

5/14/19

PROJECT REFERENCE NO. R-5740	SHEET NO. 15
RW SHEET NO.	
ROADWAY DESIGN ENGINEER	HYDRAULICS ENGINEER
DOCUMENT NOT CONSIDERED FINAL UNLESS ALL SIGNATURES COMPLETED	

-L-		
PI Sta 153+61.43	PI Sta 156+89.45	PI Sta 162+13.10
$\Delta = 5^{\circ} 43' 44.7" (LT)$	$\Delta = 0^{\circ} 39' 07.7" (LT)$	$\Delta = 0^{\circ} 44' 11.7" (LT)$
$D = 2^{\circ} 53' 37.4"$	$D = 0^{\circ} 17' 11.3"$	$D = 0^{\circ} 22' 55.1"$
$L = 197.98'$	$L = 227.64'$	$L = 192.84'$
$T = 99.07'$	$T = 113.82'$	$T = 96.42'$
$R = 1,980.00'$	$R = 20,000.00'$	$R = 15,000.00'$
$SE = 0.06$	$SE = EXIST$	$SE = EXIST$

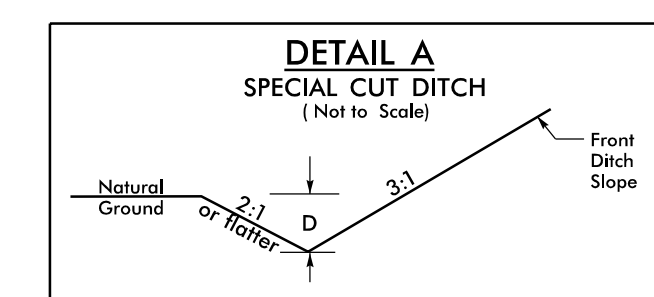
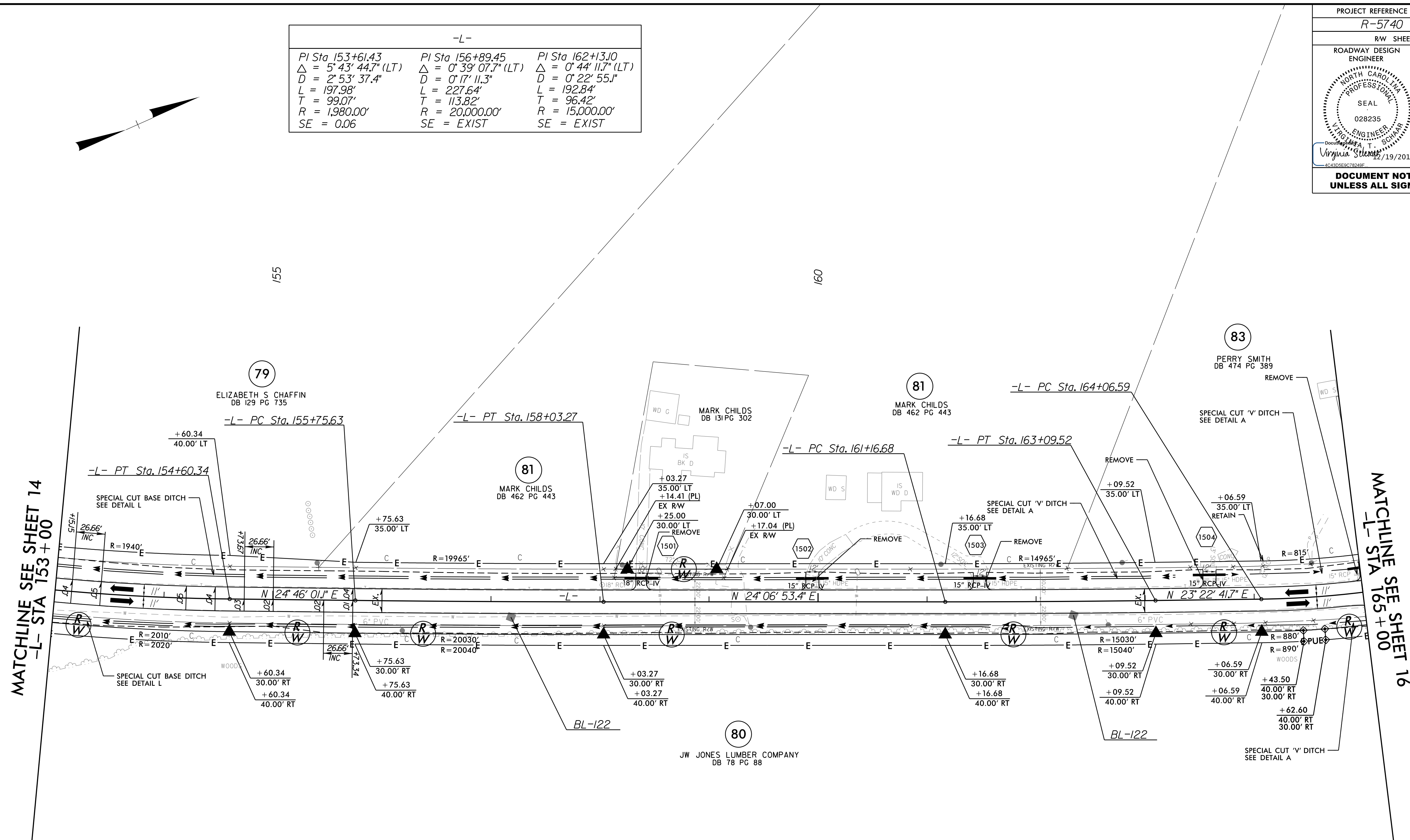

FROM -L- STA. 163+28 TO -L- STA. 170+77 LT Min. D=1.5 Ft.
FROM -L- STA. 161+71 TO -L- STA. 165+00 RT Min. D=1.5 Ft.

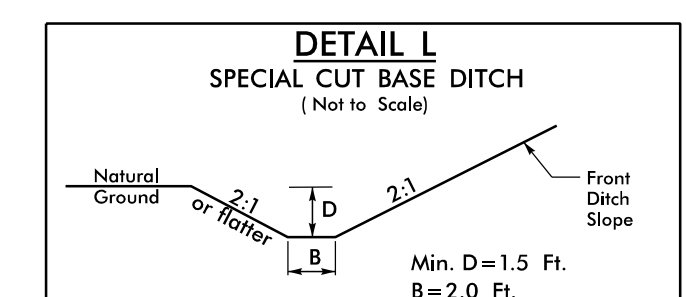

FROM -L- STA. 133+50 TO -L- STA. 163+28 LT
FROM -L- STA. 152+22 TO -L- STA. 161+71 RT

NOTE: SEE SHEET 27 FOR -L- PROFILE

R:\16-DEC-2019 16:19 R5740_r.dwg_PSH-15.dgn