

AS-BUILT REPAIR QUANTITY TABLE

REPAIRS BENT 3	QUANTITIES			
	ESTIMATE		ACTUAL	
SHOTCRETE REPAIRS	AREA SF	VOLUME CF	AREA SF	VOLUME CF
CAP	71.2	35.6		
COLUMN	171.5	85.8		
CONCRETE REPAIRS	AREA SF	VOLUME CF	AREA SF	VOLUME CF
CAP	0.0	0.0		
COLUMN	0.0	0.0		
EPOXY RESIN INJECTION		LN. FT.		LN. FT.
CAP		10.0		
COLUMN		0.0		
EPOXY COATING		SQ. FT.		SQ. FT.
TOP OF BENT CAP		94.2		

VALUES IN CHART REPRESENT ESTIMATED REPAIR TOTALS AFTER REMOVAL OF UNSOUND CONCRETE, MIN. OF 1" BEHIND REBAR AND 2" MIN. CLEAR TO SAWCUT.

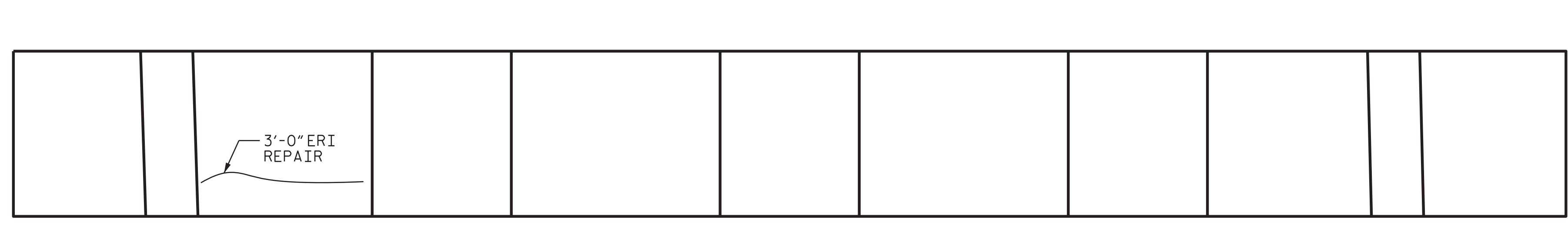
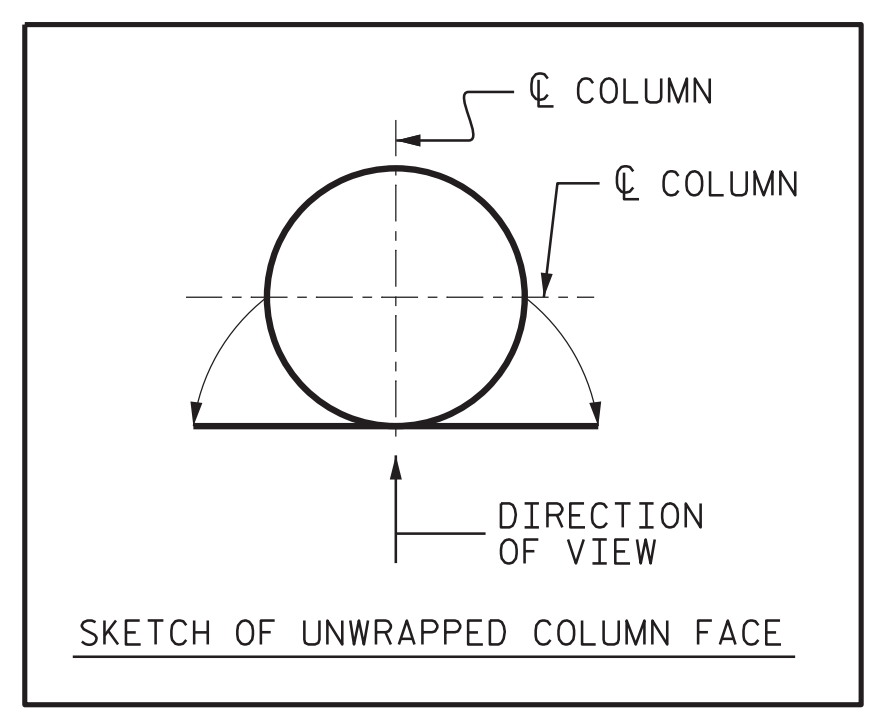
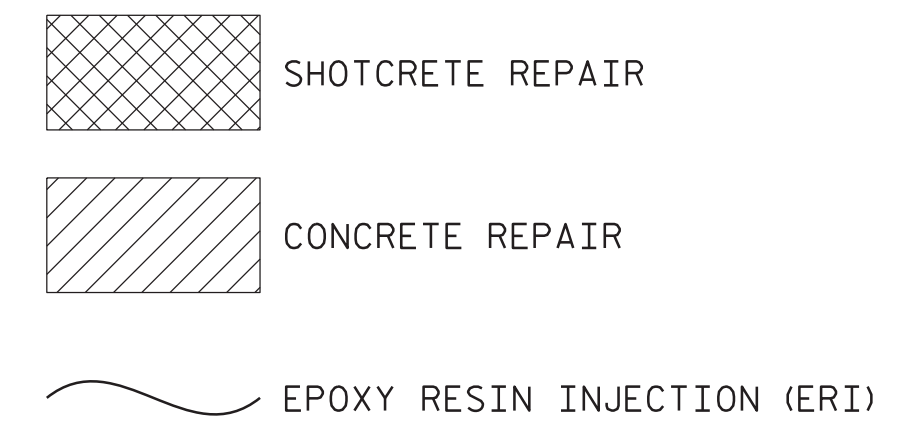

TOP OF CAP @ BENT 3

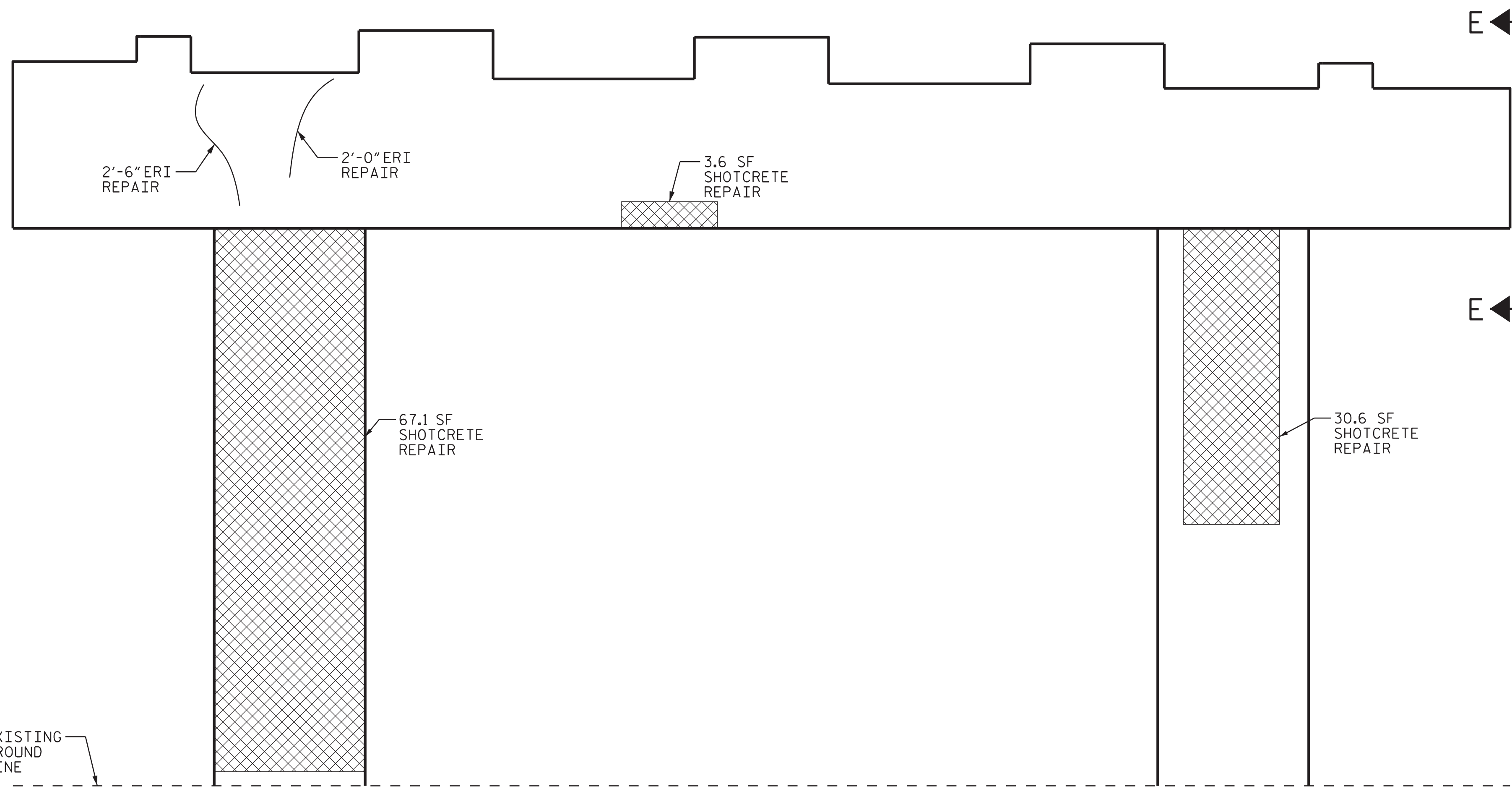

SPAN D

SPAN C

END OF CAP (E-E)

COLUMN 1

COLUMN 2

ELEVATION @ BENT 3 (SPAN C)

(COLUMN FACE IS SHOWN UNWRAPPED FOR CLARITY)

PROJECT NO. 15BPR.45
DUPLIN COUNTY
 BRIDGE NO. 300433

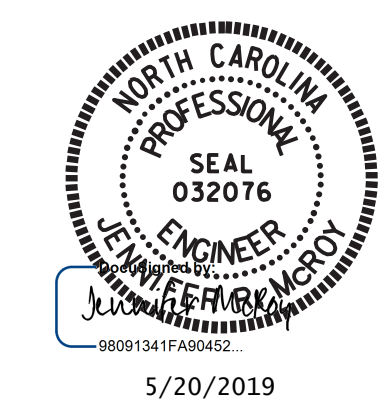

STATE OF NORTH CAROLINA
 DEPARTMENT OF TRANSPORTATION
 RALEIGH

BENT 3 (SPAN C)

DRAWN BY: R. G. BEAUCHAMP DATE: 3/19
 CHECKED BY: J. R. MCROY DATE: 3/19

VOLKERT
 5540 Centerview Drive, Suite 305
 Raleigh, NC 27606
 Tel. 919-854-0344 Fax. 919-854-0355
 NC License No. F-0765

DOCUMENT NOT CONSIDERED FINAL UNLESS ALL SIGNATURES COMPLETED

REVISIONS						SHEET NO.
NO.	BY:	DATE:	NO.	BY:	DATE:	
1			3			S1-15
2			4			TOTAL SHEETS: 31