

LOAD FACTORS:

DESIGN LOAD RATING FACTORS	LIMIT STATE	$\gamma_{DC}$	$\gamma_{DW}$
	STRENGTH I	1.25	1.50
	SERVICE III	1.00	1.00

## LOAD AND RESISTANCE FACTOR RATING (LRFR) SUMMARY FOR PRESTRESSED CONCRETE GIRDERS

LEVEL	VEHICLE	WEIGHT (W) (TONS)	CONTROLLING LOAD RATING #	MINIMUM RATING FACTORS (RF)	TONS = W x RF	STRENGTH I LIMIT STATE										SERVICE III LIMIT STATE					COMMENT NUMBER		
						MOMENT					SHEAR					MOMENT							
						LIVE-LOAD FACTORS ( $\gamma_{LL}$ )	DISTRIBUTION FACTORS (DF)	RATING FACTOR	SPAN	GIRDER LOCATION	DISTANCE FROM LEFT END OF SPAN (ft)	DISTRIBUTION FACTORS (DF)	RATING FACTOR	SPAN	GIRDER LOCATION	DISTANCE FROM LEFT END OF SPAN (ft)	LIVE-LOAD FACTORS ( $\gamma_{LL}$ )	DISTRIBUTION FACTORS (DF)	RATING FACTOR	SPAN		GIRDER LOCATION	DISTANCE FROM LEFT END OF SPAN (ft)
DESIGN LOAD RATING	HL-93 (INVENTORY)	N/A	①	1.09		0.815	1.49	A	E	48.5	0.981	1.18	A	I	4.5	0.80	0.744	1.09	A	I	48.5		
	HL-93 (OPERATING)	N/A		1.55		0.815	1.93	A	E	48.5	0.981	1.55	A	I	4.5	N/A	--	--	--	--	--		
	HS-20 (INVENTORY)	36.000	②	1.51		0.815	2.06	A	E	48.5	0.981	1.61	A	I	4.5	0.80	0.744	1.51	A	I	48.5		
	HS-20 (OPERATING)	36.000		2.11		0.815	2.68	A	E	48.5	0.981	2.11	A	I	4.5	N/A	--	--	--	--	--		
LEGAL LOAD RATING	SINGLE VEHICLE (SV)	SNSH	13.500		3.57	48.19	0.815	6.10	A	E	48.5	0.981	5.15	A	I	4.5	0.80	0.744	3.57	A	I	48.5	
		SNGARBS2	20.000		2.59	51.80	0.815	4.42	A	E	48.5	0.981	3.57	A	I	4.5	0.80	0.744	2.59	A	I	48.5	
		SNAGRIS2	22.000		2.43	53.46	0.815	4.14	A	E	48.5	0.981	3.29	A	I	4.5	0.80	0.744	2.43	A	I	48.5	
		SNCOTTS3	27.250		1.78	48.50	0.815	3.03	A	E	48.5	0.981	2.52	A	I	4.5	0.80	0.744	1.78	A	I	48.5	
		SNAGGRS4	34.925		1.46	50.99	0.815	2.49	A	E	48.5	0.981	2.04	A	I	4.5	0.80	0.744	1.46	A	I	48.5	
		SNS5A	35.550		1.43	50.83	0.815	2.44	A	E	48.5	0.981	2.04	A	I	4.5	0.80	0.744	1.43	A	I	48.5	
		SNS6A	39.950		1.30	51.93	0.815	2.22	A	E	48.5	0.981	1.84	A	I	4.5	0.80	0.744	1.30	A	I	48.5	
		SNS7B	42.000		1.24	52.08	0.815	2.11	A	E	48.5	0.981	1.79	A	I	4.5	0.80	0.744	1.24	A	I	48.5	
	TRUCK TRACTOR SEMI-TRAILER (TTST)	TNAGRIT3	33.000		1.58	52.14	0.815	2.70	A	E	48.5	0.981	2.22	A	I	4.5	0.80	0.744	1.58	A	I	48.5	
		TNT4A	33.075		1.58	52.25	0.815	2.70	A	E	48.5	0.981	2.18	A	I	4.5	0.80	0.744	1.58	A	I	48.5	
		TNT6A	41.600		1.28	53.24	0.815	2.19	A	E	48.5	0.981	1.87	A	I	4.5	0.80	0.744	1.28	A	I	48.5	
		TNT7A	42.000		1.28	53.76	0.815	2.19	A	E	48.5	0.981	1.84	A	I	4.5	0.80	0.744	1.28	A	I	48.5	
		TNT7B	42.000		1.32	55.44	0.815	2.25	A	E	48.5	0.981	1.76	A	I	4.5	0.80	0.744	1.32	A	I	48.5	
		TNAGRIT4	43.000		1.26	54.18	0.815	2.15	A	E	48.5	0.981	1.70	A	I	4.5	0.80	0.744	1.26	A	I	48.5	
		TNAGT5A	45.000		1.19	53.55	0.815	2.04	A	E	48.5	0.981	1.67	A	I	4.5	0.80	0.744	1.19	A	I	48.5	
TNAGT5B	45.000	③	1.18	53.10	0.815	2.02	A	E	48.5	0.981	1.62	A	I	4.5	0.80	0.744	1.18	A	I	48.5			

**NOTES:**

MINIMUM RATING FACTORS ARE BASED ON THE STRENGTH I AND SERVICE III LIMIT STATES.

ALLOWABLE STRESSES FOR SERVICE III LIMIT STATE ARE AS REQUIRED FOR DESIGN.

# CONTROLLING LOAD RATING

① DESIGN LOAD RATING (HL-93)

② DESIGN LOAD RATING (HS-20)

③ LEGAL LOAD RATING \*\*

\*\* SEE CHART FOR VEHICLE TYPE

---

GIRDER LOCATION

I - INTERIOR GIRDER  
E - EXTERIOR

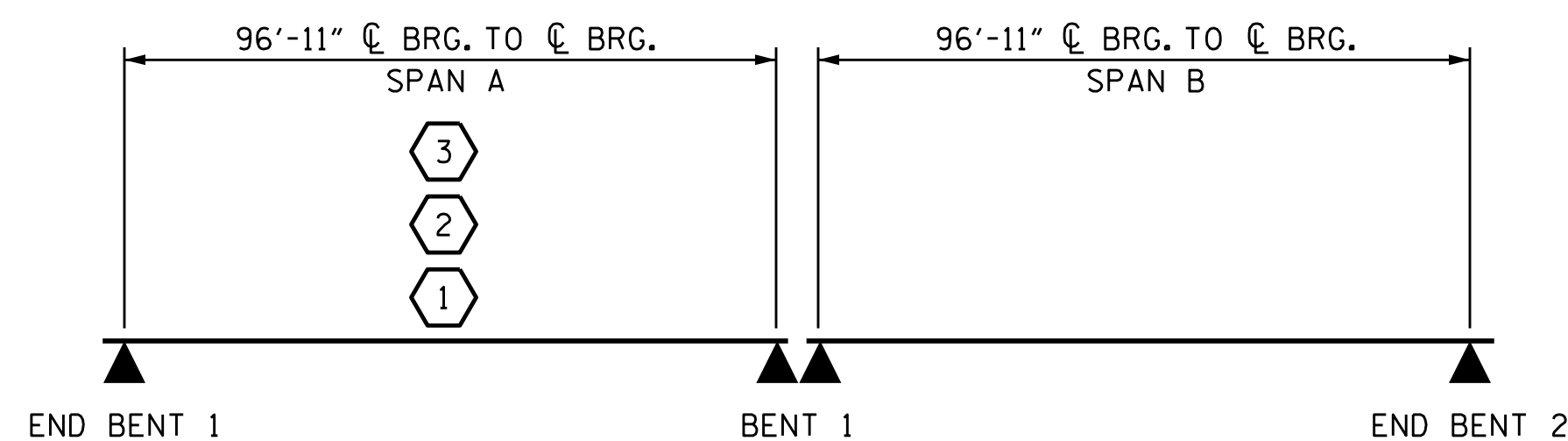

### LRFR SUMMARY

PROJECT NO. B-5671  
EDGEcombe COUNTY  
 STATION: 17+00.00 -L-

STATE OF NORTH CAROLINA  
DEPARTMENT OF TRANSPORTATION  
RALEIGH

STANDARD  
LRFR SUMMARY FOR  
PRESTRESSED  
CONCRETE GIRDERS  
(NON-INTERSTATE TRAFFIC)

REVISIONS						SHEET NO.
NO.	BY:	DATE:	NO.	BY:	DATE:	S-5
1			3			TOTAL SHEETS
2			4			29

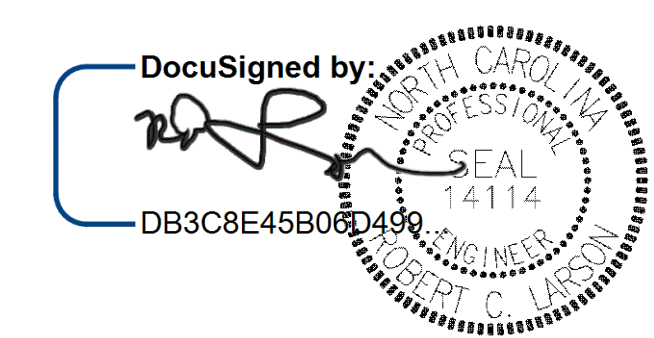

KCI JOB NO: 251801945.24

DESIGN ENGINEER OF RECORD: DocuSigned by: R. Larson DATE: 1/24/2020

ASSEMBLED BY: C. E. LARSON DATE: 09/05/19  
 CHECKED BY: R. C. LARSON DATE: 09/09/19

DRAWN BY: MAA 1/08 REV. 11/2/08RR MAA/GM  
 CHECKED BY: GM/DI 2/08 REV. 10/1/11 MAA/GM  
 REV. 12/17 MAA/THC

**DOCUMENT NOT CONSIDERED FINAL  
UNLESS ALL SIGNATURES COMPLETED**

KCI Associates  
of North Carolina, P.A.  
1505 Falls of Neuse Road, Suite 400, Raleigh, NC 27609-5270 Phone 919-783-9200