

09/06/19

STATE	STATE PROJECT REFERENCE NO.	SHEET NO.	TOTAL SHEETS
N.C.	B-5671	RW01	8

**TIP PROJECT: B-5671**

STATE OF NORTH CAROLINA  
 DIVISION OF HIGHWAYS

---

SURVEY CONTROL, EXISTING CENTERLINES,  
 RIGHT OF WAY, EASEMENTS AND PROPERTY TIES

---

**EDGEcombe COUNTY**

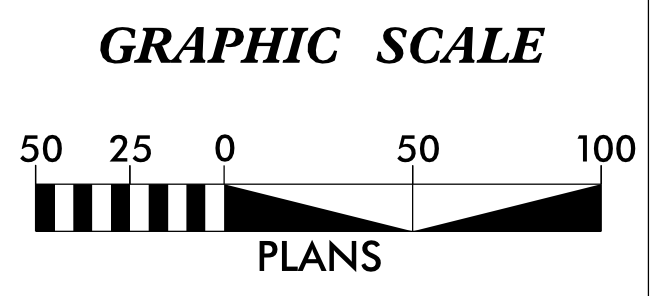
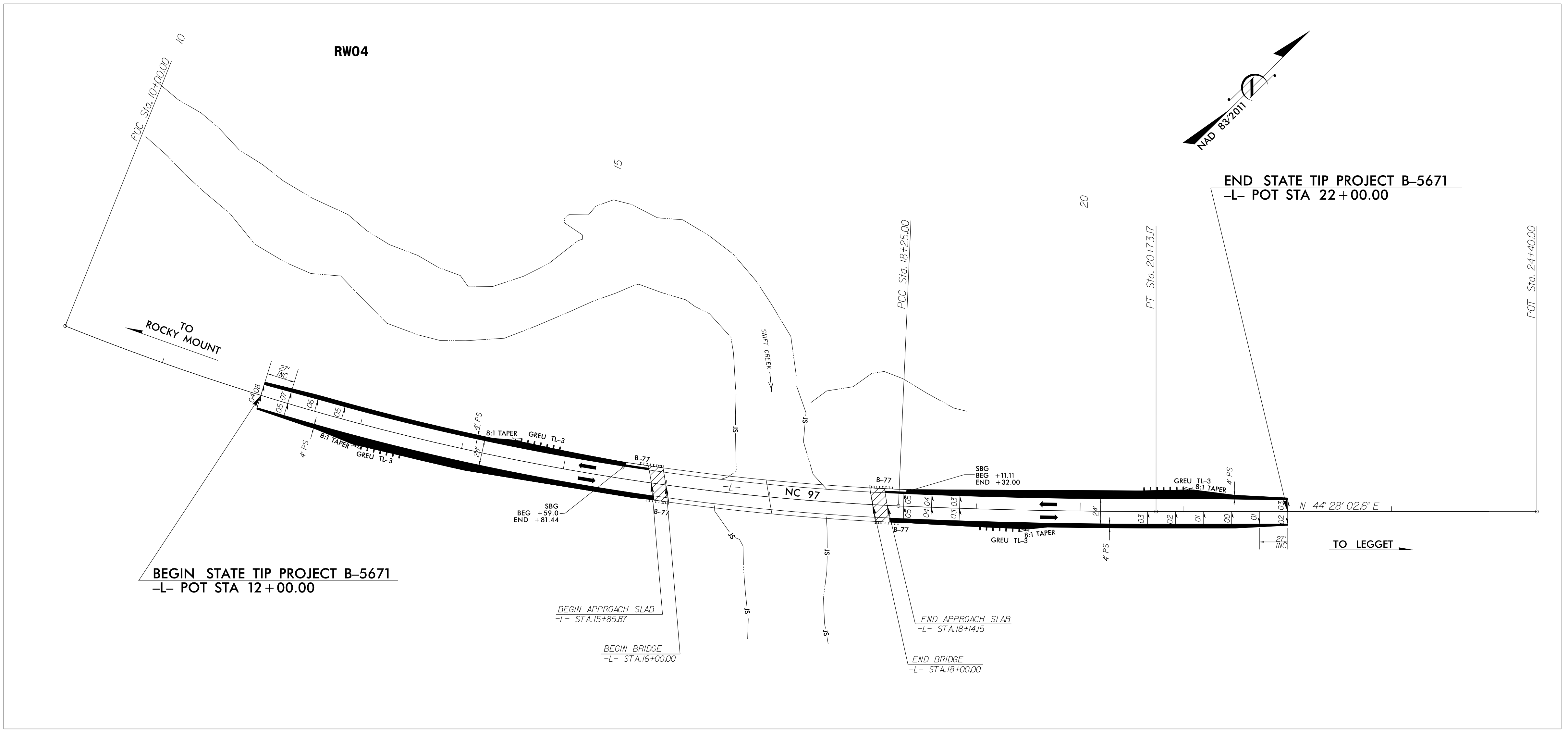

**DATUM DESCRIPTION**

THE LOCALIZED COORDINATE SYSTEM DEVELOPED FOR THIS PROJECT IS BASED ON THE STATE PLANE COORDINATES ESTABLISHED BY NCDOT FOR GPS MONUMENT "B-5671-1" WITH NAD 83/NA2011 STATE PLANE GRID COORDINATES OF NORTHING: 816,633.980(ft) EASTING: 2,417,900.223(ft) ELEVATION: 60.869(ft)

THE AVERAGE COMBINED GRID FACTOR USED ON THIS PROJECT (GROUND TO GRID) IS: 0.99995722

THE N.C. LAMBERT GRID BEARING AND LOCALIZED HORIZONTAL GROUND DISTANCE FROM "B-5671-1" TO -L- STATION 10+00.00 IS S 48-07' 55.9" W 3,396.92(ft)

ALL LINEAR DIMENSIONS ARE LOCALIZED HORIZONTAL DISTANCES VERTICAL DATUM USED IS NAVD 88/GEOID G12NC

Prepared in the Office of:

**JoynerKeeny, PLLC**  
 1051 N. Winstead Avenue  
 Rocky Mount, NC 27804  
 252-977-3124  
 North Carolina Firm Number P-0551

---

2018 STANDARD SPECIFICATIONS

**RIGHT OF WAY DATE:** \_\_\_\_\_ **LETTING DATE:** \_\_\_\_\_

**PROFESSIONAL LAND SURVEYOR**

DocuSigned by:  
 Stephen Wolfe  
 3008915F3980449...

28 February 2020

SIGNATURE: \_\_\_\_\_ Date: \_\_\_\_\_

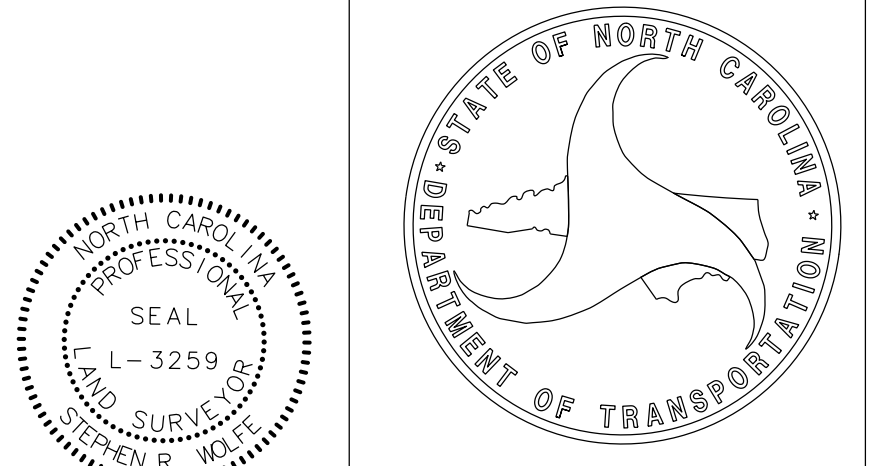

\$\$\$\$\$ SYSTEM \$\$\$\$\$\$  
\$\$\$\$\$ DDN \$\$\$\$\$\$  
\$\$\$\$\$ USERNAME \$\$\$\$\$\$