

PROJECT REFERENCE NO.	SHEET NO.
B-5639	RW02C-1
Location and Surveys	
5310 BARBADOS BLVD., SUITE 102 CASTLE HAYNE, NC 28429	

SURVEY CONTROL SHEET

W/ EXISTING CENTERLINE ALIGNMENTS PRIOR TO CONSTRUCTION

BL	POINT	DESC.	NORTH	EAST	ELEVATION	BL STATION	OFFSET
B56391	GPS CAP & REBAR		406373.1490	2310350.6110	81.69	5+00.00	0.00
B56392	GPS CAP & REBAR		407388.2630	2310130.6980	78.86	15+38.66	0.00
BL100	TRV CAP & REBAR		407784.4380	2310082.0620	69.29	19+37.81	0.00
BL101	TRV CAP & REBAR		408274.8370	2309976.3520	66.72	24+39.47	0.00
BL102	TRV CAP & REBAR		408750.1170	2309872.7460	66.32	29+25.92	0.00
BL103	TRV CAP & REBAR		409246.5060	2309765.1360	64.86	34+33.83	0.00

EL	POINT	N	E	BEARING	DIST
POT		407144.046	2310200.751		
LINE				N 12°09'40.3" W	2031.25
POT		409129.712	2309772.843		

.....
 BM1 ELEVATION = 68.71
 N 407712 E 2310164
 BL STATION 18+56.00 73 RIGHT
 NAIL SET IN 13' PINE TREE

 BM2 ELEVATION = 59.55
 N 408406 E 2310027
 BL STATION 25+57.00 77 RIGHT
 NAIL SET IN 10' OAK TREE

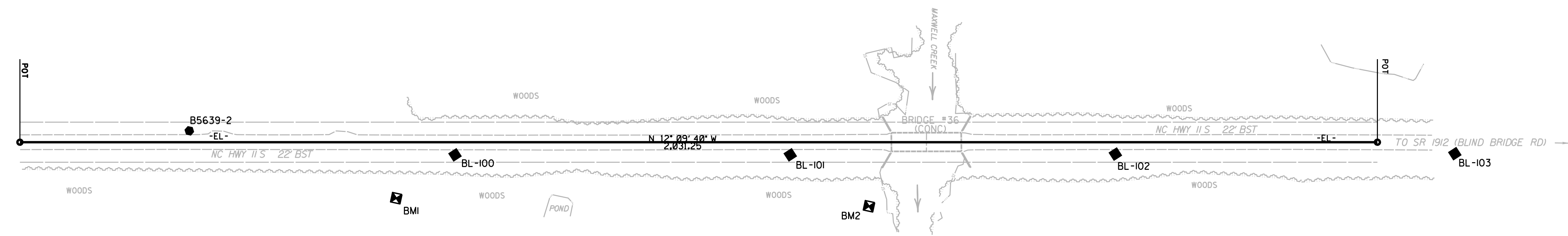
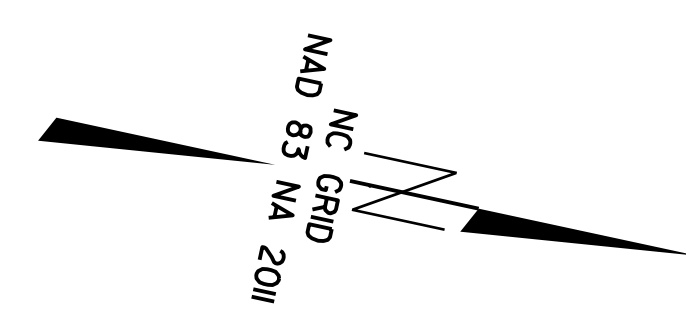

NOTES:

1. PROJECT CONTROL WAS ESTABLISHED USING GNSS, THE GLOBAL NAVIGATION SATELLITE SYSTEM.
2. THE SURVEY CONTROL DATA FOR THIS PROJECT HAS BEEN COMPILED FROM VARIOUS SOURCES. IF FURTHER INFORMATION REGARDING PROJECT CONTROL IS NEEDED, PLEASE CONTACT THE LOCATION AND SURVEYS UNIT.

REVISIONS