

5/14/1991

Kimley Horn

421 FAYETTEVILLE STREET, SUITE 600
RALEIGH, N.C. 27601

PROJECT REFERENCE NO. B-5534		SHEET NO. 4	
RW SHEET NO.			
ROADWAY DESIGN ENGINEER		HYDRAULICS ENGINEER	
DOCUMENT NOT CONSIDERED FINAL UNLESS ALL SIGNATURES COMPLETED			

-L-		
PI Sta 16+37.50	PI Sta 23+85.79	PI Sta 26+73.45
$\Delta = 26^\circ 22' 00.6" (RT)$	$\Delta = 10^\circ 59' 17.3" (RT)$	$\Delta = 10^\circ 59' 17.3" (LT)$
D = 3' 28" 20.9"	D = 3' 49" 11.0"	D = 3' 49" 11.0"
L = 759.31'	L = 287.67'	L = 287.67'
T = 386.50'	T = 144.28'	T = 144.28'
R = 1,650.00'	R = 1,500.00'	R = 1,500.00'
SE = 0.04	SE = 0.04	SE = 0.04
RO = 108'	RO = 108'	RO = 108'

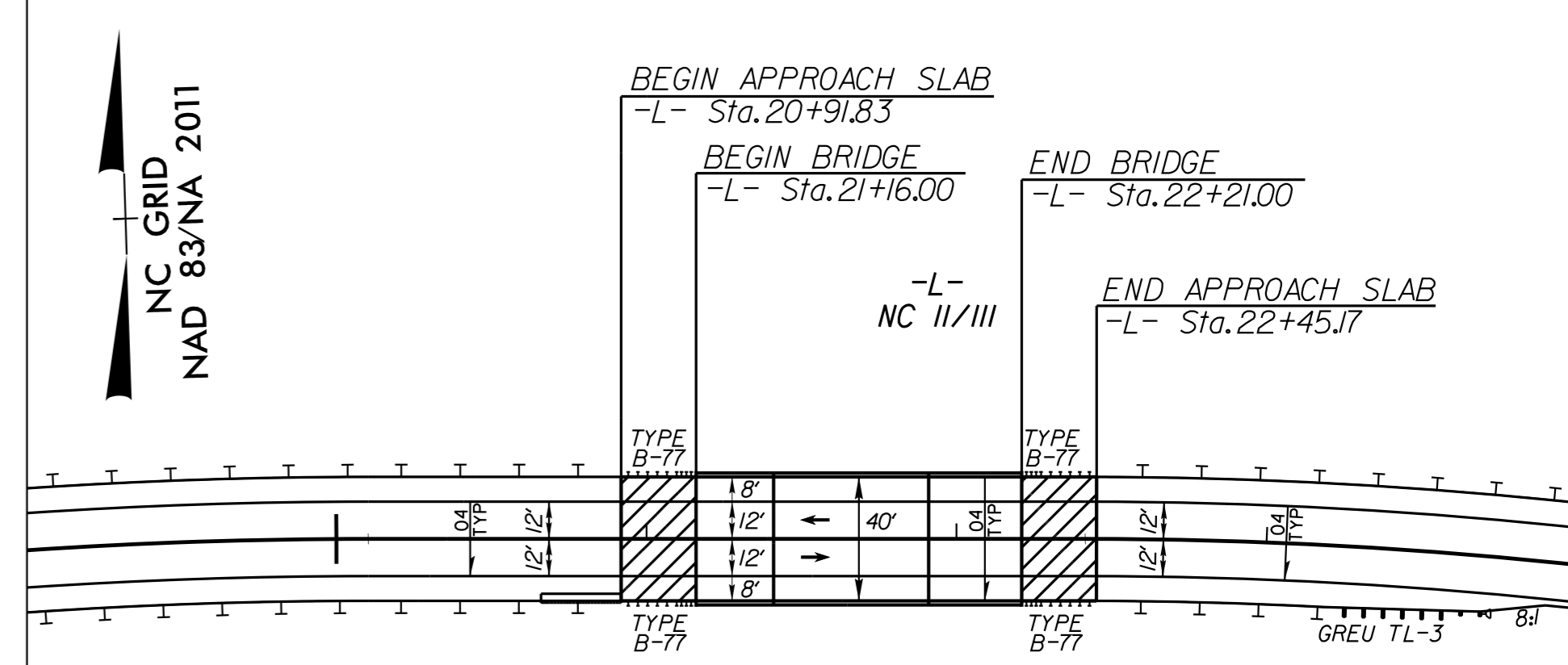
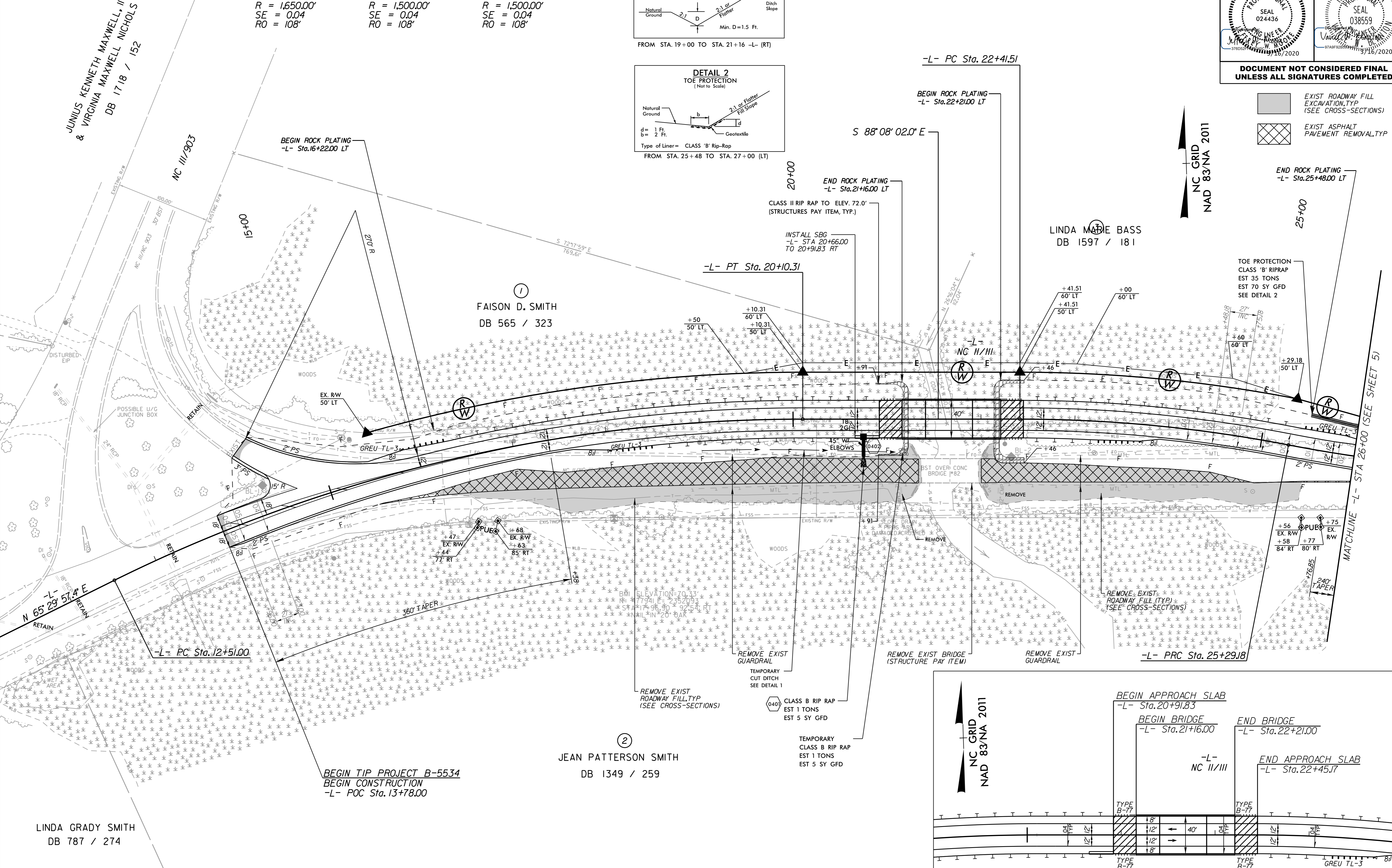
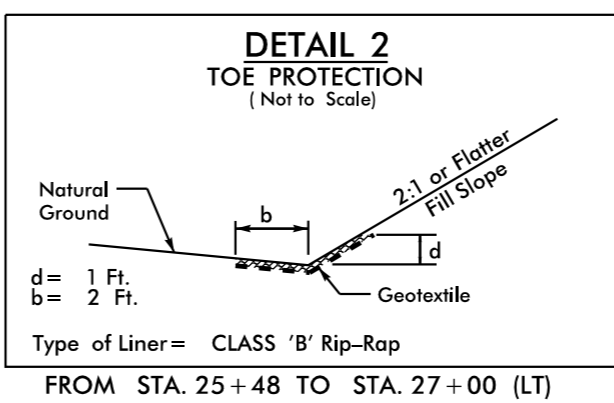
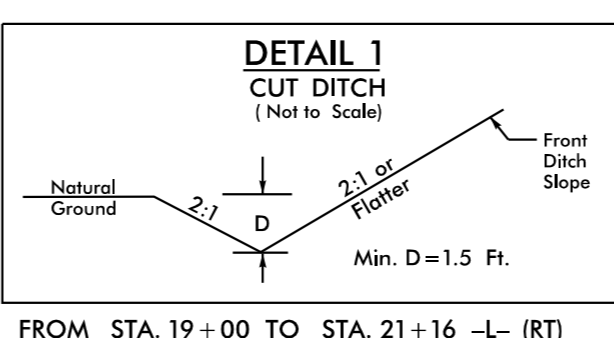

SEE SHEET 6 FOR -L- PROFILE
SEE SHEETS S-1 THRU S-34 FOR STRUCTURE PLANS

DETAIL SHOWING BRIDGE /PAVEMENT RELATIONSHIP

LINDA GRADY SMITH
DB 787 / 274

BEGIN TIP PROJECT B-5534
BEGIN CONSTRUCTION
-L- POC Sta. 13+78.00

JEAN PATTERSON SMITH
DB 1349 / 259

LINDA M. BASS
DB 1597 / 181

3/16/2020