

-RETWL2- DETAIL

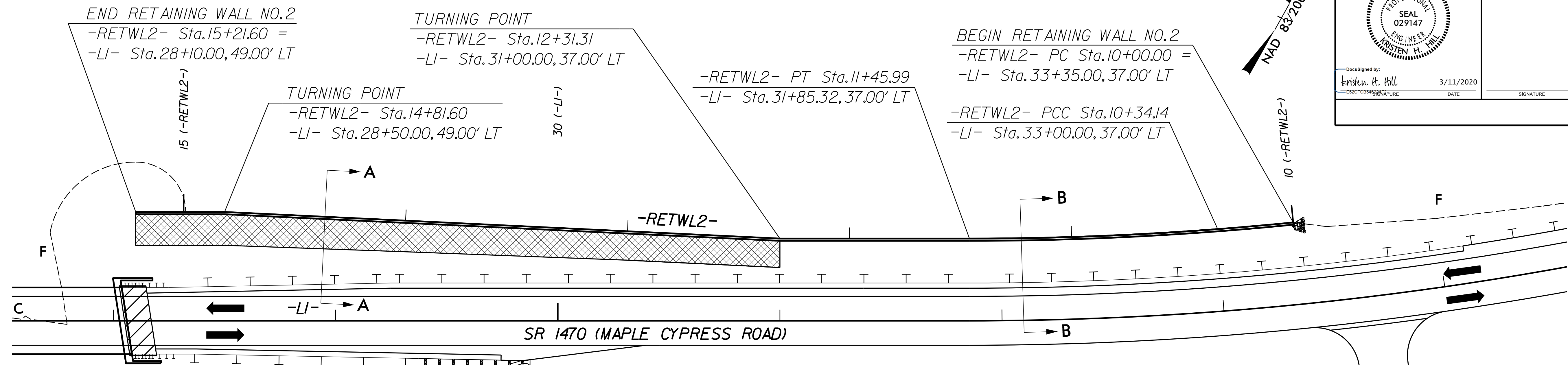

GEOTECHNICAL ENGINEER

ENGINEER

SEAL 029147
 KRISTEN H. HILL

DocuSigned by:
 Kristen H. Hill 3/11/2020

SIGNATURE DATE SIGNATURE DATE

NOTE: CONCRETE DITCH BEHIND WALL NOT SHOWN IN PLAN VIEW FOR CLARITY. SEE DETAIL 1 ON SHEET W-1.

ESTIMATED RETAINING WALL QUANTITY	
SHEET PILE RETAINING WALL NO. 2	17680 SF

-RETWL2- CURVE DATA

PI Sta 10+90.09	PI Sta 10+17.07
$\Delta = 4^{\circ} 22' 50.1''$ (RT)	$D = 1^{\circ} 20' 12.8''$ (RT)
$D = 3^{\circ} 54' 58.8''$	$D = 3^{\circ} 54' 58.8''$
$L = 111.85'$	$L = 34.14'$
$T = 55.95'$	$T = 17.07'$
$R = 1,463.00'$	$R = 1,463.00'$

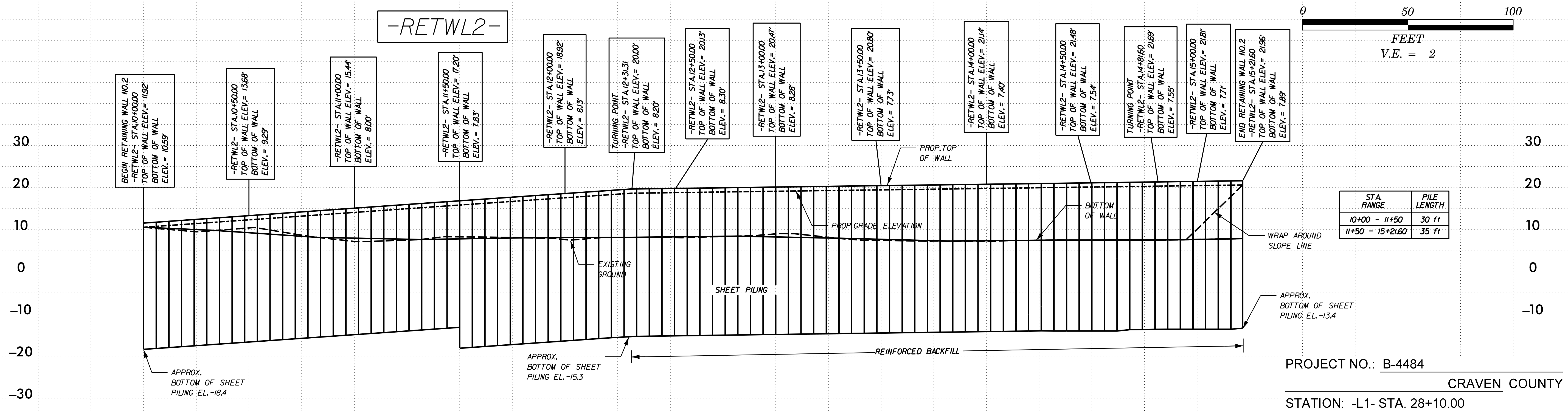
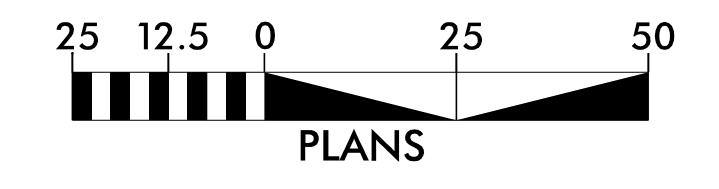

THE WALL ENVELOPE DOES NOT ACCURATELY DEPICT THE ACTUAL FACE OF WALL

13 & 14 15

9751 SOUTHERN PINE BLVD
 CHARLOTTE, NC 28273
 (704) 523-4726

NORTH CAROLINA DEPARTMENT OF TRANSPORTATION DIVISION OF HIGHWAYS

GEOTECHNICAL ENGINEERING UNIT

RETAINING WALL NO 2 LOCATION PLAN & ENVELOPE

REVISIONS					
NO.	BY	DATE	NO.	BY	DATE
1	-	-	3	-	-
2	-	-	4	-	-

SHEET NO. W-2

PREPARED BY: K. HILL	DATE: 1/14/20
REVIEWED BY: S. LANEY	DATE: 1/14/20