

09_08/19

T.I.P. NO.	SHEET NO.
B-4484	UC-1

STATE OF NORTH CAROLINA
DIVISION OF HIGHWAYS

**UTILITY CONSTRUCTION PLANS
CRAVEN COUNTY**

LOCATION: REPLACE BRIDGES NO. 138 & 139 OVER NEUSE RIVER AND NEUSE RIVER OVERFLOW ON SR 1470 (MAPLE CYPRESS ROAD)

TYPE OF WORK: WATER LINE RELOCATION

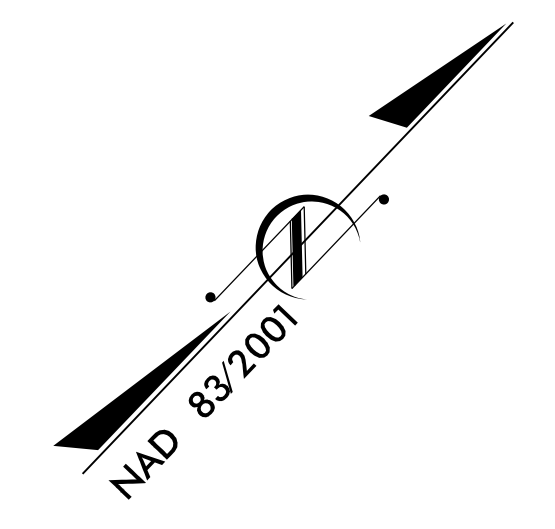

TIP PROJECT: B-4484

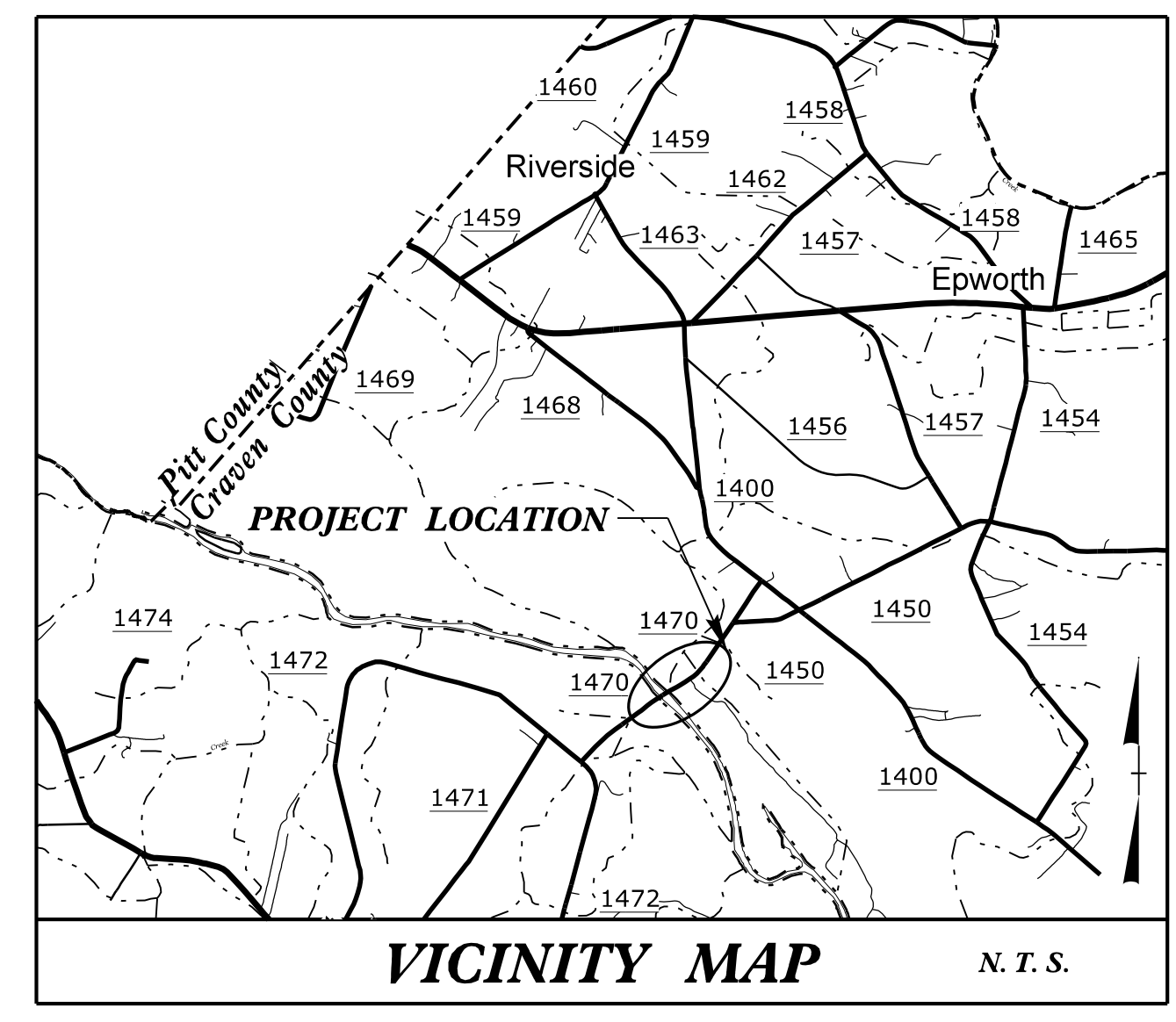

UC PLANS

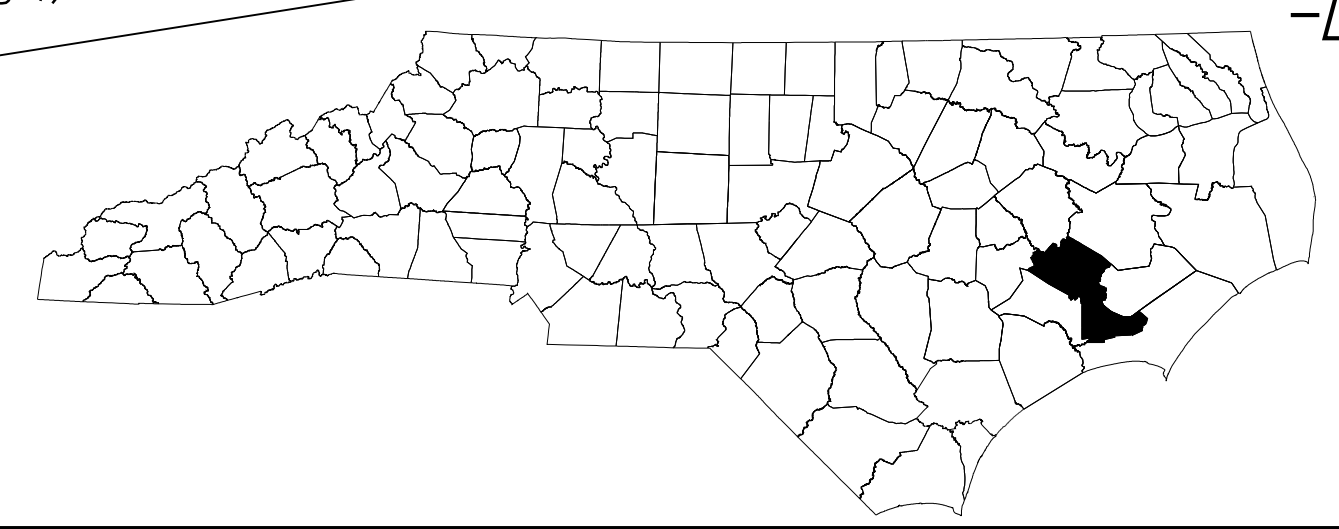
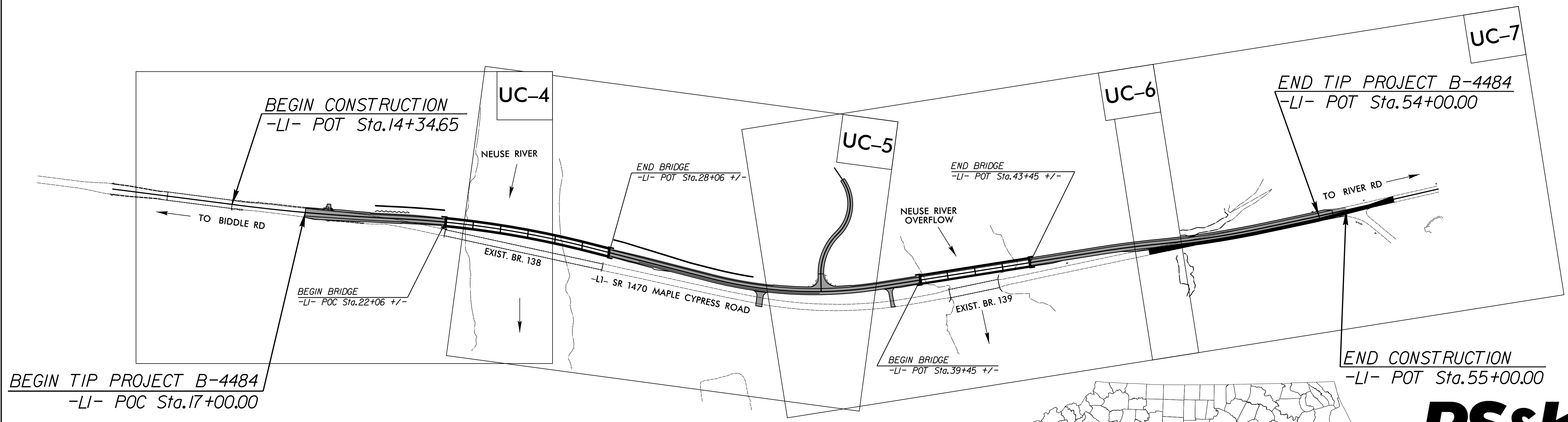

THERE IS NO CONTROL OF ACCESS ON THIS PROJECT.
THIS PROJECT IS NOT WITHIN ANY MUNICIPAL BOUNDARIES.
CLEARING ON THIS PROJECT SHALL BE PERFORMED TO THE LIMITS ESTABLISHED BY METHOD II.

DOCUMENT NOT CONSIDERED FINAL
UNLESS ALL SIGNATURES COMPLETED

CONTRACT:

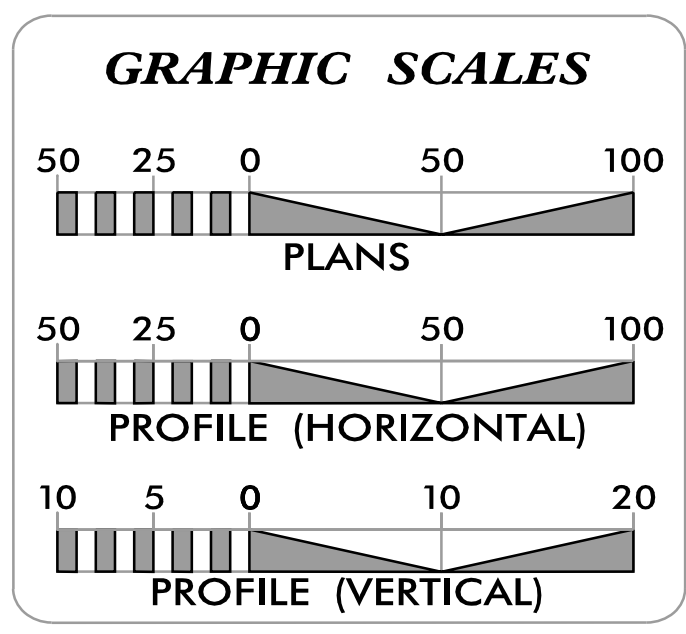

INDEX OF SHEETS

SHEET NO.:	DESCRIPTION:
UC-1	TITLE SHEET
UC-2	UTILITY SYMBOLOGY
UC-3	NOTES
UC-3A TO UC-3E	DETAILS
UC-4 TO UC-7	UTILITY CONSTRUCTION SHEET
UC-8 TO UC-9	PROFILE SHEET

WATER AND SEWER OWNERS ON PROJECT

(A) CRAVEN COUNTY WATER

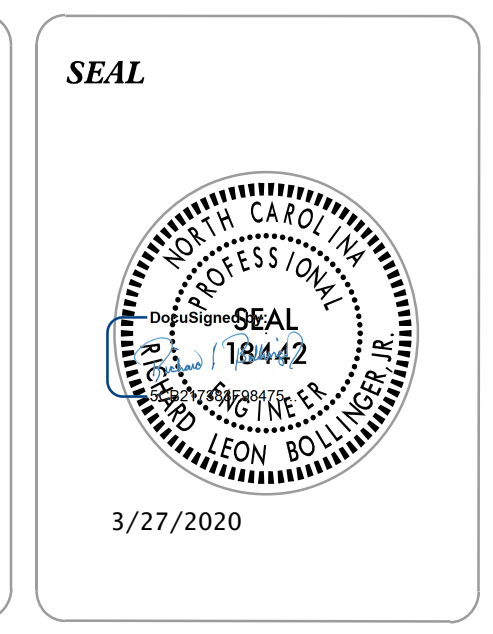

PREPARED IN THE OFFICE OF
RS&H
ARCHITECTS-ENGINEERS-PLANNERS, INC.
8521 SIX FORKS ROAD, SUITE 400
RALEIGH, NC 27615

RICHARD BOLLINGER, PE
PROJECT ENGINEER

ALEXANDER VINSON, PE
PROJECT DESIGN ENGINEER

HON YEUNG, PE
NCDOT CONTACT