

STATE OF NORTH CAROLINA
DIVISION OF HIGHWAYS

TRANSPORTATION MANAGEMENT PLAN

CRAVEN COUNTY

LOCATION: REPLACE BRIDGES NO. 138 & 139 OVER NEUSE RIVER AND NEUSE RIVER OVERFLOW ON SR 1470 (MAPLE CYPRESS ROAD)

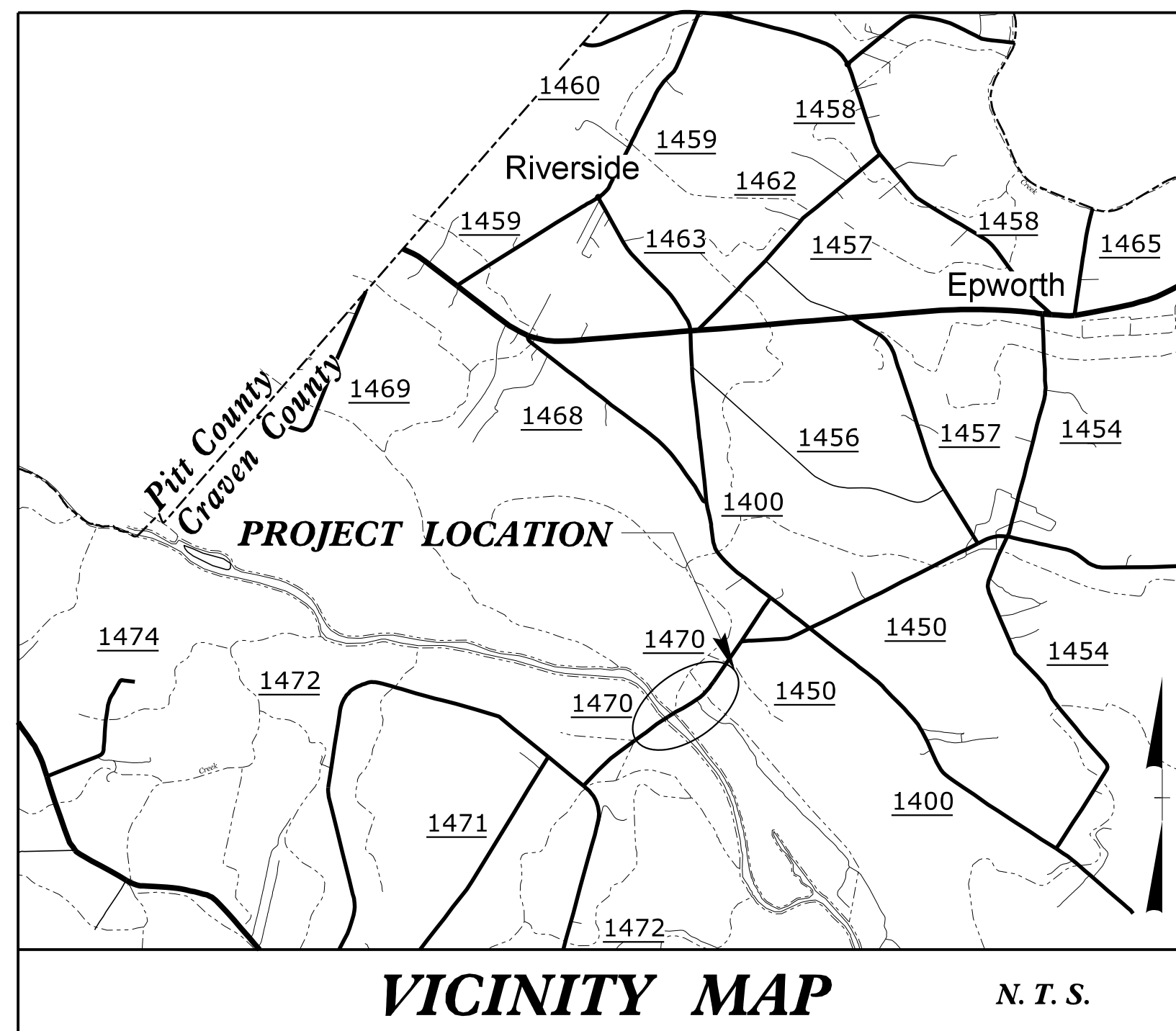
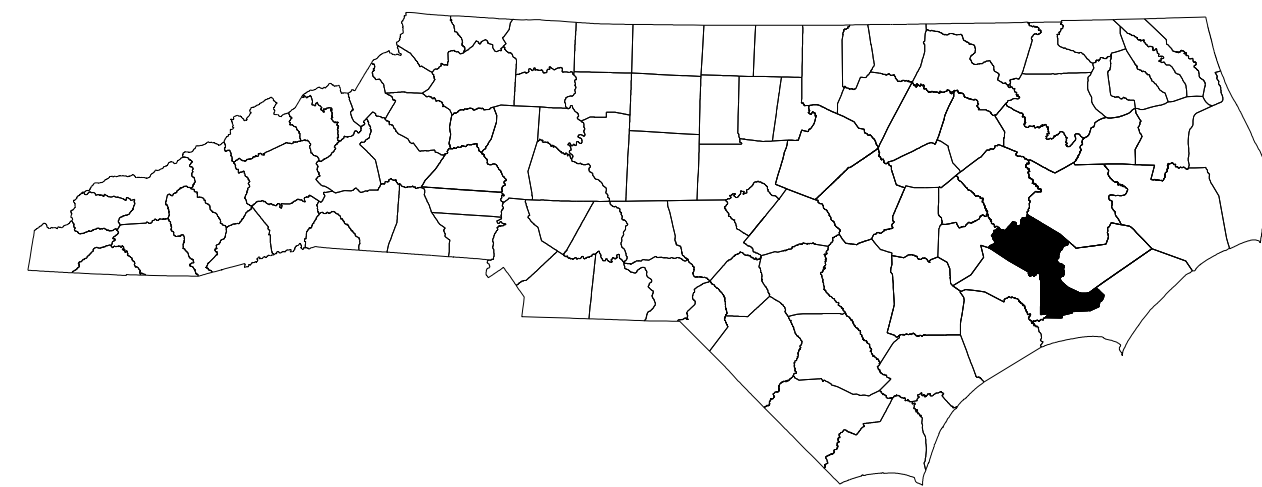

INDEX OF SHEETS

SHEET NO.	TITLE
TMP-1	TITLE SHEET, VICINITY MAP, AND INDEX OF SHEETS
TMP-1A	LIST OF APPLICABLE ROADWAY STANDARD DRAWINGS, AND LEGEND
TMP-2 THRU 2A	TRANSPORTATION OPERATIONS PLAN: (MANAGEMENT STRATEGY, GENERAL NOTES, AND LOCAL NOTES)
TMP-2B	PORTABLE CONCRETE BARRIER AT TEMPORARY SHORING LOCATION
TMP-2C	TEMPORARY SHORING NOTES
TMP-3	TEMPORARY TRAFFIC CONTROL PHASING
TMP-4	TEMPORARY TRAFFIC CONTROL PHASE 1 STEP 2 DETAIL
TMP-5 THRU 7	TEMPORARY TRAFFIC CONTROL PHASE I STEP 3 DETAIL
TMP-8 THRU 10	TEMPORARY TRAFFIC CONTROL PHASE II DETAIL
TMP-11 THRU 13	TEMPORARY TRAFFIC CONTROL PHASE III DETAIL

SHEET NO.
TMP-1

B-4484

TIP PROJECT:

**DOCUMENT NOT CONSIDERED FINAL
UNLESS ALL SIGNATURES COMPLETED**

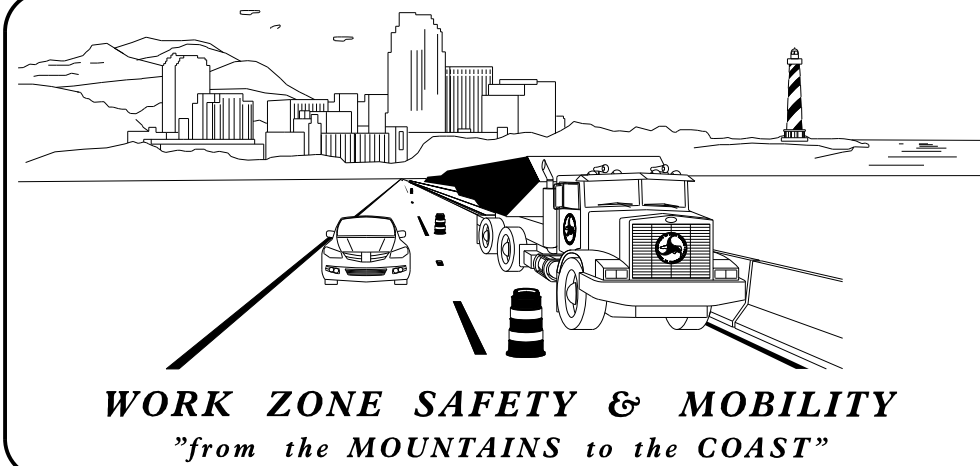

PLANS PREPARED BY:
 ANNIE C. PILZ, P.E.
 PROJECT ENGINEER
 NIKI E. AVGERINOS, E.I.
 PROJECT DESIGN ENGINEER

NCDOT CONTACTS:
 HON YEUNG, P.E.
 PROJECT TEAM LEAD

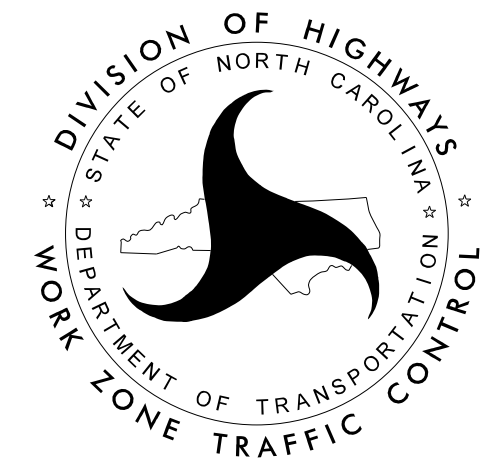

APPROVED: *Annie C. Pilz*
DocuSigned by: Annie C. Pilz 82FB8C0DE83D48E
DATE: 4/2/2020



4/2/2020 R:\TrafficControl\CP\B4484_tmp_tsh.dgn User:PilzA