

09/06/99

TIP PROJECT: B-4484

STATE OF NORTH CAROLINA  
DIVISION OF HIGHWAYS

SURVEY CONTROL, EXISTING CENTERLINES,  
RIGHT OF WAY, EASEMENTS AND PROPERTY TIES

**CRAVEN COUNTY**

LOCATION: REPLACE BRIDGES NO. 138 & 139 OVER NEUSE  
RIVER AND NEUSE RIVER OVERFLOW ON  
SR 1470 (MAPLE CYPRESS ROAD)

STATE	STATE PROJECT REFERENCE NO.	SHEET NO.	TOTAL SHEETS
N.C.	B-4484	RW01	

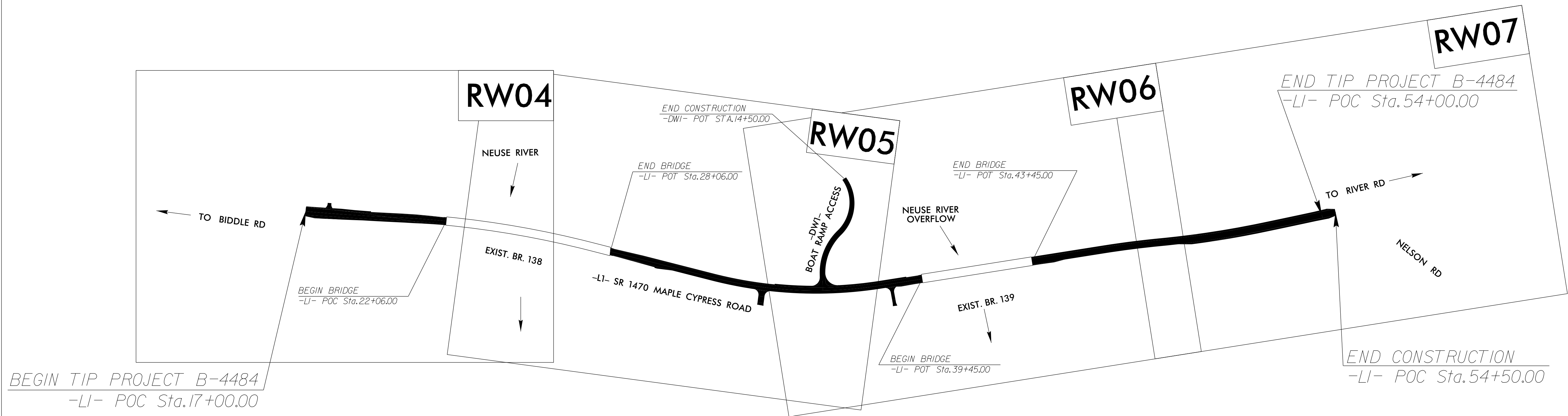
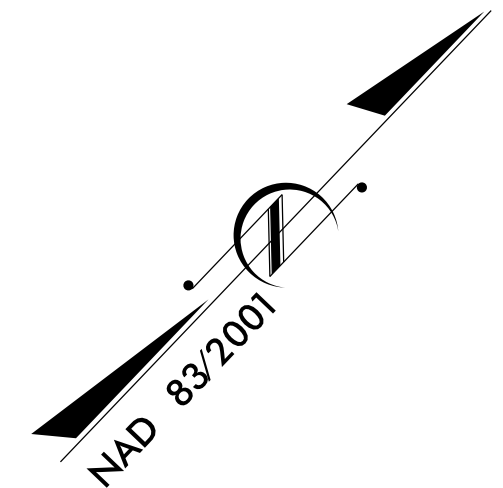

BEGIN TIP PROJECT B-4484  
-LI- POC Sta.17+00.00

END TIP PROJECT B-4484  
-LI- POC Sta.54+00.00

END CONSTRUCTION  
-LI- POC Sta.54+50.00

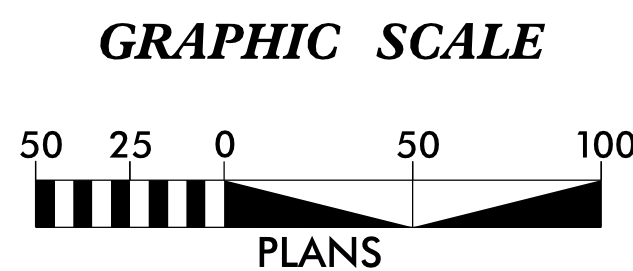

**DATUM DESCRIPTION**

THE LOCALIZED COORDINATE SYSTEM DEVELOPED FOR THIS PROJECT IS BASED ON THE STATE PLANE COORDINATES ESTABLISHED BY NCGS FOR MONUMENT "B4484-1" WITH NAD 83/2001 STATE PLANE GRID COORDINATES OF NORTHING: 572679.980(ft) EASTING: 2506001.038(ft) ELEVATION: 24.22(ft)

THE AVERAGE COMBINED GRID FACTOR USED ON THIS PROJECT (GROUND TO GRID) IS: 0.99987771

THE N.C. LAMBERT GRID BEARING AND LOCALIZED HORIZONTAL GROUND DISTANCE FROM "B4484-1" TO -LI- STATION 17+00.00 IS S 56-49'12" W 263.15(ft)

ALL LINEAR DIMENSIONS ARE LOCALIZED HORIZONTAL DISTANCES VERTICAL DATUM USED IS NAVD 88

Prepared in the Office of:

**DIVISION 2  
LOCATION & SURVEYS**

2018 STANDARD SPECIFICATIONS

**RIGHT OF WAY DATE:**  
MARCH 7, 2019

**LETTING DATE:**  
FEBRUARY 16, 2021

**PROFESSIONAL LAND  
SURVEYOR**

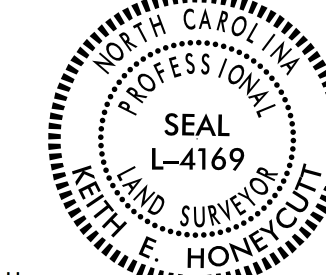

DocuSigned by:  
*KE Honeycutt*  
SIGNATURE:

Date:  
12/15/2020

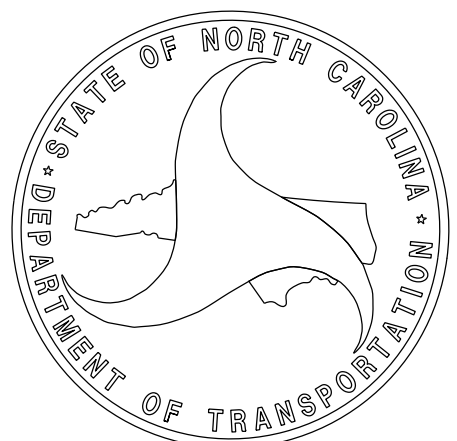

\$\$\$\$\$ SYSTEM \$\$\$\$\$\$  
\$\$\$\$\$ DDN \$\$\$\$\$\$  
\$\$\$\$\$ USERNAME \$\$\$\$\$\$