

09\_08/19

STATE OF NORTH CAROLINA  
DIVISION OF HIGHWAYS

# SAMPSON COUNTY

**LOCATION: BRIDGE NO. 810348 OVER BEAVERDAM CREEK  
ON SR 1703 (OLD GOLDSBORO RD)**

**TYPE OF WORK: GRADING, DRAINAGE, PAVING & STRUCTURE**

STATE	STATE PROJECT REFERENCE NO.	SHEET NO.	TOTAL SHEETS
N.C.	BR-0122		
STATE PROJ. NO.	F.A. PROJ. NO.	DESCRIPTION	
48831.1.1		PE	
48831.2.1		ROW, UTIL.	
48831.3.1	2020001	CONST.	



TRANSPORTATION PLANNING/DESIGN - BRIDGE/STRUCTURE DESIGN  
CIVIL/SITE DESIGN - GIS/GPS - CONSTRUCTION OBSERVATION

**BRIDGE #810348**

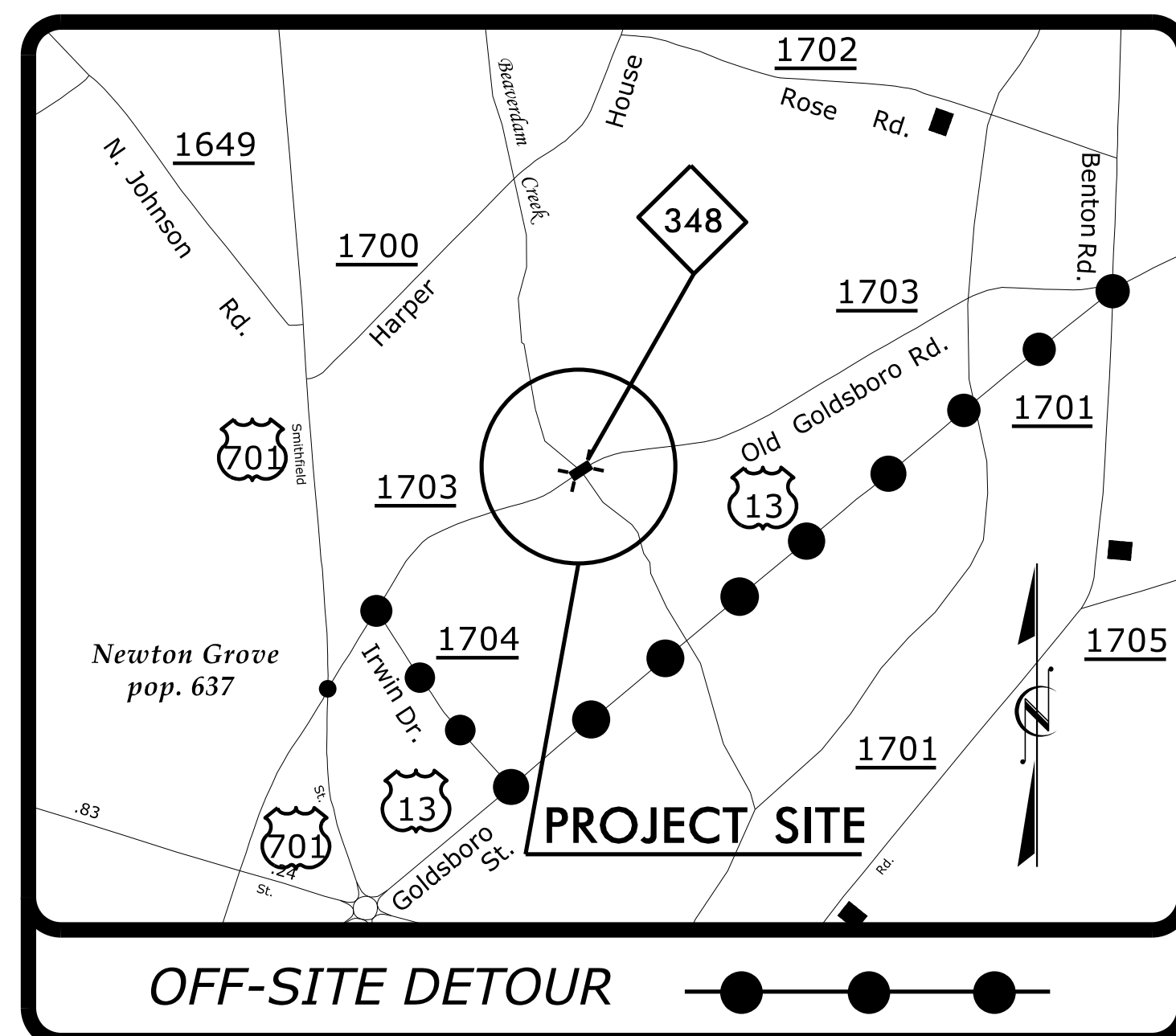

## STRUCTURE PLANS

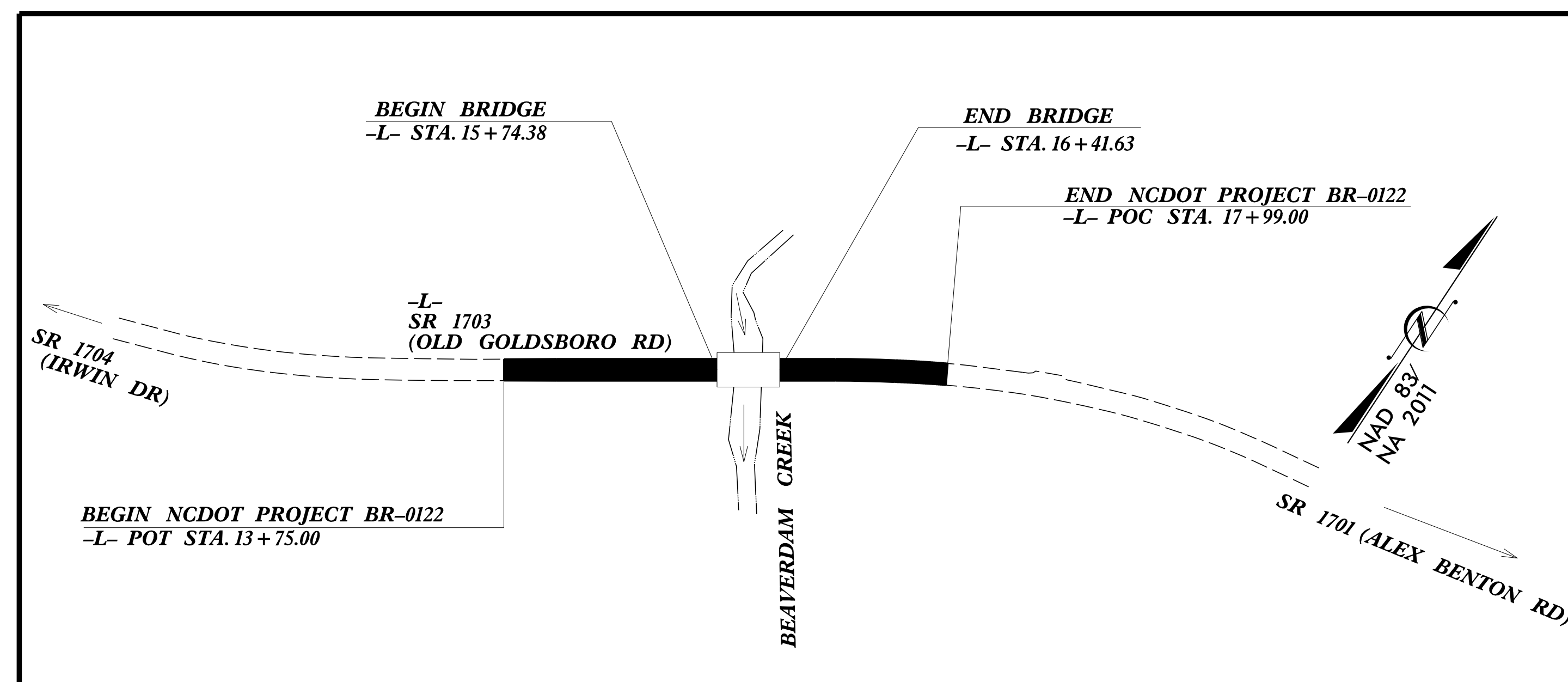

DOCUMENT NOT CONSIDERED FINAL  
UNLESS ALL SIGNATURES COMPLETED

**PROJECT: BR-0122**

**CONTRACT: C204524**

**DESIGN DATA**  
ADT 2019 = 110

T = 7 % \*  
V = 35 MPH  
\* (TTST = 3% +  
DUAL = 4%)  
FUNC CLASS =  
RURAL LOCAL  
SUBREGIONAL TIER

**PROJECT LENGTH**

LENGTH ROADWAY PROJECT BR-0122 =	0.067 MILES
LENGTH STRUCTURE PROJECT BR-0122 =	0.013 MILES
<b>TOTAL LENGTH PROJECT BR-0122 =</b>	<b>0.080 MILES</b>

NCDOT CONTACT: DAVID STUTTS, PE  
PROJECT ENGINEER - PEP/PROGRAM MGT.

Prepared for:  
**DIVISION OF HIGHWAYS  
STRUCTURES MANAGEMENT UNIT**  
1000 BIRCH RIDGE DRIVE RALEIGH NC, 27610

2018 STANDARD SPECIFICATIONS

EDWARD G. WETHERILL, PE  
PROJECT ENGINEER

LETTING DATE:  
JANUARY 19, 2021

JOHN A. DILWORTH, PE  
PROJECT DESIGN ENGINEER

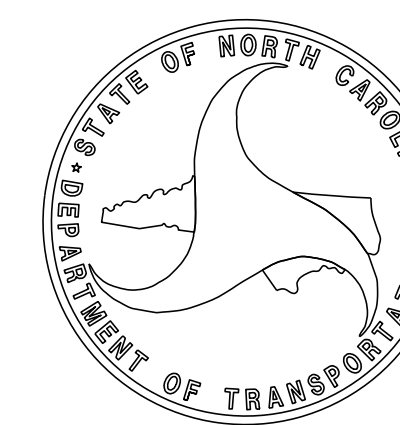

1/18/2020 12:45:12 PM  
F:\2019\19109.01\_BR-0122\_Structures\DCN\BR0122\_SMU\_TSH.dgn