

09_08/19

See Sheet 1-A For Index of Sheets
See Sheet 1-B For Conventional Symbols
See Sheet RW02C-1 TO RW02C-2 For Survey Control Sheets

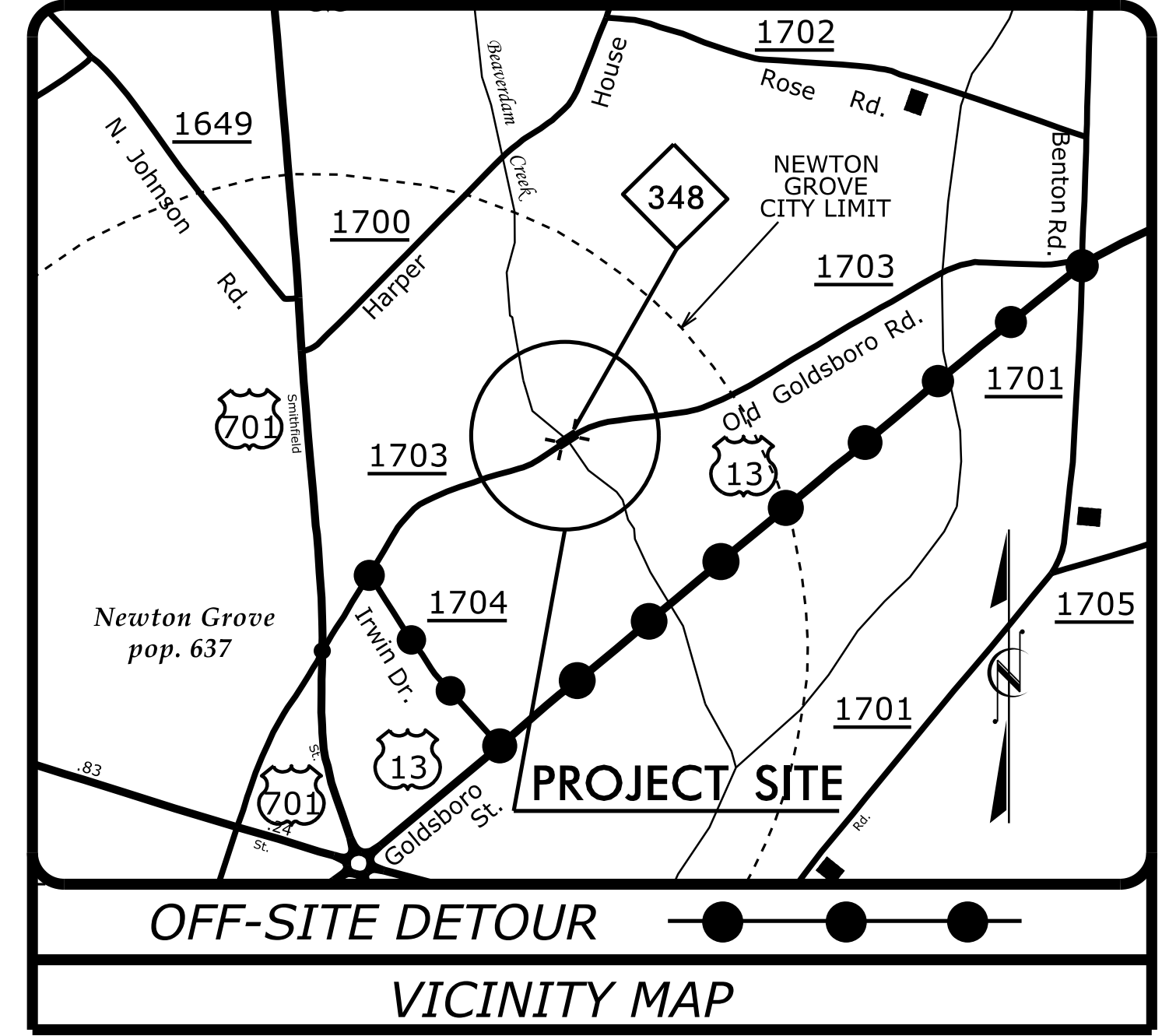

STATE OF NORTH CAROLINA DIVISION OF HIGHWAYS

UTILITY CONSTRUCTION PLANS SAMPSON COUNTY

**LOCATION: BRIDGE NO. 810348 OVER BEAVERDAM CREEK
ON SR 1703 (OLD GOLDSBORO RD)**

TYPE OF WORK: RELOCATION OF WATER LINE AND FORCE MAIN SEWER

| | |
|------------|-----------|
| T.I.P. NO. | SHEET NO. |
| BR-0122 | UC-1 |

WETHERILL ENGINEERING

1223 Jones Franklin Rd.
Raleigh, N.C. 27606
License No. F-0377
Bus: 919 851 8077
Fax: 919 851 8107

TRANSPORTATION PLANNING/DESIGN - BRIDGE/STRUCTURE DESIGN
CIVIL/SITE DESIGN - GIS/GPS - CONSTRUCTION OBSERVATION

FINAL DESIGN
RELEASE
FOR CONSTRUCTION

TIP PROJECT: BR-0122

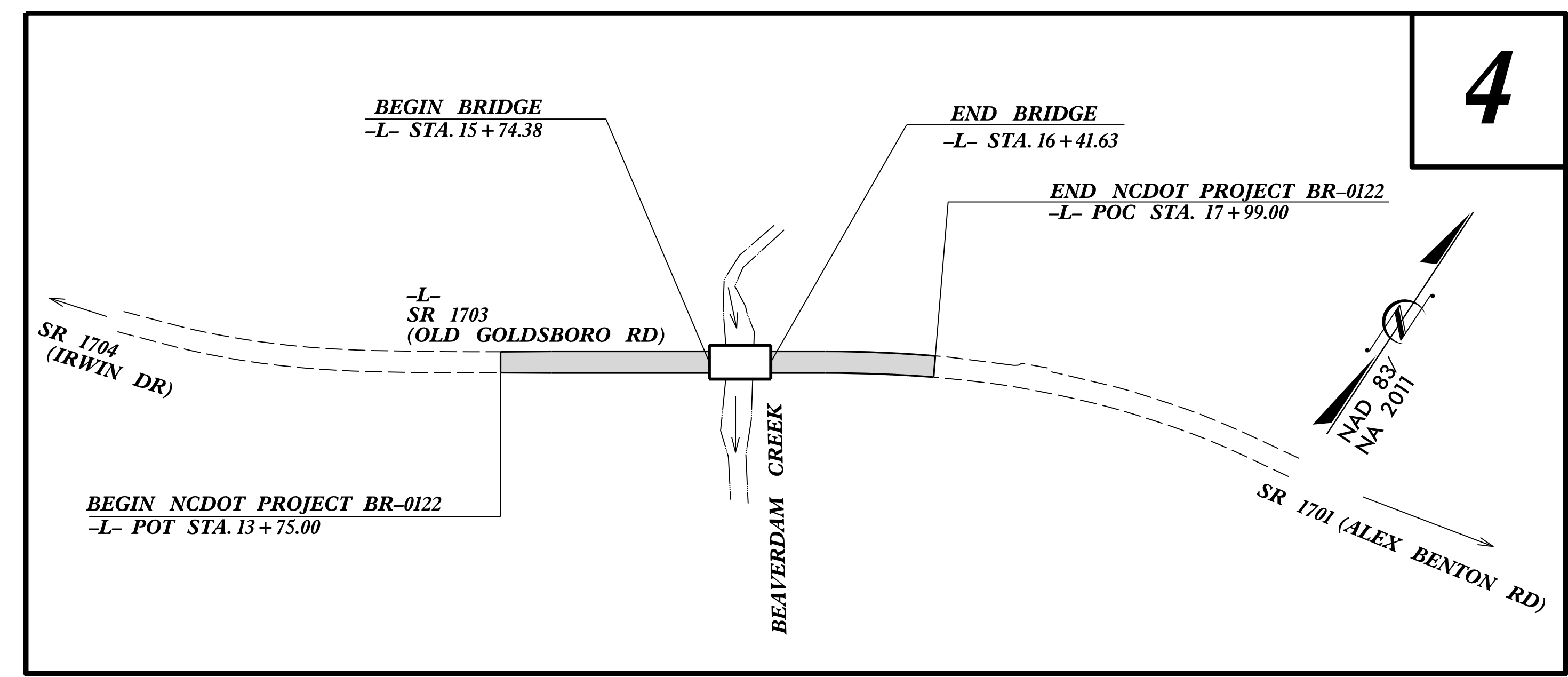

4

DOCUMENT NOT CONSIDERED FINAL
UNTIL ALL SIGNATURES ARE COMPLETED

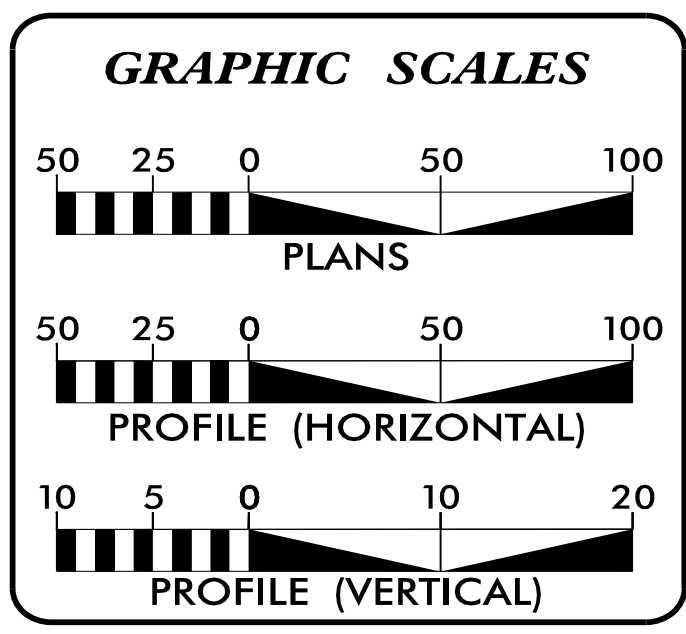

| SHEET NO.: | DESCRIPTION: |
|------------------|-------------------------|
| UC-1 | TITLE SHEET |
| UC-2 | UTILITY SYMBOLOGY |
| UC-3 THRU UC-3A | NOTES |
| UC-3B THRU UC-3C | DETAILS |
| UC-4 THRU UC-5 | PLAN AND PROFILE SHEETS |

WATER AND SEWER OWNERS ON PROJECT

(A) TOWN OF NEWTON GROVE
(WATER AND SEWER)

PREPARED IN THE OFFICE OF:

WETHERILL ENGINEERING

1223 Jones Franklin Rd.
Raleigh, N.C. 27606
License No. F-0377
Bus: 919 851 8077
Fax: 919 851 8107

TRANSPORTATION PLANNING/DESIGN - BRIDGE/STRUCTURE DESIGN
CIVIL/SITE DESIGN - GIS/GPS - CONSTRUCTION OBSERVATION

MICHAEL V. ZACCARDO, PE UTILITY ENGINEER
SCOTT L. KENNEDY UTILITY DESIGN ENGINEER
TYRON STALLINGS PROJECT UTILITY COORDINATOR

SEAL

Designed by: *Michael V. Zaccardo*

STATE OF NORTH CAROLINA
PROFESSIONAL ENGINEER
MICHAEL V. ZACCARDO
022321
11/5/2019

UTILITY CONSTRUCTION PLANS ONLY

DIVISION OF HIGHWAYS UTILITIES UNIT

1555 MAIL SERVICES CENTER
RALEIGH, NC 27699-1555
PHONE (919) 707-6690
FAX (919) 250-4151

NABIL HAMDAN UTILITIES REGIONAL ENGINEER
KELVIN MARTIN, EI UTILITIES ENGINEER
KYLE PLEASANT UTILITIES AREA COORDINATOR
LARRY JAMES, JR. UTILITIES COORDINATOR

11/5/2019
I:\BR-0122-ut_rdy-UC1.TSH.dgn
USER:skennedy