

8/17/09

-L- POT Sta. 10+00.00

-L- PC Sta. 10+37.52

-L- PT Sta. 12+73.00

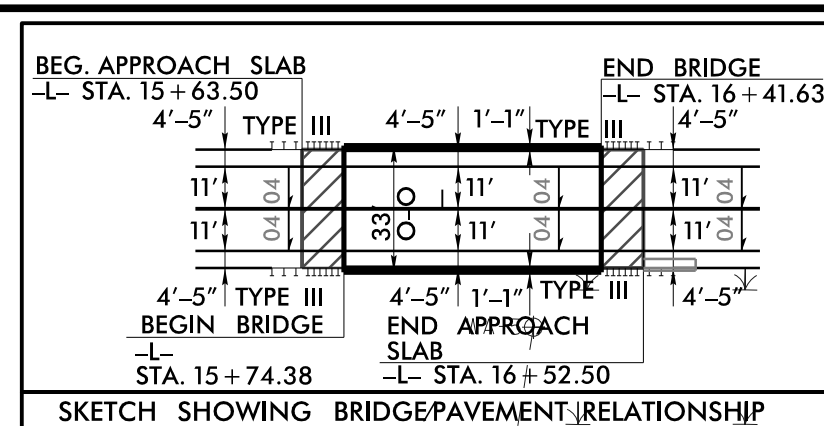

1223 Jones Franklin Rd.
Raleigh, N.C. 27606
License No. F-0377
Bus: 919 851 8077
Fax: 919 851 8107

PROJECT REFERENCE NO. BR-0122	SHEET NO. EC-5/CONST.4
RW SHEET NO.	HYDRAULICS ENGINEER
ROADWAY DESIGN ENGINEER	

ANNIE W. SMITH
DB 1274 PG 941
PB 31 PG 9

TRANSPORTATION PLANNING/DESIGN - BRIDGE/STRUCTURE DESIGN
CIVIL/SITE DESIGN - GIS/GPS - CONSTRUCTION OBSERVATION

LUTHER D. WILLIFORD
DB 1274 PG 937
DB 1489 PG 743
PB 31 PG 9

END NCDOT PROJECT BR-0122 -L- POC STA. 17+99.00

-L- POT Sta. 21+66.00

NOTE:
UTILIZE SPECIAL STILLING BASIN(S) WHERE APPLICABLE

NOTE:
UTILIZE COIR FIBER MATTING ADJACENT TO WETLANDS/ JURISDICTIONAL AREAS, AND AS DIRECTED.

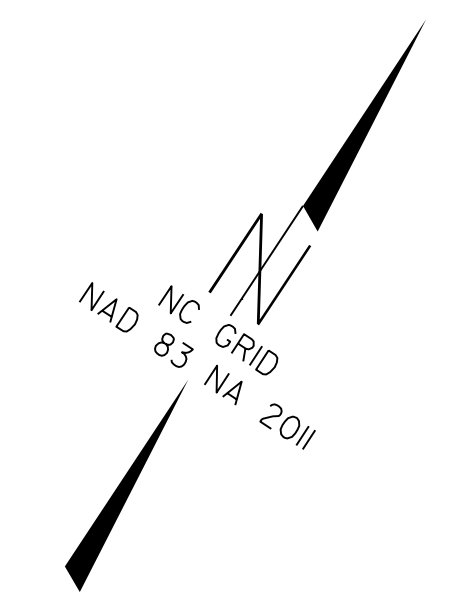

SEE SHEET RW02C-1 FOR BASELINE AND BENCHMARK INFORMATION

SEE SHEETS S-1 THRU S-13 FOR STRUCTURE PLANS

BEGIN NCDOT PROJECT BR-0122 -L- POT STA. 13+75.00

MARY MACK'S DEVELOPMENT, LLC.
DB 1853 PG 486

WILLIAM T. HERRING
DB 1933 PG 674

-L- PC Sta. 16+92.32

-L- PCC Sta. 18+31.65

-L- PT Sta. 21+29.88

NANCY J. WISE
DB 1435 PG 93
PB 28 PG 14

REVISIONS

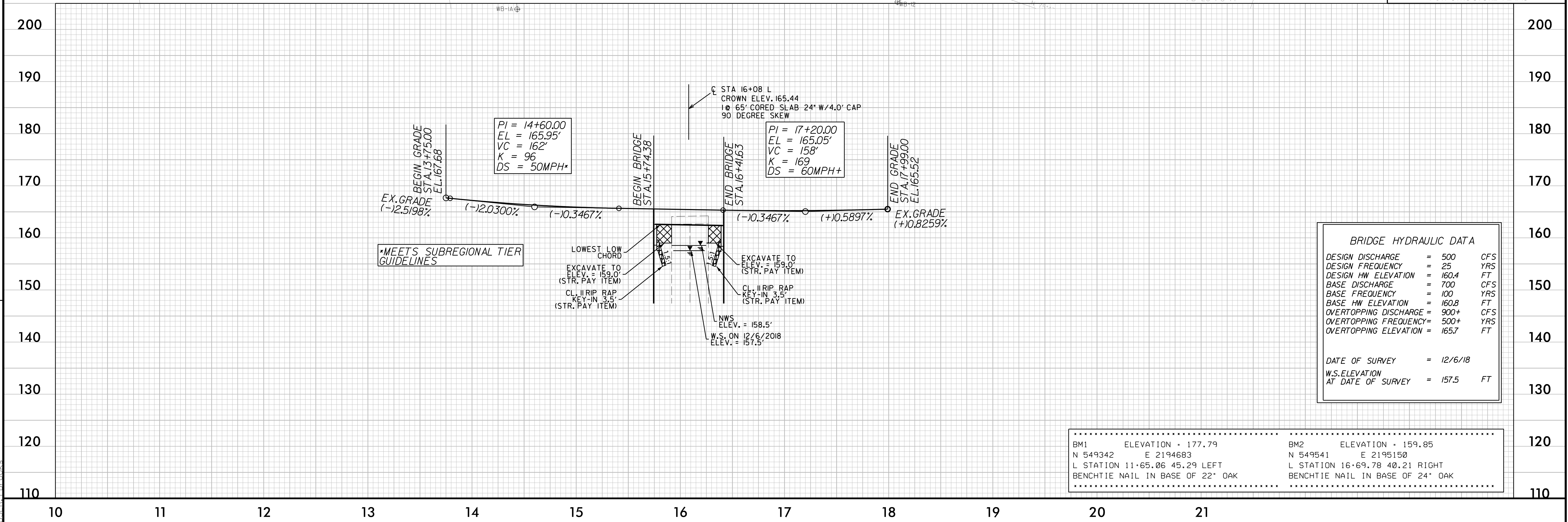

11/18/2019
R:\Position Control\br-0122-EC.fmal.psh.dgn
USER: FHC