

8/17/19

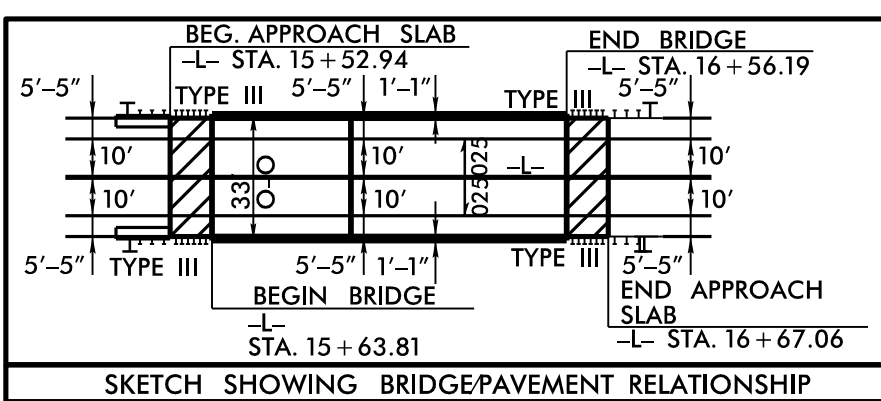
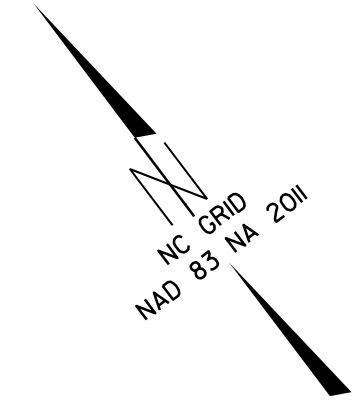

DWIGHT A. KING
DB 2458 PG 319

NOTE:
BEGIN S/BG
STA. 15+38.81 LT. & RT.
END S/BG
STA. 15+52.94 LT. & RT.

1223 Jones Franklin Rd.
Raleigh, N.C. 27606
License No. F-0377
Bus: 919 851 8077
Fax: 919 851 8107

ETHERILL
ENGINEERING

TRANSPORTATION PLANNING/DESIGN - BRIDGE/STRUCTURE DESIGN
CIVIL/SITE DESIGN - GIS/GPS - CONSTRUCTION OBSERVATION

MARTHA LANE
DB 931 PG 40

PI Sta 19+84.36
 $\Delta = 7' 18'' 32.2'' (LT)$
 $D = 2' 20'' 48.7''$
 $L = 311.44'$
 $T = 155.93'$
 $R = 2,441.38'$
 $DS = 55MPH$
 $SE = SEE PLANS$

PROJECT REFERENCE NO. BR-0113	SHEET NO. 4
RW SHEET NO.	HYDRAULICS ENGINEER
ROADWAY DESIGN ENGINEER	4/23/2020
<p>DOCUMENT NOT CONSIDERED FINAL UNLESS ALL SIGNATURES COMPLETED</p>	

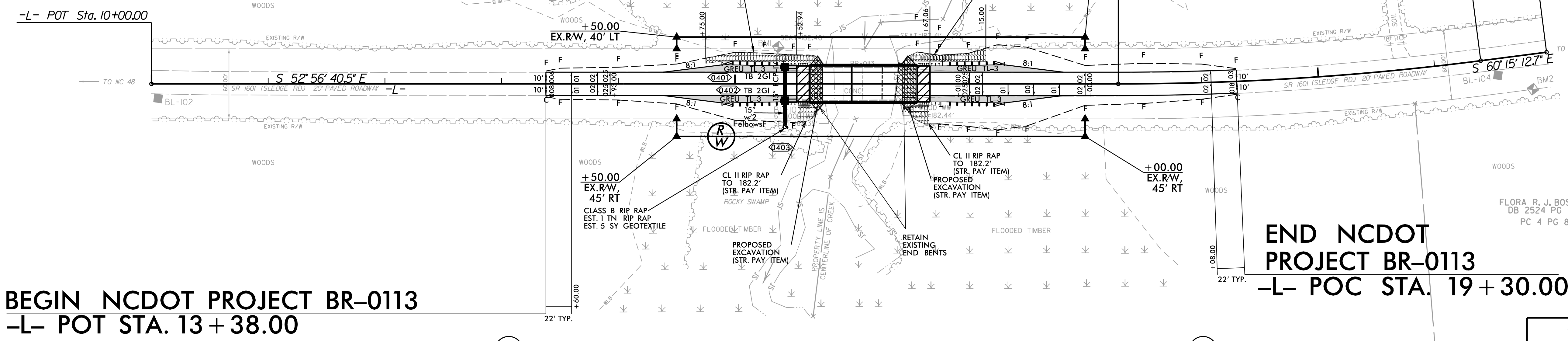

BEGIN NCDOT PROJECT BR-0113
-L- POT STA. 13 + 38.00

END NCDOT PROJECT BR-0113
-L- POC STA. 19 + 30.00

PHENIOUS SMITH
DB 2140 PG 143

PRINCE ALBERT CARROLL
DB 2446 PG 427

SEE RSD 275.01 FOR
ROCK PLATING

SEE SHEETS S-1 THRU S-18
FOR STRUCTURE PLANS

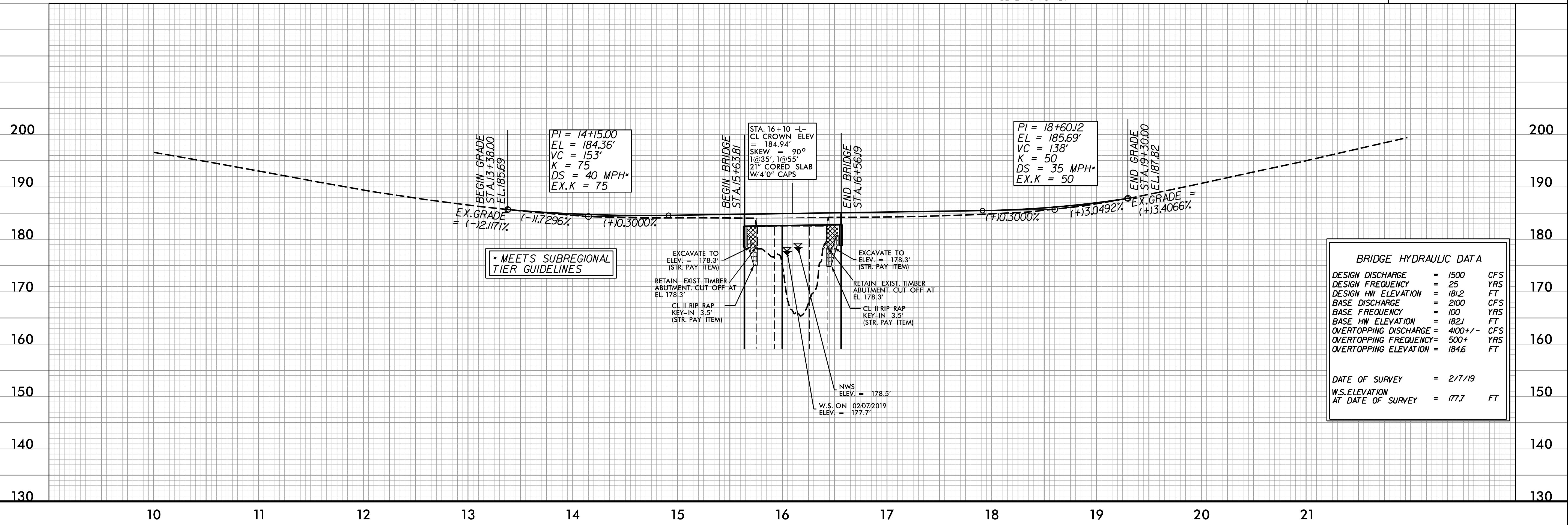

REVISIONS

4/22/2020
11:58:13 AM
C:\p\0113_rdy_psh.dgn