

STATE OF NORTH CAROLINA
DIVISION OF HIGHWAYS

TRANSPORTATION MANAGEMENT PLAN

WILKES COUNTY

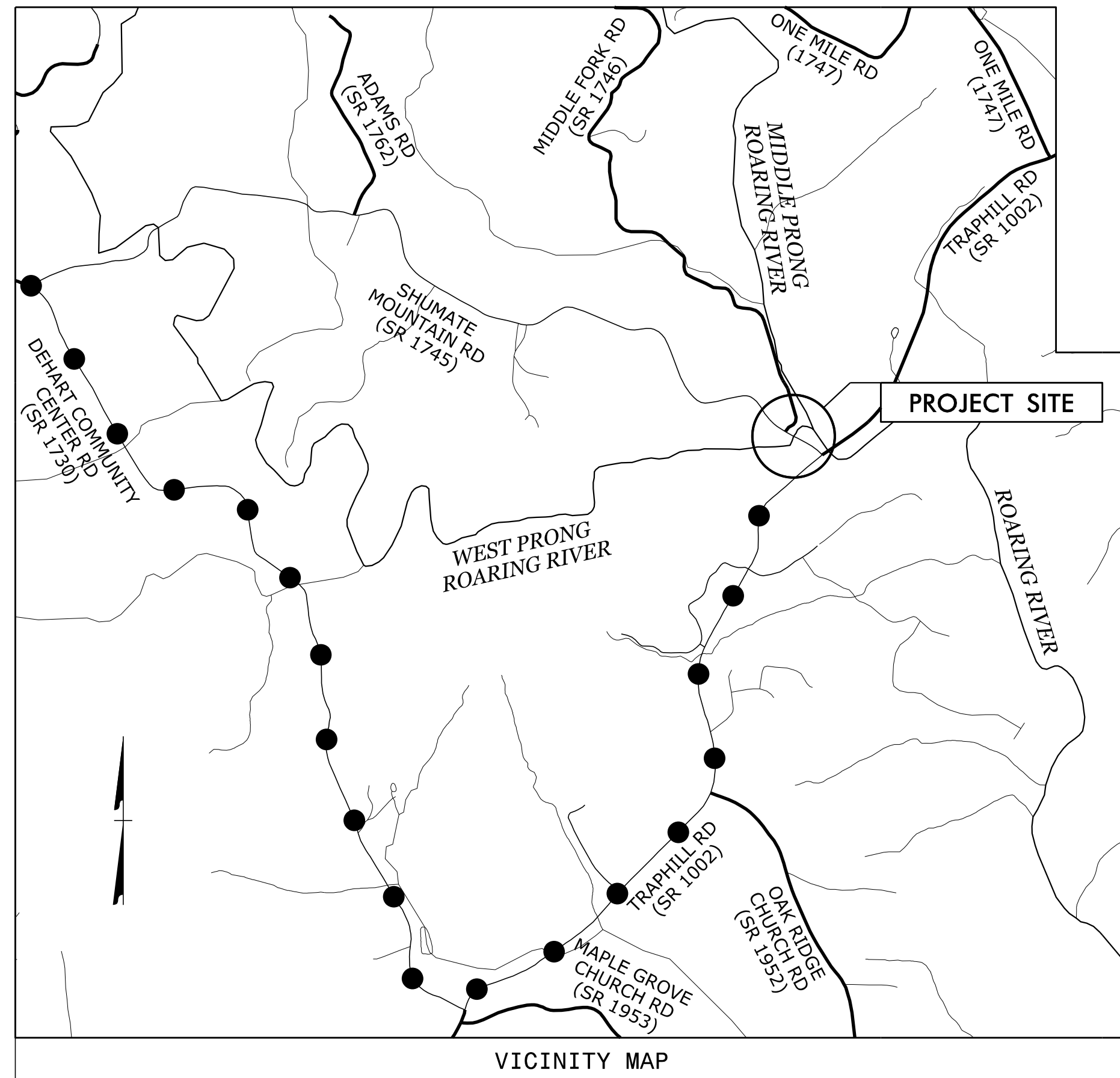
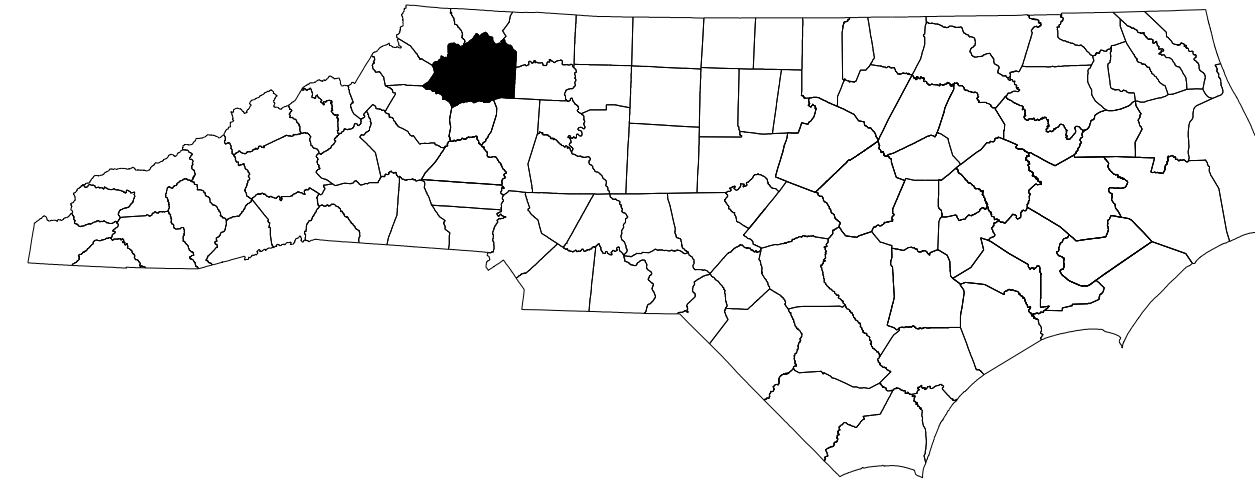

LOCATION: BRIDGE 166 OVER WEST PRONG ROARING RIVER
ON SR 1745 (SHUMATE MOUNTAIN ROAD)

● ● ● ● OFFSITE DETOUR ROUTE

INDEX OF SHEETS

SHEET NO.	TITLE
TMP-1	TITLE SHEET, VICINITY MAP, AND INDEX OF SHEETS
TMP-1A	LIST OF APPLICABLE ROADWAY STANDARD DRAWINGS, AND LEGEND
TMP-1B	TRANSPORTATION OPERATIONS PLAN: (MANAGEMENT STRATEGIES, GENERAL NOTES, AND LOCAL NOTES)
TMP-2	CLOSURE AND OFFSITE DETOUR ROUTE
TMP-3	SPECIAL SIGN DESIGN

SHEET NO.
TMP-1

BR-0124

TIP PROJECT:

11/5/2020 p:\ncdot-pw\bentley\com\ncdot-pw-01\Documents\BR-0124\Work Zone Traffic Control\CADD\BR-0124-TC-TMP-01 User: mackillu

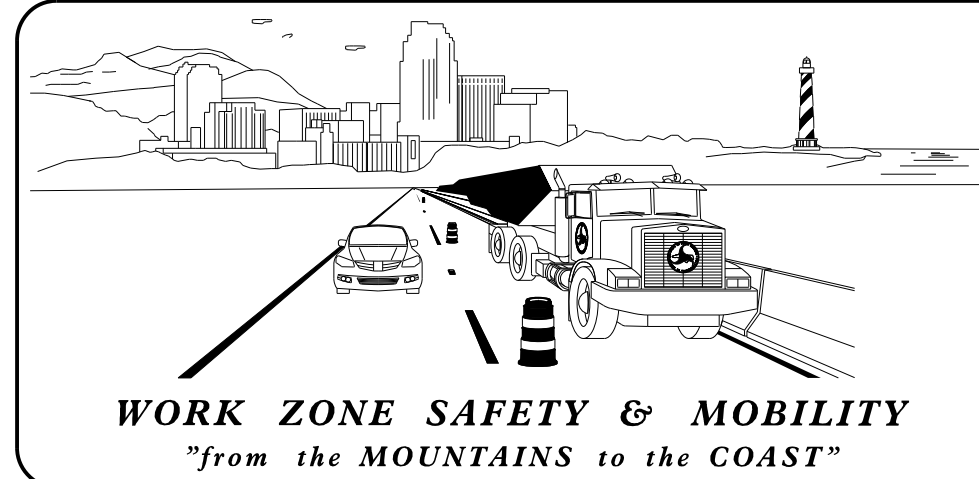

PLANS PREPARED BY:

M. A. AKLILU

NCDOT CONTACTS:

DON PARKER, P.E.
PROJECT ENGINEER

KARMEN DAIS, P.E.
PROJECT DESIGN ENGINEER

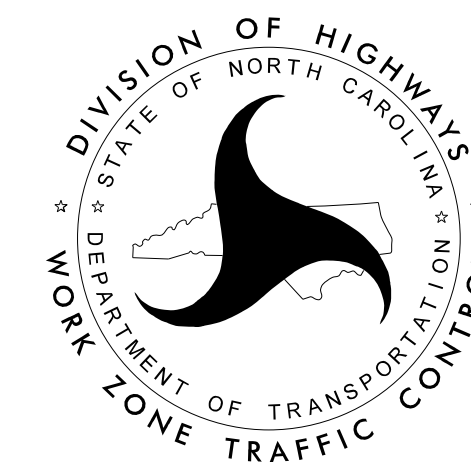

DOCUMENT NOT CONSIDERED FINAL
UNLESS ALL SIGNATURES COMPLETED

APPROVED: 

DATE: 11/9/2020

SEAL



ROADWAY STANDARD DRAWINGS

THE FOLLOWING ROADWAY STANDARDS AS SHOWN IN "ROADWAY STANDARD DRAWINGS" - N.C. DEPARTMENT OF TRANSPORTATION - RALEIGH, N.C., DATED JANUARY 2018 ARE APPLICABLE TO THIS PROJECT AND BY REFERENCE HEREBY ARE CONSIDERED A PART OF THESE PLANS:

STD. NO.	TITLE
1101.01	WORK ZONE WARNING SIGNS
1101.02	TEMPORARY LANE CLOSURES
1101.03	TEMPORARY ROAD CLOSURES
1101.04	TEMPORARY SHOULDER CLOSURES
1101.05	WORK ZONE VEHICLE ACCESSES
1101.06	WARNING SIGNS FOR BLASTING ZONES
1101.11	TRAFFIC CONTROL DESIGN TABLES
1110.01	STATIONARY WORK ZONE SIGNS
1110.02	PORTABLE WORK ZONE SIGNS
1115.01	FLASHING ARROW BOARDS
1130.01	DRUMS
1135.01	CONES
1145.01	BARRICADES
1150.01	FLAGGING DEVICES
1160.01	TEMPORARY CRASH CUSHION
1165.01	TRUCK MOUNTED ATTENUATOR
1170.01	PORTABLE CONCRETE BARRIER
1180.01	SKINNY - DRUMS
1205.01	PAVEMENT MARKINGS - LINE TYPES AND OFFSETS
1205.02	PAVEMENT MARKINGS - TWO LANE AND MULTILANE ROADWAYS
1205.03	PAVEMENT MARKINGS - EXITS AND ENTRANCE RAMP
1205.04	PAVEMENT MARKINGS - INTERSECTIONS
1205.05	PAVEMENT MARKINGS - TURN LANES
1205.06	PAVEMENT MARKINGS - LANE DROPS
1205.07	PAVEMENT MARKINGS - PEDESTRIAN CROSSWALKS
1205.08	PAVEMENT MARKINGS - SYMBOLS AND WORD MESSAGES
1205.09	PAVEMENT MARKINGS - PAINTED ISLANDS
1205.10	PAVEMENT MARKINGS - SCHOOL AREAS
1205.11	PAVEMENT MARKINGS - RAILROAD CROSSINGS
1205.12	PAVEMENT MARKINGS - BRIDGES
1205.13	PAVEMENT MARKINGS - LANE REDUCTIONS
1205.14	PAVEMENT MARKINGS - ROUNDABOUTS
1205.15	PAVEMENT MARKINGS - SUPERSTREETS
1250.01	RAISED PAVEMENT MARKERS - INSTALLATION SPACING
1251.01	RAISED PAVEMENT MARKERS - (PERMANENT AND TEMPORARY)
1261.01	GUARDRAIL AND BARRIER DELINEATORS - INSTALLATION SPACING
1261.02	GUARDRAIL AND BARRIER DELINEATORS - TYPES AND MOUNTING
1262.01	GUARDRAIL END DELINEATION
1264.01	OBJECT MARKERS - TYPES
1264.02	OBJECT MARKERS - INSTALLATION

LEGEND

GENERAL

- DIRECTION OF TRAFFIC FLOW
- DIRECTION OF PEDESTRIAN TRAFFIC FLOW
- EXIST. PVMT.
- NORTH ARROW
- PROPOSED PVMT.
- TEMP. SHORING (LOCATION PURPOSES ONLY)
- WORK AREA
- REMOVAL

SIGNALS

- EXISTING
- PROPOSED
- TEMPORARY

PAVEMENT MARKINGS

- EXISTING LINES
- TEMPORARY LINES

TRAFFIC CONTROL DEVICES

- BARRICADE (TYPE III)
- CONE
- DRUM
- SKINNY DRUM
- TUBULAR MARKER
- TEMPORARY CRASH CUSHION
- FLASHING ARROW BOARD
- FLAGGER
- LAW ENFORCEMENT
- TRUCK MOUNTED ATTENUATOR (TMA)
- CHANGEABLE MESSAGE SIGN

TEMPORARY SIGNING

- PORTABLE SIGN
- STATIONARY SIGN
- STATIONARY OR PORTABLE SIGN

PAVEMENT MARKERS

- CRYSTAL/CRYSTAL
- CRYSTAL/RED
- YELLOW/YELLOW

PAVEMENT MARKING SYMBOLS

- PAVEMENT MARKING SYMBOLS

11/5/2020 11:52:00 AM pw:\ncdot\pw.bentley.com\ncdot\pw-01\Documents\BR-0124\Work Zone Traffic Control\CADD\BR-0124-TC-TMP-1A User:tmackill

APPROVED: DATE: 11/9/2020 SEAL			ROADWAY STANDARD DRAWINGS & LEGEND
DOCUMENT NOT CONSIDERED FINAL UNLESS ALL SIGNATURES COMPLETED			

MANAGEMENT STRATEGIES

TRAFFIC WILL BE DETOURED OFF-SITE DURING THE CONSTRUCTION PERIOD.

THE OFF-SITE DETOUR WILL INCLUDE TRAPHILL RD. (SR 1002),
DEHART COMMUNITY CENTER RD. (SR 1730).

GENERAL NOTES / LOCAL NOTES

CHANGES MAY BE REQUIRED WHEN PHYSICAL DIMENSIONS IN THE DETAIL DRAWINGS, STANDARD DETAILS, AND ROADWAY DETAILS ARE NOT ATTAINABLE TO MEET FIELD CONDITIONS OR RESULT IN DUPLICATE OR UNDESIRE OVERLAPPING OF DEVICES. MODIFICATION MAY INCLUDE: MOVING, SUPPLEMENTING, COVERING, OR REMOVAL OF DEVICES AS DIRECTED BY THE ENGINEER.

THE FOLLOWING GENERAL NOTES APPLY AT ALL TIMES FOR THE DURATION OF THE CONSTRUCTION PROJECT EXCEPT WHEN OTHERWISE NOTED IN THE PLAN OR DIRECTED BY THE ENGINEER.

TRAFFIC PATTERN ALTERATIONS

- A) NOTIFY THE ENGINEER THIRTY (30) CALENDAR DAYS PRIOR TO ANY TRAFFIC PATTERN ALTERATION.

SIGNING

- B) PROVIDE SIGNING AND DEVICES REQUIRED TO CLOSE THE ROAD ACCORDING TO THE ROADWAY STANDARD DRAWINGS AND TRAFFIC CONTROL PLANS.

PROVIDE SIGNING REQUIRED FOR THE OFF-SITE DETOUR ROUTE AS SHOWN IN THE TRAFFIC CONTROL PLANS.

- C) COVER OR REMOVE ALL SIGNS AND DEVICES REQUIRED TO CLOSE THE ROAD WHEN ROAD CLOSURE IS NOT IN OPERATION.

COVER OR REMOVE ALL SIGNS REQUIRED FOR THE OFF-SITE DETOUR WHEN THE DETOUR IS NOT IN OPERATION.

- D) ENSURE ALL NECESSARY SIGNING IS IN PLACE PRIOR TO ALTERING ANY TRAFFIC PATTERN.



TRAFFIC CONTROL DEVICES

- E) PLACE TYPE III BARRICADES, WITH "ROAD CLOSED" SIGN R11-2 ATTACHED, OF SUFFICIENT LENGTH TO CLOSE ENTIRE ROADWAY.

PHASING

- STEP 1. USING ROADWAY STANDARD DRAWINGS 1101.03, SHEETS 1 & 2, AND TMP-2 INSTALL OFFSITE DETOUR SIGNS AND TRAFFIC CONTROL DEVICES AND CLOSE SHUMATE MOUNTAIN ROAD (SR 1745) AND MIDDLE FORK ROAD (SR 1746) TO THROUGH TRAFFIC.
- STEP 2. COMPLETE THE FOLLOWING WITHIN THE ROAD CLOSURE:
 - A) REMOVE THE EXISTING BRIDGE.
 - B) CONSTRUCT THE PROPOSED BRIDGE AND ROADWAY APPROACHES INCLUDING THE FINAL LAYER OF SURFACE COURSE AND FINAL PAVEMENT MARKINGS.
- STEP 3. REMOVE ALL TRAFFIC CONTROL DEVICES AND DETOUR SIGNS AND OPEN SHUMATE MOUNTAIN ROAD (SR 1745) AND MIDDLE FORK ROAD (SR 1746) TO THROUGH TRAFFIC.

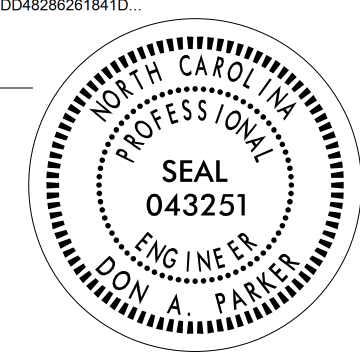
11/5/2020
pw:\ncdot-pw-bentley.com\ncdot-pw-01\Documents\BR-0124\Work Zone Traffic Control\CADD\BR-0124-TC-TMP-1B
User:mackillu

APPROVED: Don A. Parker <small>11/9/2020</small> DATE:	SEAL 		<h3 style="margin: 0;">TRANSPORTATION OPERATIONS PLAN</h3>
DOCUMENT NOT CONSIDERED FINAL UNLESS ALL SIGNATURES COMPLETED			

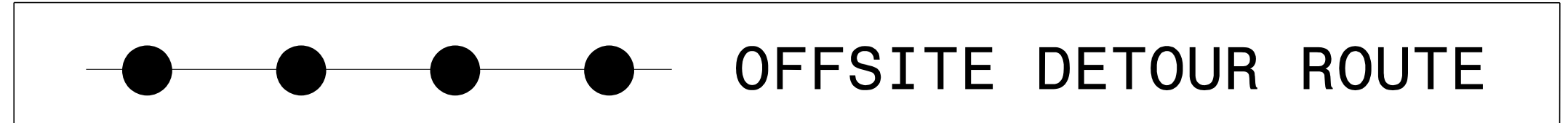
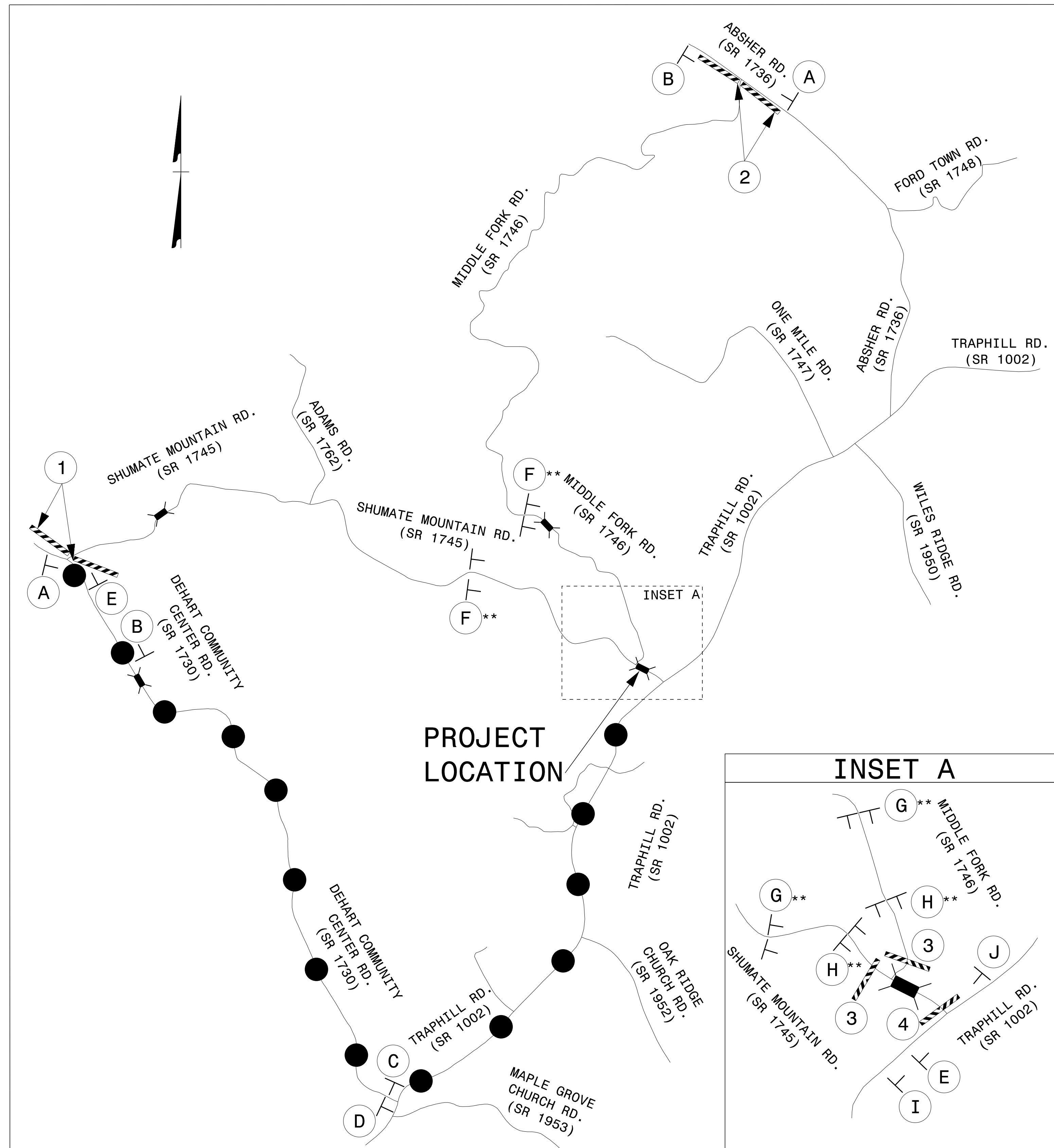

** REFER TO RSD 1101.03, SHEETS 1 & 2, FOR WORK ZONE SIGN SPACING, REQUIRED ALONG SHUMATE MOUNTAIN RD AND MIDDLE FORK RD **

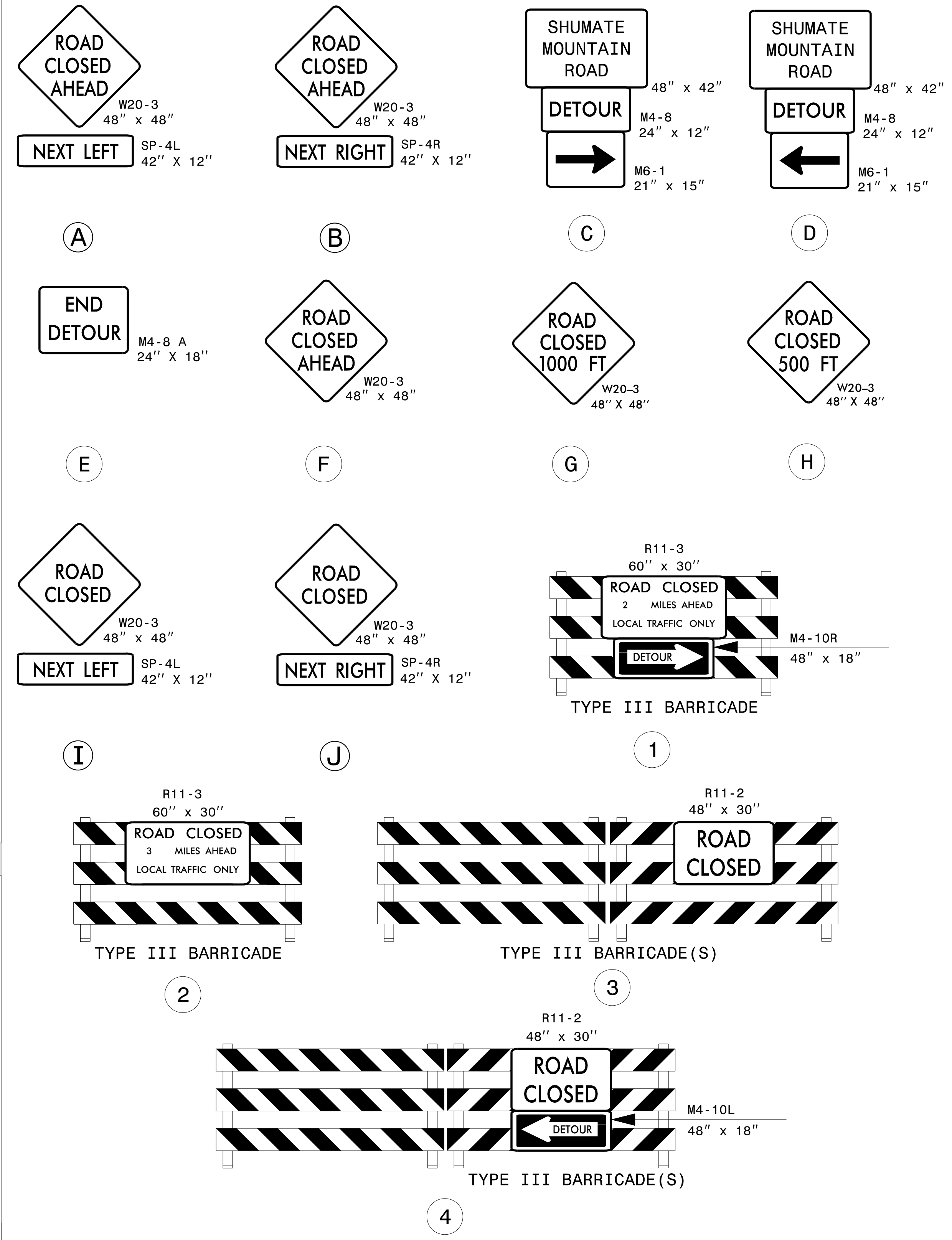

11/5/2020 pw:\ncdot-pw\bentley.com\ncdot-pw-01\Documents\BR-0124\Work Zone Traffic Control\CADD\BR-0124-TC-TMP-02 User:mackillu

APPROVED: DATE: 11/9/2020 SEAL:		OFFSITE DETOUR ROUTE AND ROAD CLOSURE
DOCUMENT NOT CONSIDERED FINAL UNLESS ALL SIGNATURES COMPLETED		

SIGN NUMBER: WZTC
 TYPE: STATIONARY
 QUANTITY: SEE PLANS

BACKG COLOR: Fluorescent Orange
 COPY COLOR: Black

DESIGN BY: J.Navarrete
 PROJECT ID: BR-0124

CHECKED BY:
 LOCATION:

Apr 07, 2020
 DIV:WZTC

SIGN WIDTH: 4'-0"
 HEIGHT: 3'-6"
 TOTAL AREA: 14.0 Sq.Ft.

SYMBOL	X	Y	WID	HT

BORDER TYPE: INSET
 RECESS: 0.75"
 WIDTH: 1.25"
 RADII: 3"

MAT'L: 0.080" (2.0 mm) ALUMINUM

NO. Z BARS:
 LENGTH:

USE NOTES: 1,2

- Legend and border shall be direct applied black non-reflective sheeting.
- Background shall be NC GRADE B fluorescent orange retroreflective sheeting.



BORDER
 R=3"
 TH=1.25"
 IN=0.75"

Spacing Factor is 1 unless specified otherwise

LETTER POSITIONS

Letter spacings are to start of next letter										Series/Size	
										Text Length	
	S	H	U	M	A	T	E				C 2000
9.1	4.4	4.7	4.7	4.8	4.2	3.9	3.1	9.2			29.7
	M	O	U	N	T	A	I	N			C 2000
7.8	5.2	4.7	4.7	4.2	3.4	4.7	2.2	3.4	7.8		32.4
	R	O	A	D							C 2000
15.7	4.3	4.3	4.7	3.4	15.7						16.6

FILENAME: BR-0042 Shumate Mountain Rd

NORTH CAROLINA D.O.T. SIGN DETAIL

11/5/2020
 pw:\ncdot-pw\benfley.com\ncdot-pw-01\Documents\BR-0124\Work Zone Traffic Control\CADD\BR-0124-TC-TMP-03
 User:mackillu

APPROVED: *Renee B. Roach*
 DATE: 11/9/2020

DOCUMENT NOT CONSIDERED FINAL
 UNLESS ALL SIGNATURES COMPLETED



SPECIAL SIGN
 DESIGN