

PROJ. REFERENCE NO.	SHEET NO.
BR-0115	X-0

## STATE OF NORTH CAROLINA DIVISION OF HIGHWAYS

NOTE: EMBANKMENT COLUMN DOES NOT INCLUDE BACKFILL FOR UNDERCUT

### CROSS-SECTION SUMMARY

Station	Uncl. Exc. (cu. yd.)	Embt (cu. yd.)																	
<b>L</b>																			
11+50.00	0	0																	
12+00.00	1	2																	
12+50.00	2	7																	
13+00.00	4	25																	
13+50.00	75	53																	
14+00.00	84	96																	
14+50.00	11	159																	
15+00.00	0	270																	
<b>L</b>																			
16+50.00	0	0																	
17+00.00	8	141																	
17+50.00	5	49																	
18+00.00	0	7																	
18+50.00	0	2																	
<b>DR1</b>																			
10+13.43	0	0																	
10+25.00	0	41																	
10+50.00	0	81																	
10+75.00	0	59																	
11+00.00	1	33																	
11+20.00	1	8																	

**Quantities are approximate only. The Resident Engineer will recross-section the work accurately when the project is staked out. These cross-section notes will be used in computing the final quantities for which the contractor will be paid.**

**Approximate quantities only. Unclassified excavation, borrow excavation, fine grading, clearing and grubbing, breaking of existing pavement and removal of existing pavement will be paid for at the lump sum price for "Grading".**

6/23/16

0 2.5 5	PROJ. REFERENCE NO. BR-0115	SHEET NO. X-1
---------	--------------------------------	------------------

75 70 65 60 55 50 45 40 35 30 25 20 15 10 5 0 5 10 15 20 25 30 35 40 45 50 55 60 65 70 75

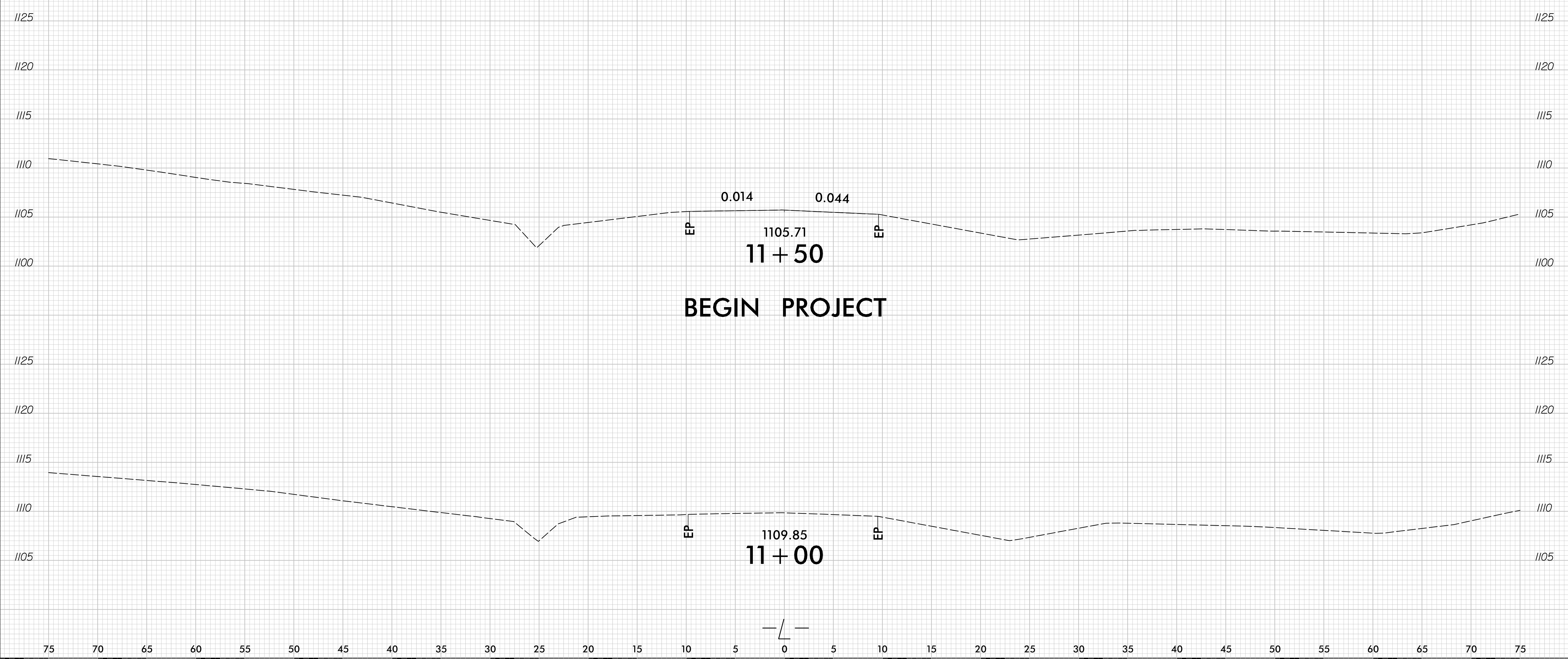

11/9/2020  
F:\Roadway\Corridor-Modeling\BRT0115\_rdy\_L\_xpl.dgn  
Print

6/23/16

0 2.5 5	PROJ. REFERENCE NO. BR-0115	SHEET NO. X-2
---------	--------------------------------	------------------

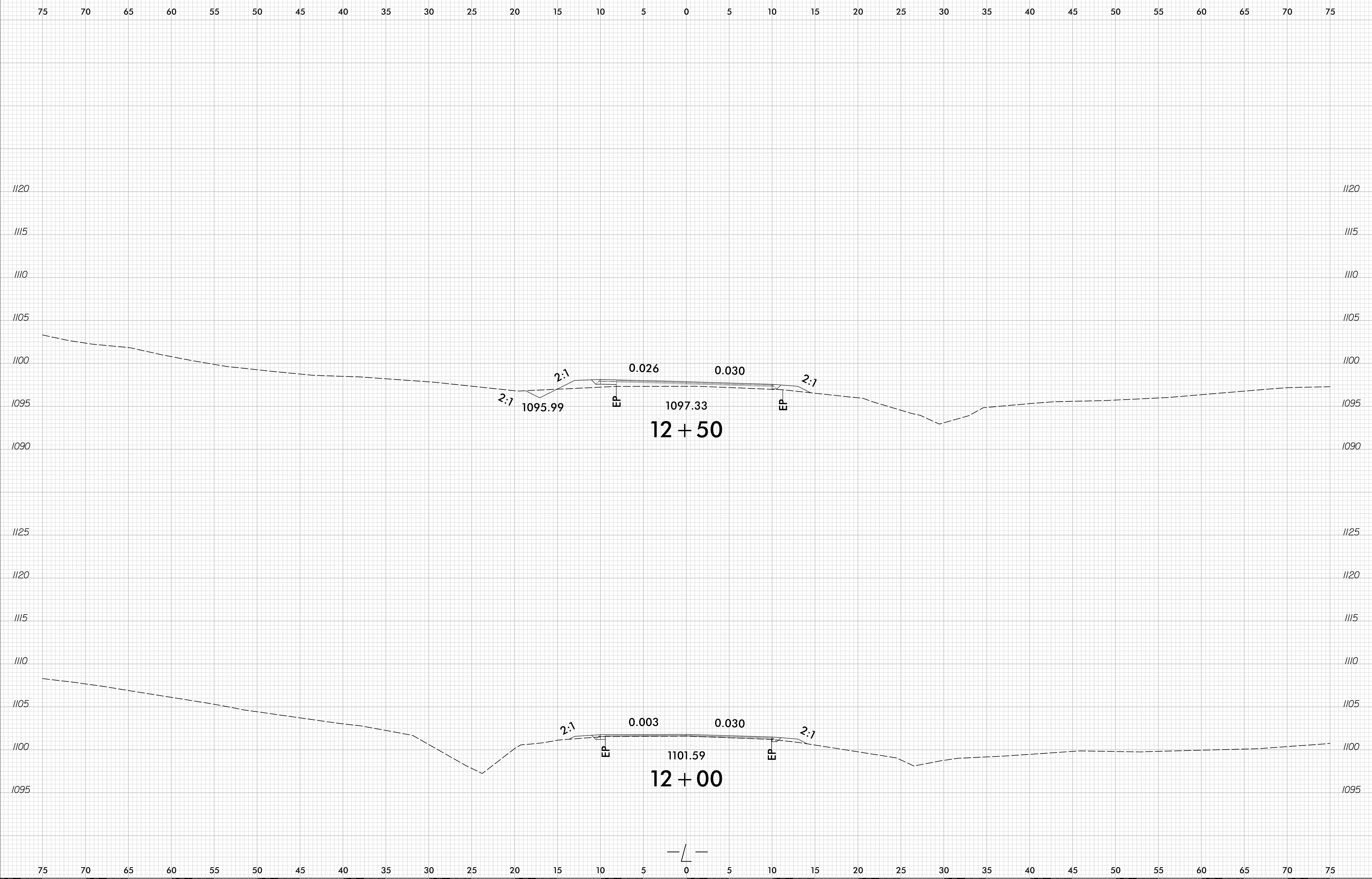

11/9/2020  
F:\Roadway\Corridor-Modeling\B0115\_rdy\_L\_xpl.dgn  
Plan

6/23/16

0 2.5 5	PROJ. REFERENCE NO. BR-0115	SHEET NO. X-3
---------	--------------------------------	------------------

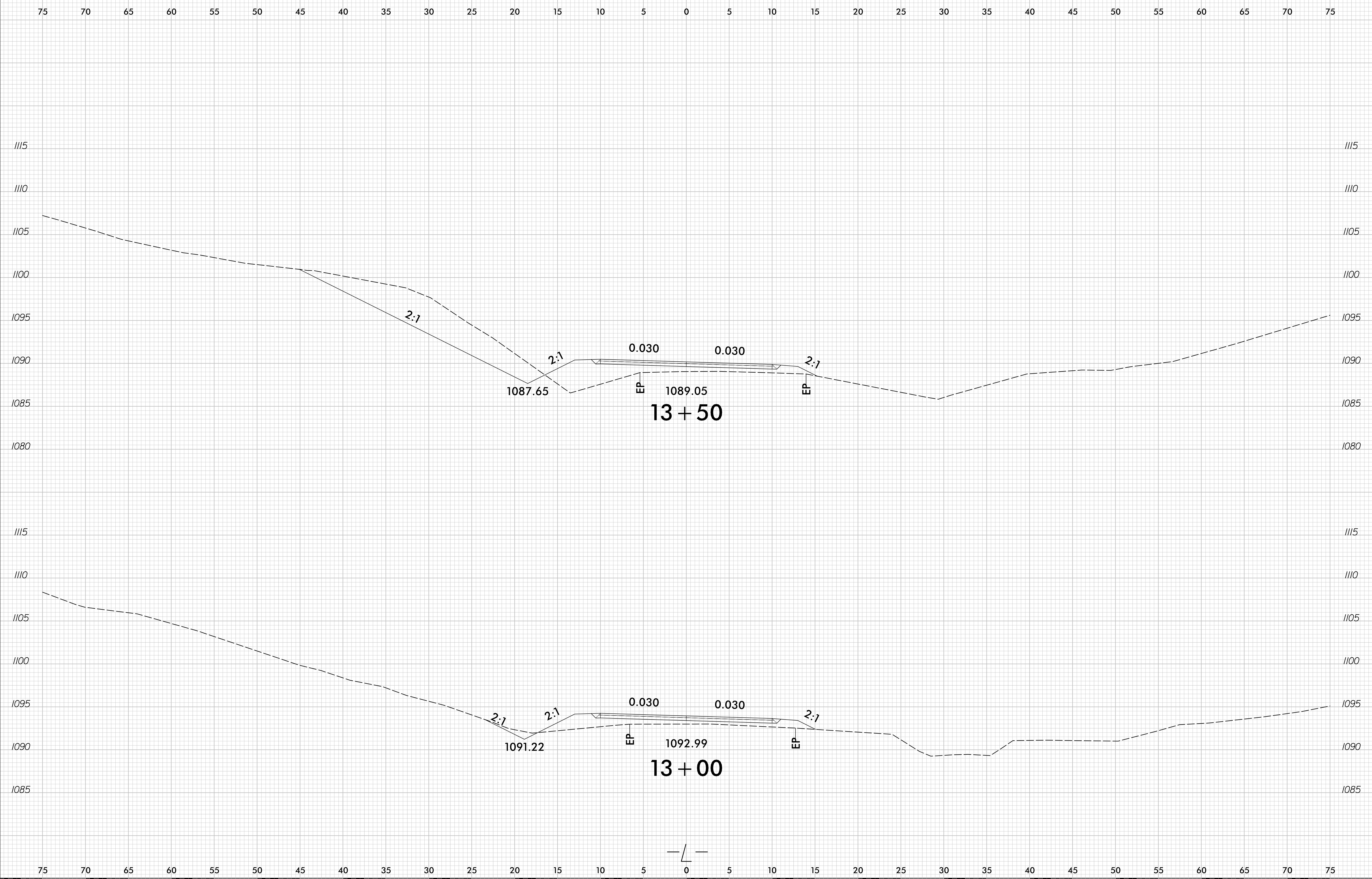

11/9/2020  
F:\Roadway\Corridor-Modeling\BR0115\_rdy\_L\_xpl.dgn  
Print

6/23/16

0 2.5 5	PROJ. REFERENCE NO. BR-0115	SHEET NO. X-4
---------	--------------------------------	------------------

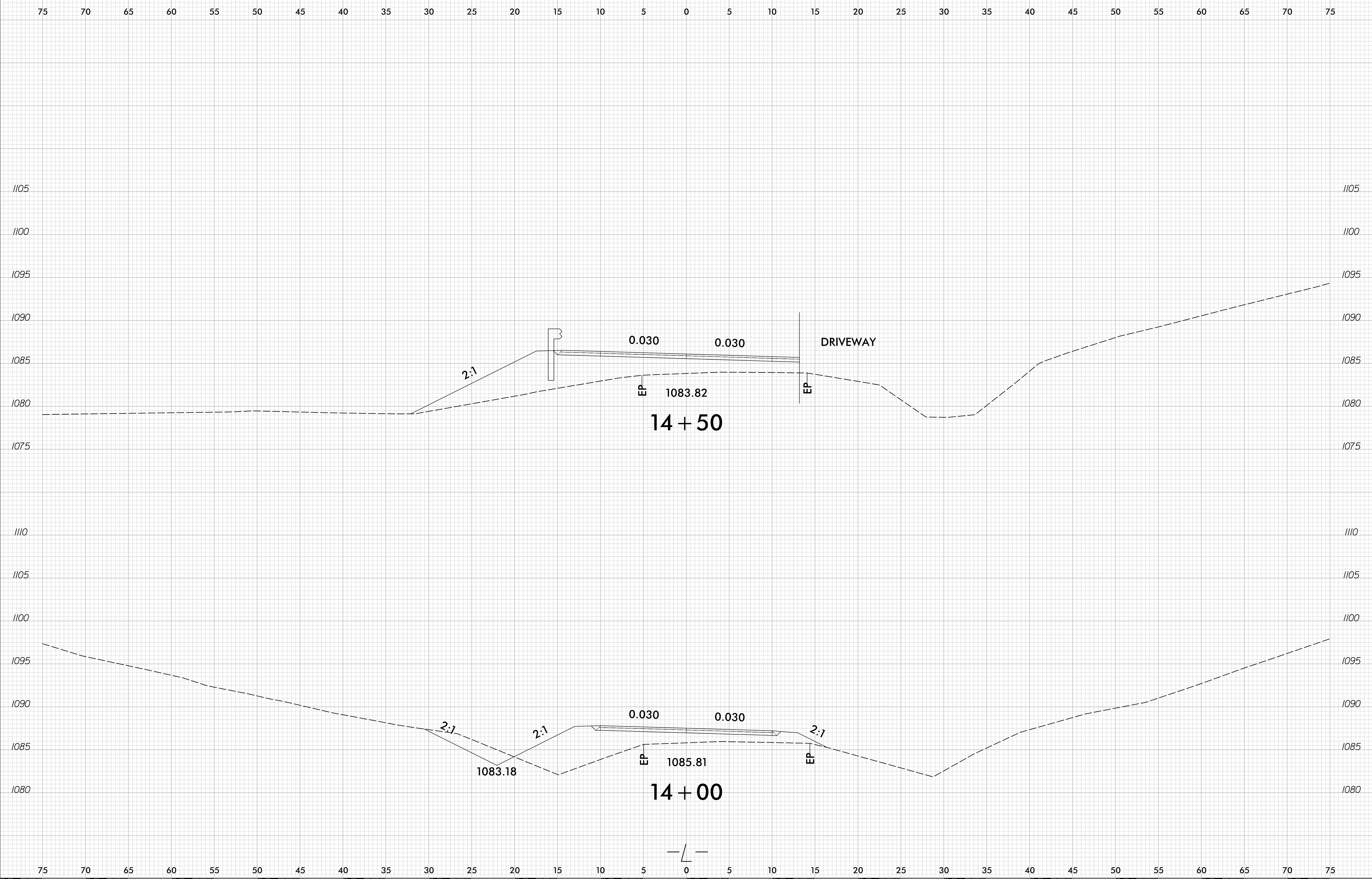

11/9/2020  
F:\Roadway\Corridor-Modeling\BR0115\_rdy\_L\_xpl.dgn

6/23/16

0 2.5 5	PROJ. REFERENCE NO. BR-0115	SHEET NO. X-5
---------	--------------------------------	------------------

75 70 65 60 55 50 45 40 35 30 25 20 15 10 5 0 5 10 15 20 25 30 35 40 45 50 55 60 65 70 75

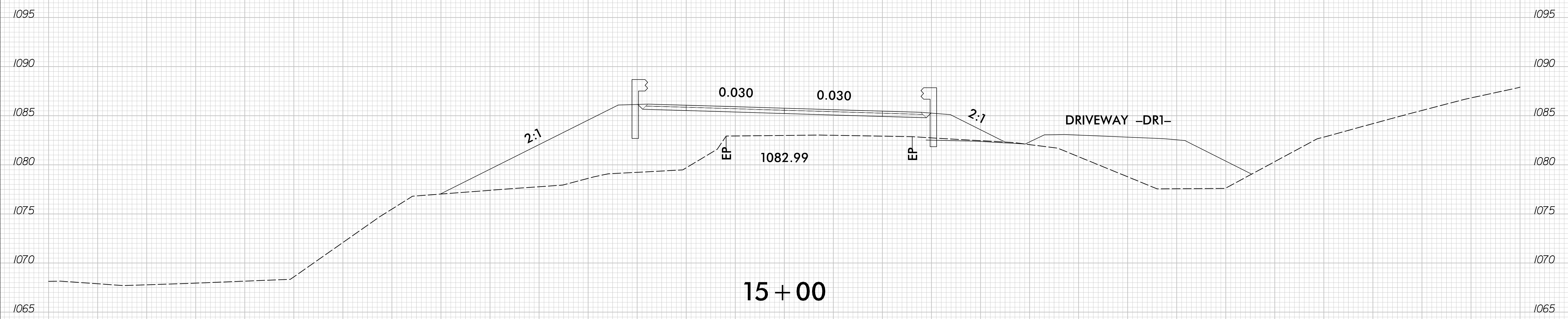
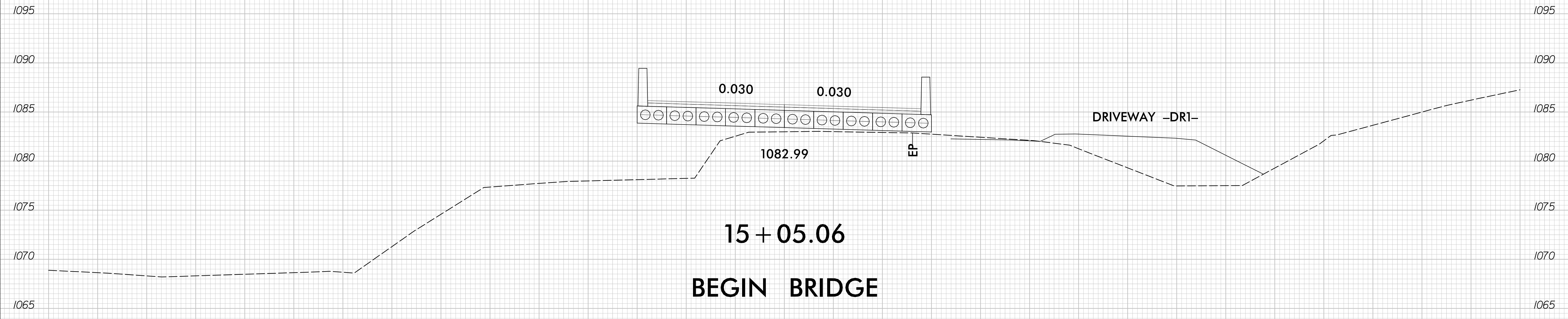

75 70 65 60 55 50 45 40 35 30 25 20 15 10 5 0 5 10 15 20 25 30 35 40 45 50 55 60 65 70 75

11/9/2020  
F:\Roadway\Corridor-Modeling\BR0115\_rdy\_L\_xpl.dgn

6/23/16

0 2.5 5	PROJ. REFERENCE NO. BR-0115	SHEET NO. X-6
---------	--------------------------------	------------------

75 70 65 60 55 50 45 40 35 30 25 20 15 10 5 0 5 10 15 20 25 30 35 40 45 50 55 60 65 70 75

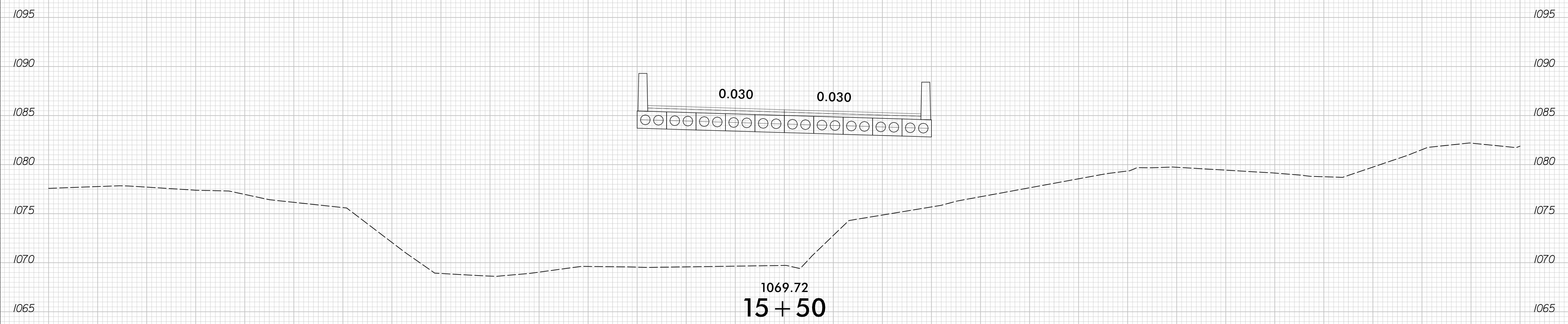
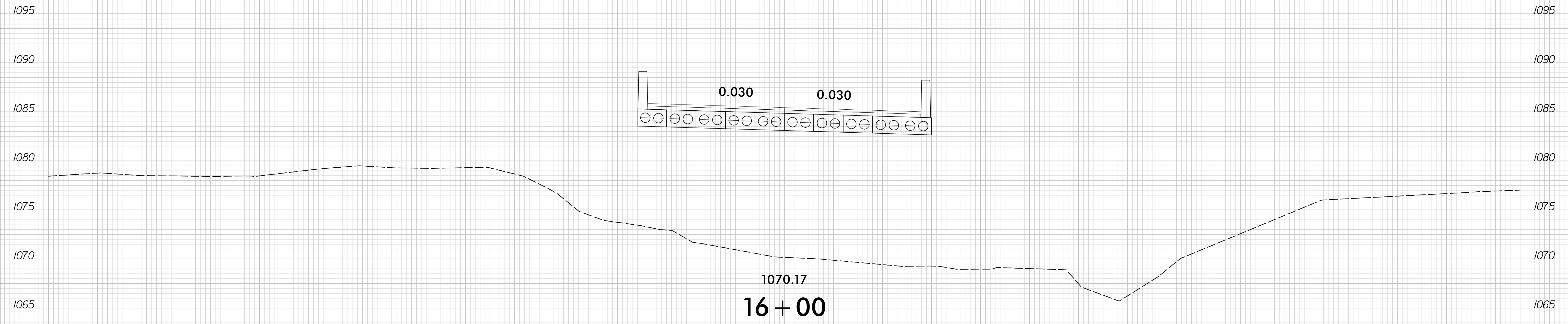

75 70 65 60 55 50 45 40 35 30 25 20 15 10 5 0 5 10 15 20 25 30 35 40 45 50 55 60 65 70 75

11/9/2020  
F:\Roadway\Corridor-Modeling\BR0115\_rdy\_L\_xpl.dgn  
Plot

6/23/16

0 2.5 5	PROJ. REFERENCE NO. BR-0115	SHEET NO. X-7
---------	--------------------------------	------------------

75 70 65 60 55 50 45 40 35 30 25 20 15 10 5 0 5 10 15 20 25 30 35 40 45 50 55 60 65 70 75

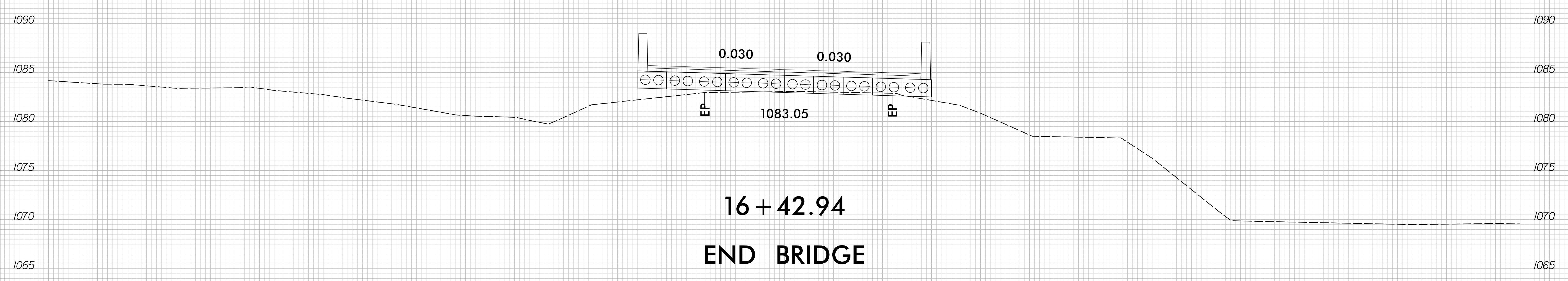
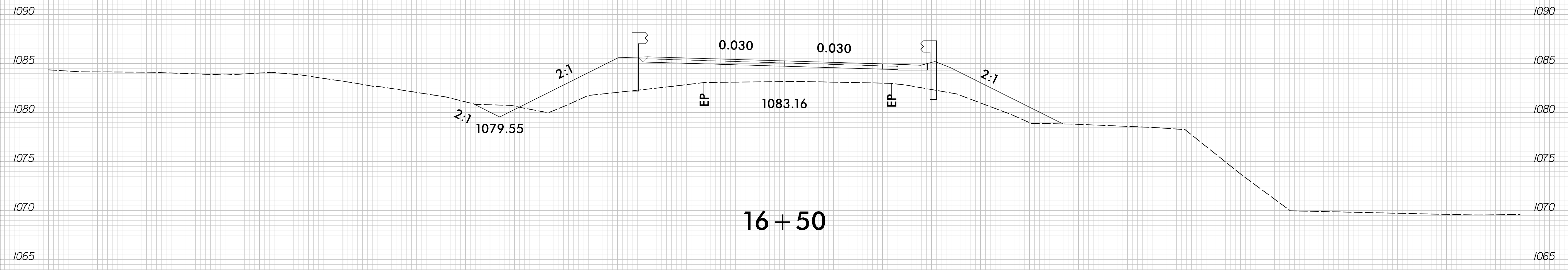

75 70 65 60 55 50 45 40 35 30 25 20 15 10 5 0 5 10 15 20 25 30 35 40 45 50 55 60 65 70 75

11/9/2020  
F:\Roadway\Corridor-Modeling\B0115\_rdy\_L\_xpl.dgn



6/23/16

0 2.5 5	PROJ. REFERENCE NO. BR-0115	SHEET NO. X-8
---------	--------------------------------	------------------

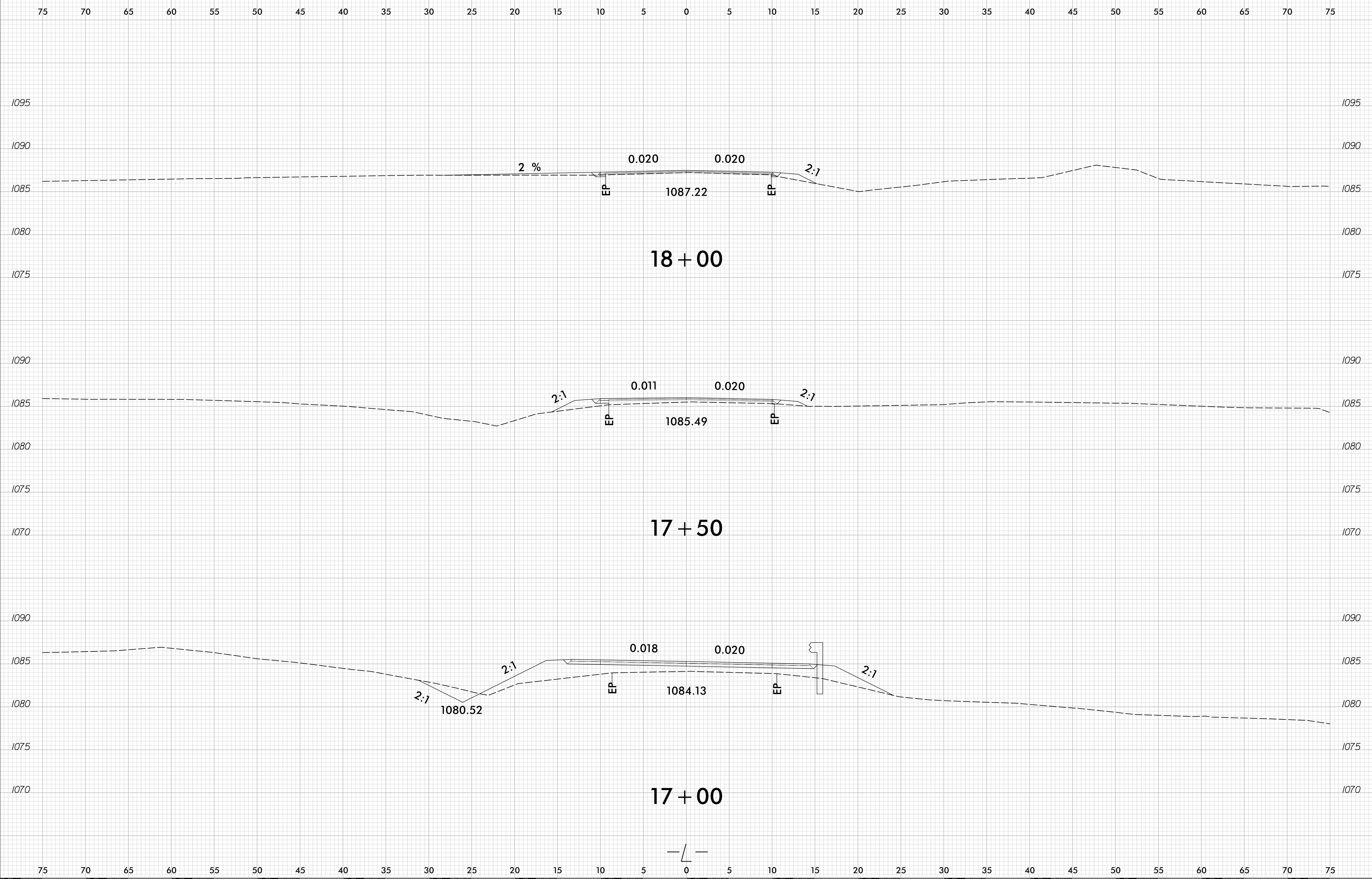

11/9/2020  
F:\Roadway\Corridor-Modeling\BR0115\_rdy\_L\_xpl.dgn  
Print

6/23/16

0 2.5 5	PROJ. REFERENCE NO. BR-0115	SHEET NO. X-9
---------	--------------------------------	------------------

75 70 65 60 55 50 45 40 35 30 25 20 15 10 5 0 5 10 15 20 25 30 35 40 45 50 55 60 65 70 75

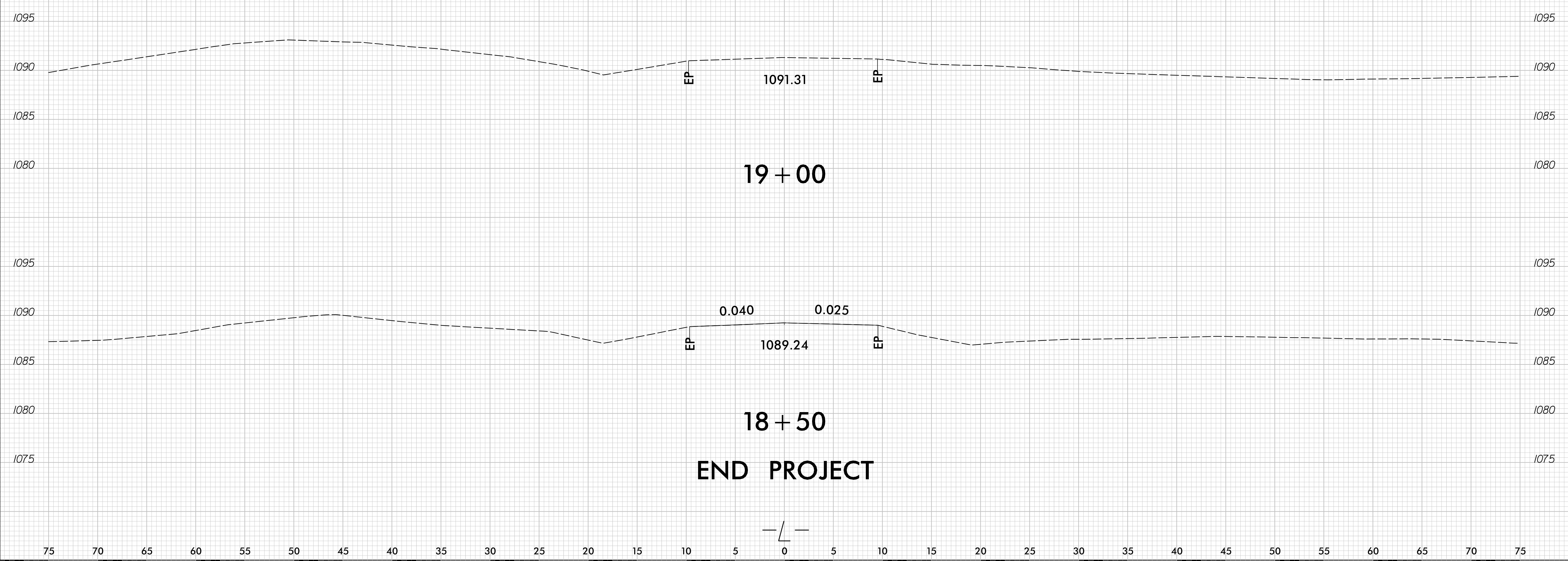

11/9/2020  
F:\Roadway\Corridor-Modeling\BR0115\_rdy\_L\_xpl.dgn  
Print

6/23/16

0 2.5 5	PROJ. REFERENCE NO. BR-0115	SHEET NO. X-10
---------	--------------------------------	-------------------

75 70 65 60 55 50 45 40 35 30 25 20 15 10 5 0 5 10 15 20 25 30 35 40 45 50 55 60 65 70 75

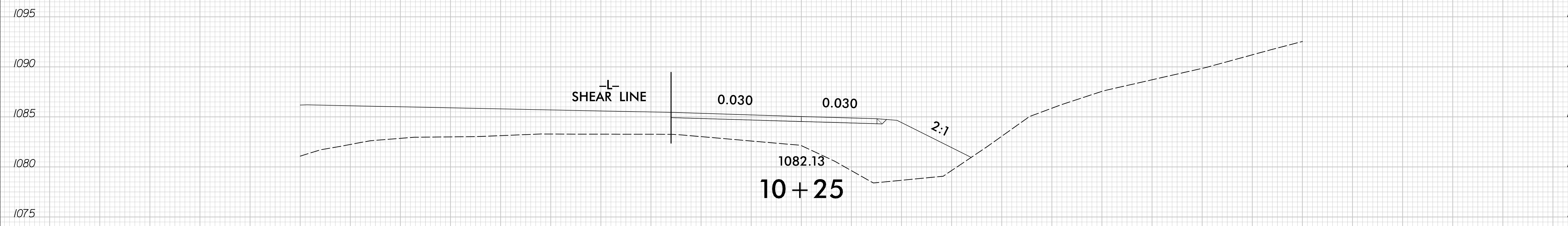
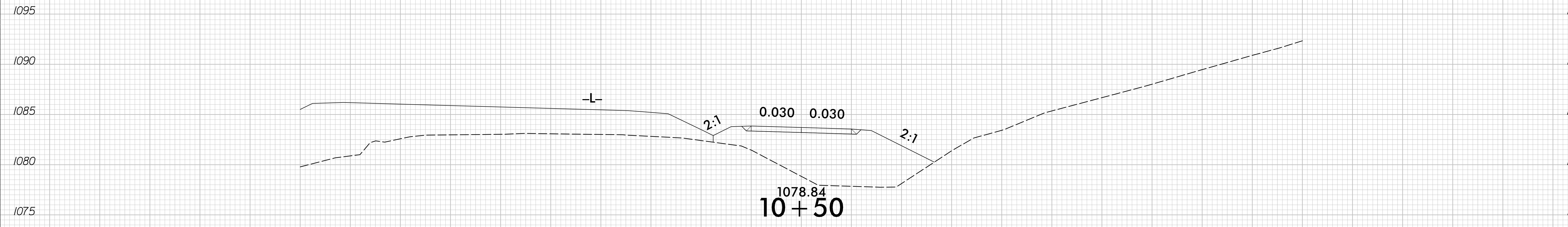

**BEGIN CONSTRUCTION -DRI- STA. 10 + 13.43**

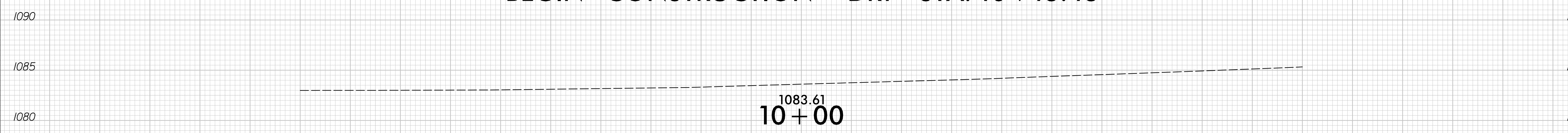

75 70 65 60 55 50 45 40 35 30 25 20 15 10 5 0 5 10 15 20 25 30 35 40 45 50 55 60 65 70 75

11/9/2020  
 F:\Roadway\Corridor-Modeling\B0115\_rdy\_DRI\_xp.dgn  
 Plot

6/23/16

0 2.5 5	PROJ. REFERENCE NO. BR-0115	SHEET NO. X-11
---------	--------------------------------	-------------------

75 70 65 60 55 50 45 40 35 30 25 20 15 10 5 0 5 10 15 20 25 30 35 40 45 50 55 60 65 70 75

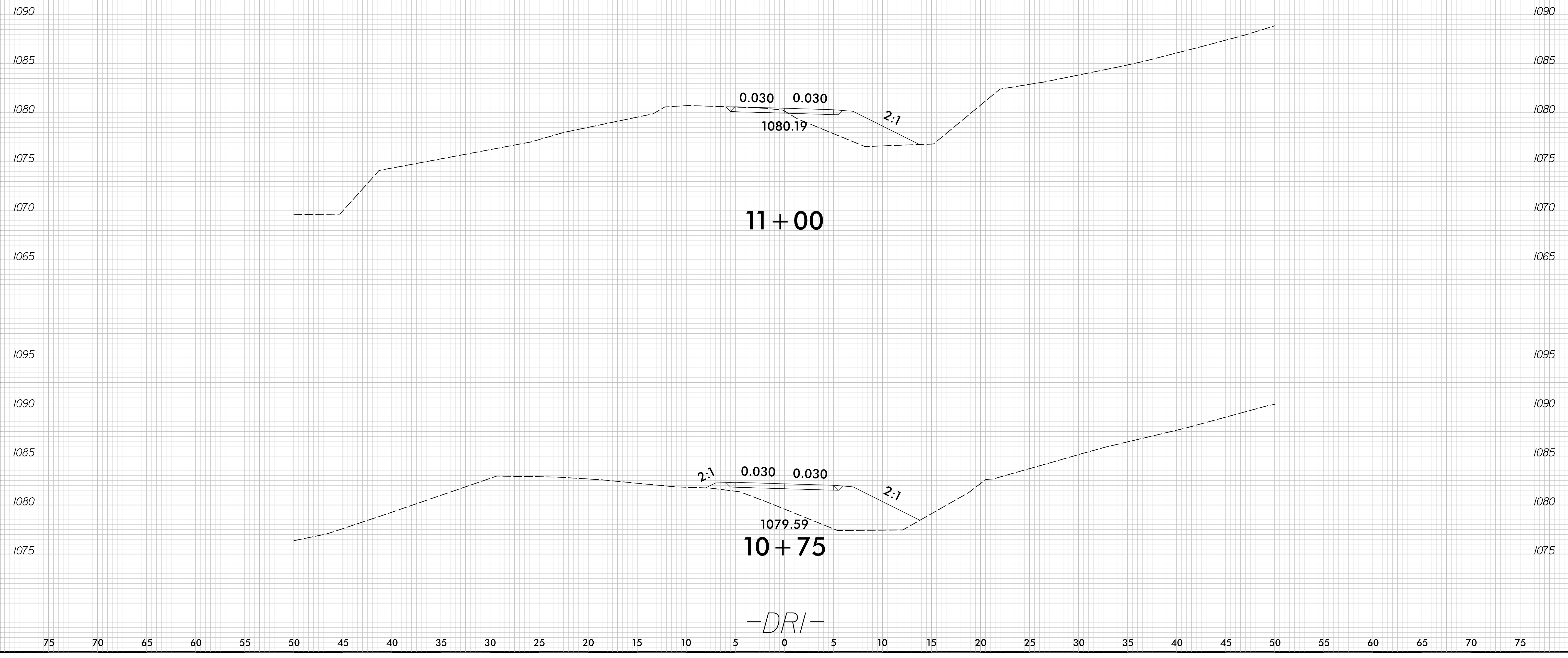

11/9/2020  
F:\Roadway\Corridor-Modeling\BR0115\_rdy\_DRI\_xp1.dgn  
Print

6/23/16

0 2.5 5	PROJ. REFERENCE NO. BR-0115	SHEET NO. X-12
---------	--------------------------------	-------------------

75 70 65 60 55 50 45 40 35 30 25 20 15 10 5 0 5 10 15 20 25 30 35 40 45 50 55 60 65 70 75

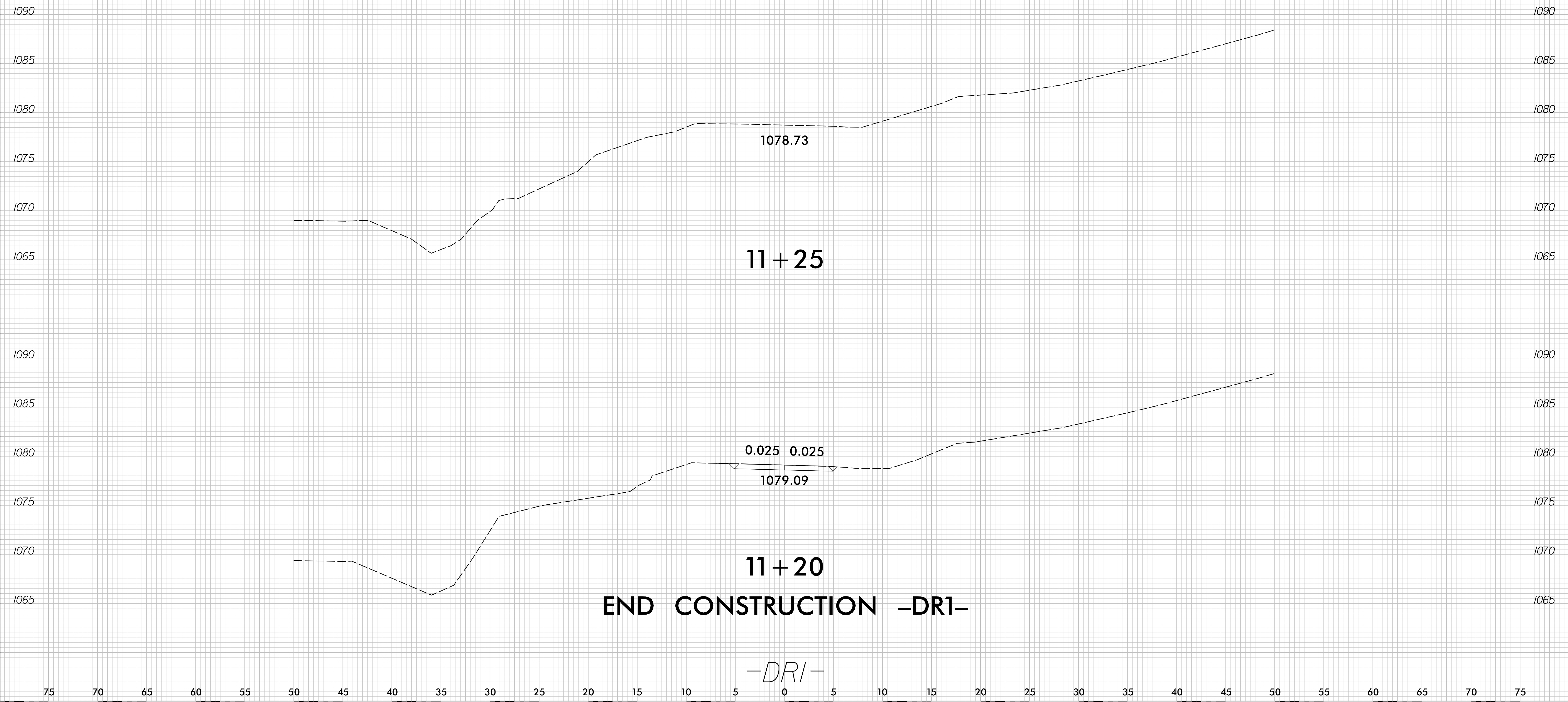

11/9/2020  
F:\Roadway\Corridor-Modeling\B0115\_rdy\_DRI\_xp.dgn

END CONSTRUCTION -DRI-

-DRI-