

STATE OF NORTH CAROLINA DIVISION OF HIGHWAYS

CROSS-SECTION SUMMARY

NOTE: EMBANKMENT COLUMN DOES NOT INCLUDE BACKFILL FOR UNDERCUT

Station	Uncl. Exc.	Embt	Station	Uncl. Exc.	Embt
L	(cu. yd.)	(cu. yd.)	L	(cu. yd.)	(cu. yd.)
14+70.00	0	0	36+74.25	0	0
15+00.00	1	6	37+00.00	9	6
15+50.00	1	20	37+50.00	7	12
16+00.00	19	24	38+00.00	4	6
16+28.81	18	19	38+15.00	1	1

Approximate quantities only. Unclassified excavation, borrow excavation, fine grading, clearing and grubbing, and removal of existing pavement will be paid for at the lump sum price for "Grading".

Station	Uncl. Exc.	Embt
L	(cu. yd.)	(cu. yd.)
17+31.19	0	0
17+50.00	8	17
18+00.00	20	36
18+50.00	17	27
19+00.00	11	22
19+50.00	8	18
20+00.00	7	14
20+50.00	4	11
21+00.00	4	6
21+50.00	4	5
22+00.00	4	3
22+50.00	4	3
23+00.00	4	4
23+50.00	4	4
24+00.00	4	3
24+50.00	4	2
25+00.00	4	3
25+50.00	4	4
26+00.00	4	5
26+50.00	4	5
27+00.00	4	4
27+50.00	4	4
28+00.00	4	7
28+50.00	9	10
29+00.00	17	8
29+50.00	16	13
30+00.00	15	20
30+24.75	10	12

CROSS SECTION INDEX

SHEET	LINE	BEGIN STATION	END STATION
X-1	-L-	14+70.00	16+28.81
X-2	-L-	16+50.00	17+50.00
X-3	-L-	18+00.00	20+50.00
X-4	-L-	21+00.00	23+50.00
X-5	-L-	24+00.00	26+50.00
X-6	-L-	27+00.00	29+50.00
X-7	-L-	30+00.00	31+00.00
X-8	-L-	31+50.00	33+00.00
X-9	-L-	33+50.00	35+06.73
X-10	-L-	35+06.75	36+74.25
X-11	-L-	36+74.27	38+15.00

Station	Uncl. Exc.	Embt
L	(cu. yd.)	(cu. yd.)
31+92.25	0	0
32+00.00	5	3
32+50.00	11	17
33+00.00	0	11
33+50.00	0	8
34+00.00	0	14
34+50.00	0	25
35+00.00	6	30
35+06.75	2	4

8/23/99



PROJ. REFERENCE NO.	SHEET NO.
BR-0111	X-1

75 70 65 60 55 50 45 40 35 30 25 20 15 10 5 0 5 10 15 20 25 30 35 40 45 50 55 60 65 70 75

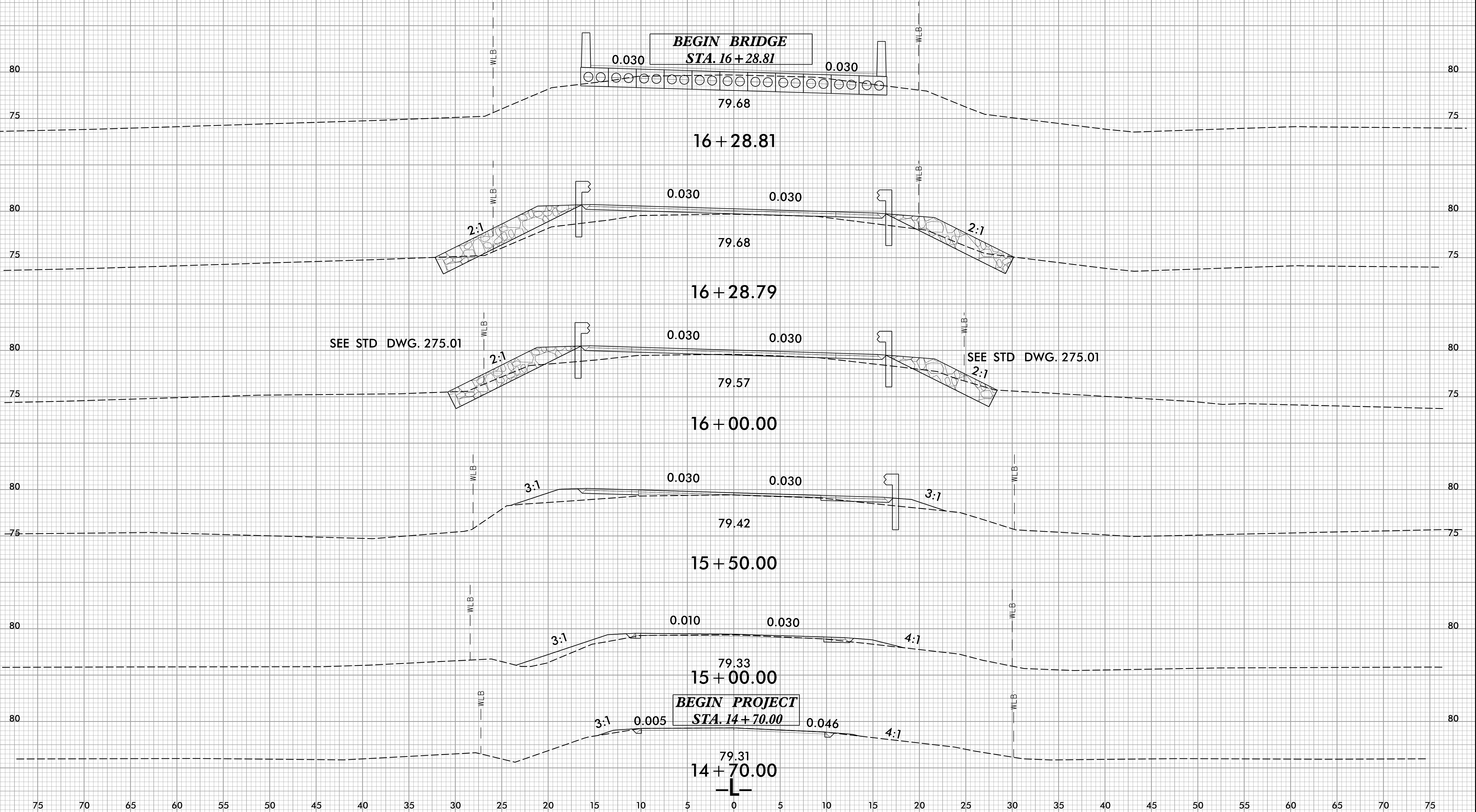

11/14/2019 10:58:01 AM J:\BR0111.RDY_XPL.dgn

8/23/99



PROJ. REFERENCE NO.	SHEET NO.
BR-0111	X-2

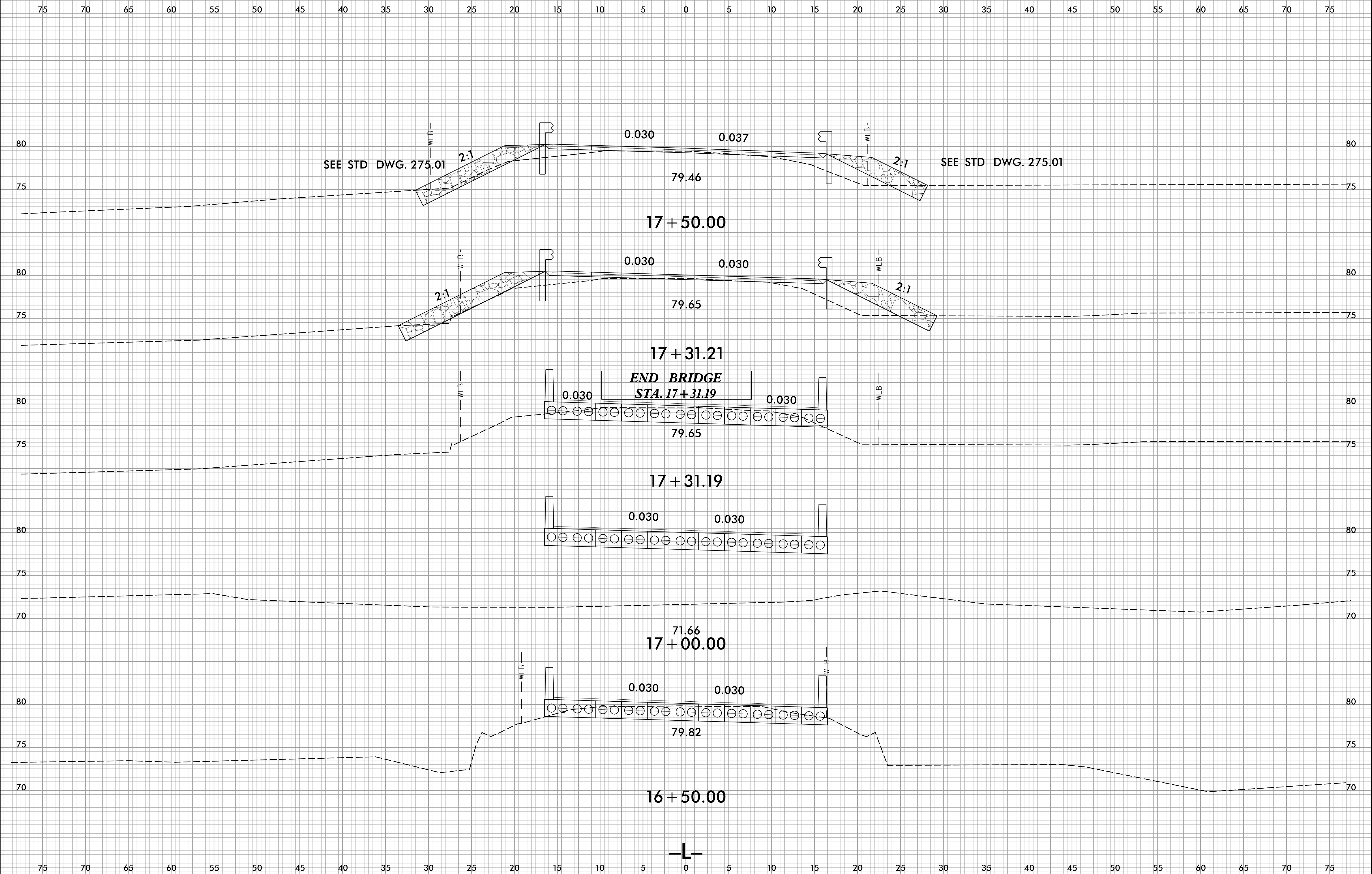

11/14/2019 10:58:01 AM J:\BR0111.RDY.XPL.dgn

8/23/99

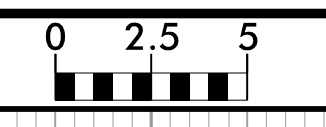

PROJ. REFERENCE NO.	SHEET NO.
BR-0111	X-3

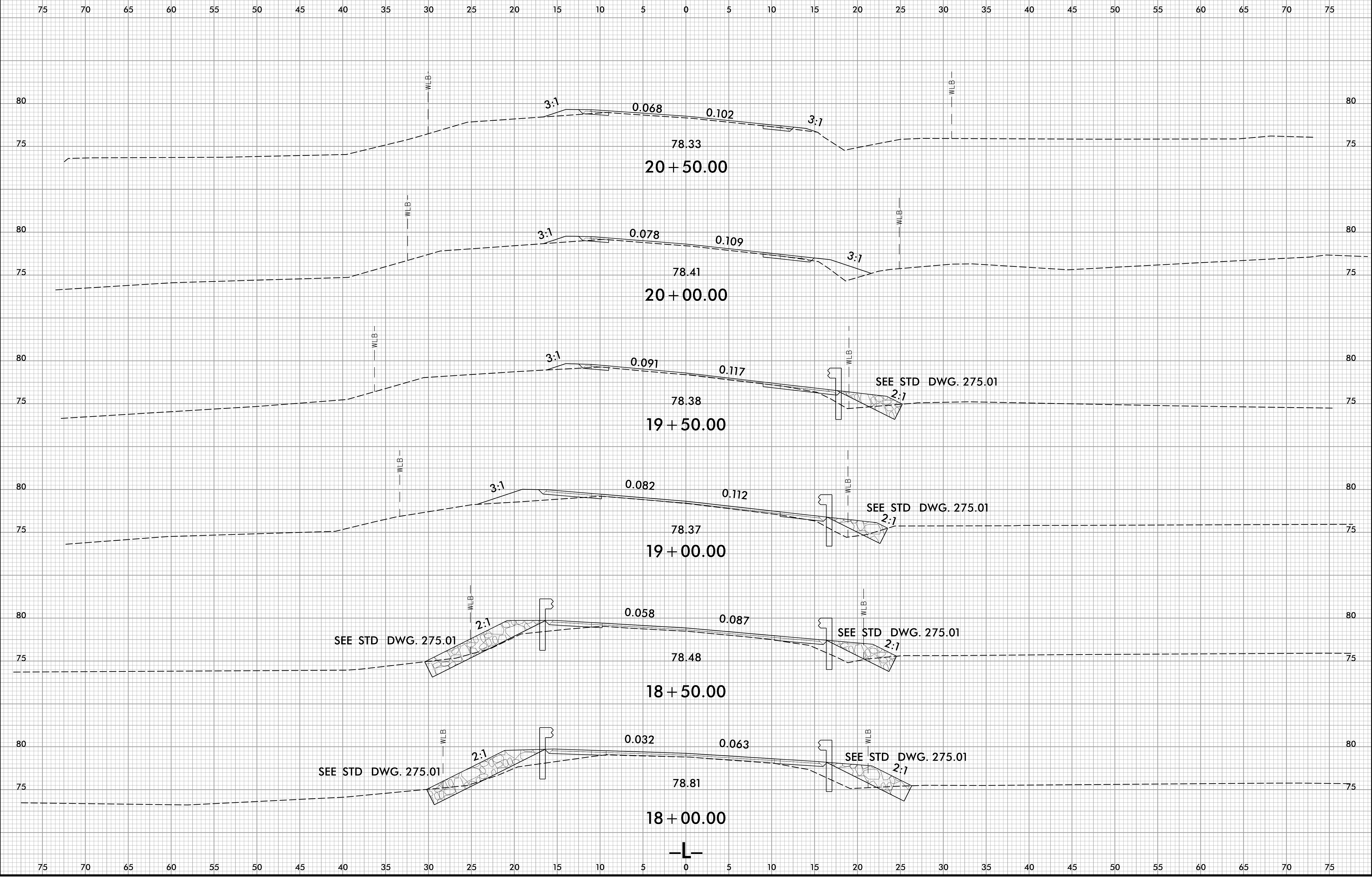

2/13/2020
J:\BR0111.RDY_XPL.dgn
J:\BR0111\BR0111

8/23/99



PROJ. REFERENCE NO. BR-0111	SHEET NO. X-4
--------------------------------	------------------

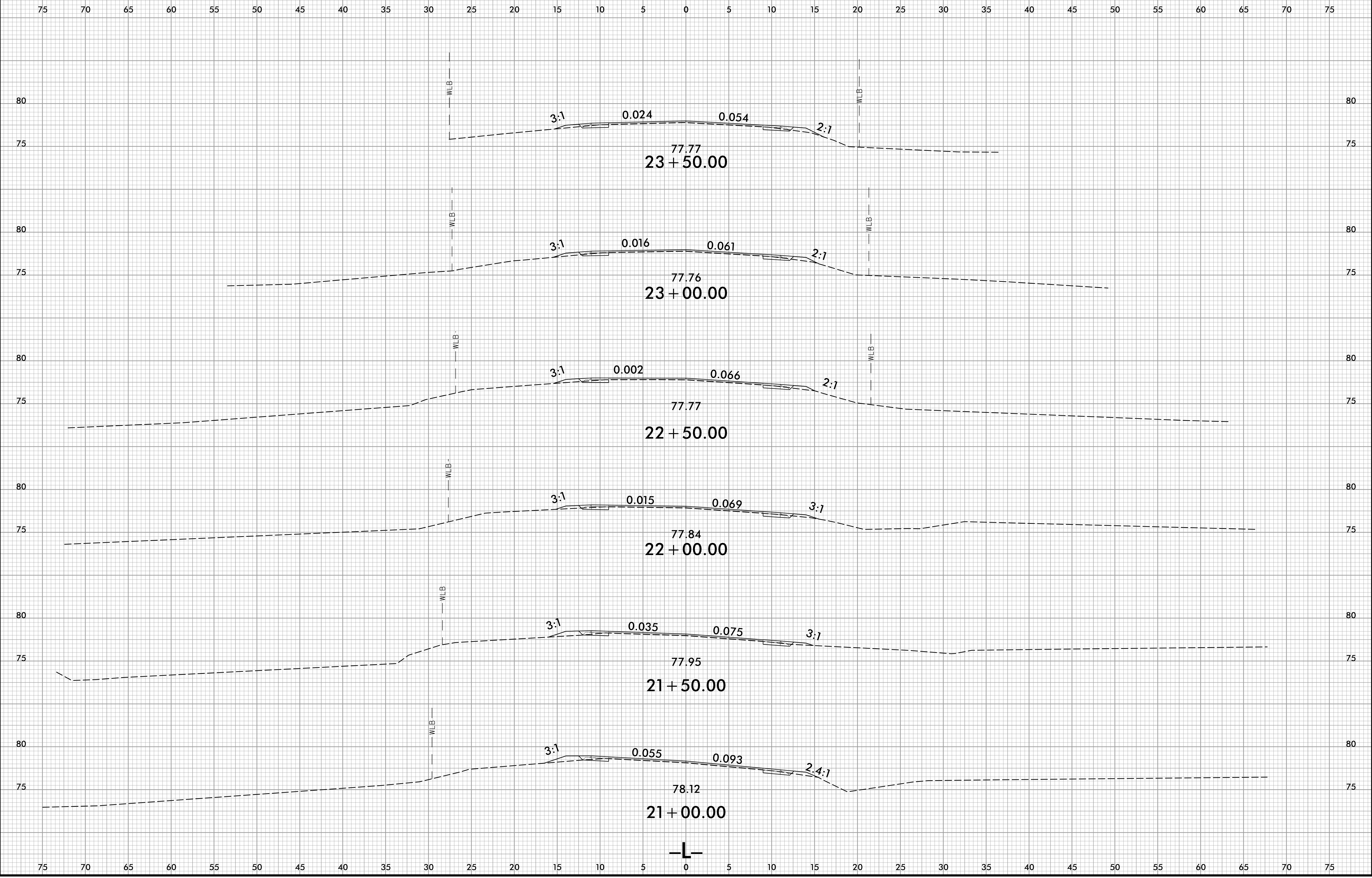

11/14/2009
J:\BR0111.RDY_XPL.dgn
J:\BR0111

8/23/99

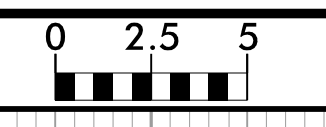

PROJ. REFERENCE NO.	SHEET NO.
BR-0111	X-5

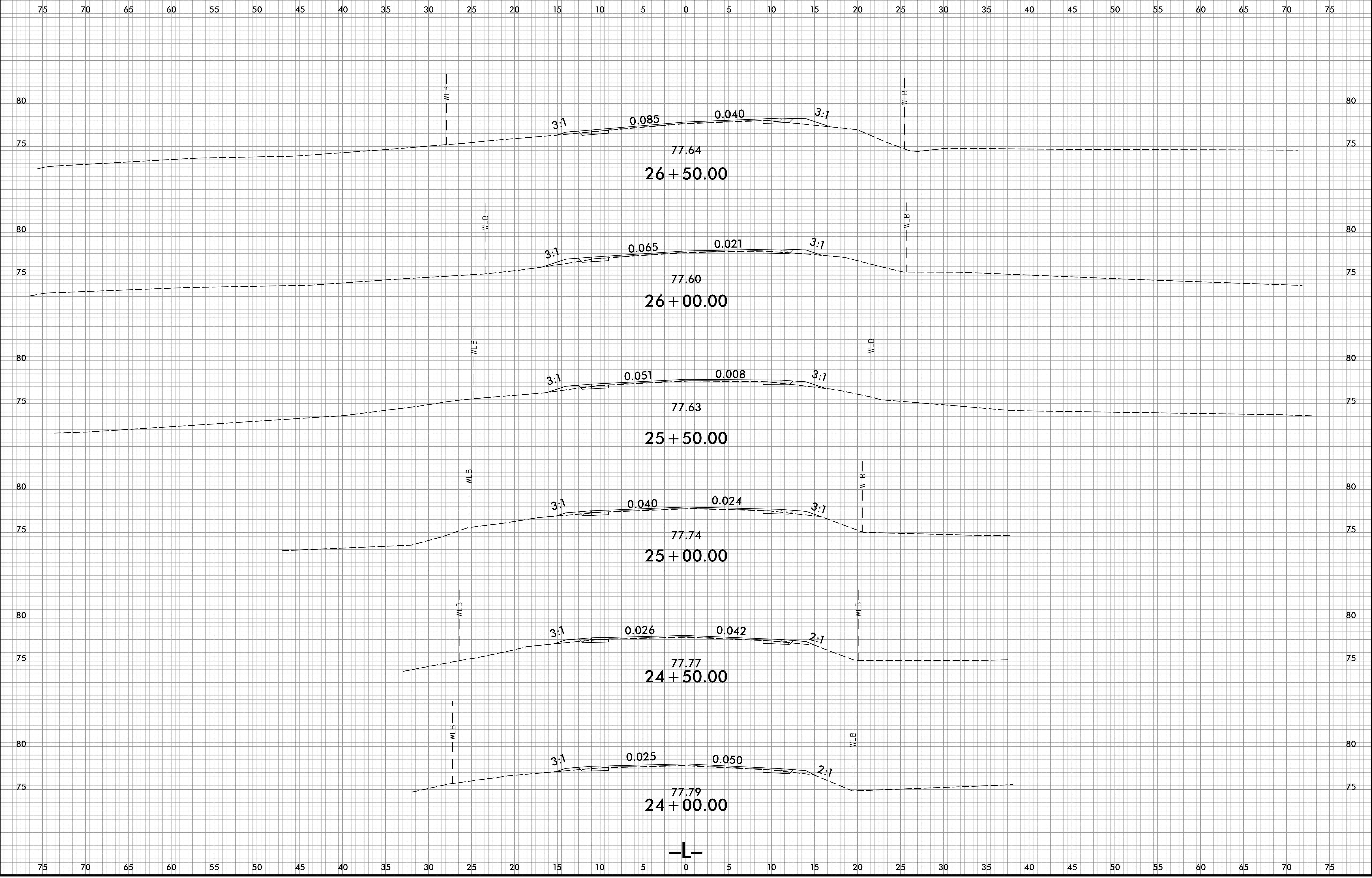

11/14/2019 10:58:01 AM J:\BR0111.RDY.XPL.dgn

8/23/99



PROJ. REFERENCE NO.	SHEET NO.
BR-0111	X-6

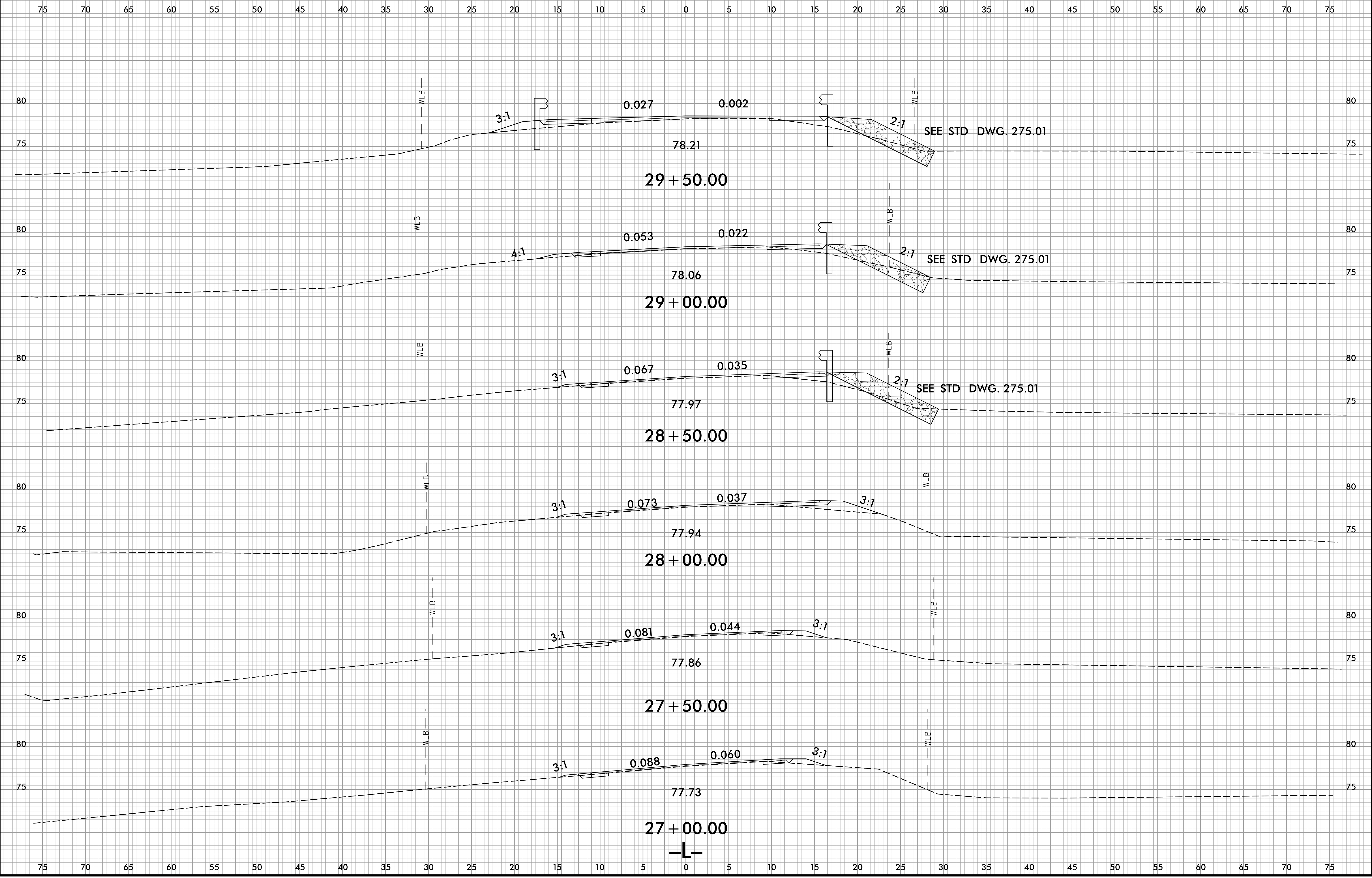

11/14/2019 10:58:01 AM J:\BR0111.RDY.XPL.dgn

8/23/99



PROJ. REFERENCE NO.	SHEET NO.
BR-0111	X-7

75 70 65 60 55 50 45 40 35 30 25 20 15 10 5 0 5 10 15 20 25 30 35 40 45 50 55 60 65 70 75

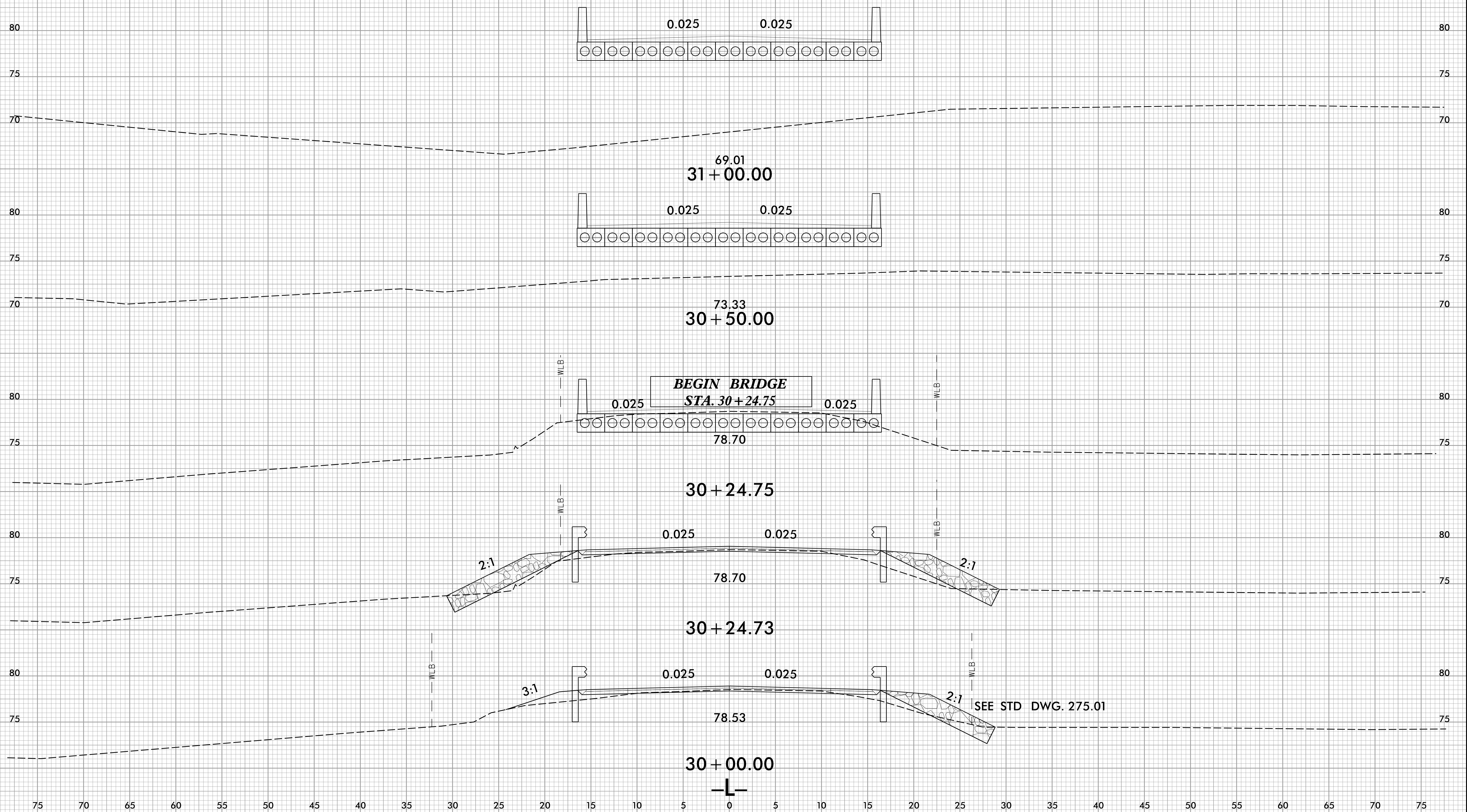

75 70 65 60 55 50 45 40 35 30 25 20 15 10 5 0 5 10 15 20 25 30 35 40 45 50 55 60 65 70 75

11/14/2019 10:58:01 AM J:\BR0111.RDY.XPL.dgn

8/23/99



PROJ. REFERENCE NO.	SHEET NO.
BR-0111	X-8

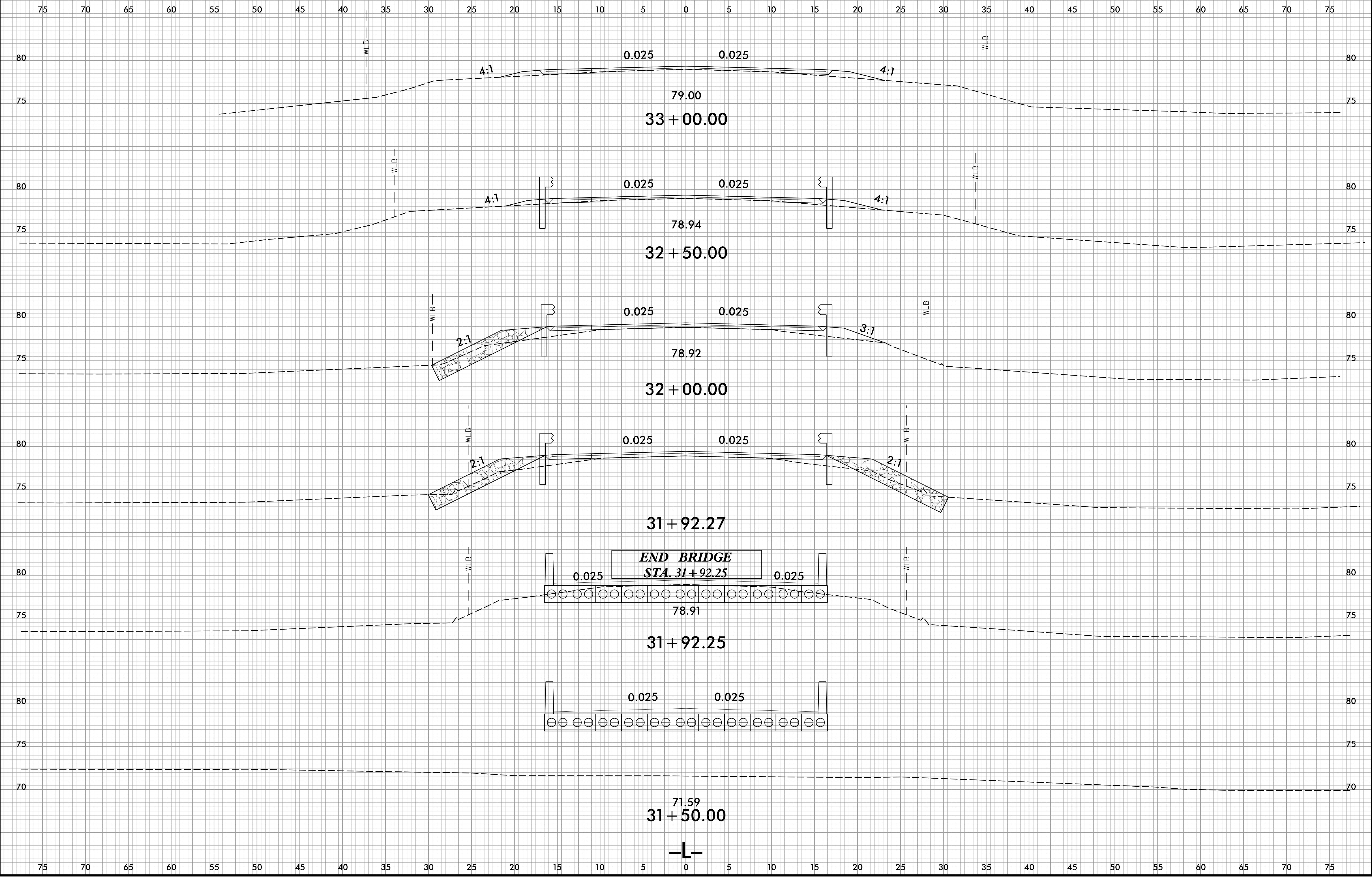

11/14/2009
T:\BRC\0111.RDY.XPL.dgn
J:\BRC\0111

8/23/99



PROJ. REFERENCE NO.	SHEET NO.
BR-0111	X-9

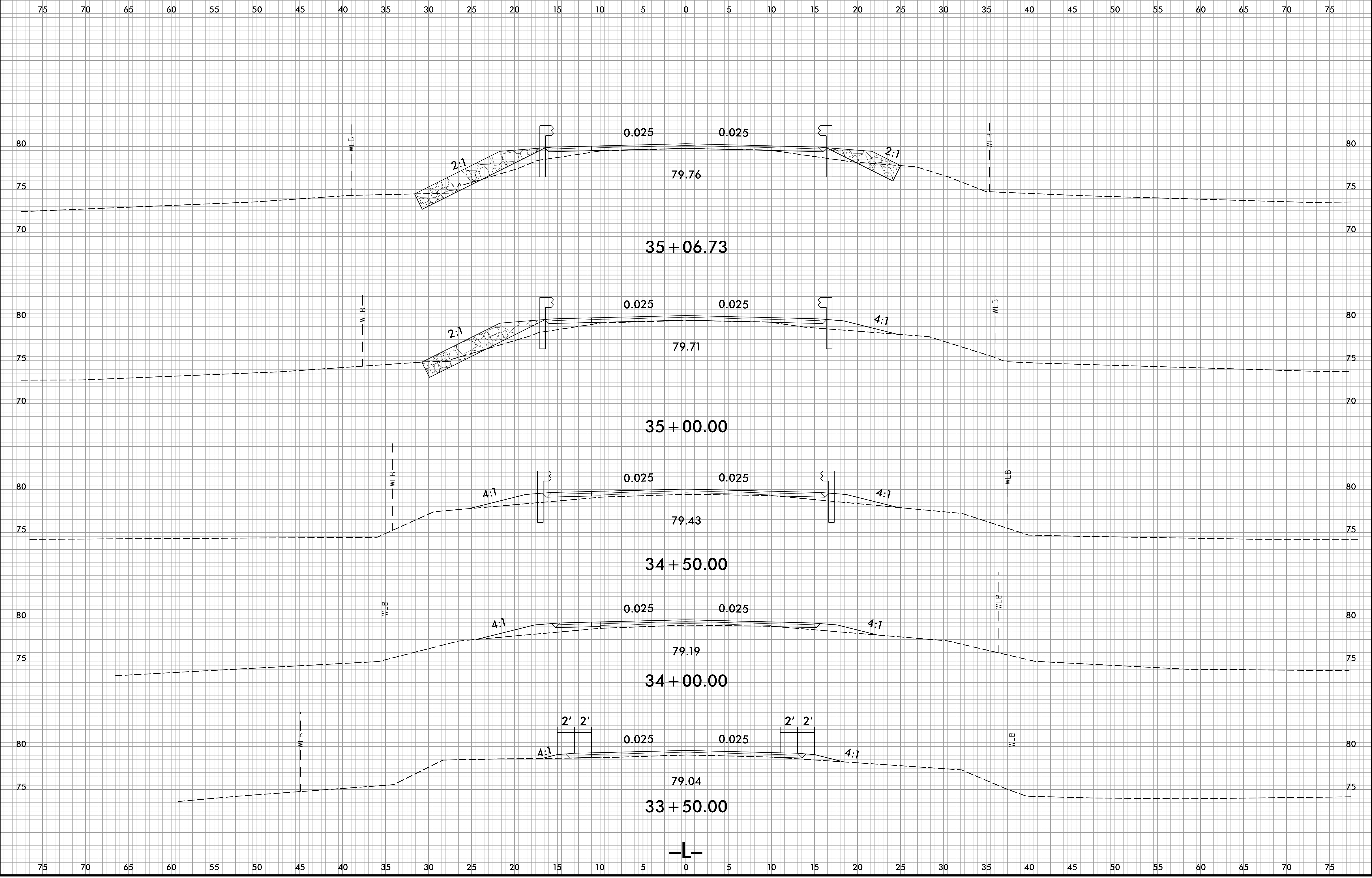

11/14/2019 10:58:01 AM J:\BRC\0111.RDY_XPL.dgn

8/23/99



PROJ. REFERENCE NO. BR-0111	SHEET NO. X-10
--------------------------------	-------------------

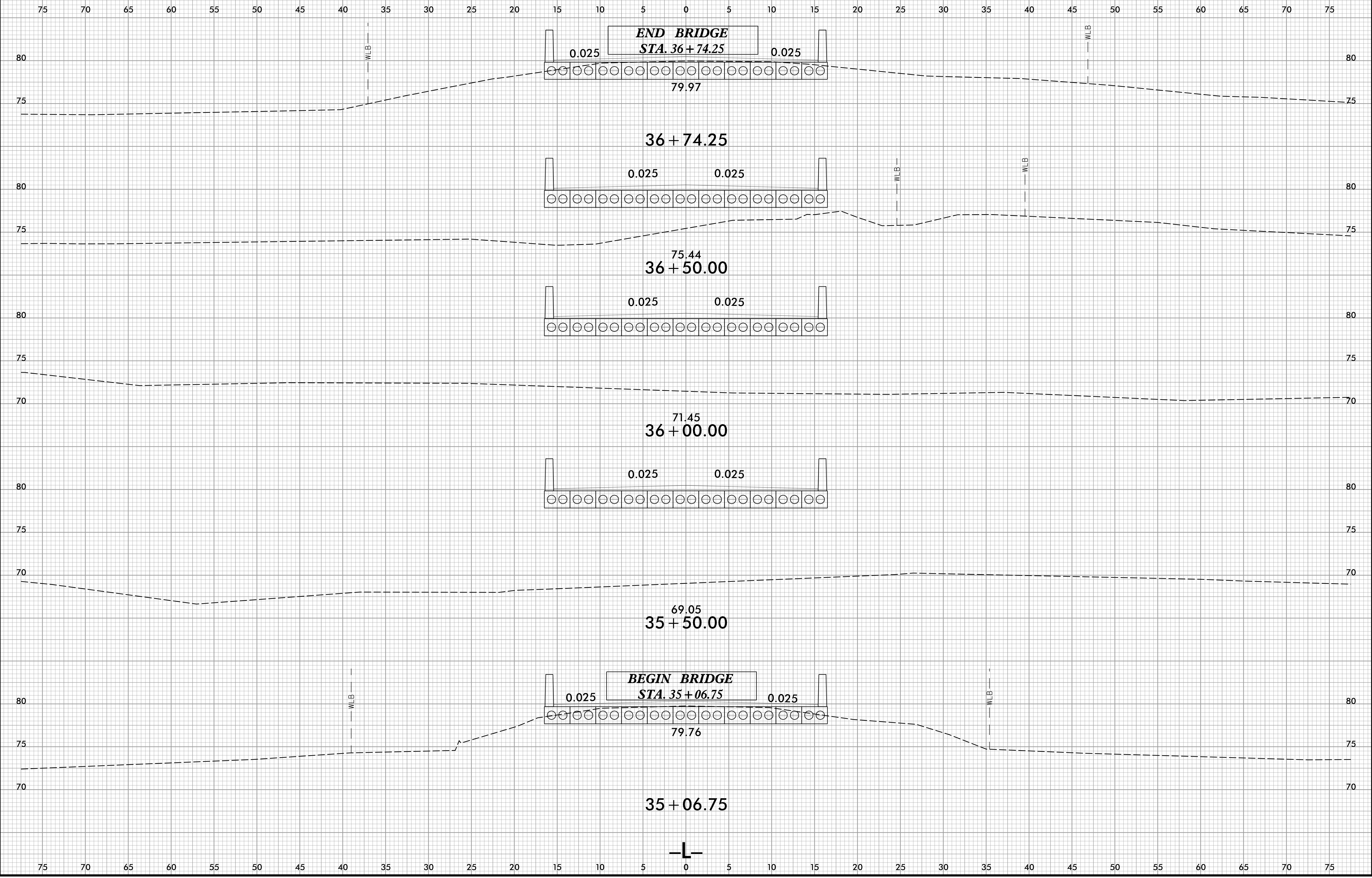

11/14/2009 10:58:01 AM J:\BR0111.RDY.XPL.dgn

8/23/99



PROJ. REFERENCE NO. BR-0111	SHEET NO. X-11
--------------------------------	-------------------

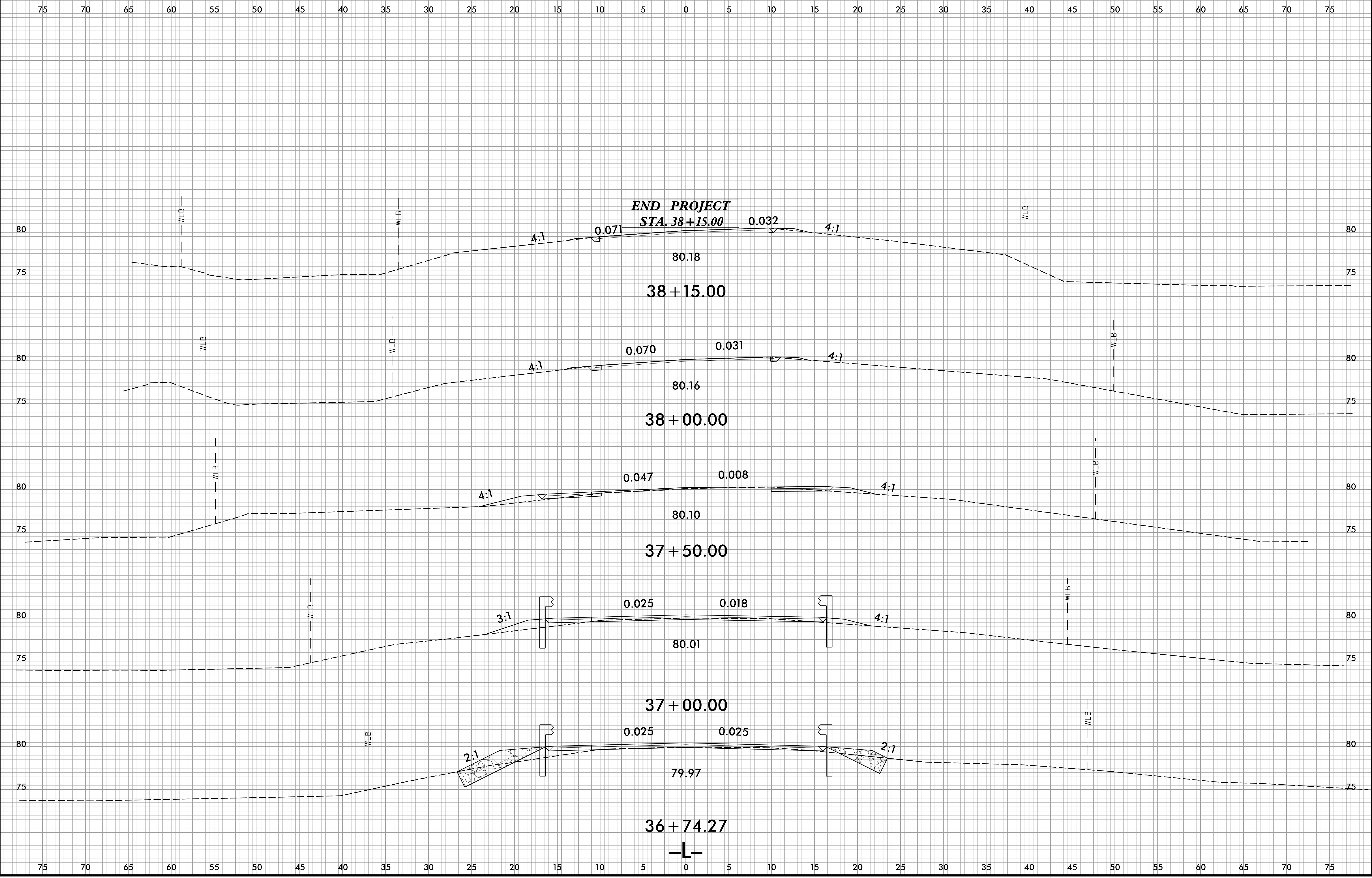

11/14/2019 10:58:01 AM J:\BR0111.RDY.XPL.dgn