

REVISIONS  
 8/17/99  
 I:\AUG-2020\_08\22  
 S:\Projects\Development\TIP\_Projects\1-5795-1\1-5795-1\40-Forsyth\Roadway\DesignFiles\1-5795\_dfd\_c\_psh10.dgn  
 \$\$\$\$\$\$

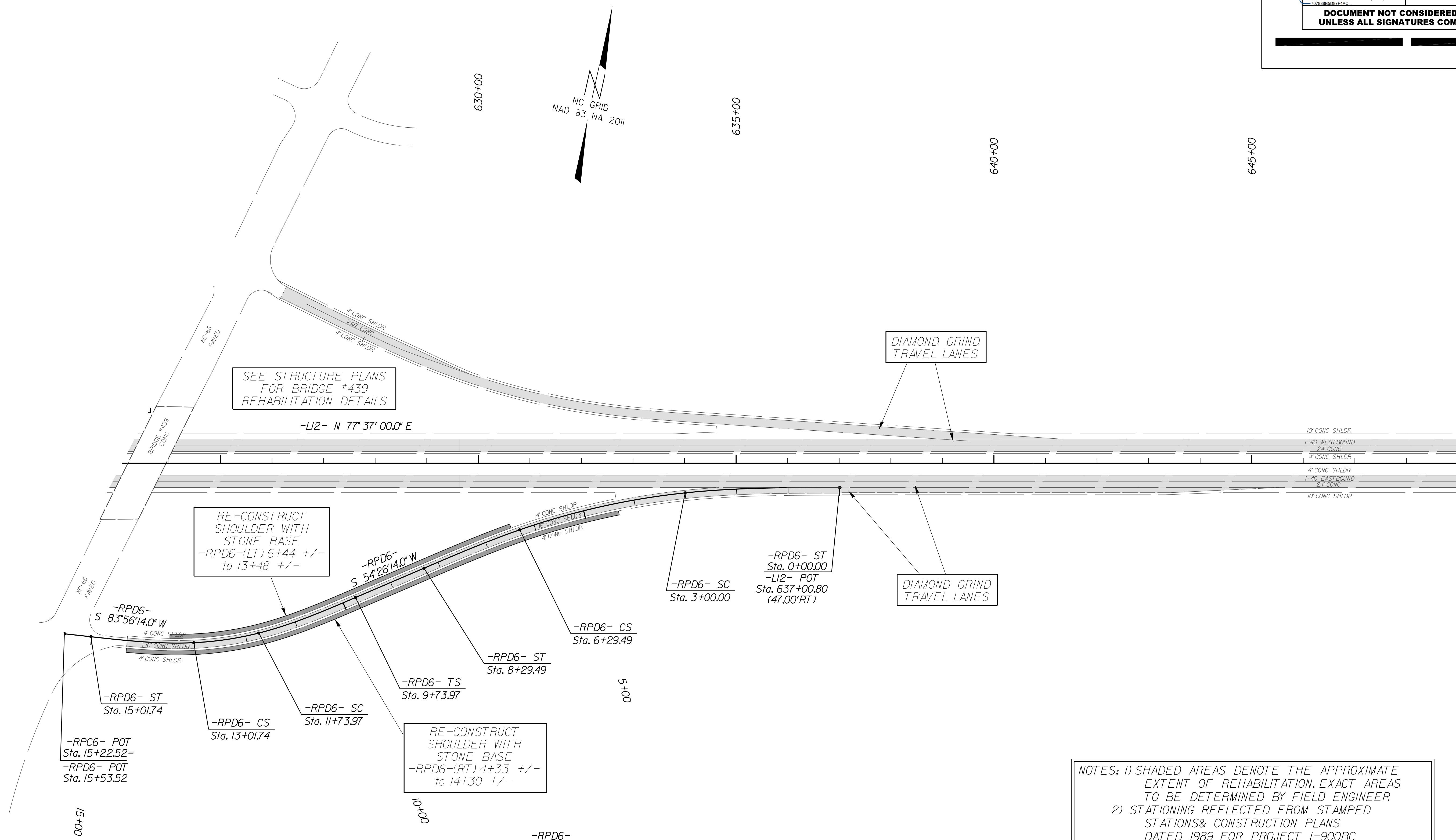

SEE STRUCTURE PLANS FOR BRIDGE #439 REHABILITATION DETAILS

RE-CONSTRUCT SHOULDER WITH STONE BASE  
-RPD6-(LT) 6+44 +/- to 13+48 +/-

RE-CONSTRUCT SHOULDER WITH STONE BASE  
-RPD6-(RT) 4+33 +/- to 14+30 +/-

Pls Sta 13+68.57 Es = 9' 00' 00.0" Ls = 200.00' LT = 133.51' ST = 66.82'	PI Sta 12+38.07 Δ = 11' 30' 00.0" (RT) D = 9' 00' 00.0" L = 127.78' T = 64.10' R = 636.62'	Pls Sta 11+07.47 Es = 9' 00' 00.0" Ls = 200.00' LT = 133.51' ST = 66.82'	Pls Sta 6+96.18 Es = 4' 00' 00.0" Ls = 200.00' LT = 133.37' ST = 66.70'	PI Sta 4+65.47 Δ = 13' 10' 46.0" (LT) D = 4' 00' 00.0" L = 329.49' T = 165.47' R = 1,432.39'	Pls Sta 2+00.12 Es = 6' 00' 00.0" Ls = 300.00' LT = 200.12' ST = 100.10'
--	---	--	---	---	--

NOTES: 1) SHADED AREAS DENOTE THE APPROXIMATE EXTENT OF REHABILITATION. EXACT AREAS TO BE DETERMINED BY FIELD ENGINEER  
 2) STATIONING REFLECTED FROM STAMPED STATIONS & CONSTRUCTION PLANS DATED 1989 FOR PROJECT 1-900BC (PROJ.\*8J620422,8J621003)  
 3) FOLLOWING RE-SURFACING, THE CONTRACTOR SHALL INSTALL NEW THERMOPLASTIC PAVEMENT MARKINGS (SAME AS EXISTING) AND TIE INTO EXISTING PAVEMENT MARKINGS