

-RPAI-

Pls Sta 10+89.75 Es = 3' 00' 00.0" Ls = 200.00' LT = 133.35' ST = 66.68'	PI Sta 7+69.11 Δ = 15' 19' 46.0" (RT) D = 3' 00' 00.0" L = 510.98' T = 257.03' R = 1,909.86'	Pls Sta 4+45.43 Es = 3' 00' 00.0" Ls = 200.00' LT = 133.35' ST = 66.68'
--	---	---

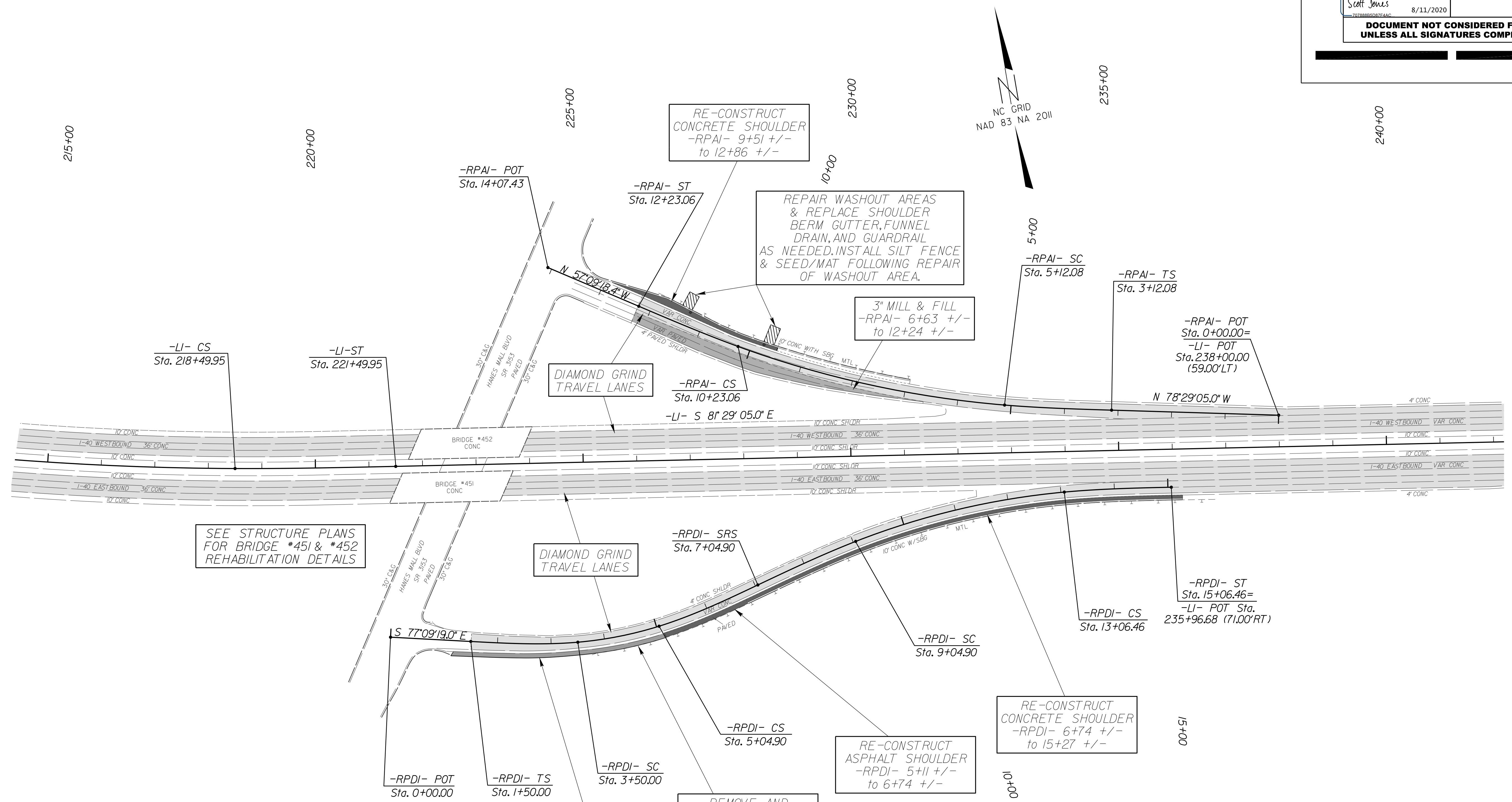

SEE STRUCTURE PLANS FOR BRIDGE #451 & #452 REHABILITATION DETAILS

NOTES: 1) SHADED AREAS DENOTE THE APPROXIMATE EXTENT OF REHABILITATION. EXACT AREAS TO BE DETERMINED BY FIELD ENGINEER
2) STATIONING REFLECTED FROM STAMPED STATIONS & CONSTRUCTION PLANS DATED 1987 FOR PROJECT I-900AB (PROJ. #81620412, 81620413)
3) FOLLOWING RE-SURFACING, THE CONTRACTOR SHALL INSTALL NEW THERMOPLASTIC PAVEMENT MARKINGS (SAME AS EXISTING) AND TIE INTO EXISTING PAVEMENT MARKINGS

-RPDI-

Pls Sta 2+83.47 Es = 8' 00' 00.0" Ls = 200.00' LT = 133.47' ST = 66.79'	PI Sta 4+27.75 Δ = 12' 23' 31.0" (LT) D = 8' 00' 00.0" L = 154.90' T = 77.75' R = 716.20'	Pls Sta 5+71.69 Es = 8' 00' 00.0" Ls = 200.00' LT = 133.47' ST = 66.79'
Pls Sta 8+38.27 Es = 4' 00' 00.0" Ls = 200.00' LT = 133.37' ST = 66.70'	PI Sta 11+07.01 Δ = 16' 03' 45.0" (RT) D = 4' 00' 00.0" L = 401.56' T = 202.11' R = 1,432.39'	Pls Sta 13+73.16 Es = 4' 00' 00.0" Ls = 200.00' LT = 133.37' ST = 66.70'

8/17/99
 I:\AUG-2020_09-22
 5:14:02 PM
 I:\Projects\Development\TIP_Projects\1-5795-1\1-5795-1.dwg
 40-Forsyth\Roadway\Design\1-5795-1.dwg
 8/11/2020 09:22
 5:14:02 PM
 I:\Projects\Development\TIP_Projects\1-5795-1\1-5795-1.dwg
 40-Forsyth\Roadway\Design\1-5795-1.dwg