

8/17/99

PROJECT REFERENCE NO. 48793.3.1	SHEET NO. 6
RW SHEET NO.	
ROADWAY DESIGN ENGINEER 	HYDRAULICS ENGINEER 
DOCUMENT NOT CONSIDERED FINAL UNLESS ALL SIGNATURES COMPLETED	
ICE of CAROLINAS, PLLC 4503 Falls of Neuse Road, Suite 110 Raleigh, North Carolina 27609 Phone: 803-822-0333 License #: P-6999	

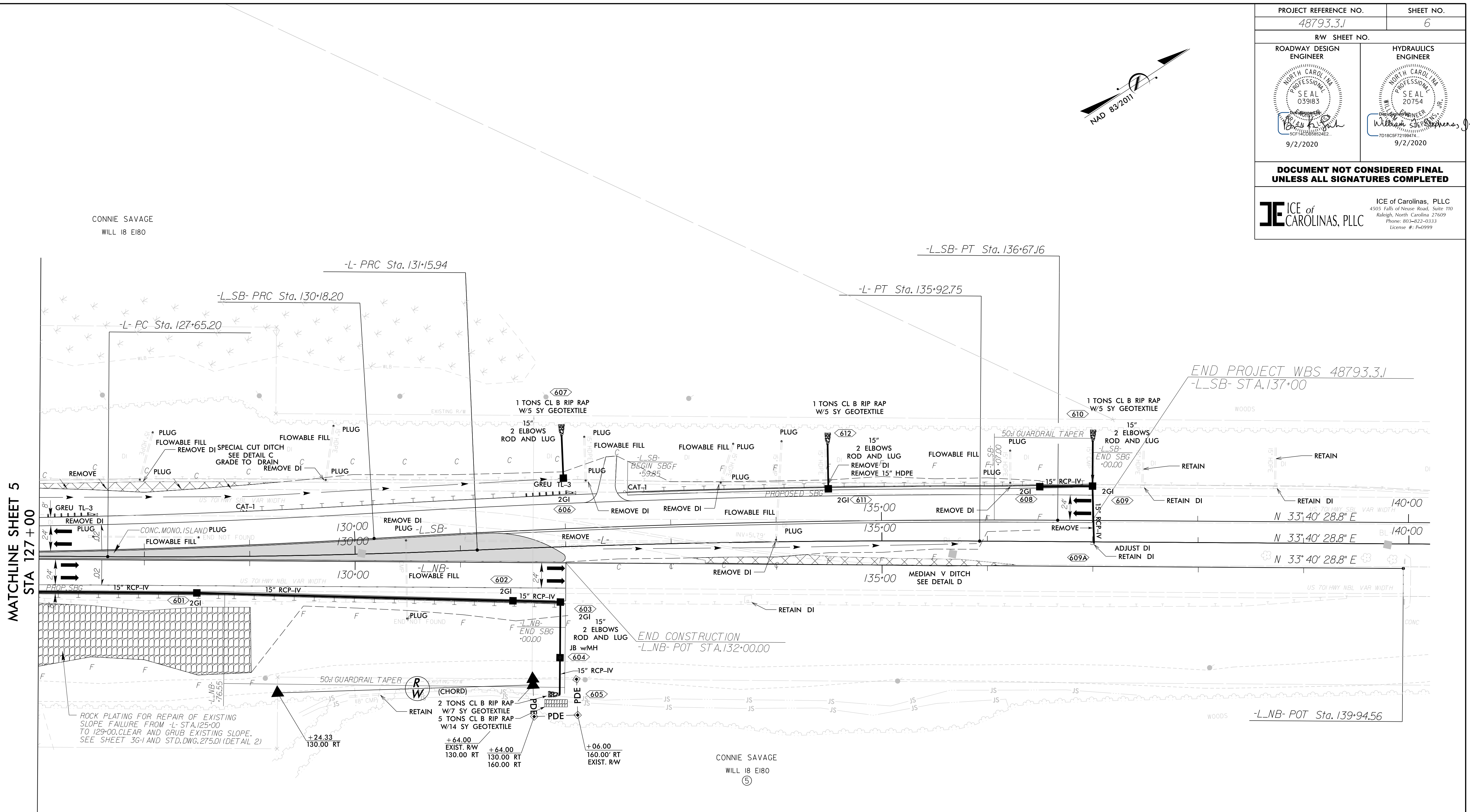
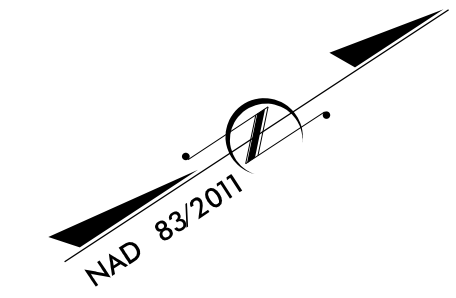

MATCHLINE SHEET 5  
STA 127+00

END PROJECT WBS 48793.3.1  
-L- SB- STA. 137+00

END CONSTRUCTION  
-L- NB- POT STA. 132+00.00

-L- NB- POT Sta. 139+94.56

-L- SB- US 70I SOUTHBOUND	
PI Sta 127+79.60	PI Sta 133+42.80
$\Delta = 3^{\circ} 49' 31.4''$ (LT)	$\Delta = 3^{\circ} 49' 31.4''$ (RT)
D = 0' 48' 04.8"	D = 0' 35' 22.1"
L = 477.37'	L = 648.96'
T = 238.78'	T = 324.60'
R = 7,150.00'	R = 9,720.00'
SE = .02	SE = NC
DS = 55 MPH	DS = 55 MPH

-L- US 70I	
PI Sta 129+40.61	PI Sta 133+54.39
$\Delta = 2^{\circ} 48' 38.1''$ (LT)	$\Delta = 2^{\circ} 48' 38.1''$ (RT)
D = 0' 48' 04.8"	D = 0' 35' 22.1"
L = 350.74'	L = 476.81'
T = 175.40'	T = 238.45'
R = 7,150.00'	R = 9,720.00'

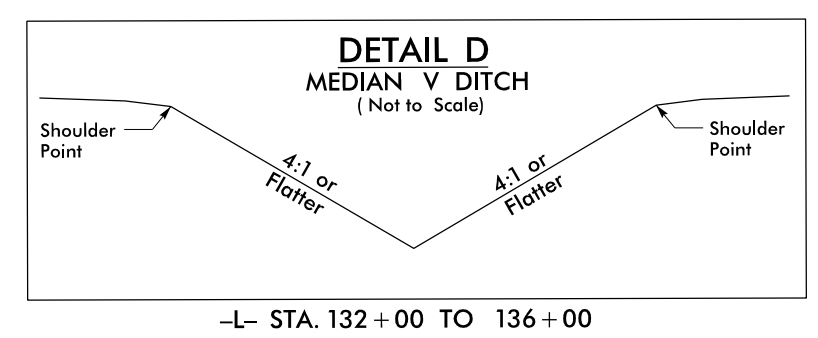
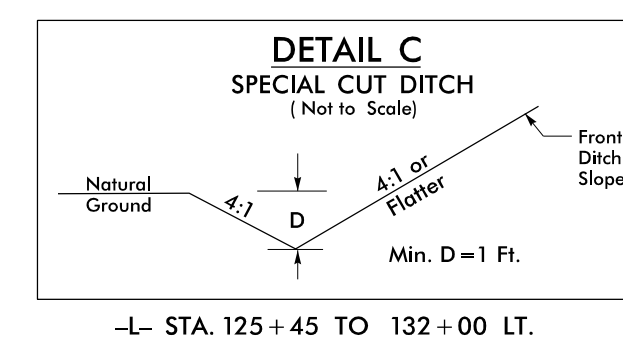

NOTE: ALL EASEMENT CALLOUTS FROM -L- UNLESS OTHERWISE NOTED

PAVEMENT REMOVAL

FOR -L- NB- AND -L- SB- PROFILE, SEE SHEET 9

9:43:10 AM R:\Projects\19-77 Division 6 On Call\02 US 70I over Cape Fear River\NCDOT\Roadway\Proj\Plansheets\US70I\rdy\_psh06.dgn 8/17/99