

8/17/99

DIMENSIONING DETAIL SHEET

PROJECT REFERENCE NO. 48793.31	SHEET NO. 2B
RW SHEET NO.	

ROADWAY DESIGN ENGINEER

**DOCUMENT NOT CONSIDERED FINAL
UNLESS ALL SIGNATURES COMPLETED**

ICE of CAROLINAS, PLLC

ICE of Carolinas, PLLC
4505 Falls of Neuse Road, Suite 110
Raleigh, North Carolina 27609
Phone: 803-822-0333
License #: P-0999

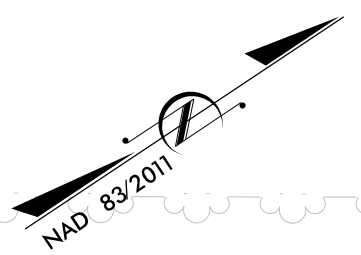
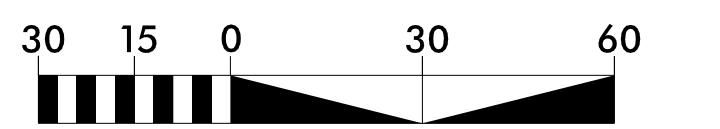
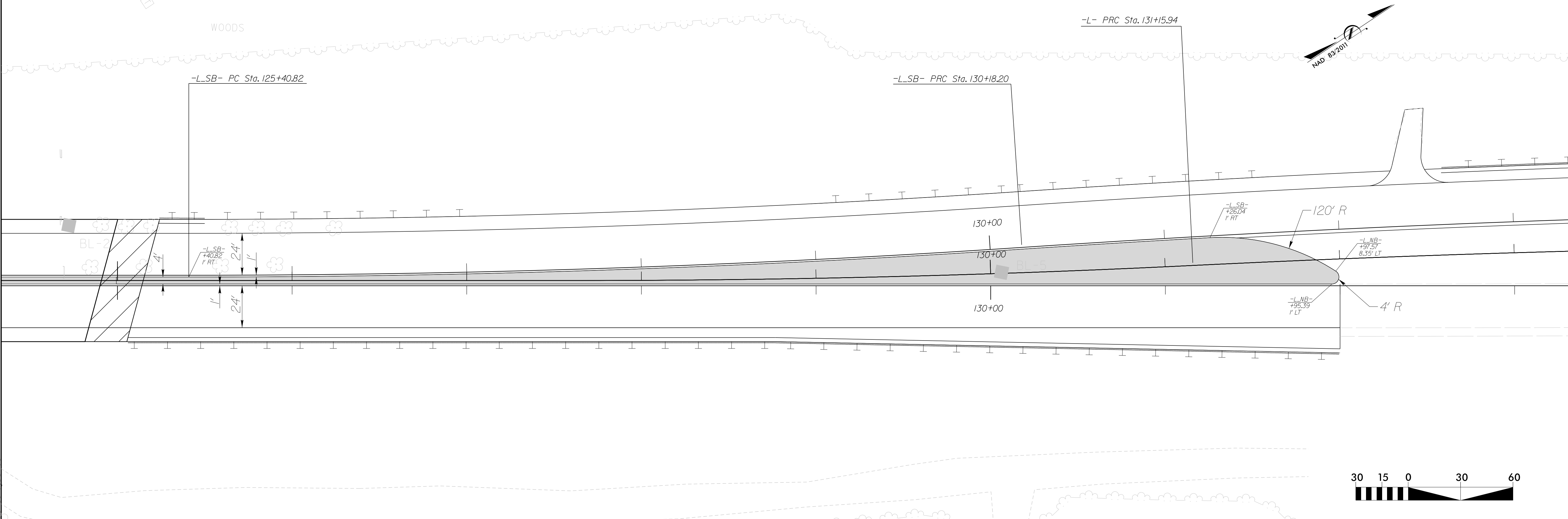
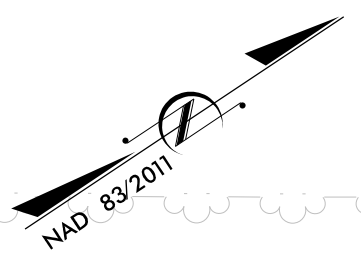
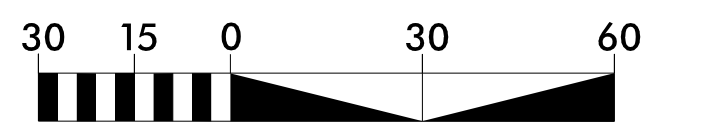
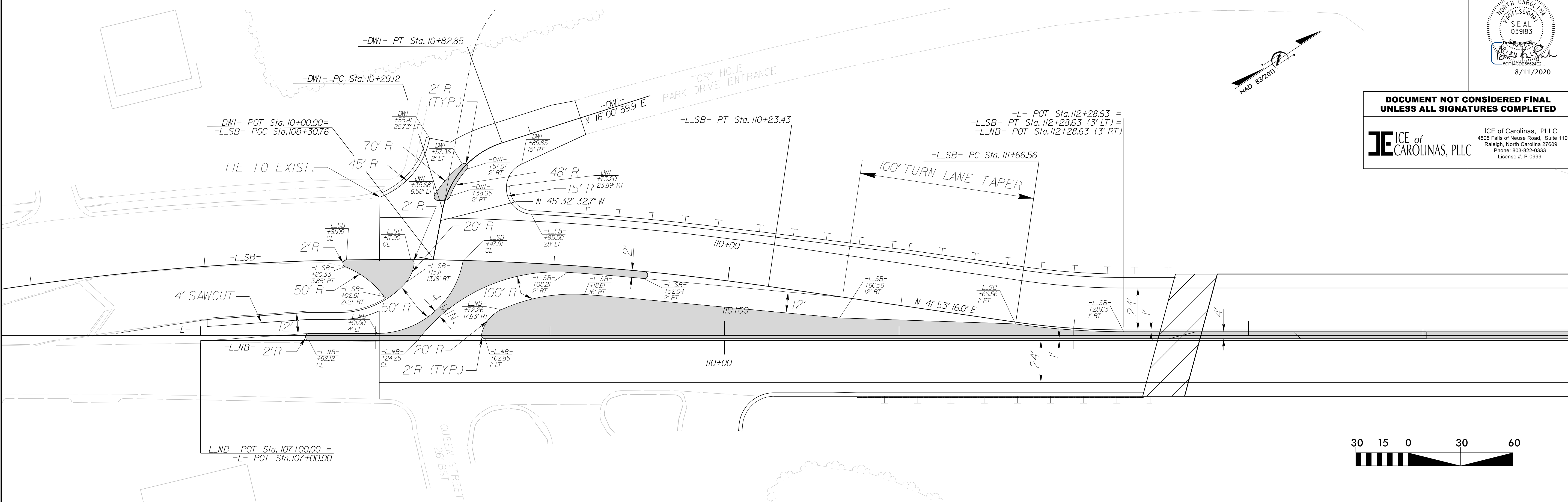

5:30:43 PM
 R:\Projects\19-77 Division 6 On Call\02 US 701 over Cape Fear River\NCDOT\Roadway\Proj\Plansheets\US701\rdy_psh2B_DETAL.dgn
 Corbin, Jackson