

19 DEC 2016 09:37
 C:\NCDOT\191740\Hydr-autils\CADD\PSHA.E&SC\R5740_rdy_PSH_36.dgn
 \$\$\$\$SUSAN HARRIS\$\$\$\$

MATCHLINE SEE SHEET EC-35
 -L- STA 191+00

MATCHLINE SEE SHEET EC-37
 -L- STA 204+00

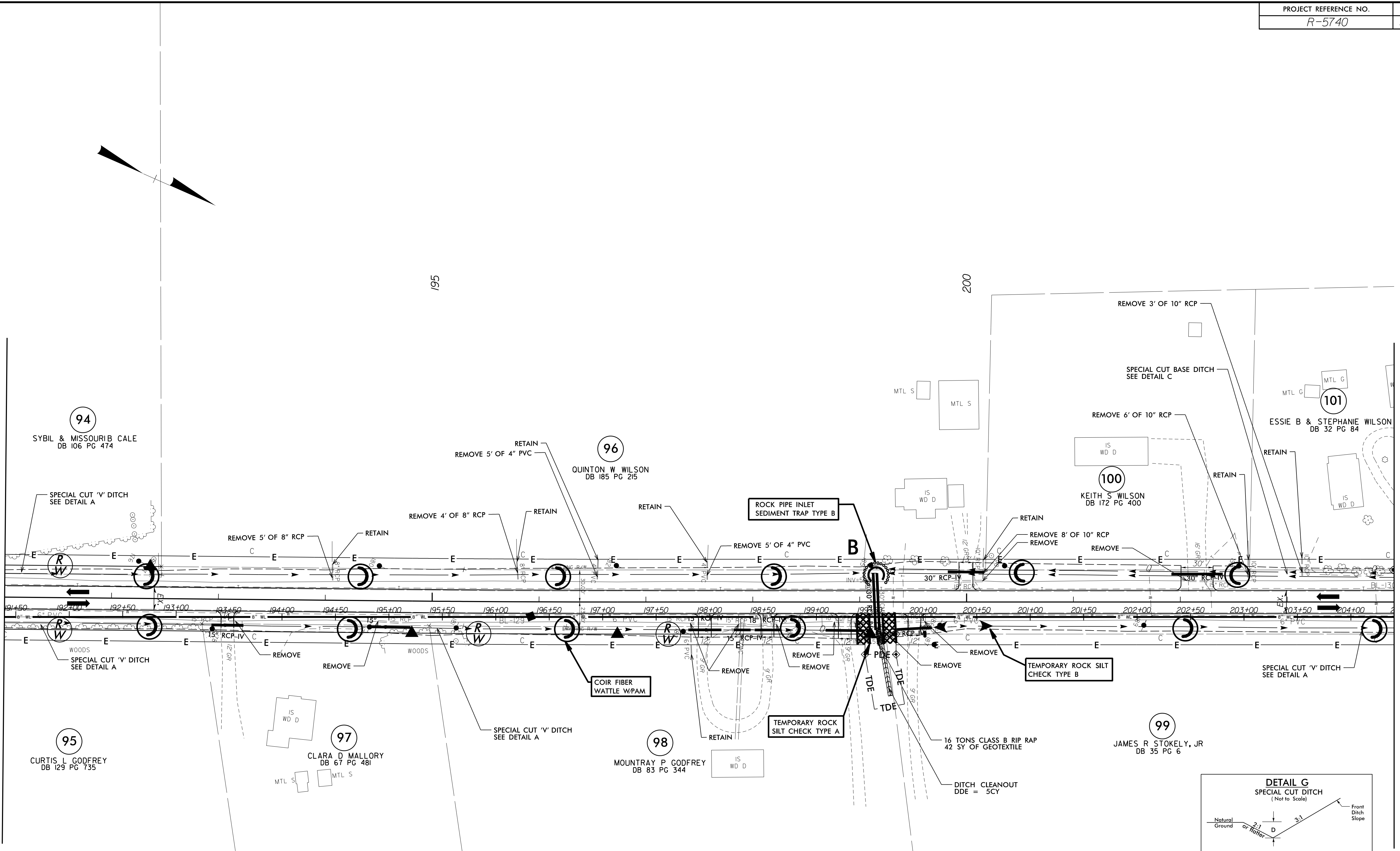

94
SYBIL & MISSOURI CALE
DB 106 PG 474

96
QUINTON W. WILSON
DB 185 PG 215

100
KEITH S. WILSON
DB 172 PG 400

101
ESSIE B & STEPHANIE WILSON
DB 32 PG 84

95
CURTIS L. GODFREY
DB 129 PG 735

97
CLARA D. MALLORY
DB 67 PG 481

98
MOUNTRAY P. GODFREY
DB 83 PG 344

99
JAMES R. STOKELY, JR.
DB 35 PG 6

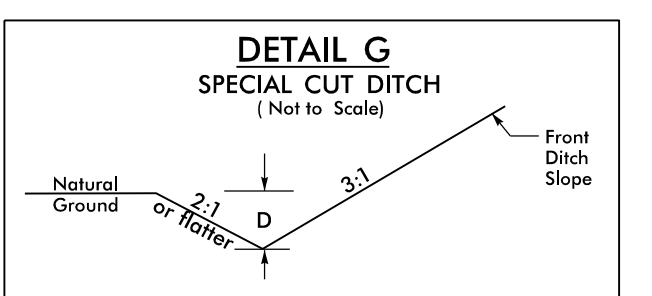

FROM -L- STA. 189+01 TO -L- STA. 193+00 LT Min. D=1.5 Ft.
 FROM -L- STA. 193+00 TO -L- STA. 199+00 LT Min. D=2.0 Ft.

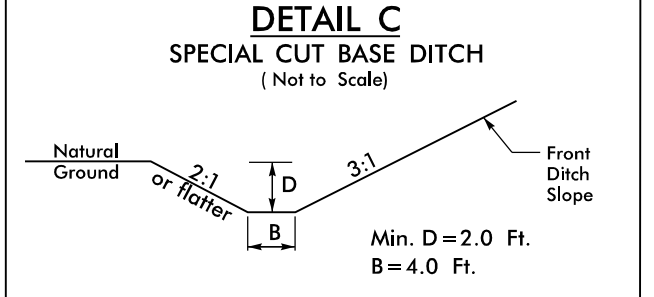

FROM -L- STA. 199+15 TO -L- STA. 204+00 LT

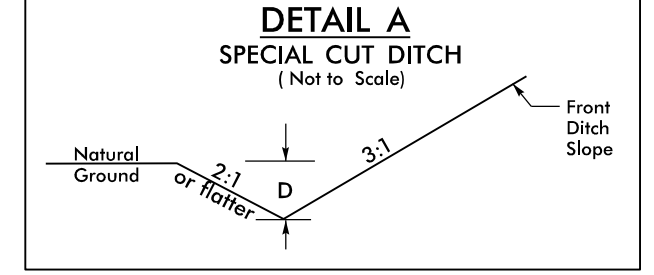

FROM -L- STA. 188+42 TO -L- STA. 199+16 RT Min. D=1.5 Ft.
 FROM -L- STA. 199+17 TO -L- STA. 205+00 RT Min. D=1.0 Ft.
 FROM -L- STA. 205+00 TO -L- STA. 211+53 RT Min. D=1.5 Ft.

INSTALL MATTING FOR EROSION CONTROL IN THE PROPOSED DITCH LINE.