

PLOT DRIVER: NCDOT\_color\_eng\_50.plt  
 USER: MDIEHL  
 DATE: 12/10/2019  
 TIME: 5:08:24 PM  
 FILE: North\_Carolina\_Dept\_of\_Transportation\NCDOT\_Western\_Div\_Or-Coll.M.\NCDOT-U2714\_US117.c.\6.0\_CAD\_BIM\6.2\_Work\_In\_Progress\U-2714\_NCDOT\_File\_Structure\Erosion\_Control\U2714\_EC\_PSH.dgn

REVISIONS

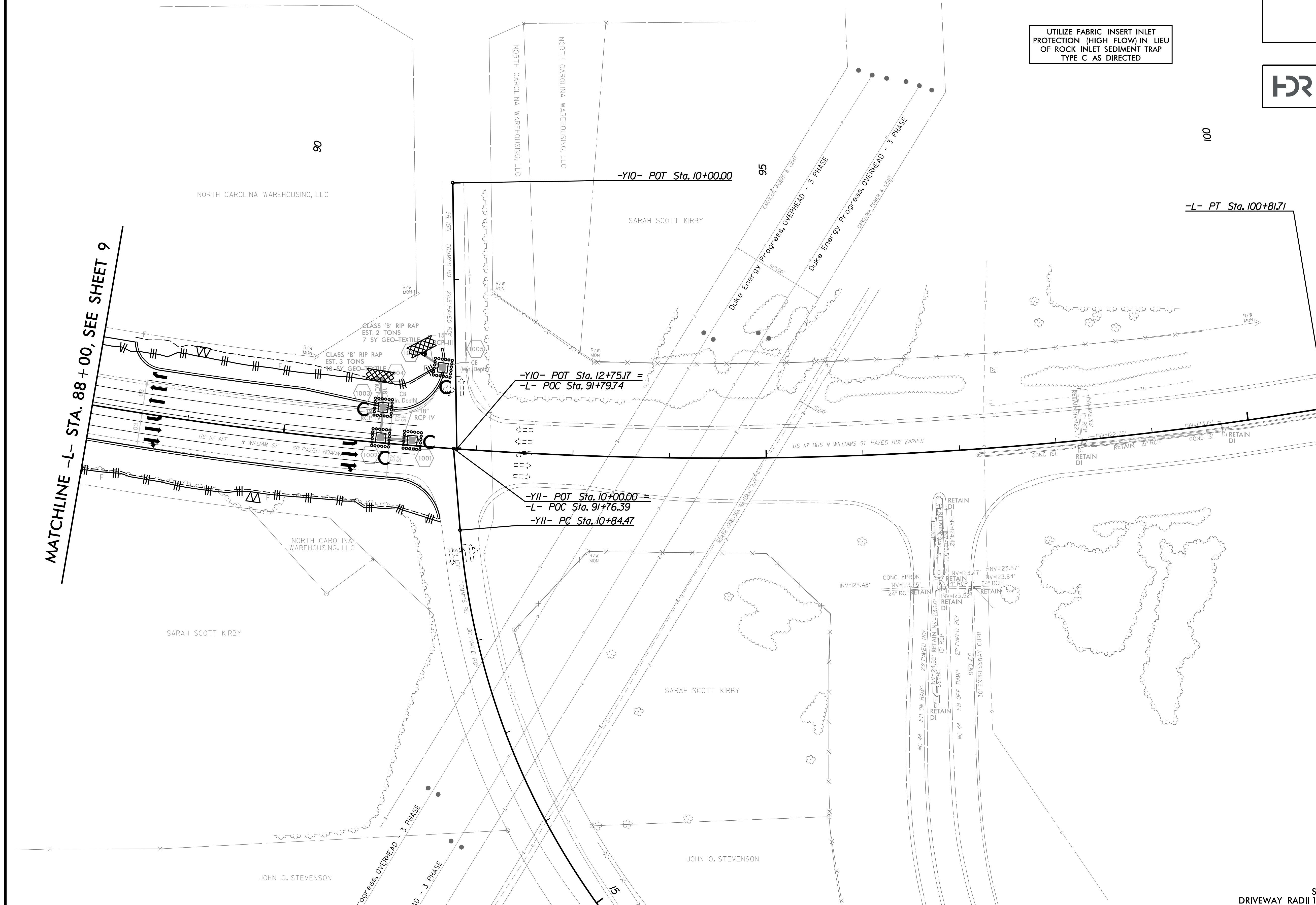

NAD 83 / NA 2011

UTILIZE FABRIC INSERT INLET PROTECTION (HIGH FLOW) IN LIEU OF ROCK INLET SEDIMENT TRAP TYPE C AS DIRECTED

PROJECT REFERENCE NO.	SHEET NO.
U-2714	EC-18/CONST.10
RW SHEET NO.	RW-10
ROADWAY DESIGN ENGINEER	HYDRAULICS ENGINEER

**HDR** HDR Engineering, Inc. of the Carolinas  
 555 Fayetteville St. Suite 900 Raleigh, N.C. 27601  
 N.C.B.E.L.S. License Number: F-0116

SEE SHEET 15 FOR -L- PROFILE DRIVEWAY RADII 10' UNLESS OTHERWISE NOTED