

PLOT DRIVER: NCDOT\_color\_eng\_50.plt  
 USER: MDIEHL  
 FILE: North\_Carolina\_Dept\_of\_Transportation\NCDOT\_Western\_Div\_Or\_Coll\_M\_NCDOT-U2714\_US117.cad\_CAD\_BIM\6.2\_Work\_In\_Progress\U-2714\_NCDOT\_File\_Structure\Erosion\_Control\U2714\_EC\_PSH.dgn

REVISIONS

PROJECT REFERENCE NO.	SHEET NO.
U-2714	EC-15/CONST.7
RW SHEET NO.	RW-7
ROADWAY DESIGN ENGINEER	HYDRAULICS ENGINEER

**HDR** HDR Engineering, Inc. of the Carolinas  
 555 Fayetteville St. Suite 900 Raleigh, N.C. 27601  
 N.C.B.E.L.S. License Number: F-0116

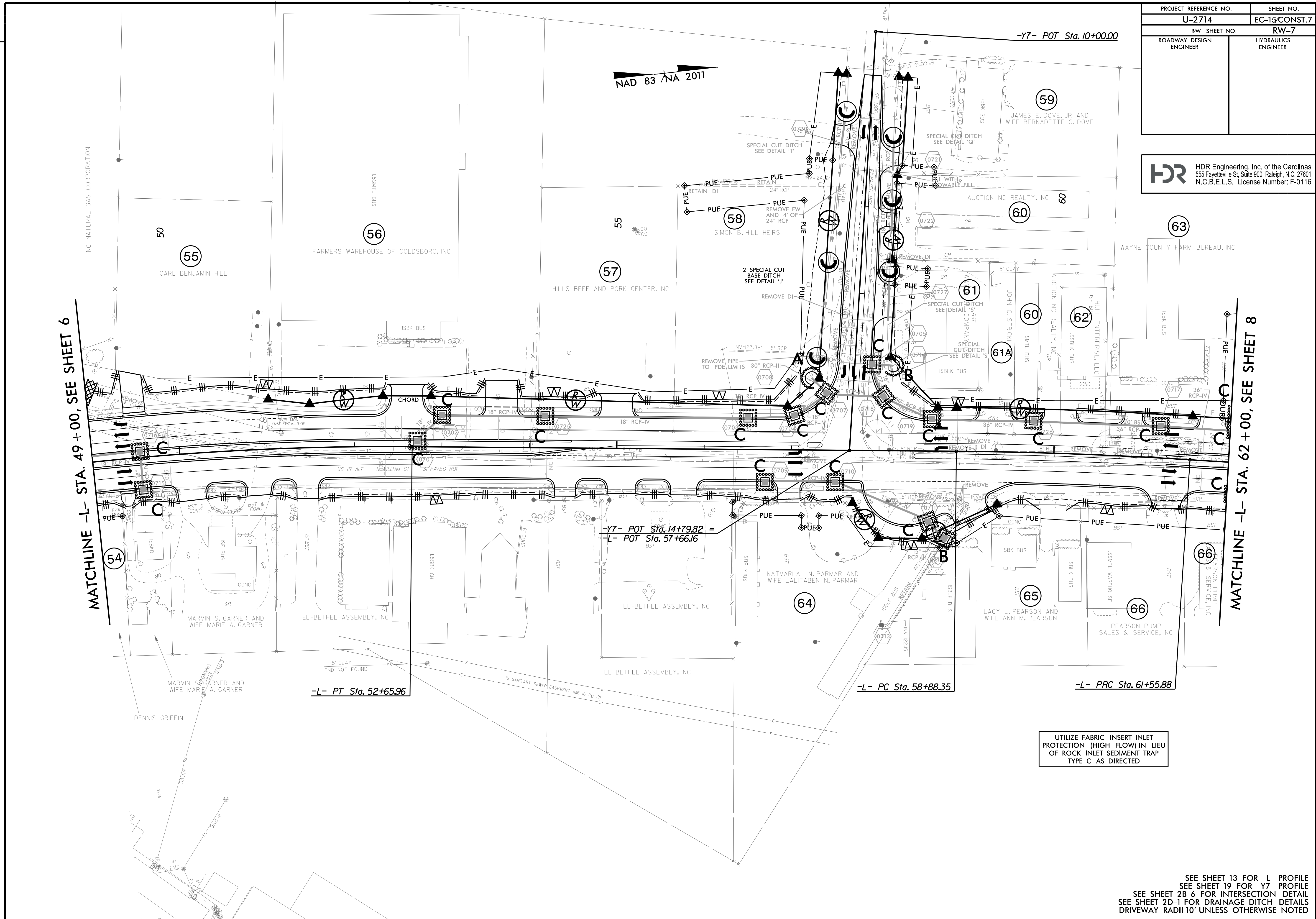

MATCHLINE -L- STA. 49 + 00, SEE SHEET 6

MATCHLINE -L- STA. 62 + 00, SEE SHEET 8

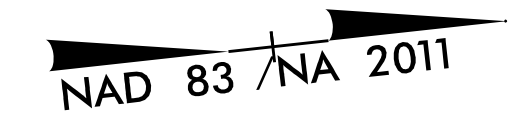

-Y7- POT Sta. 10+00.00

-Y7- POT Sta. 14+79.82 =  
 -L- POT Sta. 57+66.16

-L- PT Sta. 52+65.96

-L- PC Sta. 58+88.35

-L- PRC Sta. 61+55.88

UTILIZE FABRIC INSERT INLET PROTECTION (HIGH FLOW) IN LIEU OF ROCK INLET SEDIMENT TRAP TYPE C AS DIRECTED

SEE SHEET 13 FOR -L- PROFILE  
 SEE SHEET 19 FOR -Y7- PROFILE  
 SEE SHEET 2B-6 FOR INTERSECTION DETAIL  
 SEE SHEET 2D-1 FOR DRAINAGE DITCH DETAILS  
 DRIVEWAY RADII 10' UNLESS OTHERWISE NOTED