

PROJECT REFERENCE NO.	SHEET NO.
U-2714	EC-11/CONST.11
RW SHEET NO.	RW-11
ROADWAY DESIGN ENGINEER	HYDRAULICS ENGINEER

HDR HDR Engineering, Inc. of the Carolinas
 555 Fayetteville St. Suite 900 Raleigh, N.C. 27601
 N.C.B.E.L.S. License Number: F-0116

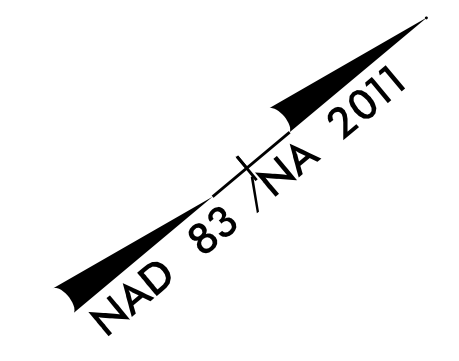

PLOT DRIVER: NCDOT...color_eng_50.plt
 USER: MDIEHL
 DATE: 12/10/2019
 TIME: 5:05:43 PM
 FILE: North_Carolina_Dept_of_Transportation\NCDOT...Western_Div_Or-Coll_M...NCDOT-U2714_US117...NCDOT-U2714_US117...c...6.0_CAD_BIM_v6.2_Work_In_Progress\U-2714_NCDOT_File_Structure\Erosion_Contr\U2714_EC_PSH.dgn

REVISIONS

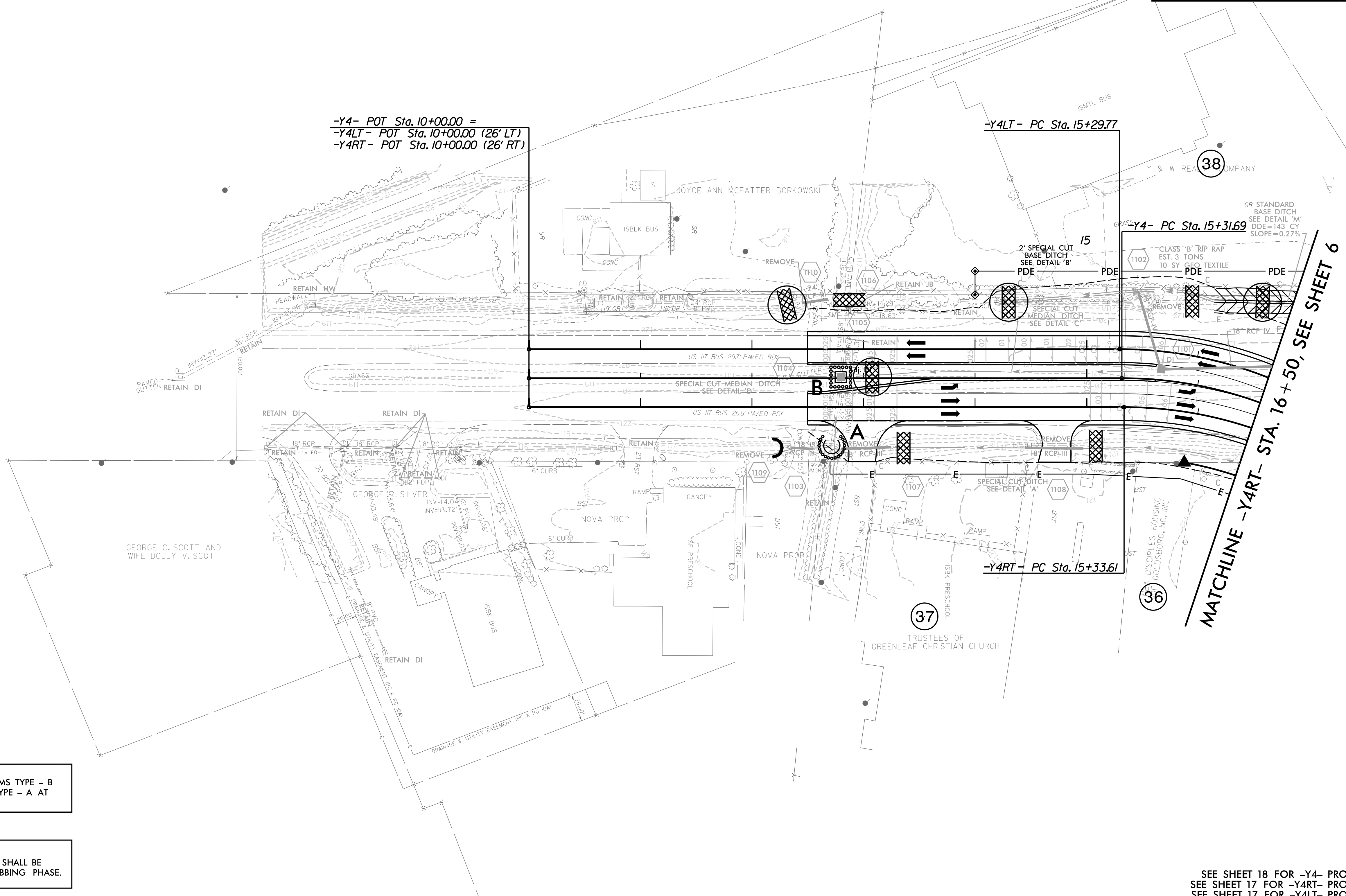

-Y4- POT Sta. 10+00.00 =
 -Y4LT- POT Sta. 10+00.00 (26' LT)
 -Y4RT- POT Sta. 10+00.00 (26' RT)

-Y4LT- PC Sta. 15+29.77

-Y4- PC Sta. 15+31.69

-Y4RT- PC Sta. 15+33.61

MATCHLINE -Y4RT- STA. 16 + 50, SEE SHEET 6

UTILIZE FABRIC INSERT INLET PROTECTION (HIGH FLOW) IN LIEU OF ROCK INLET SEDIMENT TRAP TYPE C AS DIRECTED

CLEARING AND GRUBBING EROSION CONTROL FOR CONSTRUCTION SHEET 11

NOTE: PLACE TEMPORARY ROCK SEDIMENT DAMS TYPE - B AND TEMPORARY ROCK SILT CHECKS TYPE - A AT DRAINAGE OUTLETS.

NOTE: PERIMETER EROSION CONTROL MEASURES SHALL BE INSTALLED DURING CLEARING AND GRUBBING PHASE.

SEE SHEET 18 FOR -Y4- PROFILE
 SEE SHEET 17 FOR -Y4RT- PROFILE
 SEE SHEET 17 FOR -Y4LT- PROFILE
 SEE SHEET 2D-1 FOR DRAINAGE DITCH DETAILS
 DRIVEWAY RADII 10' UNLESS OTHERWISE NOTED