

PROJECT REFERENCE NO.	SHEET NO.
U-2714	EC-10/CONST.10
R/W SHEET NO.	RW-10
ROADWAY DESIGN ENGINEER	HYDRAULICS ENGINEER

HDR HDR Engineering, Inc. of the Carolinas
 555 Fayetteville St. Suite 900 Raleigh, N.C. 27601
 N.C.B.E.L.S. License Number: F-0116

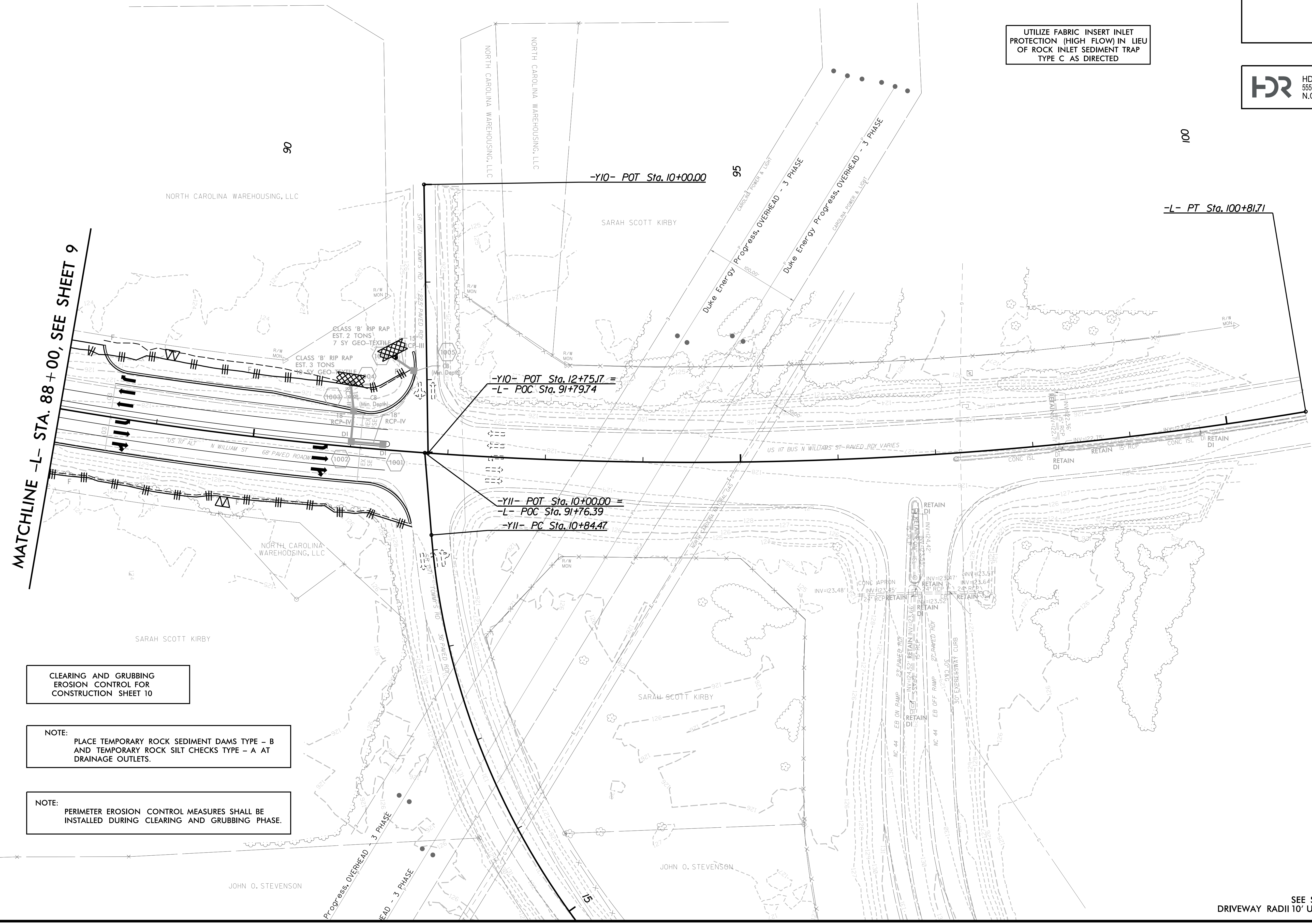

UTILIZE FABRIC INSERT INLET PROTECTION (HIGH FLOW) IN LIEU OF ROCK INLET SEDIMENT TRAP TYPE C AS DIRECTED



MATCHLINE -L- STA. 88+00, SEE SHEET 9

CLEARING AND GRUBBING
 EROSION CONTROL FOR
 CONSTRUCTION SHEET 10

NOTE:
 PLACE TEMPORARY ROCK SEDIMENT DAMS TYPE - B
 AND TEMPORARY ROCK SILT CHECKS TYPE - A AT
 DRAINAGE OUTLETS.

NOTE:
 PERIMETER EROSION CONTROL MEASURES SHALL BE
 INSTALLED DURING CLEARING AND GRUBBING PHASE.

SEE SHEET 15 FOR -L- PROFILE
 DRIVEWAY RADII 10' UNLESS OTHERWISE NOTED

PLOT DRIVER: NCDOT_pdf_color_eng_50.plt
 USER: MDIEHL
 DATE: 12/10/2019
 TIME: 5:05:41 PM
 FILE: North_Carolina_Dept_of_Transportation\NCDOT_Western_Div_On-Call\M_NCDOT-U2714_US117.cad_CAD-BIM\6.2_Work_In_Progress\U-2714_NCDOT_File_Structure\Erosion_Control\U2714_EC_PSH.dgn

REVISIONS