

EXISTING 1 4 24 NCDOT ITS
 2 4 144 NCDOT ITS
 29
 40A 52A
 53 66
 EXISTING 1 4 24 NCDOT ITS

1 4 24 NCTA
 1 4 144 NCDOT ITS
 7
 8
 2 14 2
 18
 SEE NOTE 5

40A 52A
 53 66

1 4 24 NCTA
 1 4 144 NCDOT ITS
 7
 8
 2 14 2
 18
 SEE NOTE 5

EXISTING 1 4 24 NCDOT ITS
 1 4 24 NCDOT ITS
 7
 8
 2 14 2
 18
 SEE NOTE 4

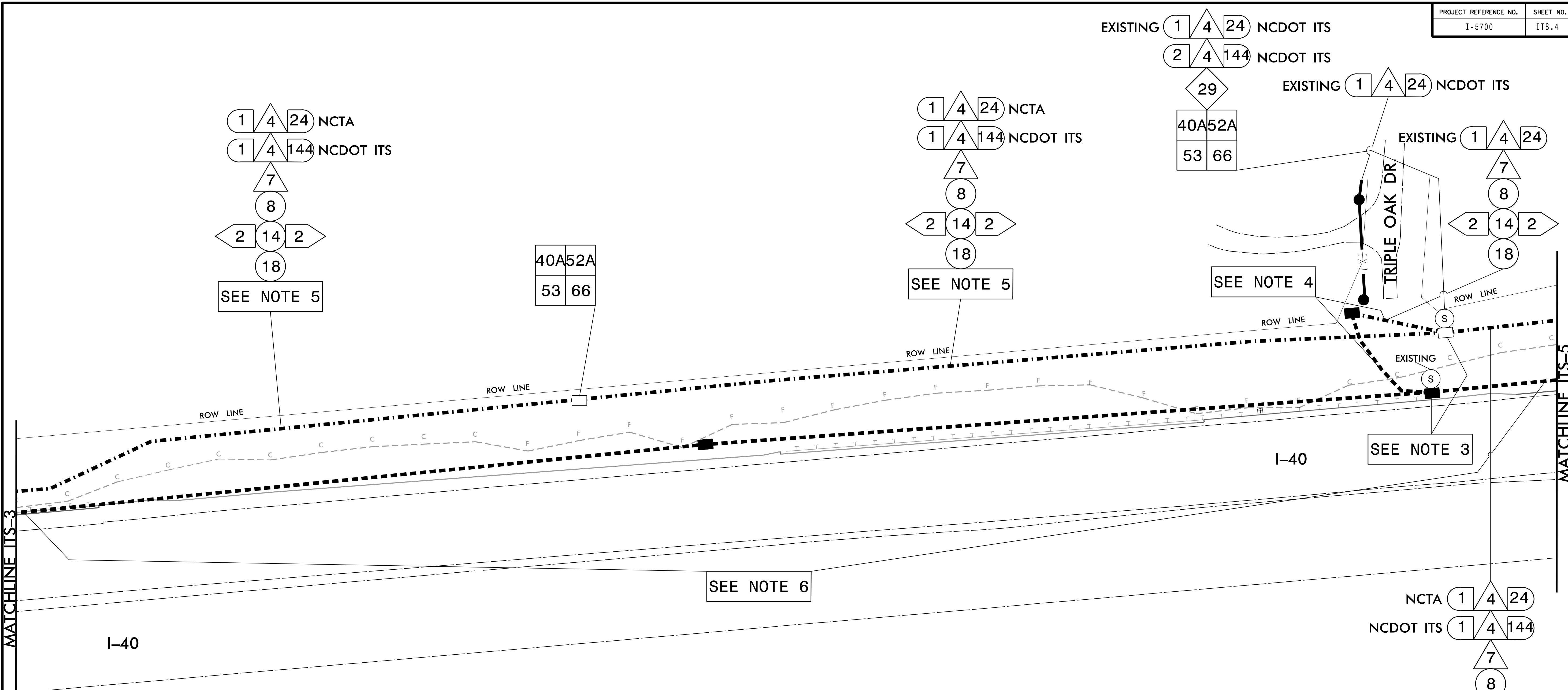

- 1) NOTIFY THE DIVISION 05 REGIONAL ITS ENGINEER, CLIFF BRAAM, AT 919-825-2635 FIVE (5) DAYS PRIOR TO BEGINNING WORK ON FIBER-OPTIC SYSTEM COMMUNICATIONS CABLE. NOTIFY THE REGIONAL ITS ENGINEER AFTER ALL WORK IS PERFORMED TO ENSURE THAT ALL FIBER CIRCUITS ARE FUNCTIONING PROPERLY. ALL WORK IS NOT COMPLETE UNTIL THE FIBER-OPTIC SYSTEM IS BACK UP AND OPERATIONAL.
- 2) NOTIFY THE NORTH CAROLINA TURNPIKE AUTHORITY ROADSIDE TOLL TECHNOLOGY MANAGER, RACHEL RUIZ, AT 919-710-0115 FIVE (5) DAYS PRIOR TO BEGINNING WORK ON FIBER-OPTIC SYSTEM COMMUNICATIONS CABLE. NOTIFY THE ROADSIDE TOLL TECHNOLOGY MANAGER AFTER ALL WORK IS PERFORMED TO ENSURE THAT ALL FIBER CIRCUITS ARE FUNCTIONING PROPERLY. ALL WORK IS NOT COMPLETE UNTIL THE FIBER-OPTIC SYSTEM IS BACK UP AND OPERATIONAL.
- 3) CONTRACTOR SHALL RECORD CURRENT SPLICE ARRANGEMENT PRIOR TO REMOVAL OF EXISTING CABLE AND SPLICE ENCLOSURE AND SHALL REPLICATE THE SAME SPLICING FOR THE NEW CABLES AND SPLICE ENCLOSURE. DO NOT CUT OR SPLICE NEW NCTA 24-FIBER CABLE INTO THE NEW SPLICE ENCLOSURE.
- 4) BACKPULL EXISTING 24-FIBER CABLE FROM THE EXISTING SPLICE ENCLOSURE AND REROUTE THROUGH NEW CONDUIT TO THE NEW SPLICE ENCLOSURE.
- 5) INSTALL NEW CONDUIT SYSTEM AS CLOSE TO THE RIGHT OF WAY LINE AS POSSIBLE TO AVOID DAMAGE DURING FUTURE CONSTRUCTION IN THIS AREA.
- 6) AFTER NEW 144-FIBER AND 24-FIBER CABLES HAVE BEEN INSTALLED AND SPLICED, REMOVE EXISTING 60-FIBER, 72-FIBER AND 24-FIBER CABLES. REMOVE EXISTING JUNCTION BOXES AND BACKFILL WITH SUITABLE MATERIAL. ABANDON EXISTING CONDUIT IN PLACE.

NCTA 1 4 24
 NCDOT ITS 1 4 144
 7
 8
 2 14 2
 18
 SEE NOTE 5

TMP PHASE 1

DOCUMENT NOT CONSIDERED FINAL UNLESS ALL SIGNATURES COMPLETED

	COMMUNICATIONS CABLE AND CONDUIT ROUTING PLANS		SEAL NORTH CAROLINA PROFESSIONAL ENGINEER MOHD A. ASLAMI 032108
	DIVISION 05 WAKE COUNTY CARY PLAN DATE: JULY 2019 PREPARED BY: A. J. SKUCE REVIEWED BY: <i>Neil Berry</i> DATE:	REVISIONS:	
750 N. Greenfield Pkwy., Garner, NC 27529 SCALE: 1" = 50' 	DocuSigned by: <i>Mohd Aslami</i> 7/29/2019 DATE:		