

**This electronic collection of documents is provided
for the convenience of the user
and is Not a Certified Document –**

**The documents contained herein were originally issued
and sealed by the individuals whose names and license
numbers appear on each page, on the dates appearing
with their signature on that page.**

**This file or an individual page
shall not be considered a certified document.**

NOTE: PLACE TEMPORARY ROCK SEDIMENT DAMS TYPE - B AND TEMPORARY ROCK SILT CHECKS TYPE - A AT DRAINAGE OUTLETS.

NOTE: UTILIZE FABRIC INSERT INLET PROTECTION DEVICE IN LIEU OF ROCK INLET SEDIMENT TRAP TYPE-C AT LOCATIONS WHERE THEY CANNOT BE INSTALLED CORRECTLY OR IMPOUND WATER ON ACTIVE TRAVEL LANES

NOTE 1:
BERM DITCH
SEE RDWY STD. 240.01
-L- STA 126+50 TO 126+75 LT
-L- STA 126+75 TO 127+75 LT
-L- STA 127+75 TO 128+25 LT
-L- STA 128+25 TO 129+75 LT

Place Matting for Erosion Control on Slope as Work Allows. -Y11- Sta. 13+00-15+00 LT

Place Matting for Erosion Control on Slope as Work Allows. -L- Sta. 117+50-118+50 LT

Place Matting for Erosion Control on Slope as Work Allows. -L- Sta. 117+50-119+00 RT

Place Matting for Erosion Control on Slope as Work Allows. -L- Sta. 127+50-129+50 RT

MATCH LINE -L- STA 116+80
SEE SHEET NO. 11

MATCH LINE -L- STA 130+00
SEE SHEET NO. 12

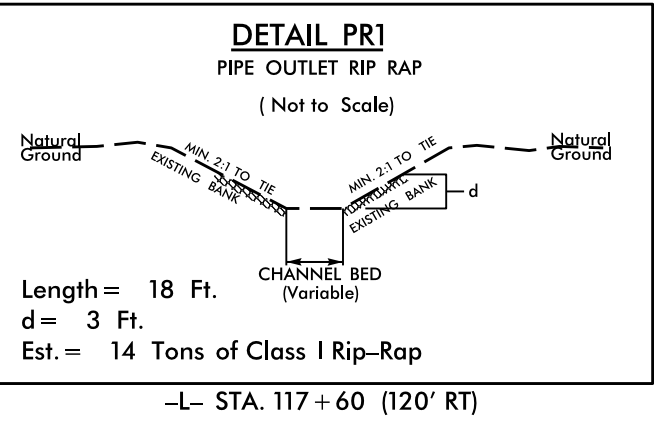
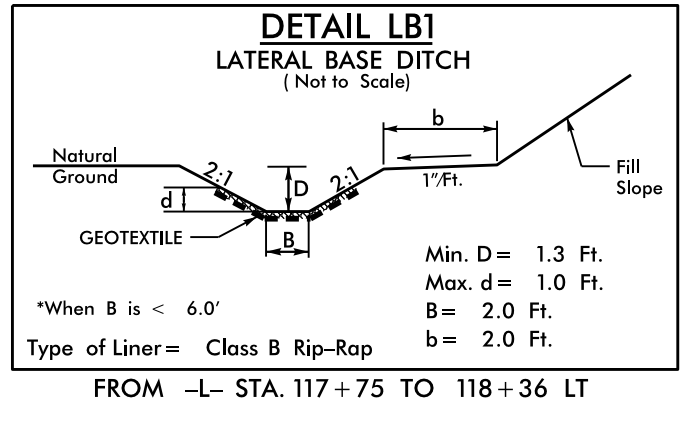
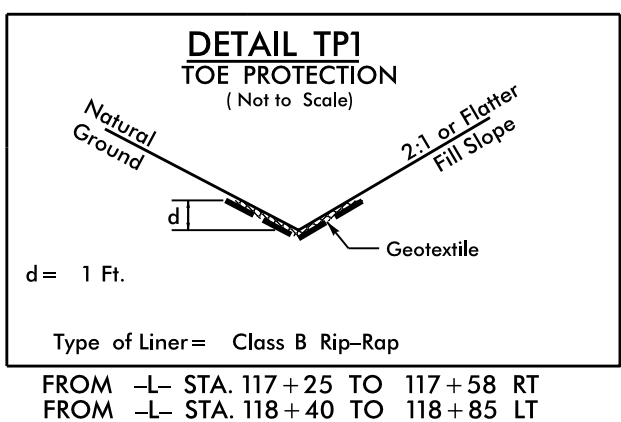
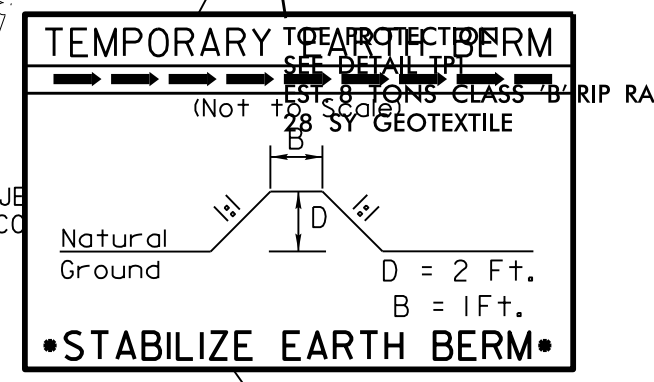

SEE SHEET 26 FOR -L- PROFILE
SEE SHEET 34 FOR -Y11- PROFILE
DRIVEWAY RADII ARE 10' UNLESS NOTED OTHERWISE.

8/17/19

8/2/2019
S:\Projects\190811C-EC-EC37_FINAL.dgn

PROJECT REFERENCE NO. A-0011C	SHEET NO. EC-38/CONST J3
RW SHEET NO.	HYDRAULICS ENGINEER
ROADWAY DESIGN ENGINEER	
Weston & Sampson	
WSE of North Carolina, PC 588 East Chatham Street Phone: 919.297.0220	NC License: C-4847 Suite 137 Cary, NC 27511 Fax: 919.297.0221

NOTE:
PLACE TEMPORARY ROCK SEDIMENT DAMS TYPE - B AND TEMPORARY ROCK SILT CHECKS TYPE - A AT DRAINAGE OUTLETS.

NOTE:
UTILIZE FABRIC INSERT INLET PROTECTION DEVICE IN LIEU OF ROCK INLET SEDIMENT TRAP TYPE-C AT LOCATIONS WHERE THEY CANNOT BE INSTALLED CORRECTLY OR IMPOUND WATER ON ACTIVE TRAVEL LANES

Place Matting for Erosion Control on Slope as Work Allows.
-Y11- Sta. 15+00-18+00 LT

Place Matting for Erosion Control on Slope as Work Allows.
-Y11- Sta. 15+75-17+50 RT

SEE SHEET 26 FOR -L- PROFILE
SEE SHEET 34 FOR -Y11-, -Y12-, & -Y13- PROFILES
SEE SHEET 2B-4 FOR -Y11-, -Y12- & -Y13- INTERSECTION DETAILS

DRIVEWAY RADII ARE 10' UNLESS NOTED OTHERWISE.

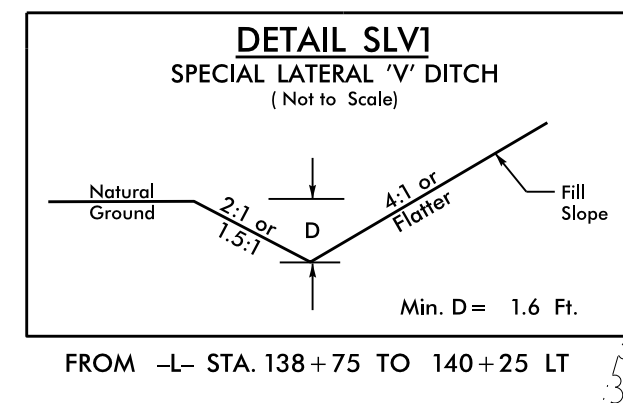
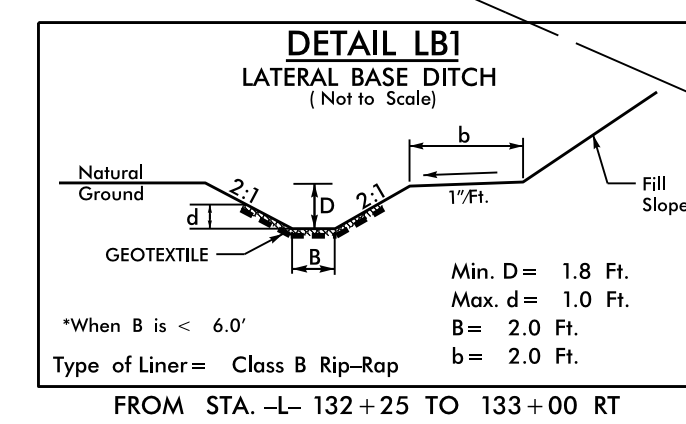
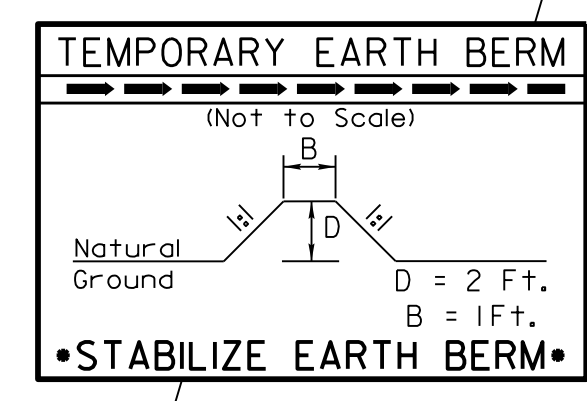
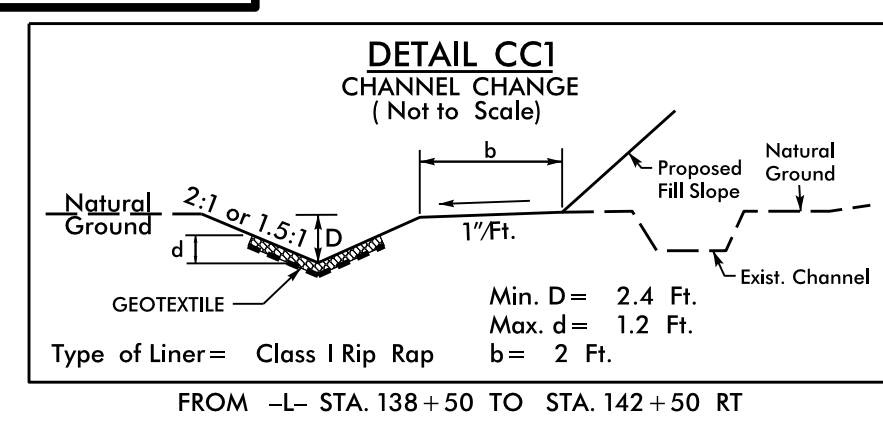

-L- POC Sta. 133+80.00
-Y11- POT Sta. 20+14.45
N 83° 17' 03.5" E (-Y11- BK)
-Y12- POT Sta. 10+00.00
N 86° 17' 03.5" E (-Y12- AH)

Place Matting for Erosion Control on Slope as Work Allows.
-Y11- Sta. 18+75 LT to -L- Sta. 137+50 LT

Place Matting for Erosion Control on Slope as Work Allows.
-L- Sta. 129+50-133+00 RT

Place Matting for Erosion Control on Slope as Work Allows.
-L- Sta. 139+00-142+00 RT

Place Matting for Erosion Control on Slope as Work Allows.
-Y13- Sta. 11+00-12+00 RT

Place Matting for Erosion Control on Slope as Work Allows.
-L- Sta. 135+00-136+50 RT

99' x 35' x 3'
2 inch Skimmer with 1.625 inch Orifice Diameter
13 ft. weir
ID 13.1

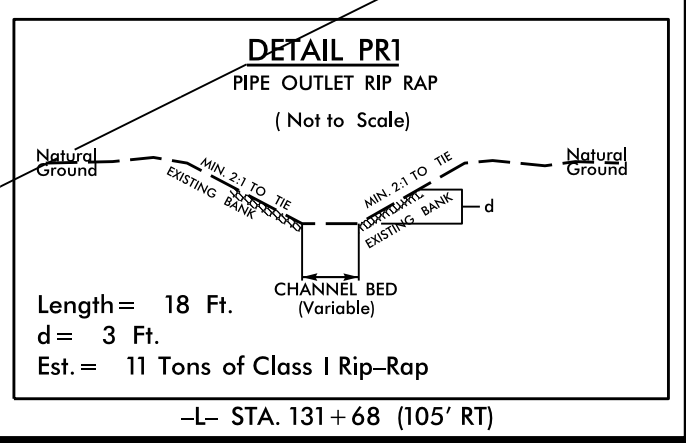

8/17/2019 8:21:29 AM C:\Users\ec\0011C-EC-38.FINAL.dgn

PROJECT REFERENCE NO. A-0011C	SHEET NO. EC-39/CONST J4
RW SHEET NO.	HYDRAULICS ENGINEER
ROADWAY DESIGN ENGINEER	
Weston & Sampson WSE of North Carolina, PC 588 East Chatham Street Phone: 919.297.0220	
NC License: C-4847 Cory, NC 27511 Fax: 919.297.0221	

NOTE: PLACE TEMPORARY ROCK SEDIMENT DAMS TYPE - B AND TEMPORARY ROCK SILT CHECKS TYPE - A AT DRAINAGE OUTLETS.

NOTE: UTILIZE FABRIC INSERT INLET PROTECTION DEVICE IN LIEU OF ROCK INLET SEDIMENT TRAP TYPE-C AT LOCATIONS WHERE THEY CANNOT BE INSTALLED CORRECTLY OR IMPOUND WATER ON ACTIVE TRAVEL LANES

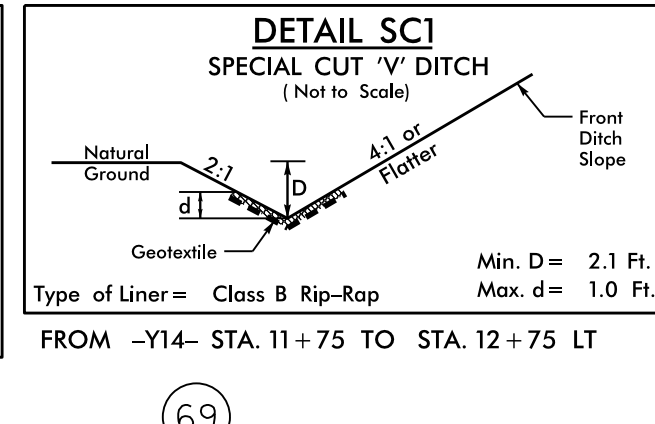
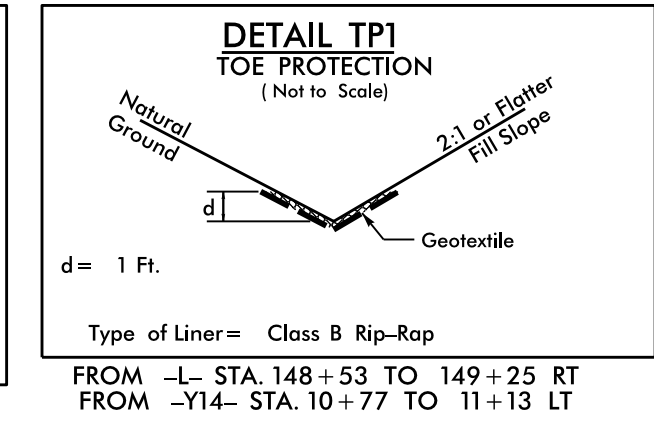
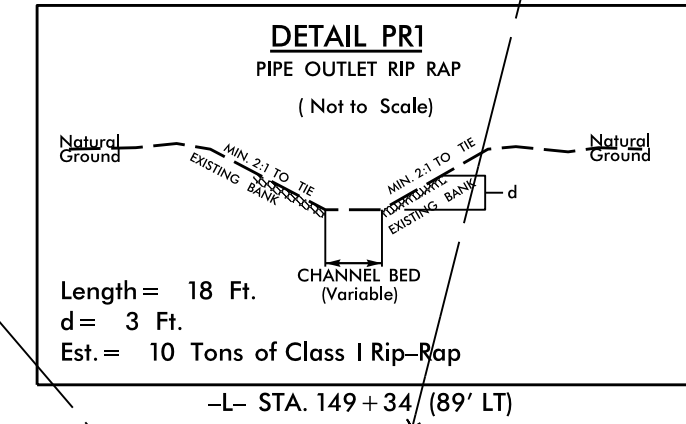
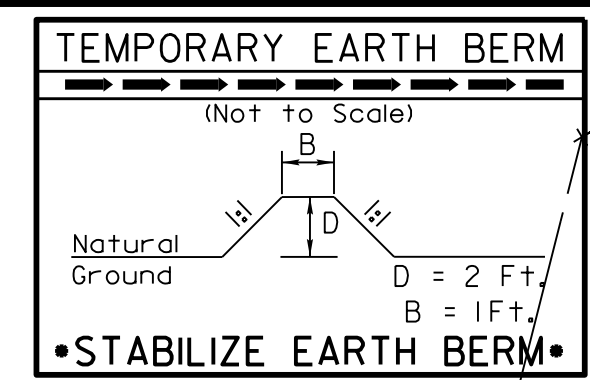

SEE SHEET 27 FOR -L- PROFILE
SEE SHEET 35 FOR -Y14- & -Y15- PROFILES
SEE SHEET 28-5 FOR -Y14- & -Y15- INTERSECTION DETAILS

DRIVEWAY RADII ARE 10' UNLESS NOTED OTHERWISE.

Place Matting for Erosion Control on Slope as Work Allows.
-L- Sta. 141+50-147+00 LT

Place Matting for Erosion Control on Slope as Work Allows.
-L- Sta. 142+00-147+00 RT

Place Matting for Erosion Control on Slope as Work Allows.
-Y14- Sta. 11+75-12+75 LT

Place Matting for Erosion Control on Slope as Work Allows.
-L- Sta. 149+70-152+50 RT

Place Matting for Erosion Control on Slope as Work Allows.
-Y15- Sta. 11+50 LT to -L- Sta. 155+00 RT

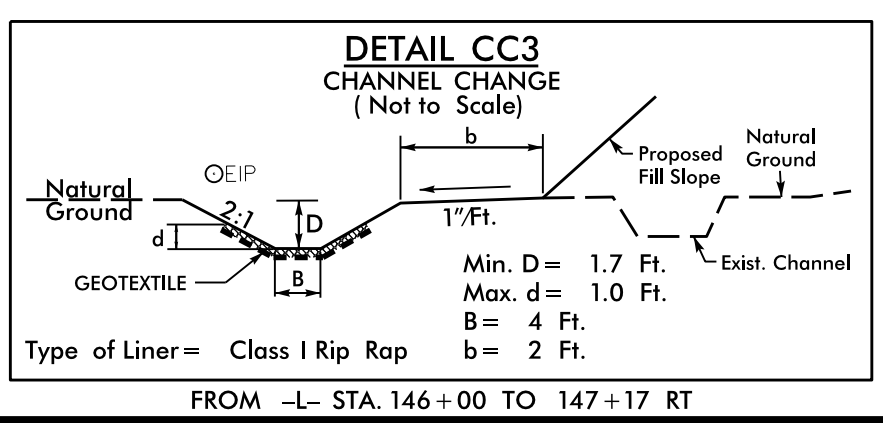
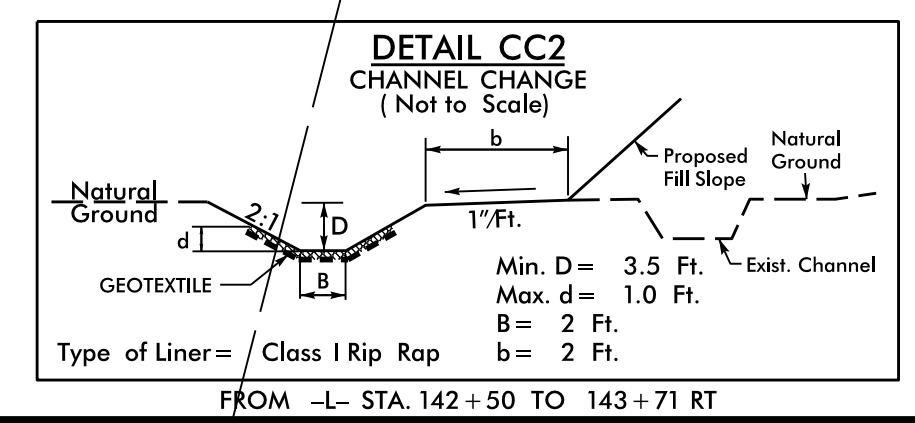
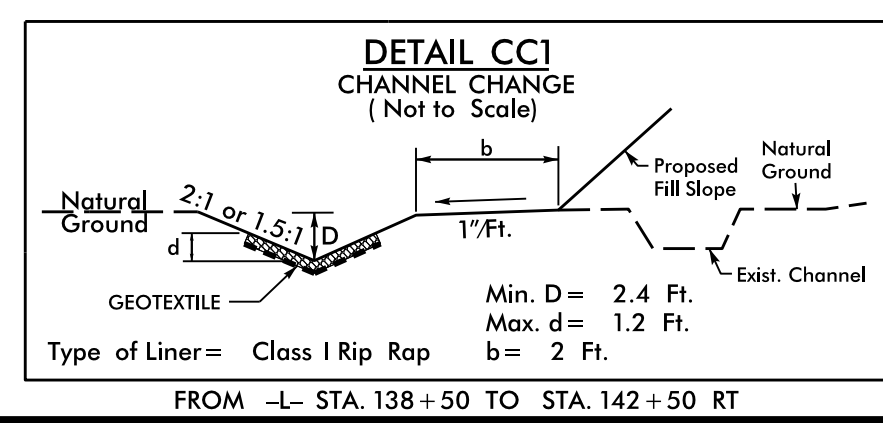

8/17/99
8/2/2019
C:\Users\jcs\OneDrive\EC-0011C-EC-39_FINAL.dgn

PROJECT REFERENCE NO. A-0011C	SHEET NO. EC-40/CONSTJ5
ROADWAY DESIGN ENGINEER	HYDRAULICS ENGINEER
Weston Sampson	
WSE of North Carolina, PC 588 East Chatham Street Phone: 919.297.0220	NC License: C-4847 Suite 137 Cary, NC 27511 Fax: 919.297.0221

NOTE: UTILIZE FABRIC INSERT INLET PROTECTION DEVICE IN LIEU OF ROCK INLET SEDIMENT TRAP TYPE-C AT LOCATIONS WHERE THEY CANNOT BE INSTALLED CORRECTLY OR IMPOUND WATER ON ACTIVE TRAVEL LANES

NOTE: PLACE TEMPORARY ROCK SEDIMENT DAMS TYPE - B AND TEMPORARY ROCK SILT CHECKS TYPE - A AT DRAINAGE OUTLETS.

PARCELS 78 & 79 DETERMINED ELIGIBLE FOR LISTING ON NATIONAL REGISTER OF HISTORIC PLACES

NAD 83 NA 2011

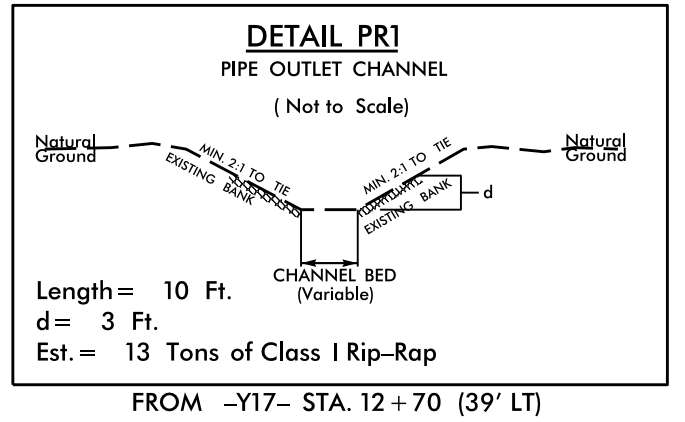
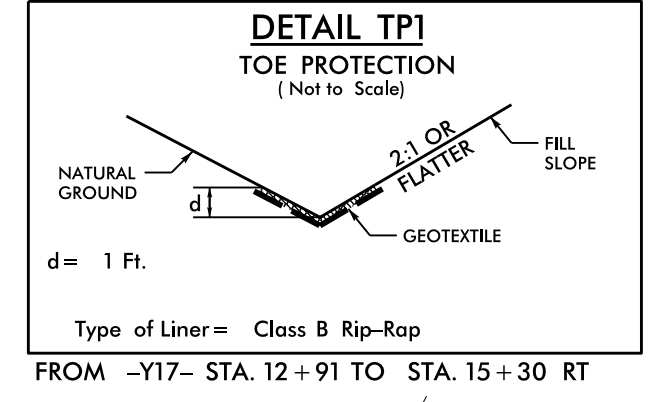

46' x 18' x 3'
1.5 inch Skimmer
with 0.75 inch
Orifice Diameter
4 ft. weir
ID 15.2

25' x 12' x 3'
1.5 inch Skimmer
with 0.375 inch
Orifice Diameter
4 ft. weir
ID 15.1

Place Matting for Erosion Control
on Slope as Work Allows.
-Y17- Sta. 14+00-14+75 LT

Place Matting for Erosion Control
on Slope as Work Allows.
-Y16- Sta. 12+00-13+25 LT

Place Matting for Erosion Control
on Slope as Work Allows.
-L- Sta. 155+00 RT to -DR161- Sta. 11+00 RT

Place Matting for Erosion Control
on Slope as Work Allows.
-L- Sta. 162+50-168+00 RT

SEE SHEET 27 FOR -L- PROFILE
SEE SHEET 35 FOR -Y16- & -Y17- PROFILES
SEE SHEET 38 FOR -DR161- PROFILE
SEE SHEET 2B-5 FOR -Y16-, -Y17-, & -DR161-
INTERSECTION DETAILS

DRIVEWAY RADII ARE 10' UNLESS NOTED OTHERWISE.

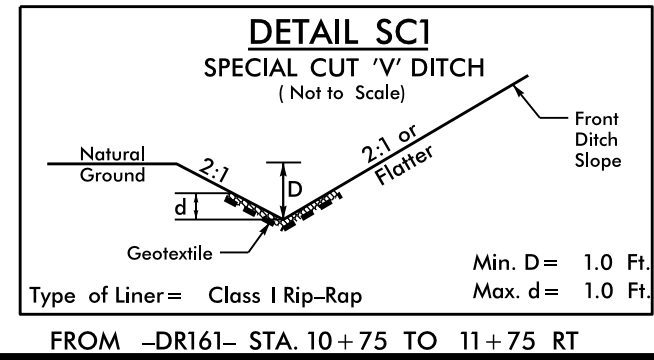
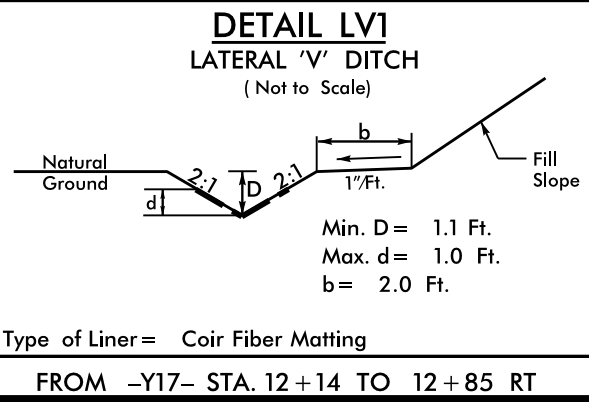

8/17/19 8/2/2019 8:21:03 AM \\s:\projects\190011C-EC-EC40-FINAL.dgn

PROJECT REFERENCE NO. A-0011C	SHEET NO. EC-41/CONST.16
RW SHEET NO.	
ROADWAY DESIGN ENGINEER	HYDRAULICS ENGINEER
Weston & Sampson WSE of North Carolina, PC 588 East Chatham Street Phone: 919.297.0220	
NC License: C-4847 Suite 137 Cary, NC 27511 Fax: 919.297.0221	

SEE SHEET 28 FOR -L- PROFILE
 DRIVEWAY RADII ARE 10' UNLESS NOTED OTHERWISE.

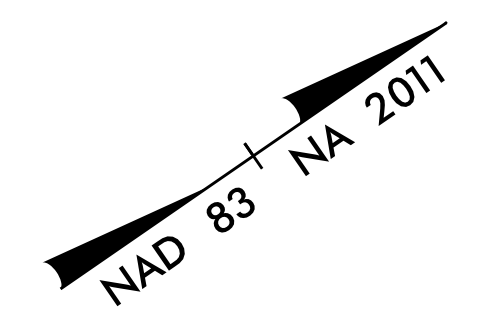

80A
 DAVID DEERING, AND WIFE,
 SUZANNE DEERING

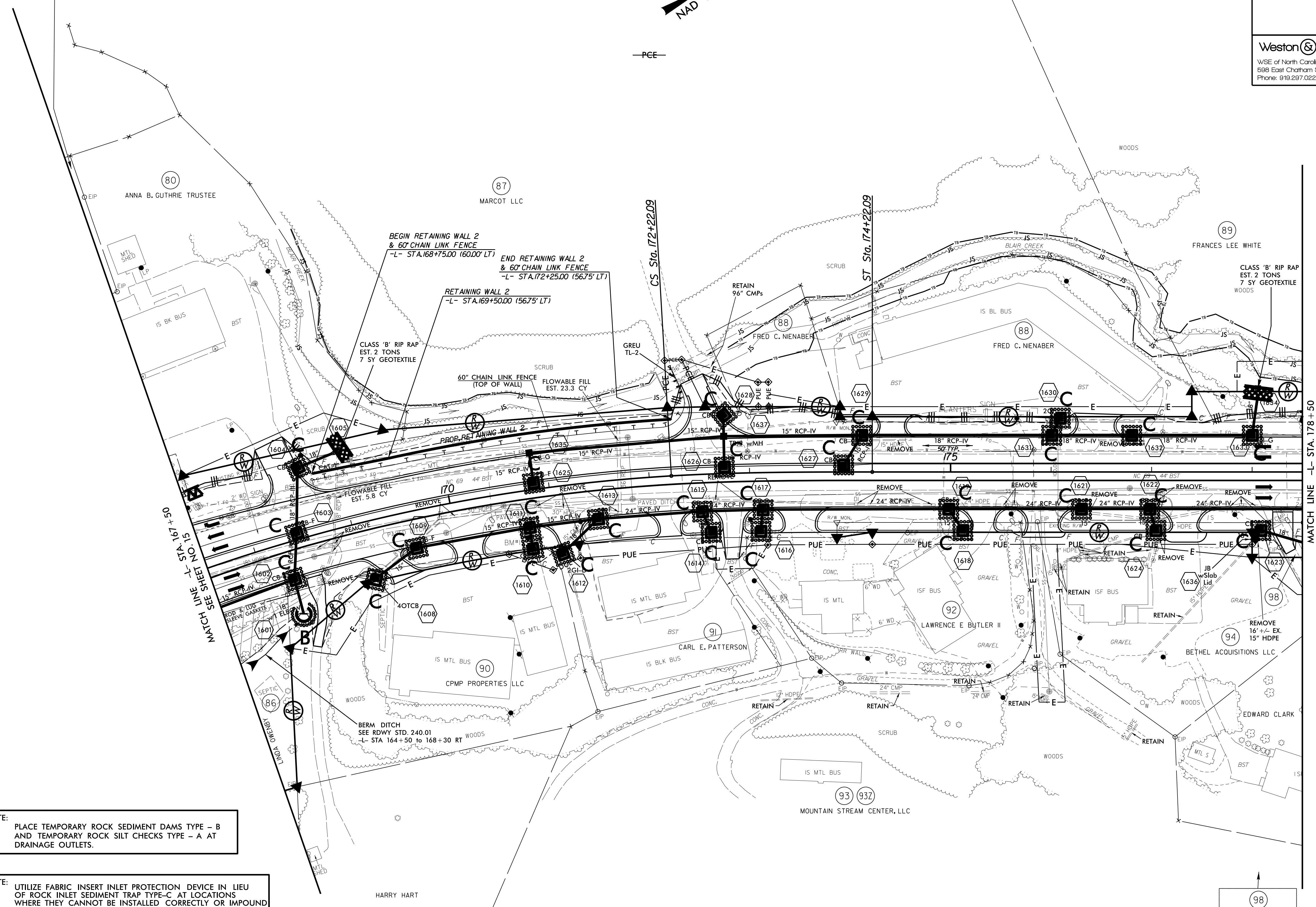

NOTE:
 PLACE TEMPORARY ROCK SEDIMENT DAMS TYPE - B AND TEMPORARY ROCK SILT CHECKS TYPE - A AT DRAINAGE OUTLETS.

NOTE:
 UTILIZE FABRIC INSERT INLET PROTECTION DEVICE IN LIEU OF ROCK INLET SEDIMENT TRAP TYPE-C AT LOCATIONS WHERE THEY CANNOT BE INSTALLED CORRECTLY OR IMPOUND WATER ON ACTIVE TRAVEL LANES

98
 FRANCIS H GARRETT
 LIFE ESTATE

8/17/19
 8/16/2019
 C:\Users\jcs\OneDrive\EC-A0011C-EC-EC41.FINAL.dgn

MATCH LINE -L- STA. 174+50
 SEE SHEET NO. 17

MATCH LINE -L- STA. 178+50
 SEE SHEET NO. 17

PROJECT REFERENCE NO. A-0011C	SHEET NO. EC-42/CONST-17
RW SHEET NO.	HYDRAULICS ENGINEER
ROADWAY DESIGN ENGINEER	HYDRAULICS ENGINEER
Weston & Sampson WSE of North Carolina, PC 588 East Chatham Street Phone: 919.297.0220	
NC License: C-4847 Cary, NC 27511 Fax: 919.297.0221	

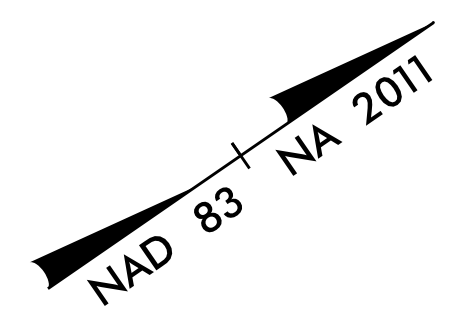
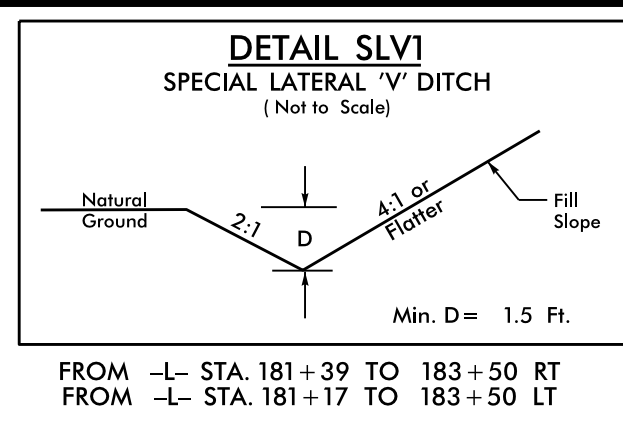
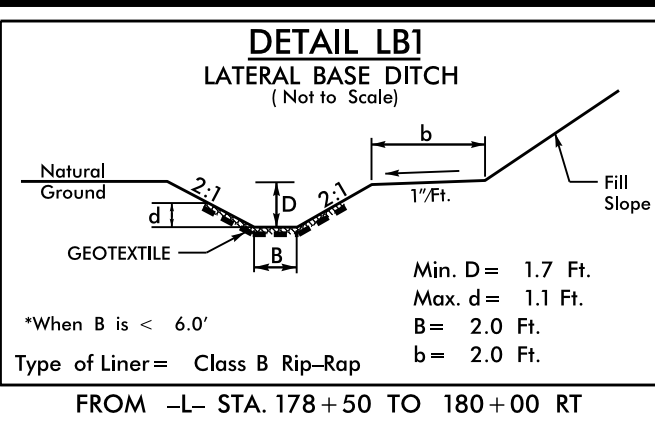
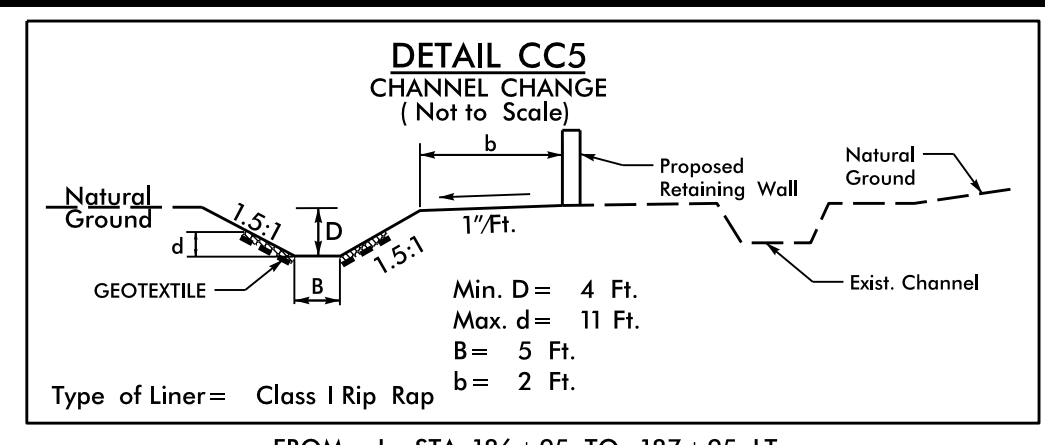

SEE SHEET 28 FOR -L- PROFILE
 DRIVEWAY RADII ARE 10' UNLESS NOTED OTHERWISE.

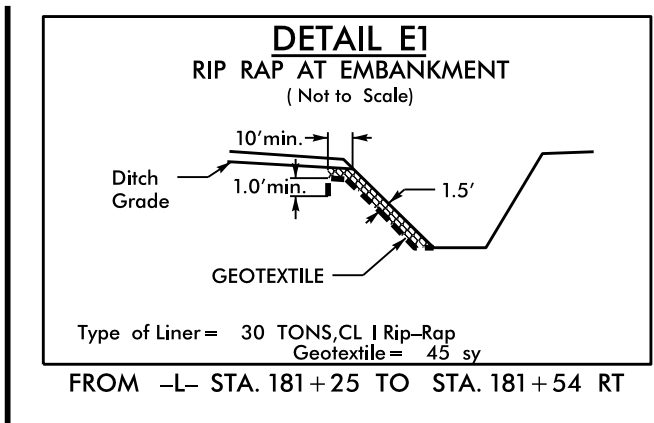

NOTE: UTILIZE FABRIC INSERT INLET PROTECTION DEVICE IN LIEU OF ROCK INLET SEDIMENT TRAP TYPE-C AT LOCATIONS WHERE THEY CANNOT BE INSTALLED CORRECTLY OR IMPOUND WATER ON ACTIVE TRAVEL LANES

NOTE: PLACE TEMPORARY ROCK SEDIMENT DAMS TYPE - B AND TEMPORARY ROCK SILT CHECKS TYPE - A AT DRAINAGE OUTLETS.

FROM -L- STA. 186+95 TO 187+95 LT

FROM -L- STA. 178+50 TO 180+00 RT

FROM -L- STA. 181+39 TO 183+50 RT
 FROM -L- STA. 181+17 TO 183+50 LT

116' x 36' x 3'
 2 inch Skimmer
 with 1.75 inch Orifice Diameter
 16 ft. weir
 ID 17.1

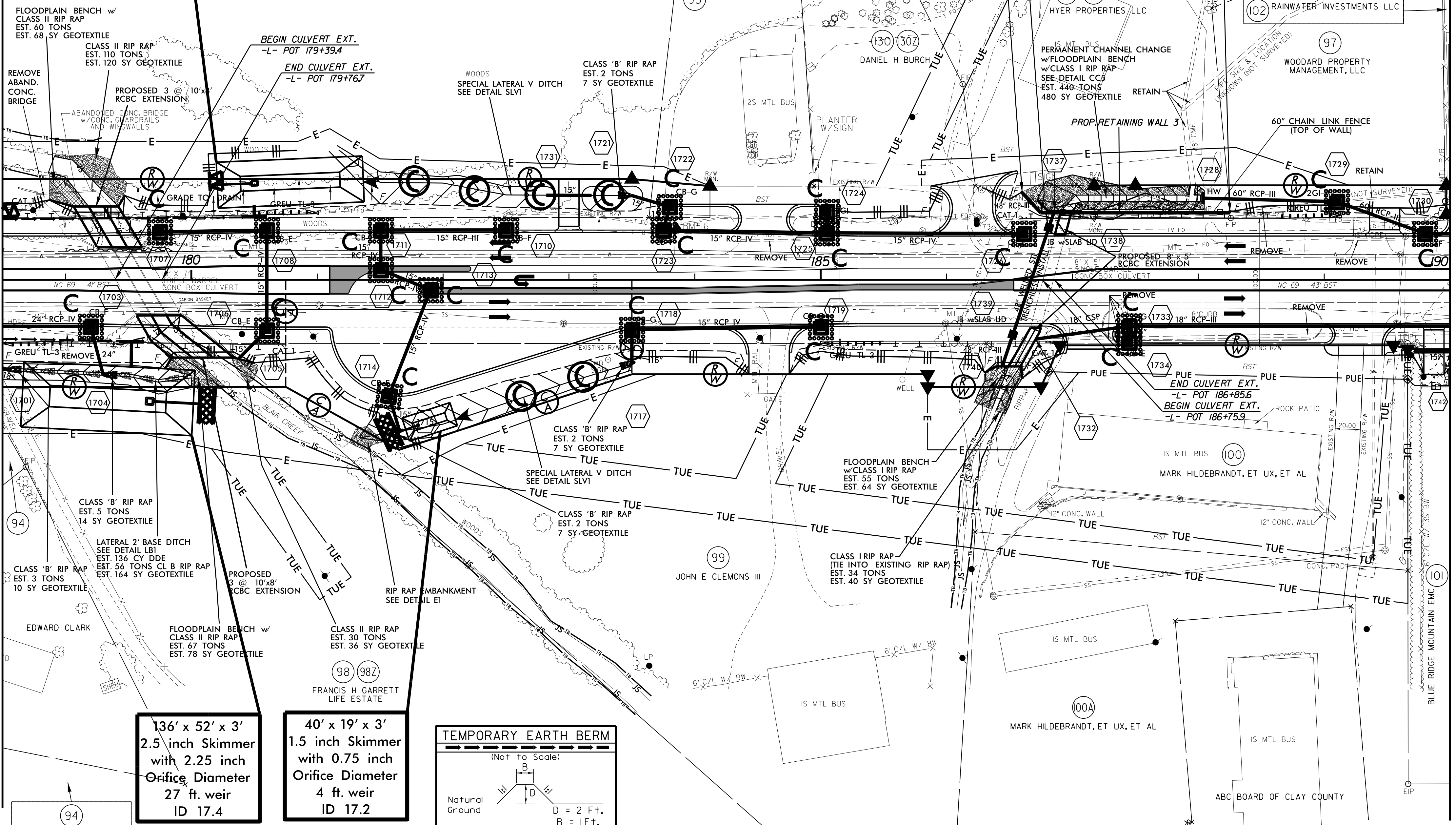

MATCH LINE -L- STA. 178+50
 SEE SHEET NO. 16

MATCH LINE -L- STA. 190+00
 SEE SHEET NO. 18

BETHEL ACQUISITIONS LLC

136' x 52' x 3'
 2.5 inch Skimmer
 with 2.25 inch Orifice Diameter
 27 ft. weir
 ID 17.4

40' x 19' x 3'
 1.5 inch Skimmer
 with 0.75 inch Orifice Diameter
 4 ft. weir
 ID 17.2

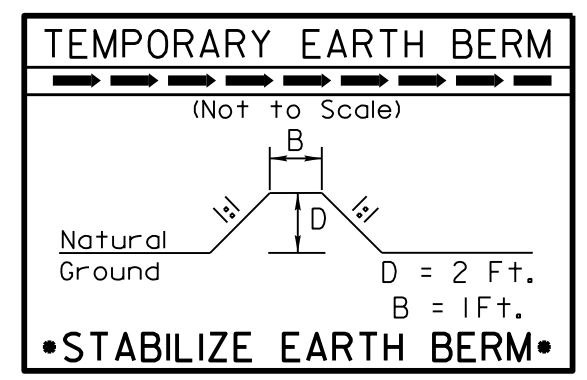

FOR CULVERT PLANS, SEE SHEETS C2-1 THRU C2-12

FOR CULVERT PLANS, SEE SHEETS C3-1 THRU C2-11

8/17/19

8/2/2019
 C:\Users\ec\0011C-EC-42-FINAL.dgn
 5:36:31 PM

PROJECT REFERENCE NO. A-0011C	SHEET NO. EC-43/CONST.B
RW SHEET NO.	HYDRAULICS ENGINEER
ROADWAY DESIGN ENGINEER	
WSE of North Carolina, PC 588 East Chatham Street Phone: 919.297.0220	NC License: C-4847 Suite 137 Cary, NC 27511 Fax: 919.297.0221

NOTE: PLACE TEMPORARY ROCK SEDIMENT DAMS TYPE - B AND TEMPORARY ROCK SILT CHECKS TYPE - A AT DRAINAGE OUTLETS.

NOTE: UTILIZE FABRIC INSERT INLET PROTECTION DEVICE IN LIEU OF ROCK INLET SEDIMENT TRAP TYPE-C AT LOCATIONS WHERE THEY CANNOT BE INSTALLED CORRECTLY OR IMPOUND WATER ON ACTIVE TRAVEL LANES

SEE SHEET 29 FOR -L- PROFILE
SEE SHEET 36 FOR -Y18- & -Y19- PROFILES
SEE SHEET 2B-5 FOR -Y18- & -Y19- INTERSECTION DETAILS

DRIVEWAY RADII ARE 10' UNLESS NOTED OTHERWISE.

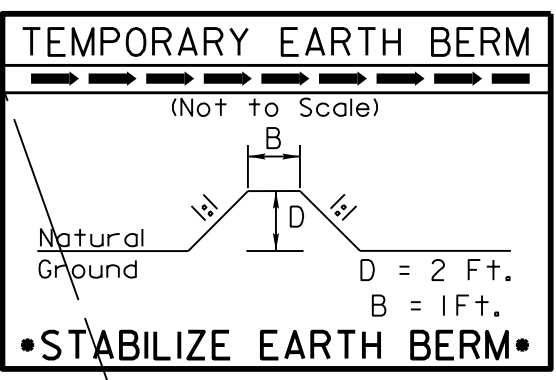

Place Matting for Erosion Control on Slope as Work Allows.
-L- Sta. 10+75-13+50 LT

Place Matting for Erosion Control on Slope as Work Allows.
-L- Sta. 193+00-196+50 RT

Place Matting for Erosion Control on Slope as Work Allows.
-L- Sta. 199+50-202+00 RT

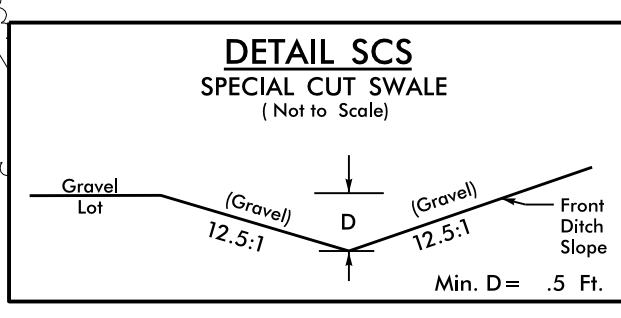
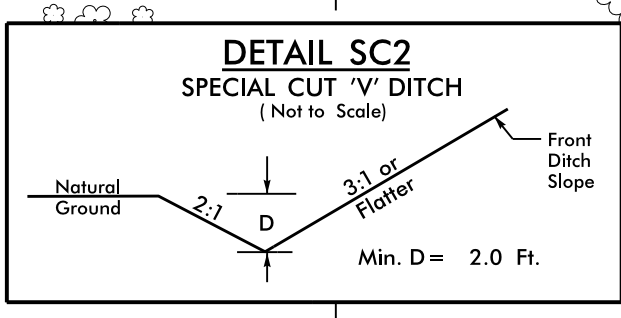
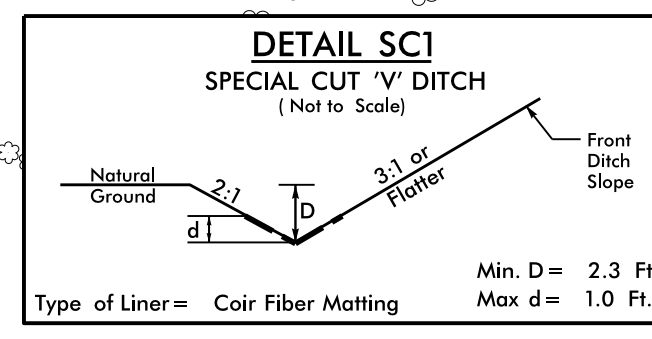
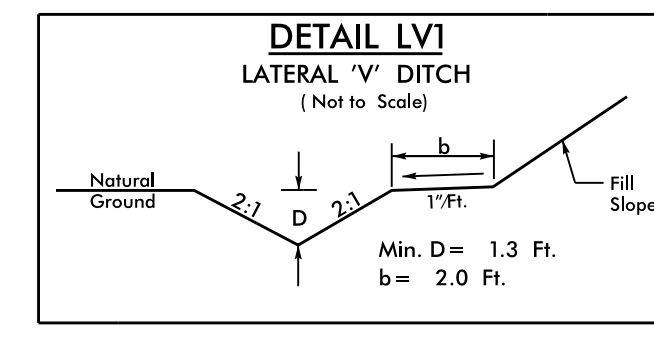

FROM -Y19- STA. 16+42 TO 18+25 RT
FROM -Y19- STA. 16+65 TO 18+25 LT

FROM -Y18- STA. 11+30 TO 12+00 LT

FROM -Y18- STA. 12+00 TO 13+00 LT

FROM -Y18- STA. 11+75 TO STA. 13+00 RT

MATCH LINE -L- STA. 190+00
SEE SHEET NO. 17

MATCH LINE -L- STA. 202+00
SEE SHEET NO. 19

8/17/19

8/17/2019
C:\Users\ec\OneDrive\EC-43_FINAL.dgn
5:36:43 AM

PROJECT REFERENCE NO. A-0011C	SHEET NO. EC-44/CONSTJ9
RW SHEET NO.	HYDRAULICS ENGINEER
ROADWAY DESIGN ENGINEER	
Weston & Sampson	
WSE of North Carolina, PC 588 East Chatham Street Phone: 919.297.0220	NC License: C-4847 Suite 137 Cary, NC 27511 Fax: 919.297.0221

SEE SHEET 29 FOR -L- PROFILE
SEE SHEET 37 FOR -Y20- PROFILE
SEE SHEET 2B-6 FOR -Y20- INTERSECTION DETAIL

DRIVEWAY RADII ARE 10' UNLESS NOTED OTHERWISE.

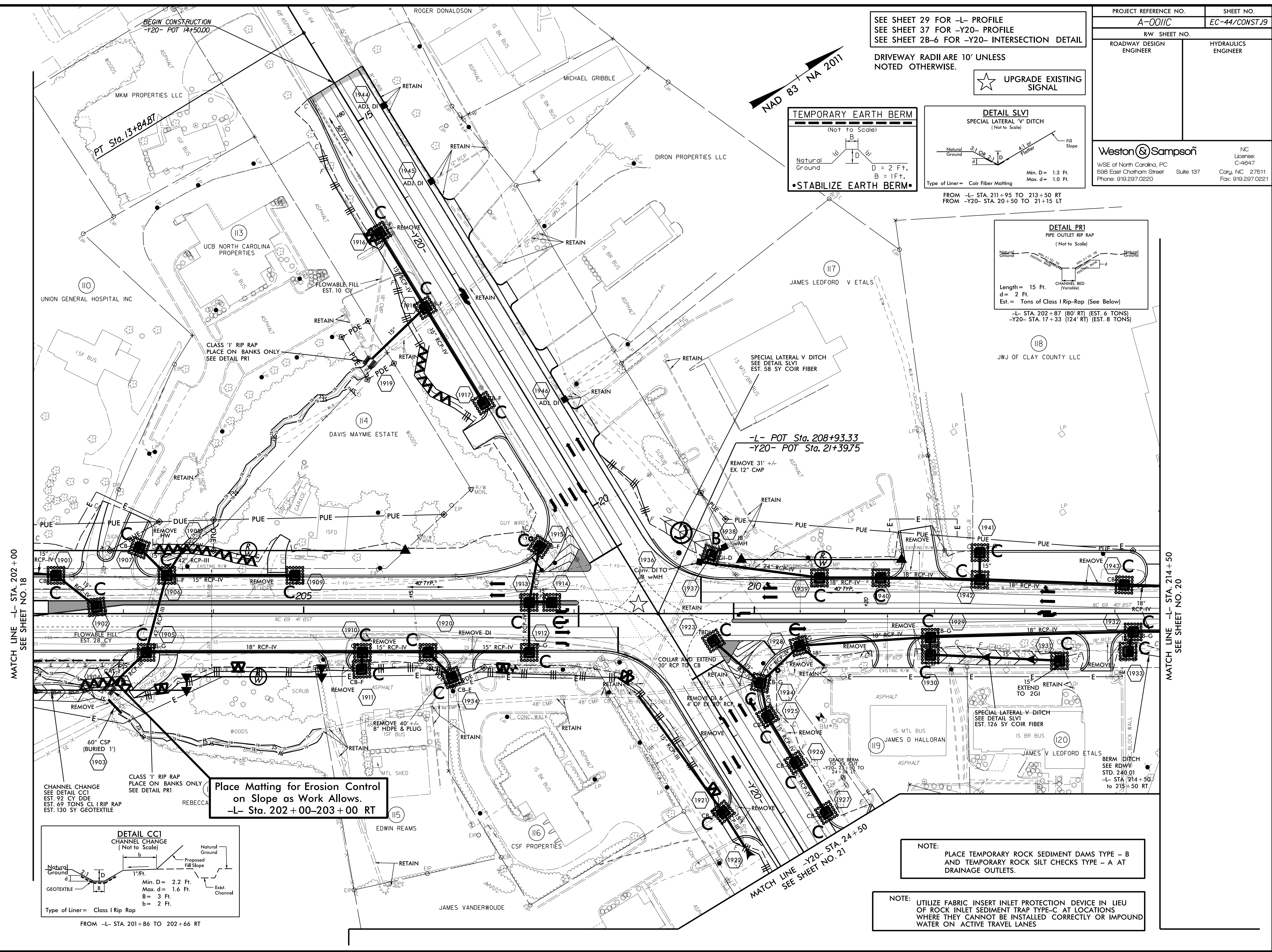
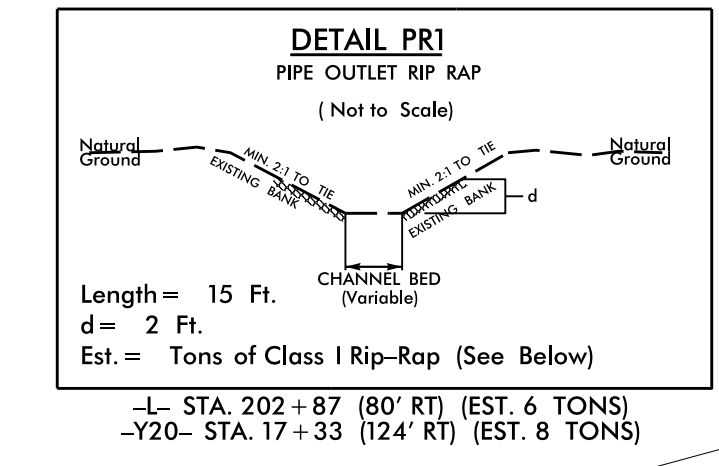
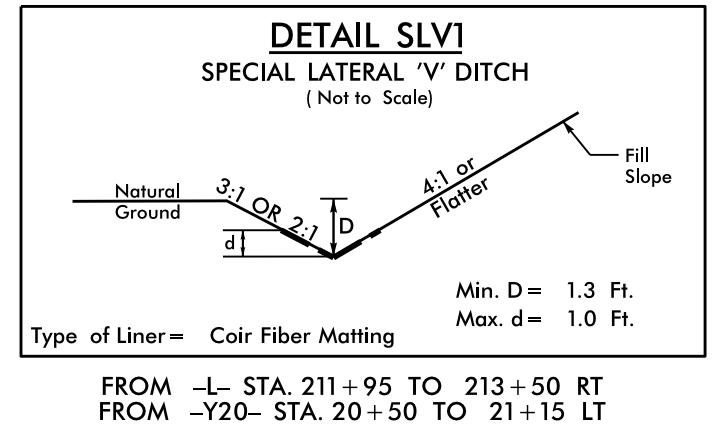
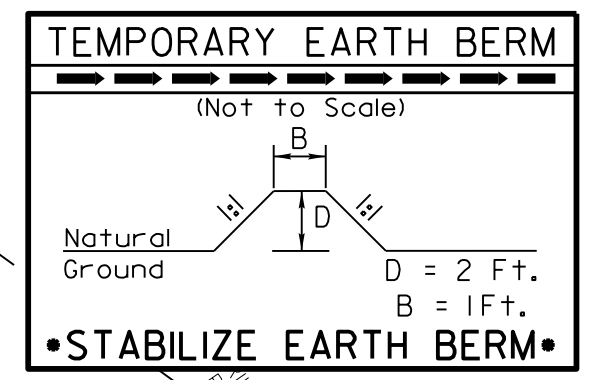
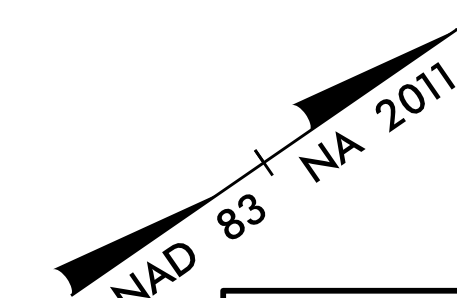

MATCH LINE -L- STA. 202+00
SEE SHEET NO. 18

MATCH LINE -L- STA. 214+50
SEE SHEET NO. 20

Place Matting for Erosion Control on Slope as Work Allows.
-L- Sta. 202+00-203+00 RT

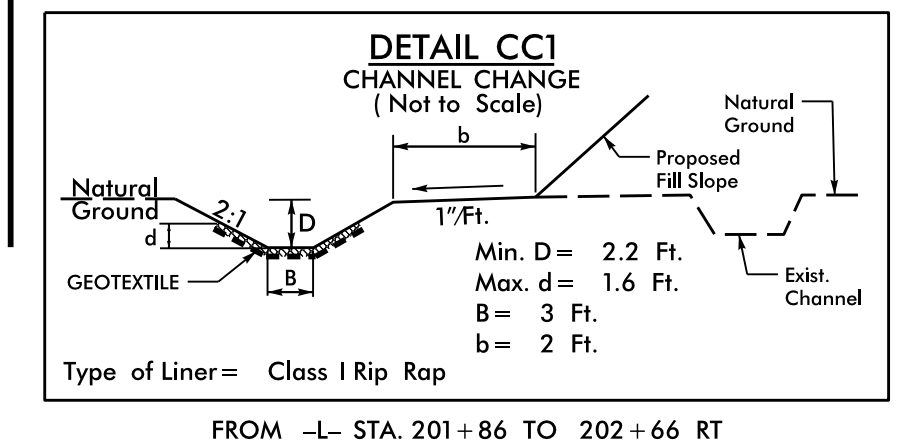

NOTE: PLACE TEMPORARY ROCK SEDIMENT DAMS TYPE - B AND TEMPORARY ROCK SILT CHECKS TYPE - A AT DRAINAGE OUTLETS.

NOTE: UTILIZE FABRIC INSERT INLET PROTECTION DEVICE IN LIEU OF ROCK INLET SEDIMENT TRAP TYPE - C AT LOCATIONS WHERE THEY CANNOT BE INSTALLED CORRECTLY OR IMPOUND WATER ON ACTIVE TRAVEL LANES

8/17/19
8/2/2019
S:\Projects\EC\A0011C-EC-EC44_FINAL.dgn

PROJECT REFERENCE NO. A-0011C	SHEET NO. EC-45/CONST.20
RW SHEET NO.	
ROADWAY DESIGN ENGINEER	HYDRAULICS ENGINEER
WSE of North Carolina, PC 588 East Chatham Street Phone: 919.297.0220	NC License: C-4847 Suite 137 Cary, NC 27511 Fax: 919.297.0221

SEE SHEET 30 FOR -L- PROFILE
SEE SHEET 38 FOR -Y21- PROFILE
SEE SHEET 2B-6 FOR -Y21- INTERSECTION DETAIL
DRIVEWAY RADII ARE 10' UNLESS NOTED OTHERWISE.

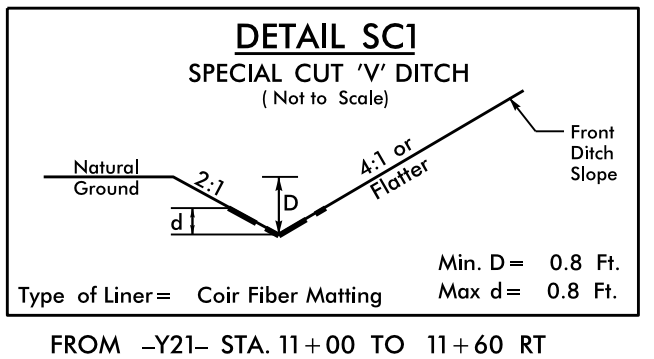

NOTE DRN
EXISTING DRAINAGE STRUCTURE MAY BE RETAINED AT THE DIRECTION OF THE ENGINEER

NOTE:
PLACE TEMPORARY ROCK SEDIMENT DAMS TYPE - B AND TEMPORARY ROCK SILT CHECKS TYPE - A AT DRAINAGE OUTLETS.

NOTE:
UTILIZE FABRIC INSERT INLET PROTECTION DEVICE IN LIEU OF ROCK INLET SEDIMENT TRAP TYPE-C AT LOCATIONS WHERE THEY CANNOT BE INSTALLED CORRECTLY OR IMPOUND WATER ON ACTIVE TRAVEL LANES

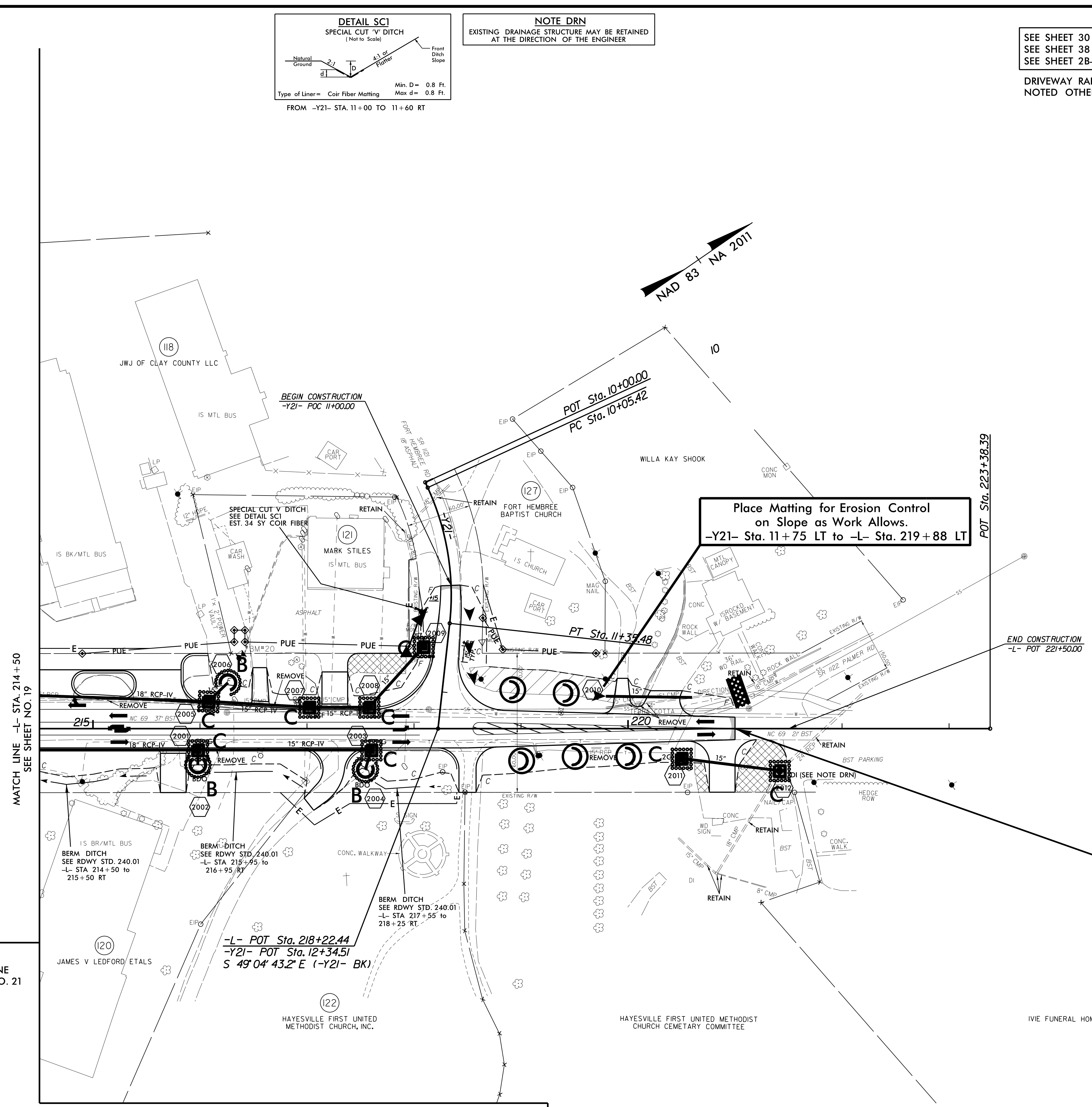

Place Matting for Erosion Control on Slope as Work Allows.
-Y21- Sta. 11+75 LT to -L- Sta. 219+88 LT

END T.I.P. PROJECT A-0011C
-L- POT 221+00.00

MATCH LINE
SEE SHEET NO. 21

MATCH LINE -L- STA. 214+50
SEE SHEET NO. 19

8/17/99

8/2/2019
S:\Projects\A-0011C-EC-45-FINAL.dgn
3:36:58 PM

PROJECT REFERENCE NO. A-0011C	SHEET NO. EC-46/CONST.21
RW SHEET NO.	
ROADWAY DESIGN ENGINEER	HYDRAULICS ENGINEER
	
W&S of North Carolina, PC 588 East Chatham Street Phone: 919.297.0220	NC License: C-4847 Suite 137 Cary, NC 27511 Fax: 919.297.0221

NOTE:
PLACE TEMPORARY ROCK SEDIMENT DAMS TYPE - B AND TEMPORARY ROCK SILT CHECKS TYPE - A AT DRAINAGE OUTLETS.

NOTE:
UTILIZE FABRIC INSERT INLET PROTECTION DEVICE IN LIEU OF ROCK INLET SEDIMENT TRAP TYPE-C AT LOCATIONS WHERE THEY CANNOT BE INSTALLED CORRECTLY OR IMPOUND WATER ON ACTIVE TRAVEL LANES

MATCH LINE
SEE SHEET NO. 20

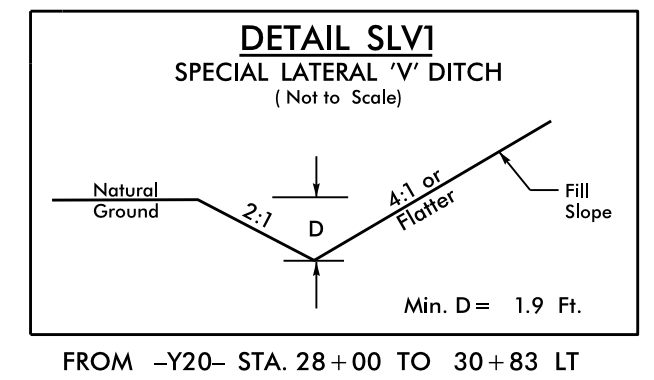
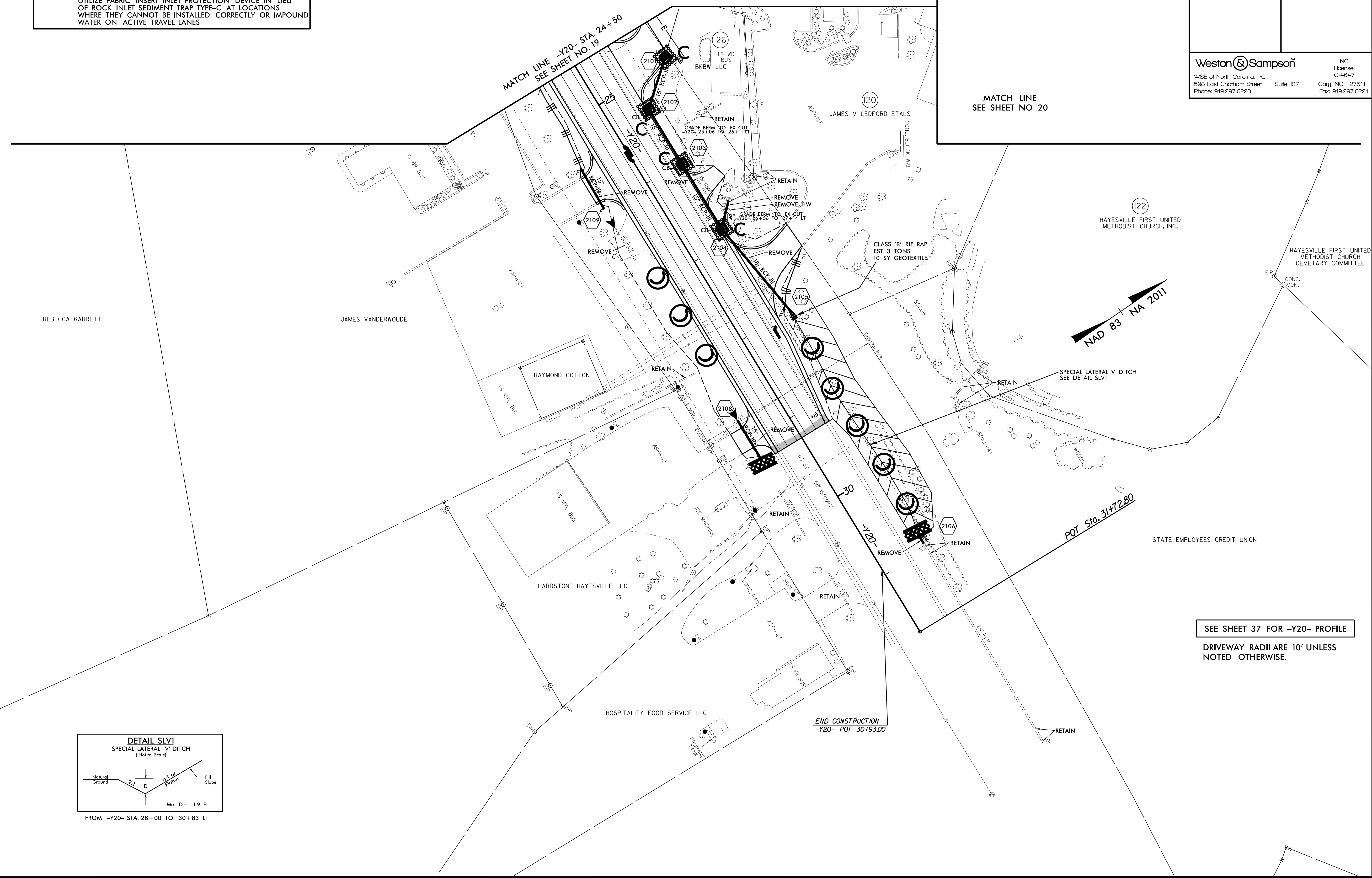

8/17/19

8/2/2019
S:\Projects\19\190011C-EC-EC46.FINAL.dgn
3:36:58 PM