

PHASING DIAGRAM

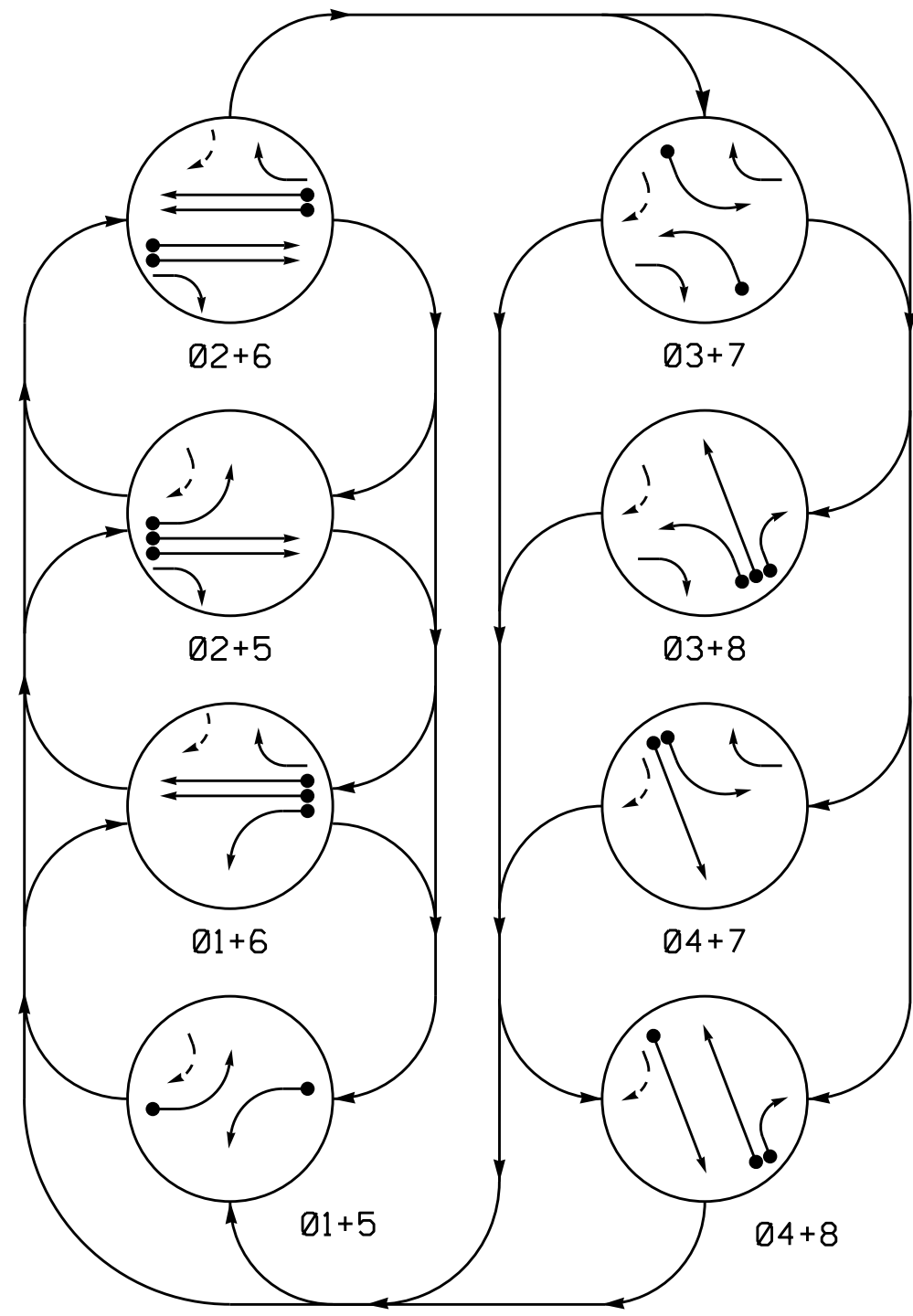

PHASING DIAGRAM DETECTION LEGEND

- DETECTED MOVEMENT
- UNDETECTED MOVEMENT (OVERLAP)
- UNSIGNALIZED MOVEMENT
- PEDESTRIAN MOVEMENT

SIGNAL FACE	PHASE							
	01+5	02+5	03+7	04+7	01+6	02+6	03+8	04+8
11	←	←	←	←	←	←	←	←
21	R	R	G	G	R	R	R	Y
22	R	R	G	G	R	R	R	Y
31	←	←	←	←	←	←	←	←
41, 42	R	R	R	R	R	R	G	G
51	←	←	←	←	←	←	←	←
61	R	G	R	G	R	R	R	Y
62	R	G	R	G	R	R	R	Y
71	←	←	←	←	←	←	←	←
81, 82	R	R	R	R	R	R	G	R

OASIS 2070 LOOP & DETECTOR INSTALLATION CHART													
LOOP	SIZE (FT)	DISTANCE FROM STOPBAR (FT)	TURNS	NEW LOOP	DETECTOR PROGRAMMING								
					PHASE	CALLING	EXTENSION	FULL TIME DELAY	STRETCH TIME	DELAY TIME	SYSTEM LOOP	NEW CARD	
1A	6X40	0	*	Y	1	Y	Y	-	-	-	-	-	*
2A	6X6	300	*	Y	2	Y	Y	-	-	-	-	-	*
2B	6X6	300	*	Y	2	Y	Y	-	-	-	-	-	*
2C	6X40	0	*	Y	2	-	Y	Y	2.0	5	-	-	*
2D	6X40	0	*	Y	2	-	Y	Y	2.0	5	-	-	*
3A	6X40	0	*	Y	3	Y	Y	-	-	-	3	-	*
4A	6X40	0	*	Y	4	Y	Y	-	-	-	-	-	*
5A	6X40	0	*	Y	5	Y	Y	-	-	-	-	-	*
6A	6X6	300	*	Y	6	Y	Y	-	-	-	-	-	*
6B	6X6	300	*	Y	6	Y	Y	-	-	-	-	-	*
6C	6X40	0	*	Y	6	-	Y	Y	2.0	5	-	-	*
6D	6X40	0	*	Y	6	-	Y	Y	2.0	5	-	-	*
7A	6X40	0	*	Y	7	Y	Y	-	-	-	3	-	*
8A	6X6	300	*	Y	8	-	Y	-	-	-	3.0	-	*
8B	6X40	0	*	Y	8	Y	Y	-	-	-	-	-	*
8C	6X40	0	*	Y	8	Y	Y	-	-	-	15	-	*

* Video Detection Zone

8 Phase Fully Actuated NC 24-27-73 (Bypass East) CLS

NOTES

- Refer to "Roadway Standard Drawings NCDOT" dated January 2018 and "Standard Specifications for Roads and Structures" dated January 2018.
- Do not program signal for late night flashing operation unless otherwise directed by the Engineer.
- Phase 1 and/or phase 5 may be lagged.
- Phase 3 and/or phase 7 may be lagged.
- Reposition existing signal heads 21 and 61.
- Set all detector units to presence mode.
- See Pavement Marking Plans for proposed stop bar locations.
- Maximum times shown in timing chart are for free-run operation only. Coordinated signal system timing values supersede these values.
- Closed loop system data: Controller Asset #: 0591.

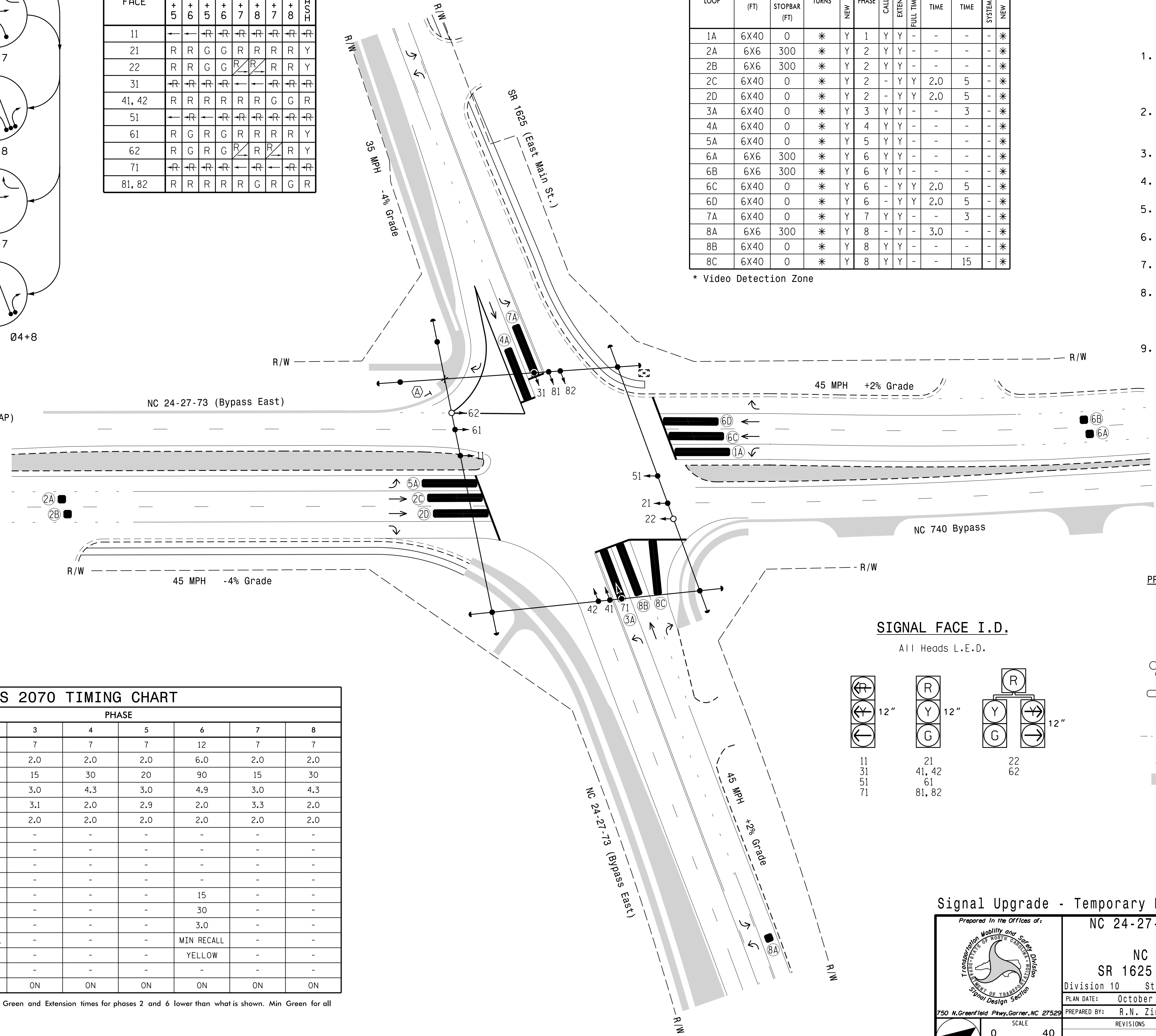

SIGNAL FACE I.D.

All Heads L.E.D.

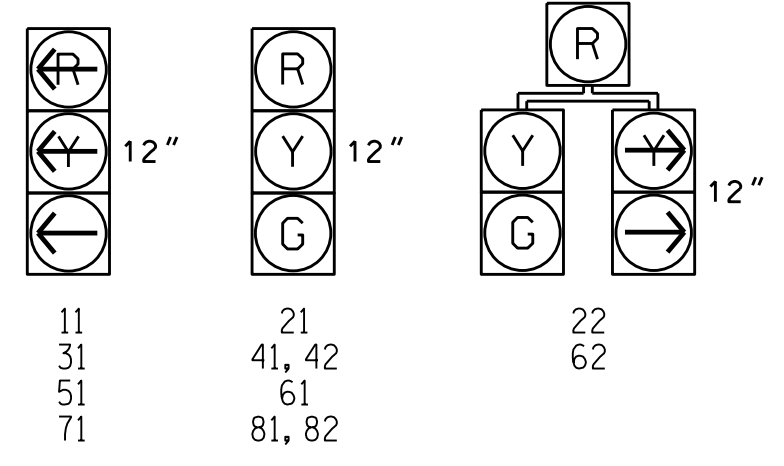

LEGEND

- | PROPOSED | EXISTING |
|----------|--|
| | Traffic Signal Head |
| | Modified Signal Head |
| | Sign |
| | Pedestrian Signal Head With Push Button & Sign |
| | Signal Pole with Guy |
| | Signal Pole with Sidewalk Guy |
| | Inductive Loop Detector |
| | Controller & Cabinet |
| | Junction Box |
| | 2-in Underground Conduit |
| | Right of Way |
| | Directional Arrow |
| | Construction Zone |
| | Video Detection Zone |
| | "YIELD" Sign (R1-2) |

OASIS 2070 TIMING CHART								
FEATURE	PHASE							
	1	2	3	4	5	6	7	8
Min Green 1 *	7	12	7	7	7	12	7	7
Extension 1 *	2.0	6.0	2.0	2.0	2.0	6.0	2.0	2.0
Max Green 1 *	20	90	15	30	20	90	15	30
Yellow Clearance	3.0	4.9	3.0	4.3	3.0	4.9	3.0	4.3
Red Clearance	3.1	2.0	3.1	2.0	2.9	2.0	3.3	2.0
Red Revert	2.0	2.0	2.0	2.0	2.0	2.0	2.0	2.0
Walk 1 *	-	-	-	-	-	-	-	-
Don't Walk 1	-	-	-	-	-	-	-	-
Seconds Per Actuation *	-	-	-	-	-	-	-	-
Max Variable Initial *	-	-	-	-	-	-	-	-
Time Before Reduction *	-	15	-	-	-	15	-	-
Time To Reduce *	-	30	-	-	-	30	-	-
Minimum Gap	-	3.0	-	-	-	3.0	-	-
Recall Mode	-	MIN RECALL	-	-	-	MIN RECALL	-	-
Vehicle Call Memory	-	YELLOW	-	-	-	YELLOW	-	-
Dual Entry	-	-	-	-	-	-	-	-
Simultaneous Gap	ON	ON	ON	ON	ON	ON	ON	ON

* These values may be field adjusted. Do not adjust Min Green and Extension times for phases 2 and 6 lower than what is shown. Min Green for all other phases should not be lower than 4 seconds.

Signal Upgrade - Temporary Design 2 - Phase 2

<p>750 N. Greenfield Pkwy, Garner, NC 27529</p>	NC 24-27-73 (Bypass East) at NC 740 Bypass/ SR 1625 (East Main St.)		
	Division 10 Stanly County Albemarle		
	PLAN DATE: October 2018	REVIEWED BY: T.J. Williams	
	PREPARED BY: R.N. Zinser	REVIEWED BY:	
REVISIONS			DATE
SCALE 0 40 1"=40'			DATE 11/2/2018

DOCUMENT NOT CONSIDERED FINAL UNLESS ALL SIGNATURES COMPLETED

SEAL
NORTH CAROLINA PROFESSIONAL ENGINEER
RICHARD N. ZINSER
SEAL 043914
DATE 11/2/2018
SIG. INVENTORY NO. 10-0591 T2