

8/17/99

WALL ENVELOPE DETAIL

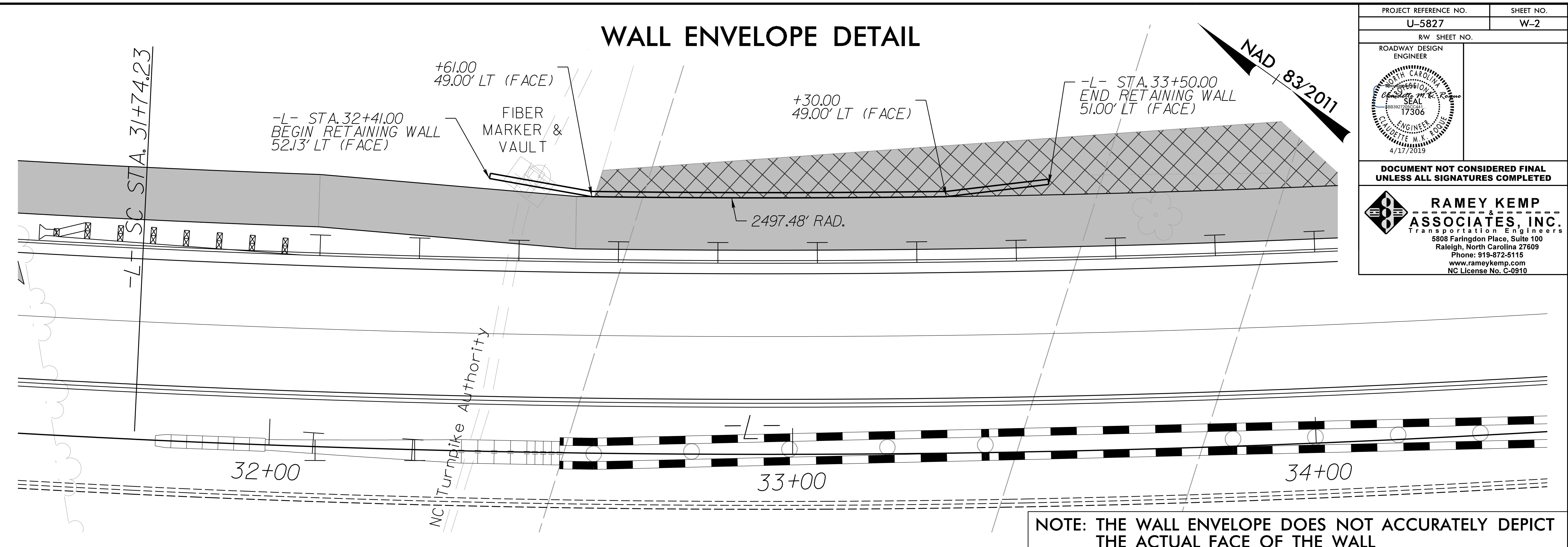

PROJECT REFERENCE NO. U-5827	SHEET NO. W-2
RW SHEET NO.	
ROADWAY DESIGN ENGINEER	
DOCUMENT NOT CONSIDERED FINAL UNLESS ALL SIGNATURES COMPLETED	
RAMEY KEMP & ASSOCIATES, INC. Transportation Engineers 5808 Faringdon Place, Suite 100 Raleigh, North Carolina 27609 Phone: 919-872-5115 www.rameykemp.com NC License No. C-0910	

NOTE: THE WALL ENVELOPE DOES NOT ACCURATELY DEPICT THE ACTUAL FACE OF THE WALL

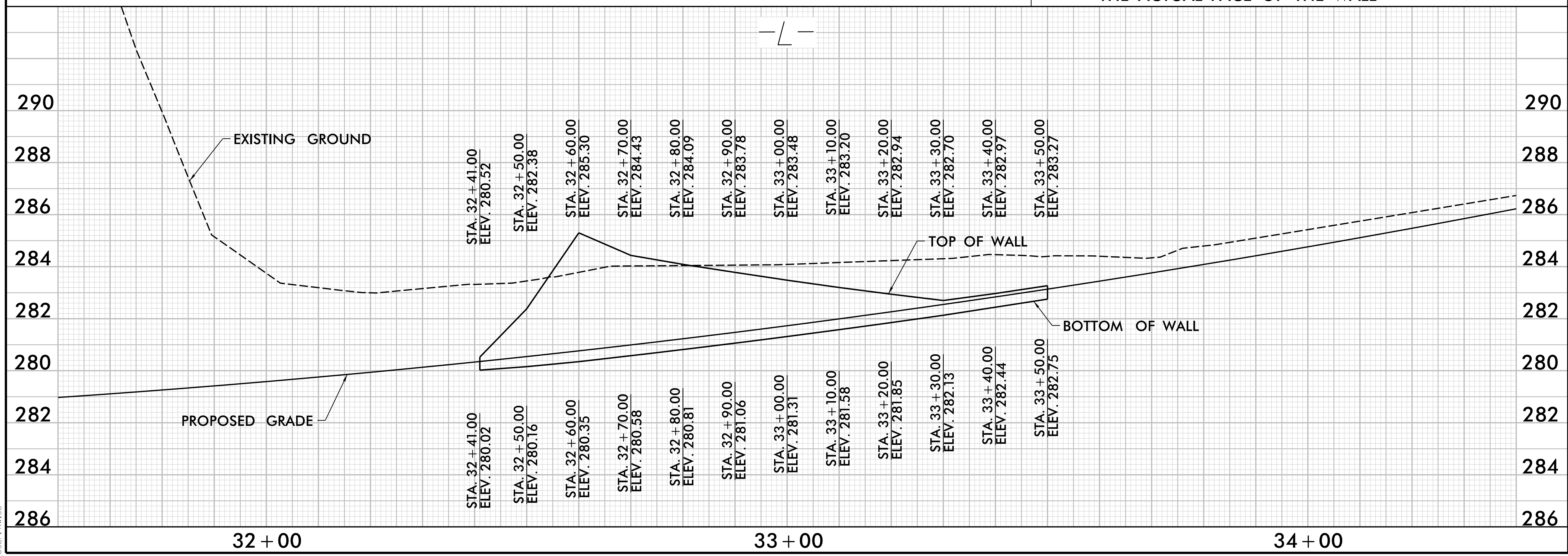

3/22/2019
 I:\Roadway\Proj\U5827_Rdy-W-2.dgn
 User: kwise