

PROJECT REFERENCE NO. <b>U-5827</b>	SHEET NO. <b>7</b>
RW SHEET NO.	
ROADWAY DESIGN ENGINEER	HYDRAULICS ENGINEER

DOCUMENT NOT CONSIDERED FINAL UNLESS ALL SIGNATURES COMPLETED

**RAMEY KEMP ASSOCIATES, INC.**  
 Transportation Engineers  
 5808 Farington Place, Suite 100  
 Raleigh, North Carolina 27609  
 Phone: 919-872-5115  
 www.rameykemp.com  
 NC License No. C-0910

REVISIONS

7/16/2019  
I:\Projects\U5827\_Rdy\_psh07.dgn  
Insert.craque

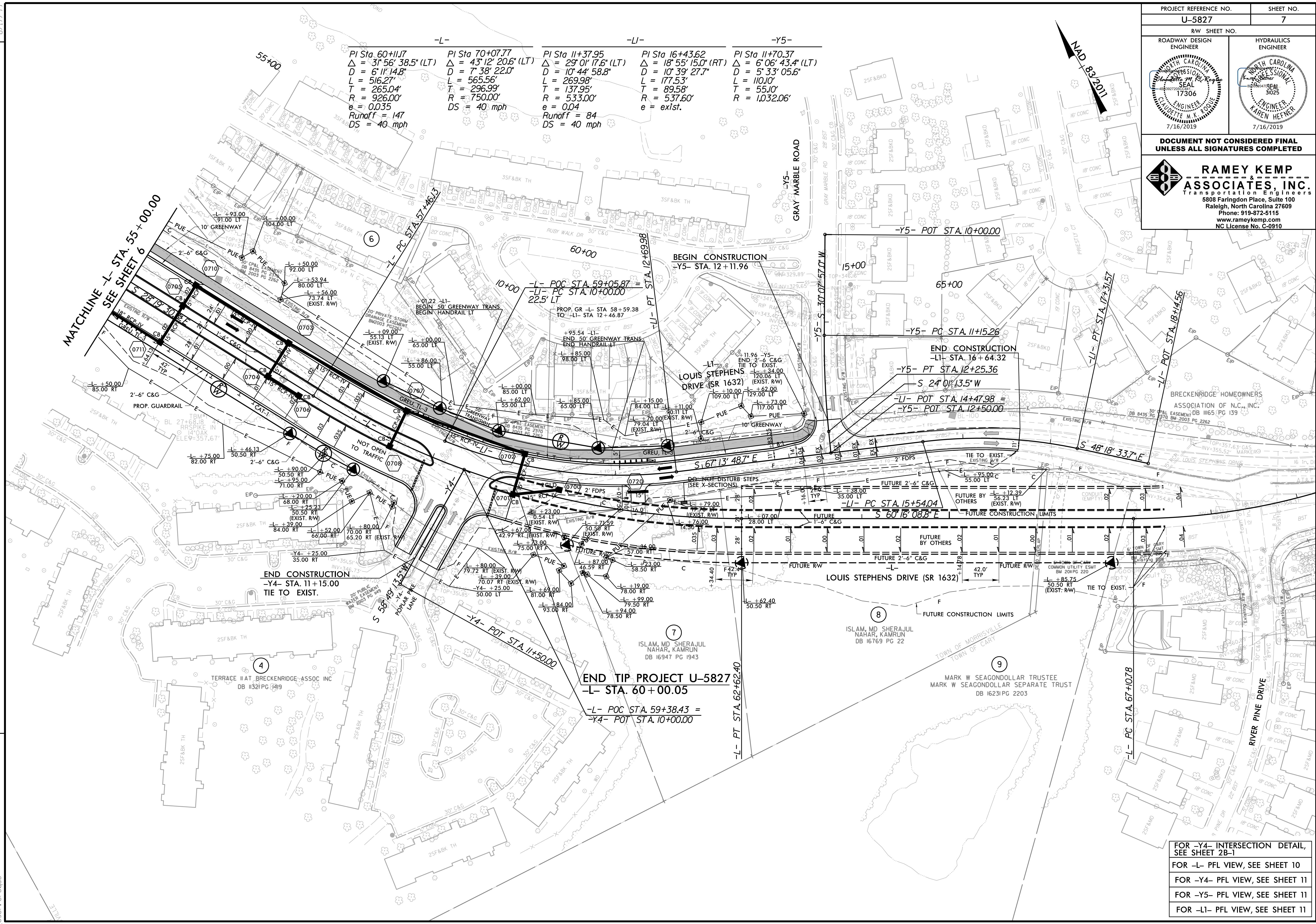

-L-	-LI-	-Y5-
PI Sta 60+11.7 Δ = 31° 56' 38.5" (LT) D = 6' 11" 14.8" L = 516.27' T = 265.04' R = 926.00' e = 0.035 Runoff = 147 DS = 40 mph	PI Sta 70+07.77 Δ = 43° 12' 20.6" (LT) D = 7' 38" 22.0" L = 565.56' T = 296.99' R = 750.00' DS = 40 mph	PI Sta 11+37.95 Δ = 29° 01' 17.6" (LT) D = 10' 44" 58.8" L = 269.98' T = 137.95' R = 533.00' e = 0.04 Runoff = 84 DS = 40 mph
PI Sta 16+43.62 Δ = 18° 55' 15.0" (RT) D = 10' 39" 27.7" L = 177.53' T = 89.58' R = 537.60' e = exist.	PI Sta 11+70.37 Δ = 6° 06' 43.4" (LT) D = 5' 33" 05.6" L = 110.10' T = 55.10' R = 1,032.06'	

- FOR -Y4- INTERSECTION DETAIL, SEE SHEET 2B-1
- FOR -L- PFL VIEW, SEE SHEET 10
- FOR -Y4- PFL VIEW, SEE SHEET 11
- FOR -Y5- PFL VIEW, SEE SHEET 11
- FOR -L1- PFL VIEW, SEE SHEET 11