

PROJECT REFERENCE NO. <b>U-5827</b>		SHEET NO. <b>6</b>	
RW SHEET NO.		HYDRAULICS ENGINEER	
ROADWAY DESIGN ENGINEER		SEAL	

**DOCUMENT NOT CONSIDERED FINAL UNLESS ALL SIGNATURES COMPLETED**

**RAMEY KEMP ASSOCIATES, INC.**  
 Transportation Engineers  
 5808 Faringdon Place, Suite 100  
 Raleigh, North Carolina 27609  
 Phone: 919-872-5115  
 www.rameykemp.com  
 NC License No. C-0910

-L-	-Y3B-
PI Sta 42+83.71 Δ = 4' 49' 32.6" (LT) D = 0' 47' 36.9" L = 608.10' T = 304.23' R = 7,220.00' e = NC DS = 50 mph	PI Sta 52+69.58 Δ = 16' 25' 54.7" (RT) D = 6' 11' 14.8" L = 265.57' T = 133.70' R = 926.00' e = 0.035 Runoff = 147 DS = 40 mph
PI Sta 11+27.98 Δ = 25' 40' 52.4" (LT) D = 35' 48' 35.5" L = 71.72' T = 36.47' R = 160.00'	

MATCHLINE -L- STA. 43+00.00  
SEE SHEET 5

MATCHLINE -L- STA. 55+00.00  
SEE SHEET 7

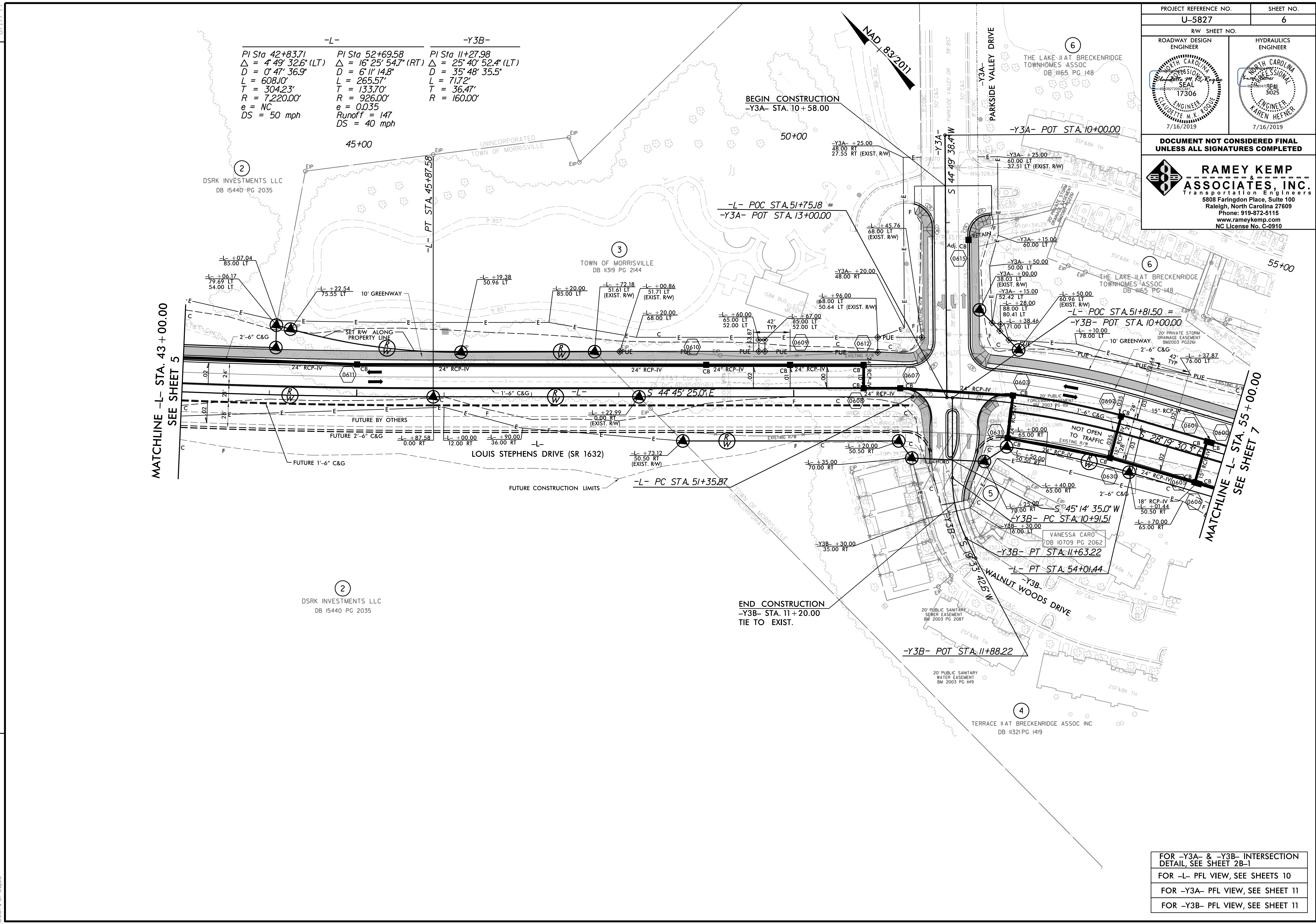

REVISIONS

7/16/2019  
I:\Projs\U5827\_Rdy\_psh06.dgn  
User: craque

FOR -Y3A- & -Y3B- INTERSECTION DETAIL, SEE SHEET 2B-1
FOR -L- PFL VIEW, SEE SHEETS 10
FOR -Y3A- PFL VIEW, SEE SHEET 11
FOR -Y3B- PFL VIEW, SEE SHEET 11