

UTILITIES BY OTHERS

ALL PROPOSED UTILITY WORK SHOWN ON THIS SHEET WILL BE DONE BY OTHERS. NO PAYMENT WILL BE MADE TO THE CONTRACTOR FOR PROPOSED UTILITY WORK SHOWN ON THIS SHEET.

8/6/18
 ADDED SEPTC INFORMATION FOR P-22 8/6/18
 V:\Asheville\transportation\3173301_I-4400C_HNTB_I-26_MM40-44\Utilities\I4400C_UT_PSH08_U08.DGN

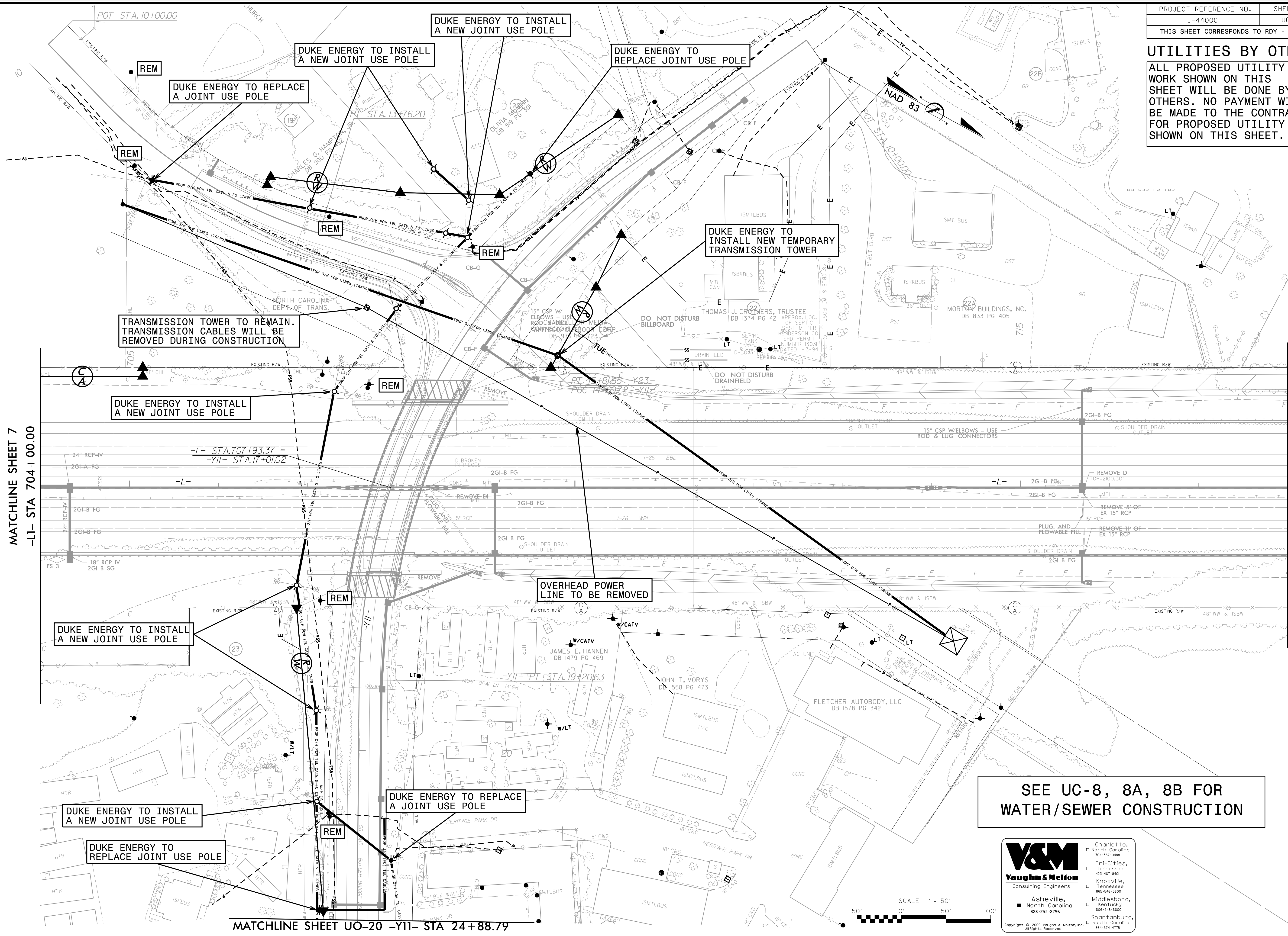

MATCHLINE SHEET 7
-L1- STA 704 + 00.00

MATCHLINE SHEET 9
-L1- STA 718 + 00.00

DUKE ENERGY TO INSTALL A NEW JOINT USE POLE

DUKE ENERGY TO INSTALL A NEW JOINT USE POLE

DUKE ENERGY TO REPLACE JOINT USE POLE

DUKE ENERGY TO REPLACE A JOINT USE POLE

DUKE ENERGY TO INSTALL A NEW JOINT USE POLE

DUKE ENERGY TO REPLACE A JOINT USE POLE

DUKE ENERGY TO INSTALL A NEW JOINT USE POLE

DUKE ENERGY TO REPLACE JOINT USE POLE

DUKE ENERGY TO INSTALL NEW TEMPORARY TRANSMISSION TOWER

OVERHEAD POWER LINE TO BE REMOVED

TRANSMISSION TOWER TO REMAIN. TRANSMISSION CABLES WILL BE REMOVED DURING CONSTRUCTION

DUKE ENERGY TO INSTALL A NEW JOINT USE POLE

SEE UC-8, 8A, 8B FOR WATER/SEWER CONSTRUCTION

Vaughn & Melton
Consulting Engineers

- Charlotte, North Carolina 704-337-0488
- Tri-Cities, Tennessee 423-467-8400
- Knoxville, Tennessee 865-546-5800
- Middlesboro, Kentucky 606-248-6600
- Spartanburg, South Carolina 864-574-4475
- Asheville, North Carolina 828-253-2796

Copyright © 2006 Vaughn & Melton, Inc. All Rights Reserved

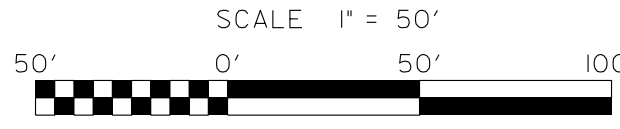

MATCHLINE SHEET UO-20 -Y11- STA 24+88.79