

**This electronic collection of documents is provided
for the convenience of the user
and is Not a Certified Document –**

**The documents contained herein were originally issued
and sealed by the individuals whose names and license
numbers appear on each page, on the dates appearing
with their signature on that page.**

**This file or an individual page
shall not be considered a certified document.**

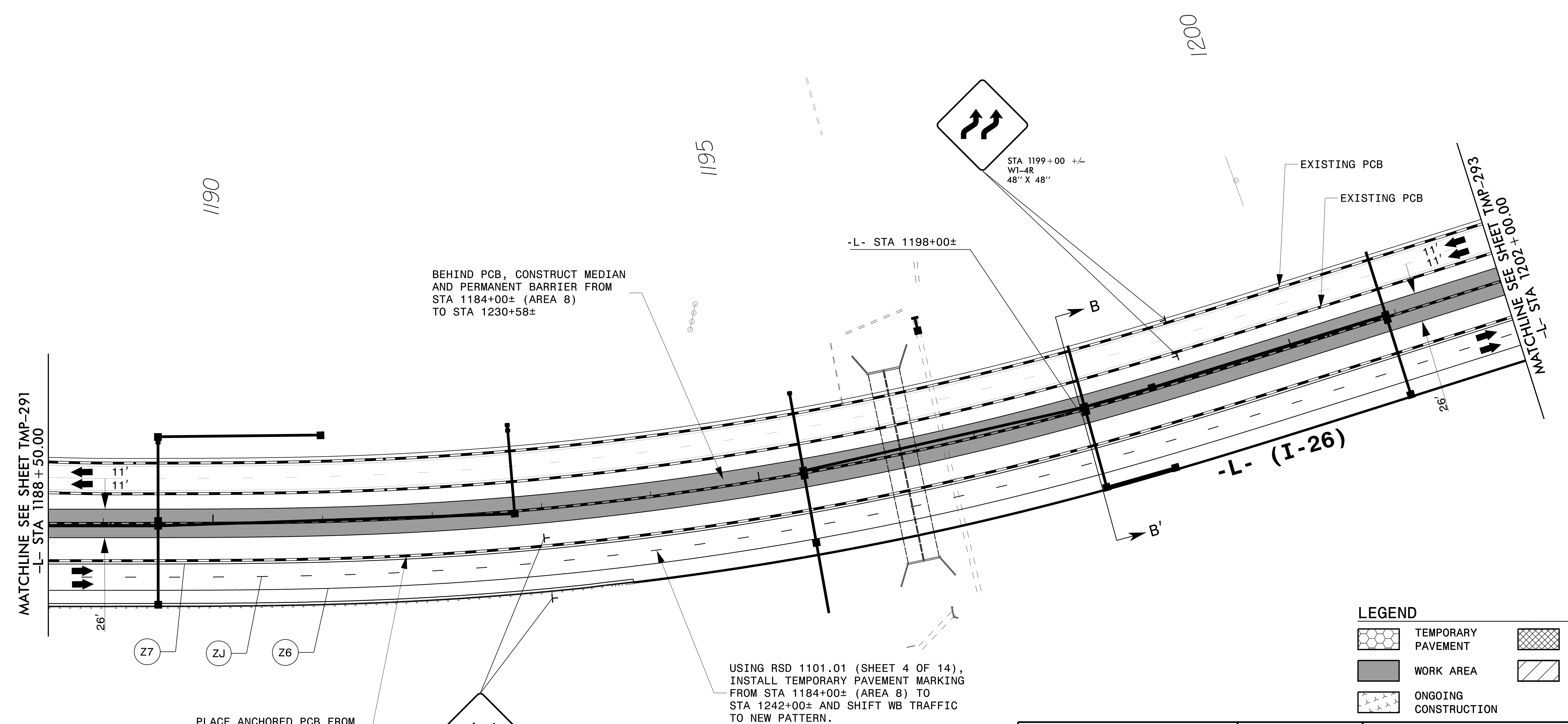
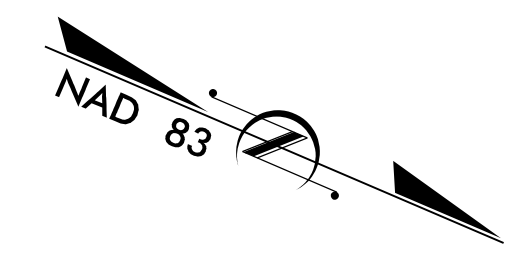

MATCHLINE SEE SHEET TMP-291
-L- STA 1188 + 50.00

BEHIND PCB, CONSTRUCT MEDIAN
AND PERMANENT BARRIER FROM
STA 1184+00± (AREA 8)
TO STA 1230+58±

STA 1199+00 +/-
W1-4R
48" X 48"

EXISTING PCB

EXISTING PCB

-L- STA 1198+00±

MATCHLINE SEE SHEET TMP-293
-L- STA 1202 + 00.00

-L- (I-26)

Z7 ZJ Z6

PLACE ANCHORED PCB FROM
STA 1184+00± (AREA 8)
TO STA 1233+66 +/-

STA 1193+00 +/-
W1-4R
48" X 48"

USING RSD 1101.01 (SHEET 4 OF 14),
INSTALL TEMPORARY PAVEMENT MARKING
FROM STA 1184+00± (AREA 8) TO
STA 1242+00± AND SHIFT WB TRAFFIC
TO NEW PATTERN.

LEGEND

	TEMPORARY PAVEMENT		REMOVAL
	WORK AREA		WEDGE / WIDEN
	ONGOING CONSTRUCTION		

REFER TO SHEETS TMP-304 - TMP-306 FOR CUT SECTION(S).
REMOVE CONFLICTING PAVEMENT MARKING.

HNTB HNTB NORTH CAROLINA, P.C.
343 E. SIX FORKS ROAD, SUITE 200
RALEIGH, NORTH CAROLINA 27609
NC LICENSE NO: C-1554

APPROVED: *Devek Eugene Vap*
DATE: 4/25/2019
SEAL
NORTH CAROLINA PROFESSIONAL ENGINEER
DEWEK EUGENE VAP
047639

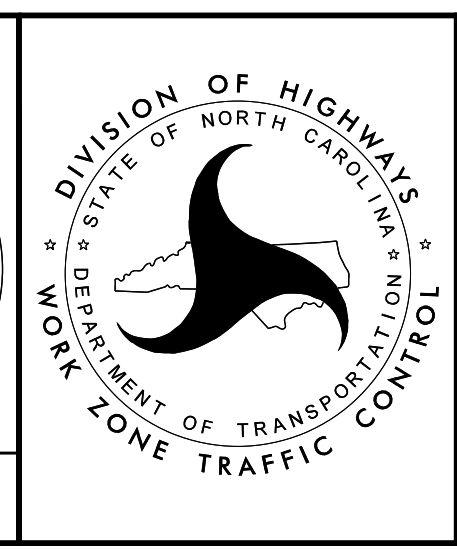

TRANSPORTATION
MANAGEMENT PLAN

AREA 9
PHASE IIIB
DETAIL 2

25-APR-2019 20:57
I:\700_TG_A\9P3\bd2.dgn
HNTB

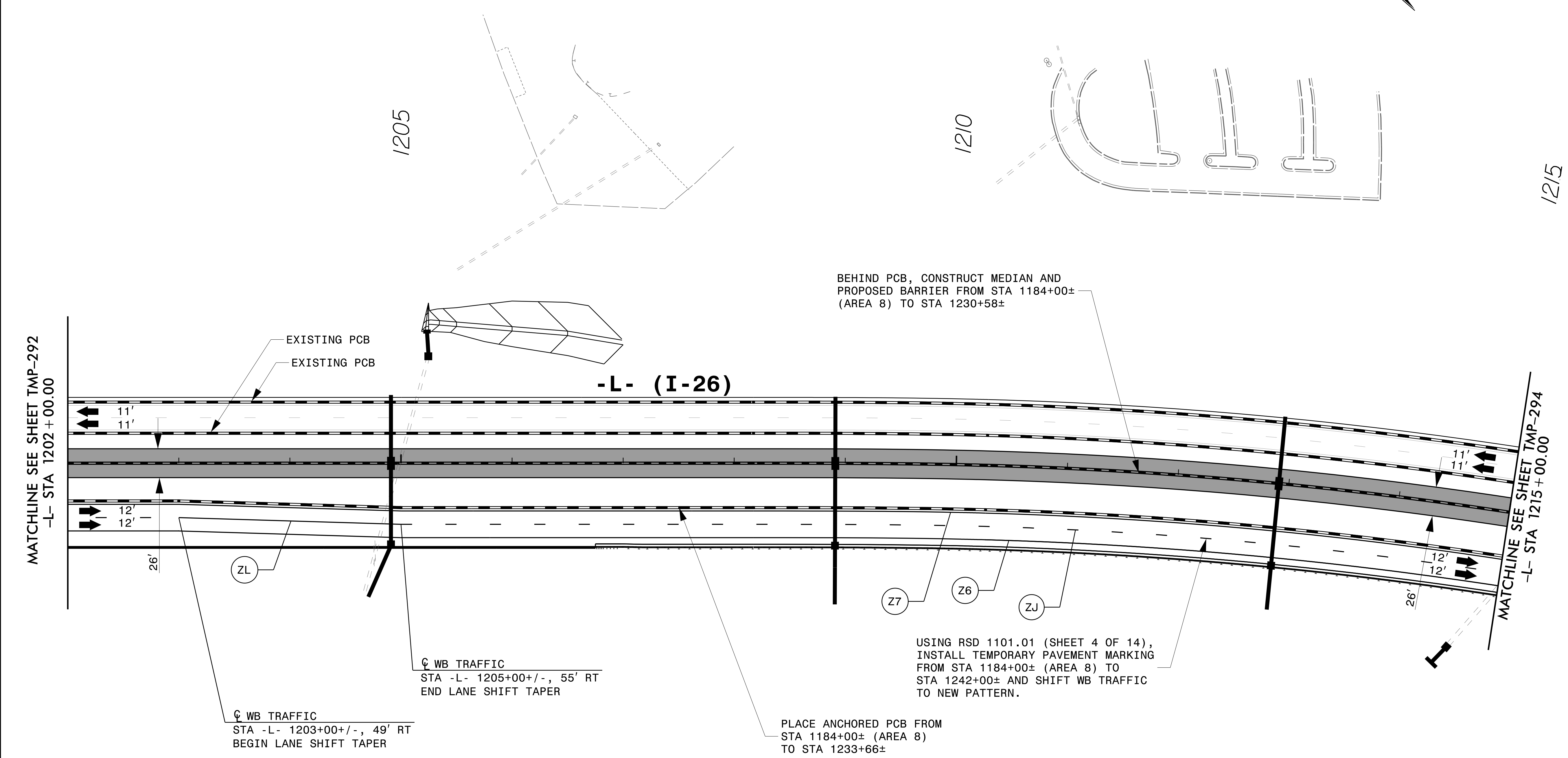
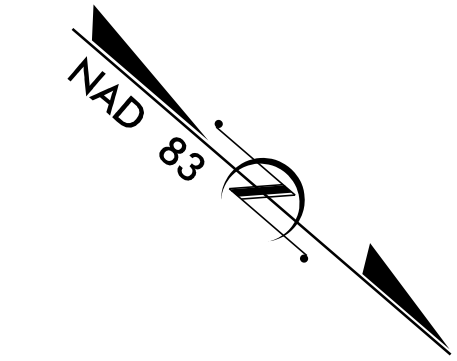

BEHIND PCB, CONSTRUCT MEDIAN AND PROPOSED BARRIER FROM STA 1184+00± (AREA 8) TO STA 1230+58±

USING RSD 1101.01 (SHEET 4 OF 14), INSTALL TEMPORARY PAVEMENT MARKING FROM STA 1184+00± (AREA 8) TO STA 1242+00± AND SHIFT WB TRAFFIC TO NEW PATTERN.

PLACE ANCHORED PCB FROM STA 1184+00± (AREA 8) TO STA 1233+66±

☉ WB TRAFFIC
STA -L- 1203+00+/-, 49' RT
BEGIN LANE SHIFT TAPER

☉ WB TRAFFIC
STA -L- 1205+00+/-, 55' RT
END LANE SHIFT TAPER

LEGEND

	TEMPORARY PAVEMENT		REMOVAL
	WORK AREA		WEDGE / WIDEN
	ONGOING CONSTRUCTION		

REFER TO SHEETS TMP-304 - TMP-306 FOR CUT SECTION(S).
REMOVE CONFLICTING PAVEMENT MARKING.



APPROVED: *Derek Eugene Vap*
DATE: 4/25/2019

SEAL

DOCUMENT NOT CONSIDERED FINAL UNLESS ALL SIGNATURES COMPLETED

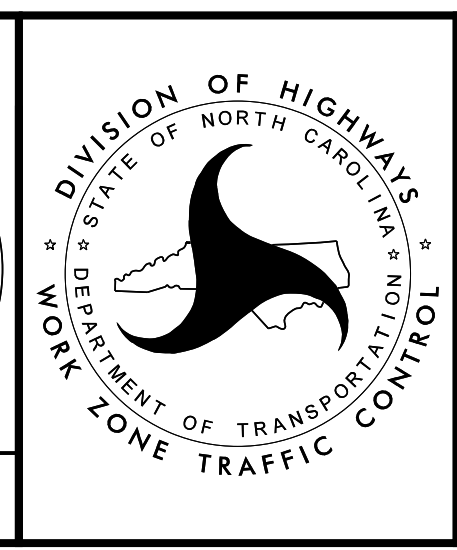

TRANSPORTATION MANAGEMENT PLAN

**AREA 9
PHASE IIIB
DETAIL 3**

25-APR-2019 2:400
I4700.TC.A9P3D03.dgn
HNTB

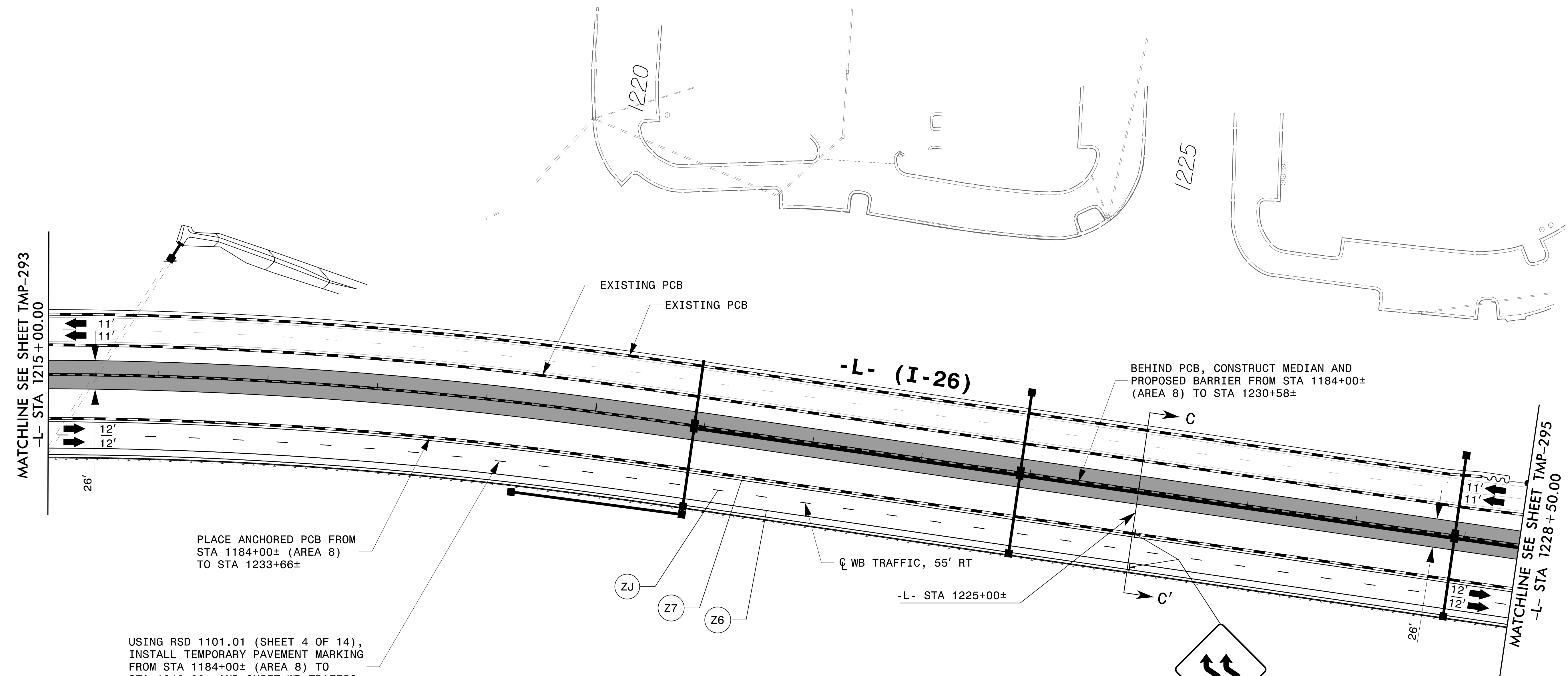
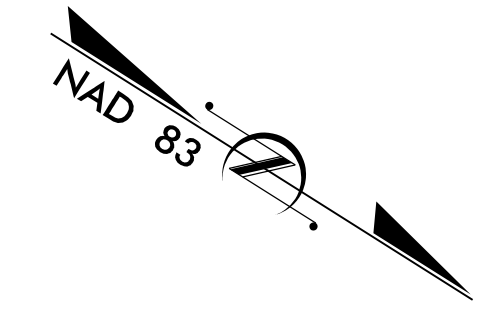

LEGEND

	TEMPORARY PAVEMENT		REMOVAL
	WORK AREA		WEDGE / WIDEN
	ONGOING CONSTRUCTION		

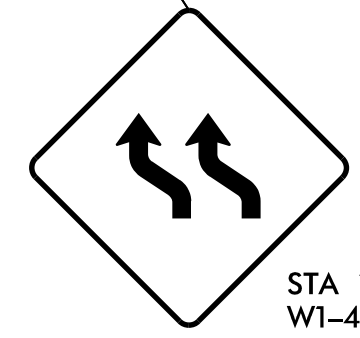

STA 1225+00 +/-
W1-4L
48" X 48"

01-MAR-2019 15:05
I4700B-TC-A923b04.dgn
HNTB

REFER TO SHEETS TMP-304 - TMP-306 FOR CUT SECTION(S).

REMOVE CONFLICTING PAVEMENT MARKING.

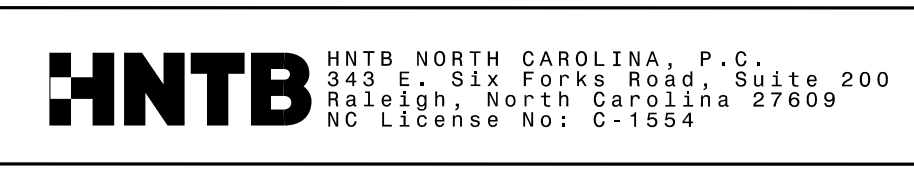

APPROVED: *Dezek Eugene Yip*
DATE: 3/1/2019

SEAL

NORTH CAROLINA PROFESSIONAL ENGINEER
SEAL 047639
DEZEK EUGENE YIP

DOCUMENT NOT CONSIDERED FINAL UNLESS ALL SIGNATURES COMPLETED

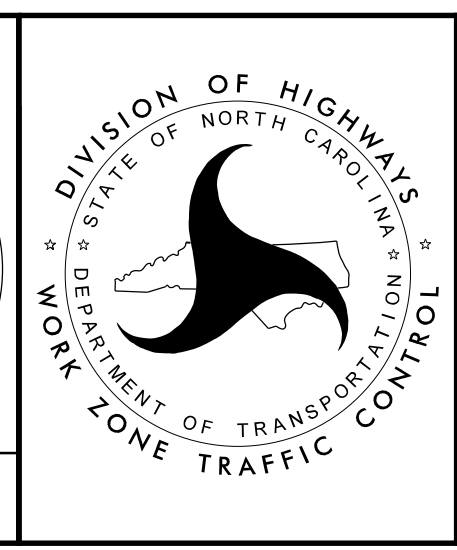

TRANSPORTATION MANAGEMENT PLAN

**AREA 9
PHASE IIIB
DETAIL 4**

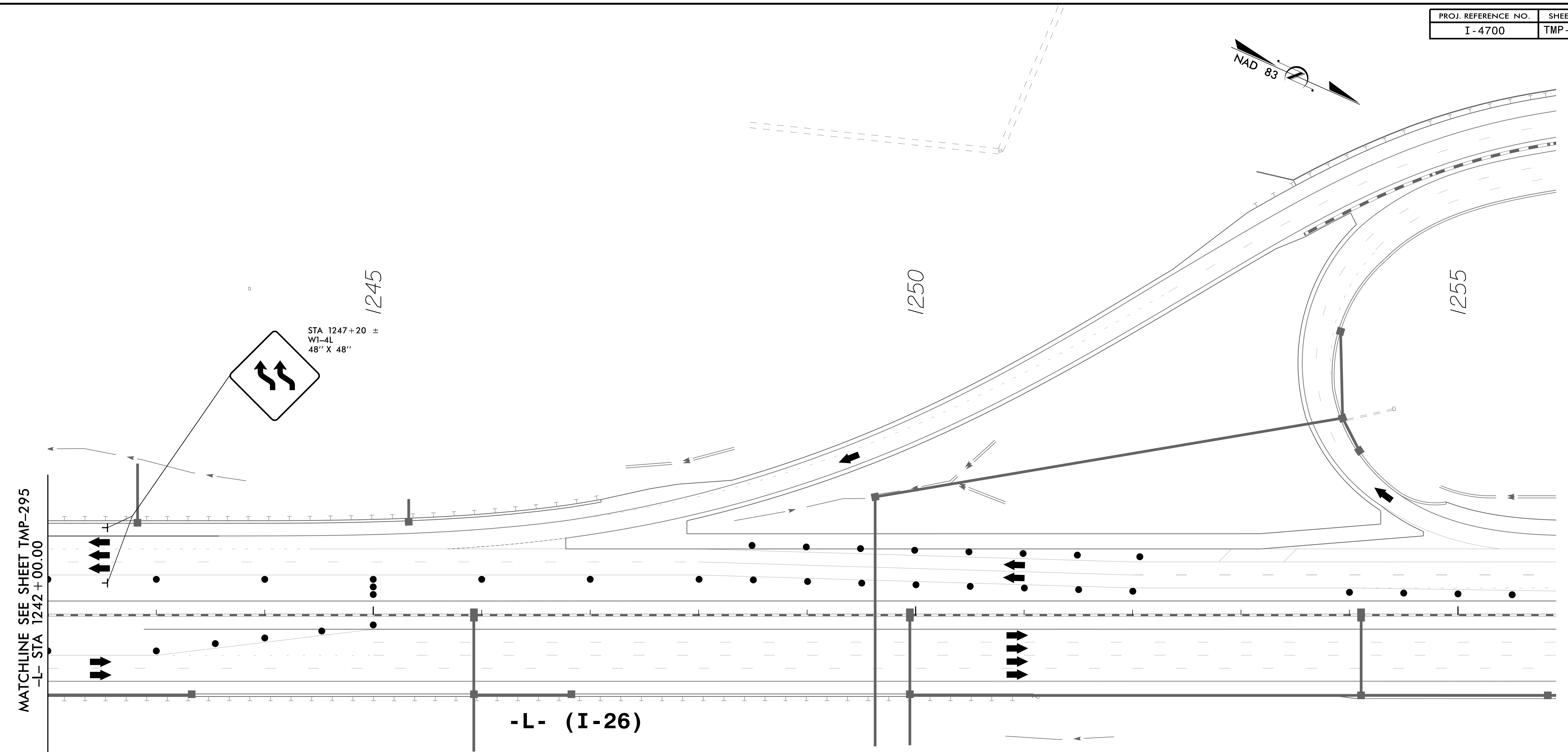
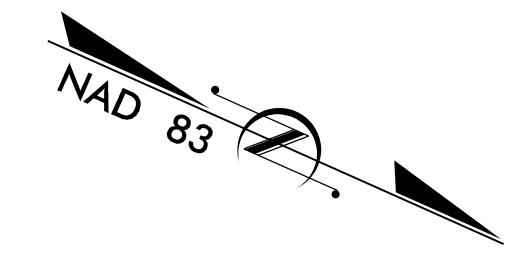

MATCHLINE SEE SHEET TMP-295
-L- STA 1242+00.00

STA 1247+20 ±
W1-4L
48" X 48"

-L- (I-26)

LEGEND

- | | | | |
|--|----------------------|--|---------------|
| | TEMPORARY PAVEMENT | | REMOVAL |
| | WORK AREA | | WEDGE / WIDEN |
| | ONGOING CONSTRUCTION | | |

01-MAR-2019 15:05
 I4700B-TC-A923b06.dgn
 HNTB

REMOVE CONFLICTING PAVEMENT MARKING.



APPROVED:
DocuSigned by: Derek Eugene Yip
CB273C85AE544C9

DATE: 3/1/2019

SEAL

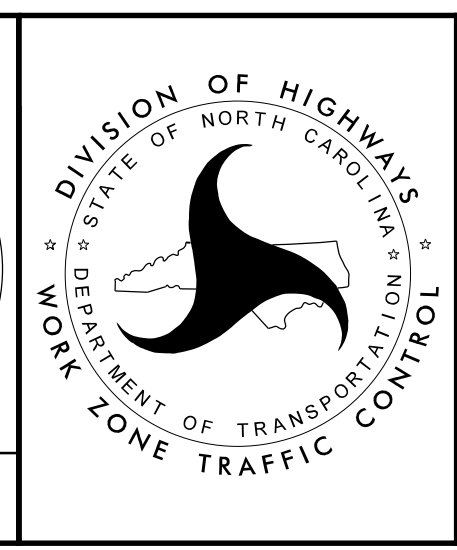

**TRANSPORTATION
MANAGEMENT PLAN**

**AREA 9
PHASE IIIB
DETAIL 6**

**DOCUMENT NOT CONSIDERED FINAL
UNLESS ALL SIGNATURES COMPLETED**

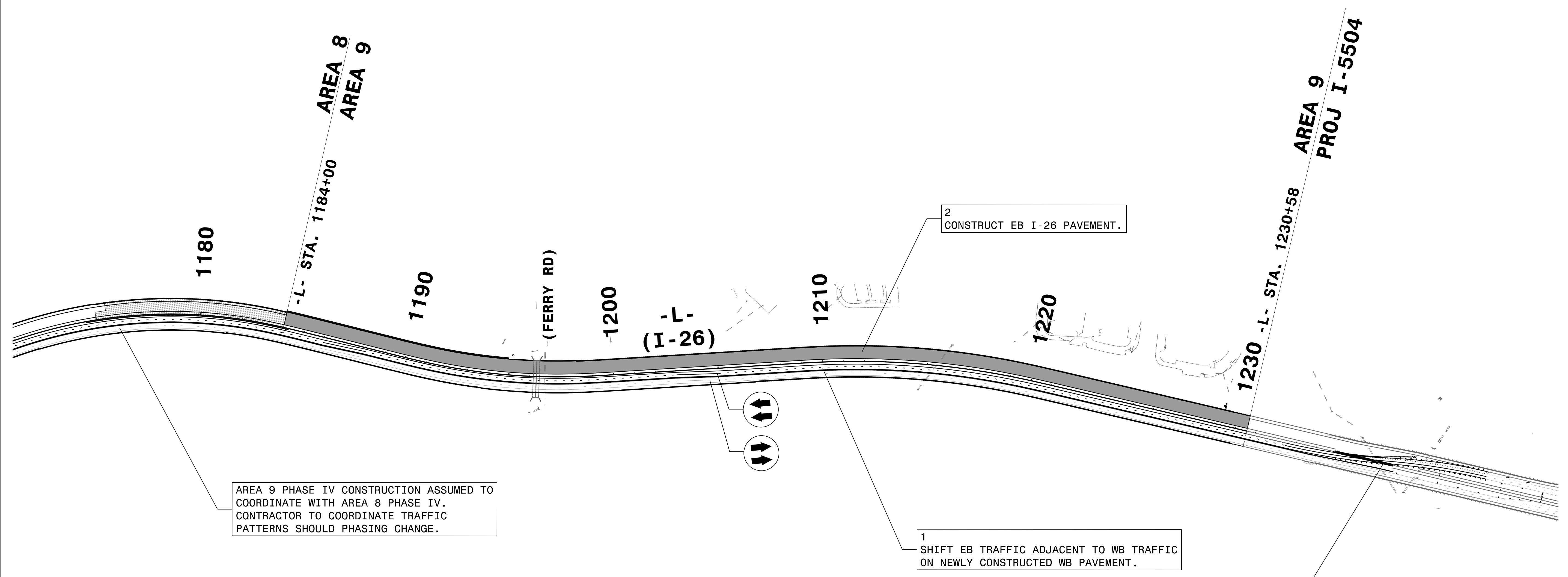
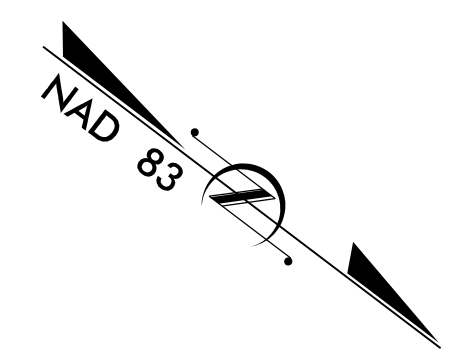

AREA 9 PHASE IV CONSTRUCTION ASSUMED TO COORDINATE WITH AREA 8 PHASE IV. CONTRACTOR TO COORDINATE TRAFFIC PATTERNS SHOULD PHASING CHANGE.

2
CONSTRUCT EB I-26 PAVEMENT.

1
SHIFT EB TRAFFIC ADJACENT TO WB TRAFFIC ON NEWLY CONSTRUCTED WB PAVEMENT.

1
USING DETOUR 9-2, CROSSOVER EB TRAFFIC

01-MAR-2019 15:05
I4700B-TC-A924_OV.dgn
HNTB

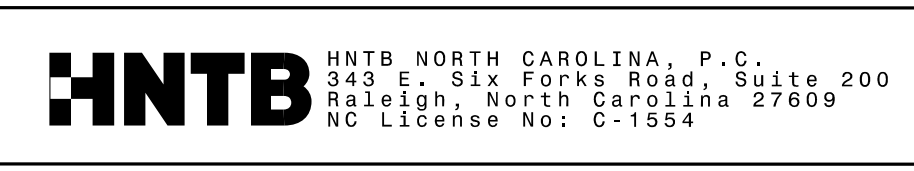

APPROVED: *Derek Eugene Vap*
DocuSigned by: Derek Eugene Vap
 CR273C85AE544C9

DATE: 3/1/2019

SEAL

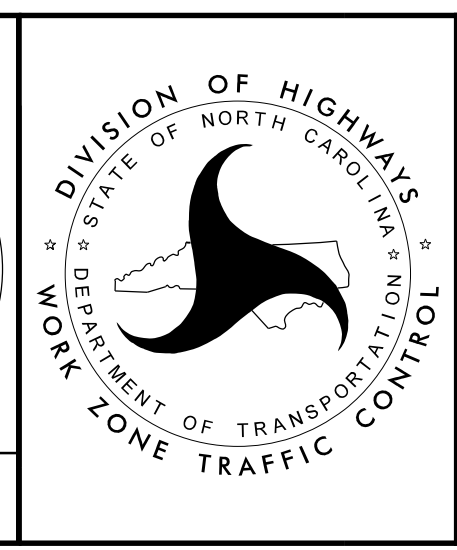

TRANSPORTATION
MANAGEMENT PLAN

AREA 9
PHASE IV
OVERVIEW

**DOCUMENT NOT CONSIDERED FINAL
UNLESS ALL SIGNATURES COMPLETED**

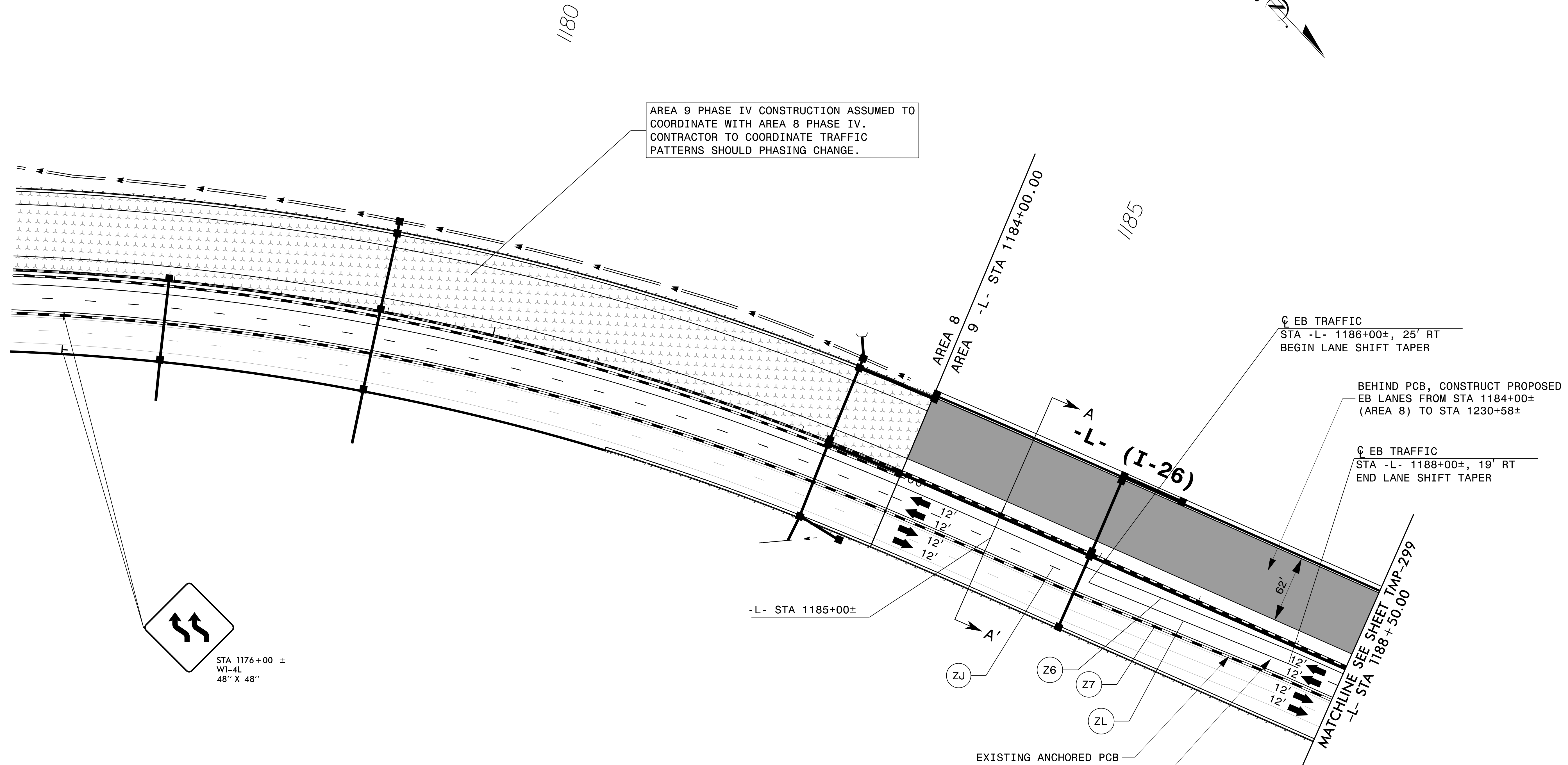
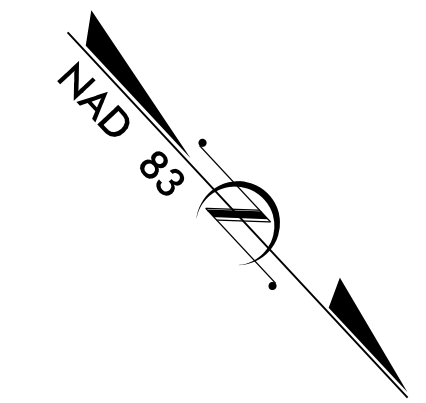

AREA 9 PHASE IV CONSTRUCTION ASSUMED TO
COORDINATE WITH AREA 8 PHASE IV.
CONTRACTOR TO COORDINATE TRAFFIC
PATTERNS SHOULD PHASING CHANGE.

USING RSD 1101.01 (SHEET 4 OF 14),
INSTALL TEMPORARY PAVEMENT MARKING
FROM STA 1184+00± (AREA 8) TO
STA 1242+00± AND SHIFT EB TRAFFIC
TO NEW PATTERN.

LEGEND

	TEMPORARY PAVEMENT		REMOVAL
	WORK AREA		WEDGE / WIDEN
	ONGOING CONSTRUCTION		

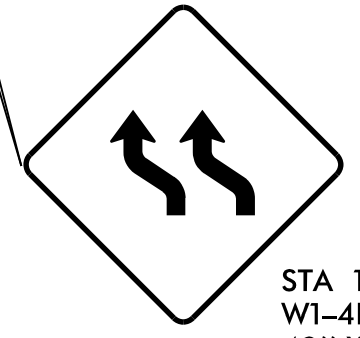

STA 1176+00 ±
WI-4L
48" X 48"

REFER TO SHEETS TMP-304 - TMP-306 FOR CUT SECTION(S).
REMOVE CONFLICTING PAVEMENT MARKING.

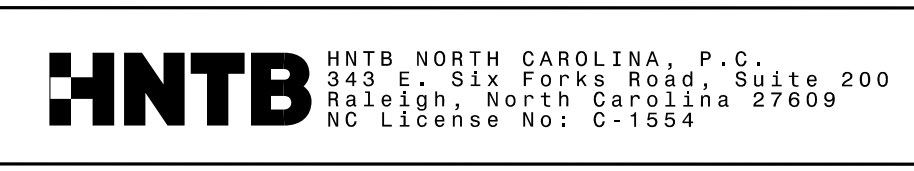

APPROVED: *Devek Eugene Vep*
DATE: 3/1/2019

SEAL

SEAL 047639
ENGINEER
DEVEK EUGENE VEP

**DOCUMENT NOT CONSIDERED FINAL
UNLESS ALL SIGNATURES COMPLETED**



**TRANSPORTATION
MANAGEMENT PLAN**

**AREA 9
PHASE IV
DETAIL 1**

01-MAR-2019 15:05
I4700B-TC-A9P4D1.dgn
HNTB

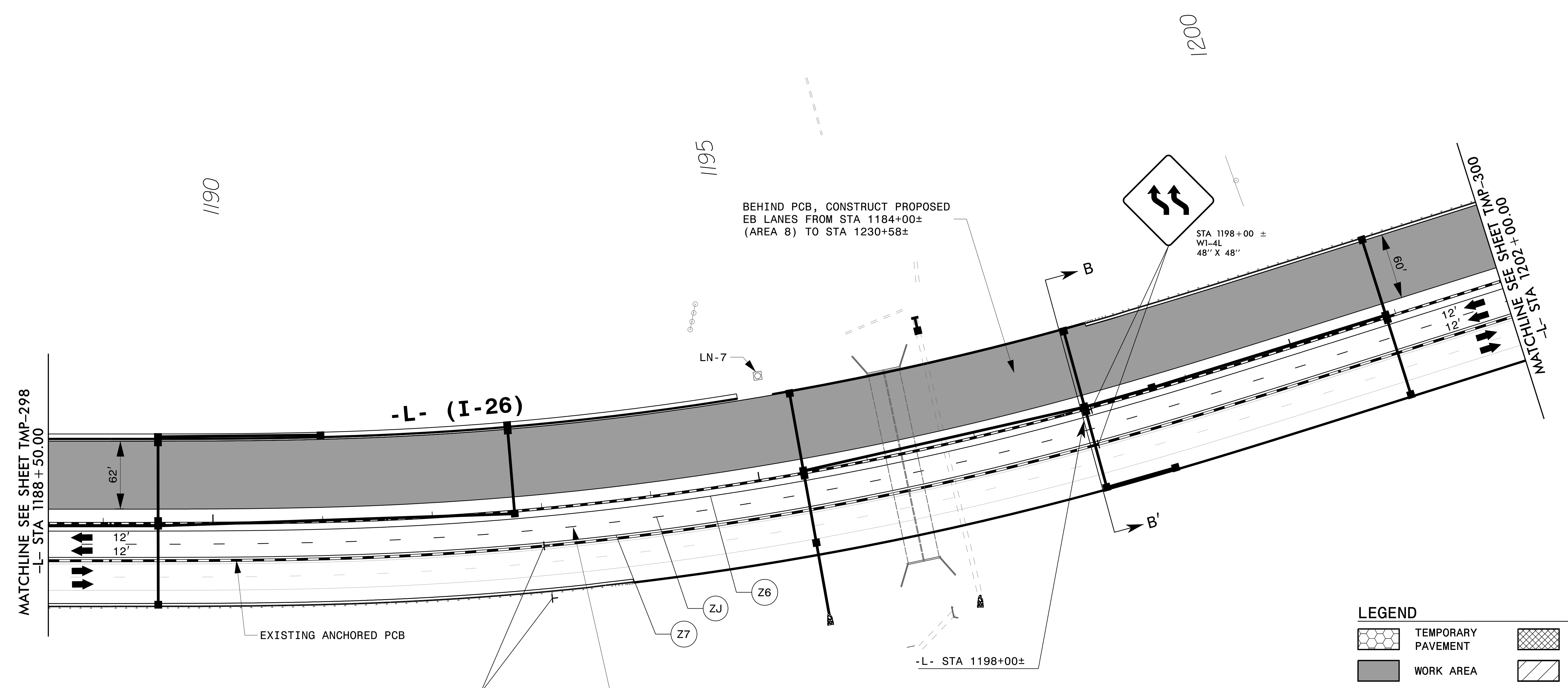
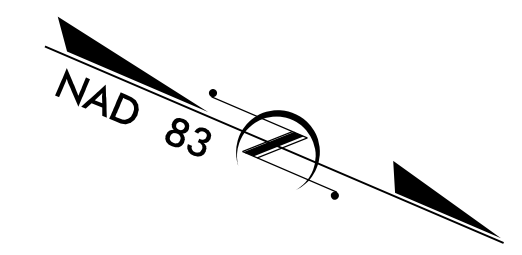

BEHIND PCB, CONSTRUCT PROPOSED
EB LANES FROM STA 1184+00±
(AREA 8) TO STA 1230+58±

MATCHLINE SEE SHEET TMP-298
-L- STA 1188 + 50.00

-L- (I-26)

EXISTING ANCHORED PCB

USING RSD 1101.01 (SHEET 4 OF 14),
INSTALL TEMPORARY PAVEMENT MARKING
FROM STA 1184+00± (AREA 8) TO
STA 1242+00± AND SHIFT EB TRAFFIC
TO NEW PATTERN.

STA 1193+00 ±
W1-4R
48" X 48"

STA 1198+00 ±
W1-4L
48" X 48"

LEGEND

	TEMPORARY PAVEMENT		REMOVAL
	WORK AREA		WEDGE / WIDEN
	ONGOING CONSTRUCTION		

REFER TO SHEETS TMP-304 - TMP-306 FOR CUT SECTION(S).
REMOVE CONFLICTING PAVEMENT MARKING.



APPROVED: *Devek Eugene Vap*
DATE: 4/25/2019

SEAL

**DOCUMENT NOT CONSIDERED FINAL
UNLESS ALL SIGNATURES COMPLETED**

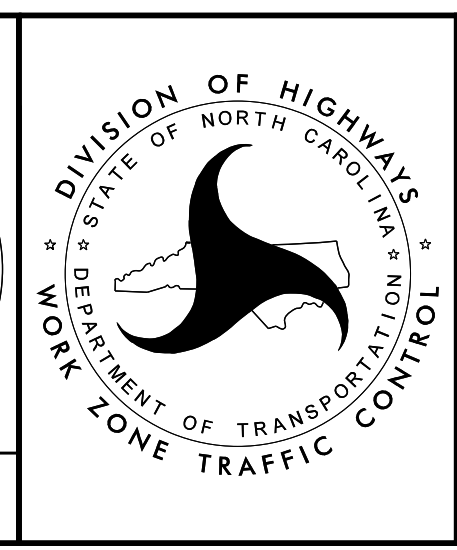

TRANSPORTATION
MANAGEMENT PLAN

AREA 9
PHASE IV
DETAIL 2

25-APR-2019 17:29
I4700.TC.A9P402.dgn
HNTB

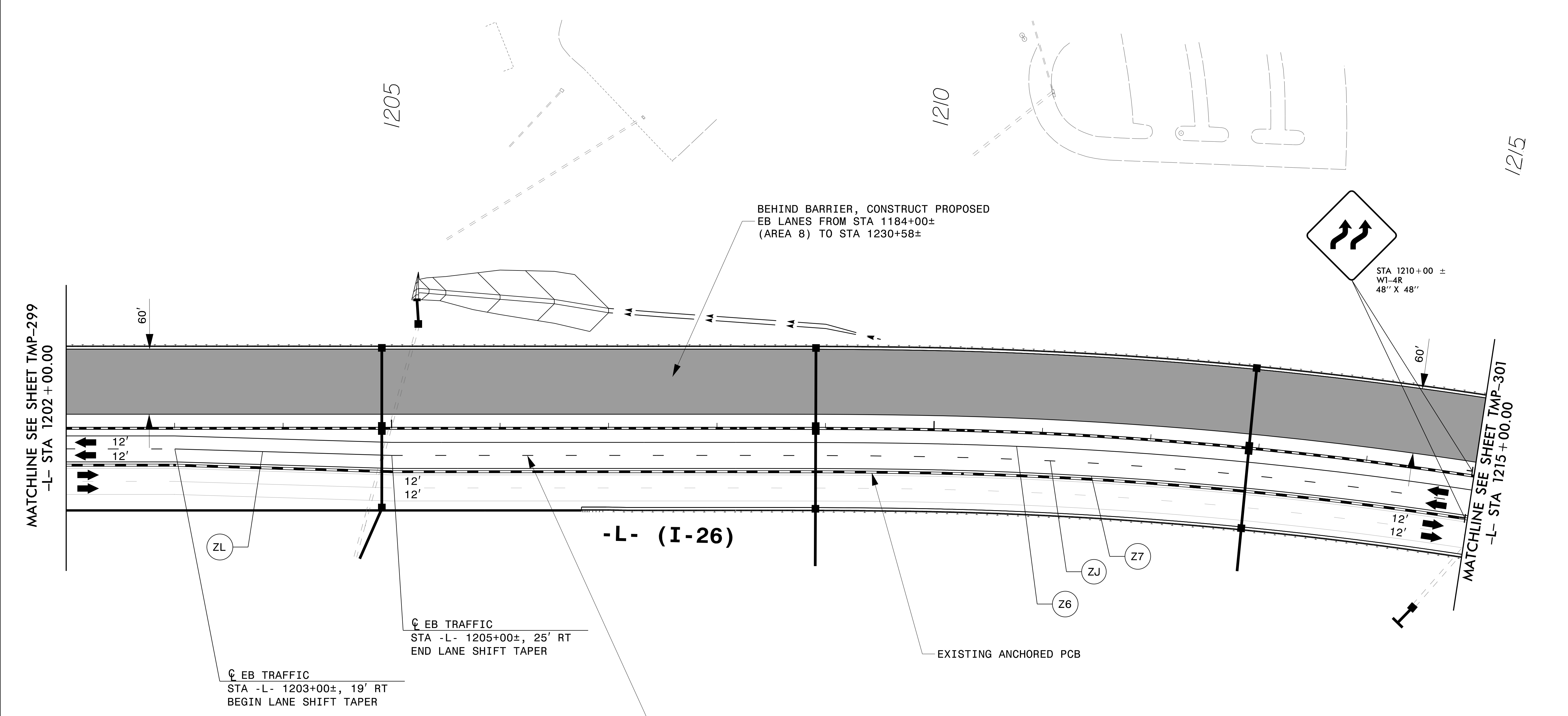
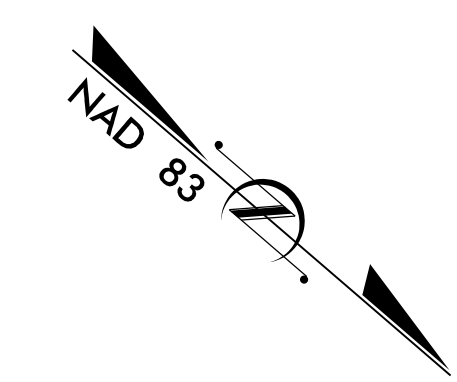

LEGEND

	TEMPORARY PAVEMENT		REMOVAL
	WORK AREA		WEDGE / WIDEN
	ONGOING CONSTRUCTION		

REMOVE CONFLICTING PAVEMENT MARKING.



APPROVED: *Derek Eugene Vap*
CB273C85A8E5A4C3
 DATE: 4/25/2019

SEAL

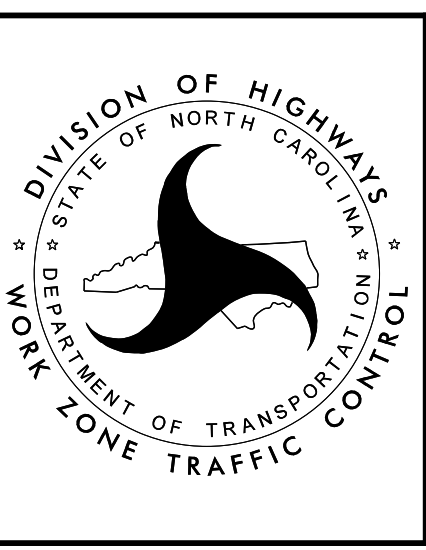

TRANSPORTATION MANAGEMENT PLAN

AREA 9
 PHASE IV
 DETAIL 3

25-APR-2019 19:03
 I4700.TC.A9P403.dgn
 HNTB

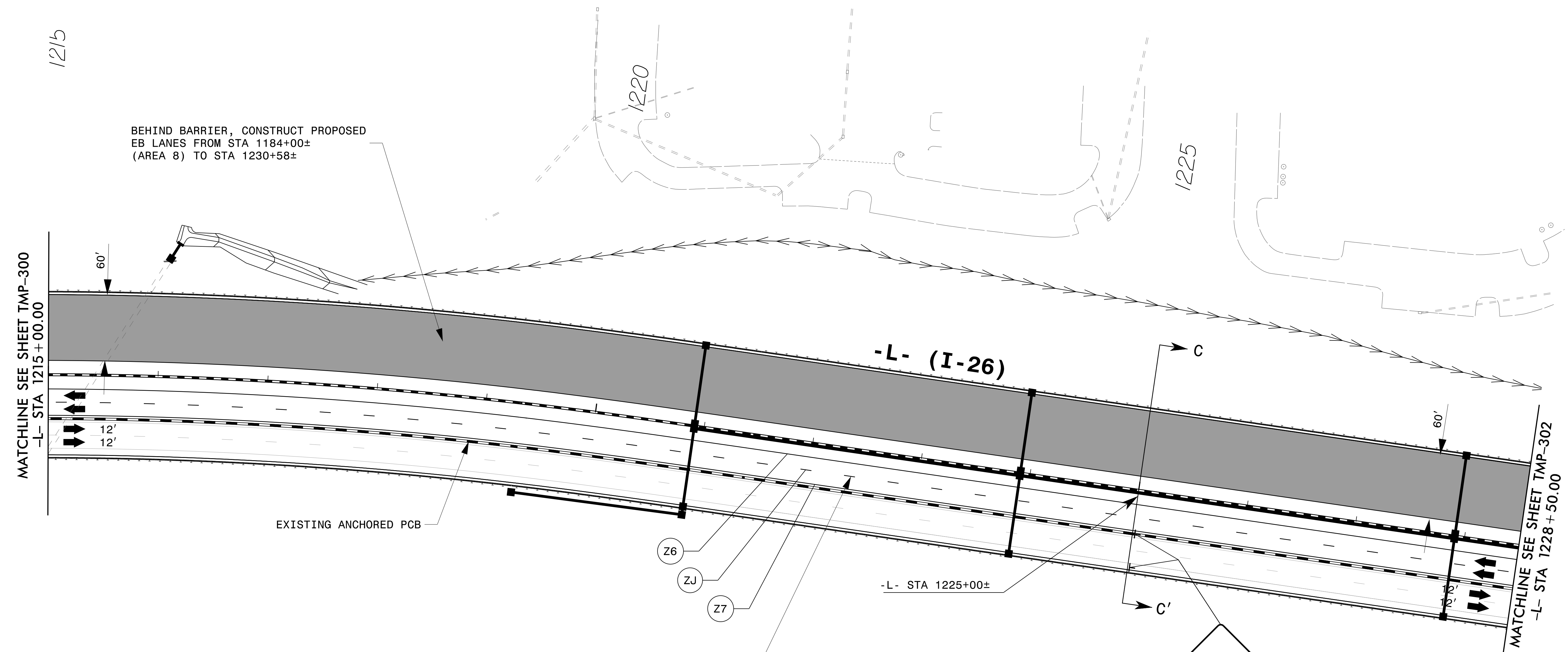
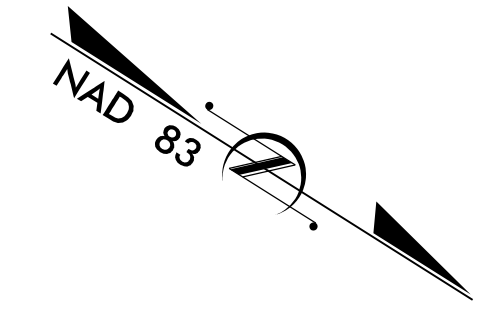

BEHIND BARRIER, CONSTRUCT PROPOSED EB LANES FROM STA 1184+00± (AREA 8) TO STA 1230+58±

MATCHLINE SEE SHEET TMP-300
-L- STA 1215+00.00

MATCHLINE SEE SHEET TMP-302
-L- STA 1228+50.00

-L- (I-26)

-L- STA 1225+00±

EXISTING ANCHORED PCB

USING RSD 1101.01 (SHEET 4 OF 14),
INSTALL TEMPORARY PAVEMENT MARKING
FROM STA 1184+00± (AREA 8) TO
STA 1242+00± AND SHIFT EB TRAFFIC
TO NEW PATTERN.

LEGEND

- | | | | |
|--|----------------------|--|---------------|
| | TEMPORARY PAVEMENT | | REMOVAL |
| | WORK AREA | | WEDGE / WIDEN |
| | ONGOING CONSTRUCTION | | |

STA 1225+00 +/-
W1-4L
48" X 48"

01-MAR-2019 15:06
I4700B-TC-A9P404.dgn
HNTB

REFER TO SHEETS TMP-304 - TMP-306 FOR CUT SECTION(S).
REMOVE CONFLICTING PAVEMENT MARKING.

HNTB HNTB NORTH CAROLINA, P.C.
343 E. SIX FORKS ROAD, SUITE 200
RALEIGH, NORTH CAROLINA 27609
NC LICENSE NO: C-1554

APPROVED: *Devek Eugene Vap*
DATE: 3/1/2019
SEAL
NORTH CAROLINA PROFESSIONAL ENGINEER
SEAL 047639
DEWEK EUGENE VAP

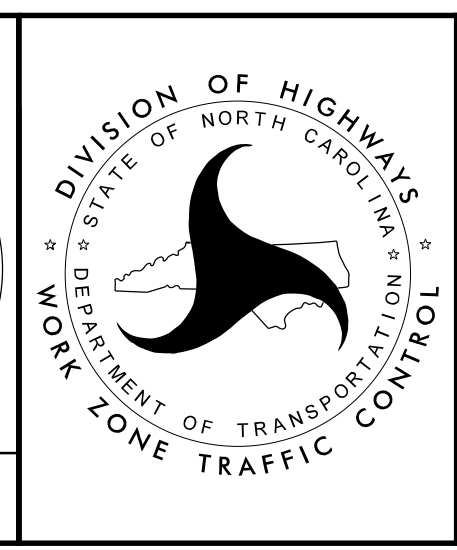

TRANSPORTATION MANAGEMENT PLAN

**AREA 9
PHASE IV
DETAIL 4**

**DOCUMENT NOT CONSIDERED FINAL
UNLESS ALL SIGNATURES COMPLETED**

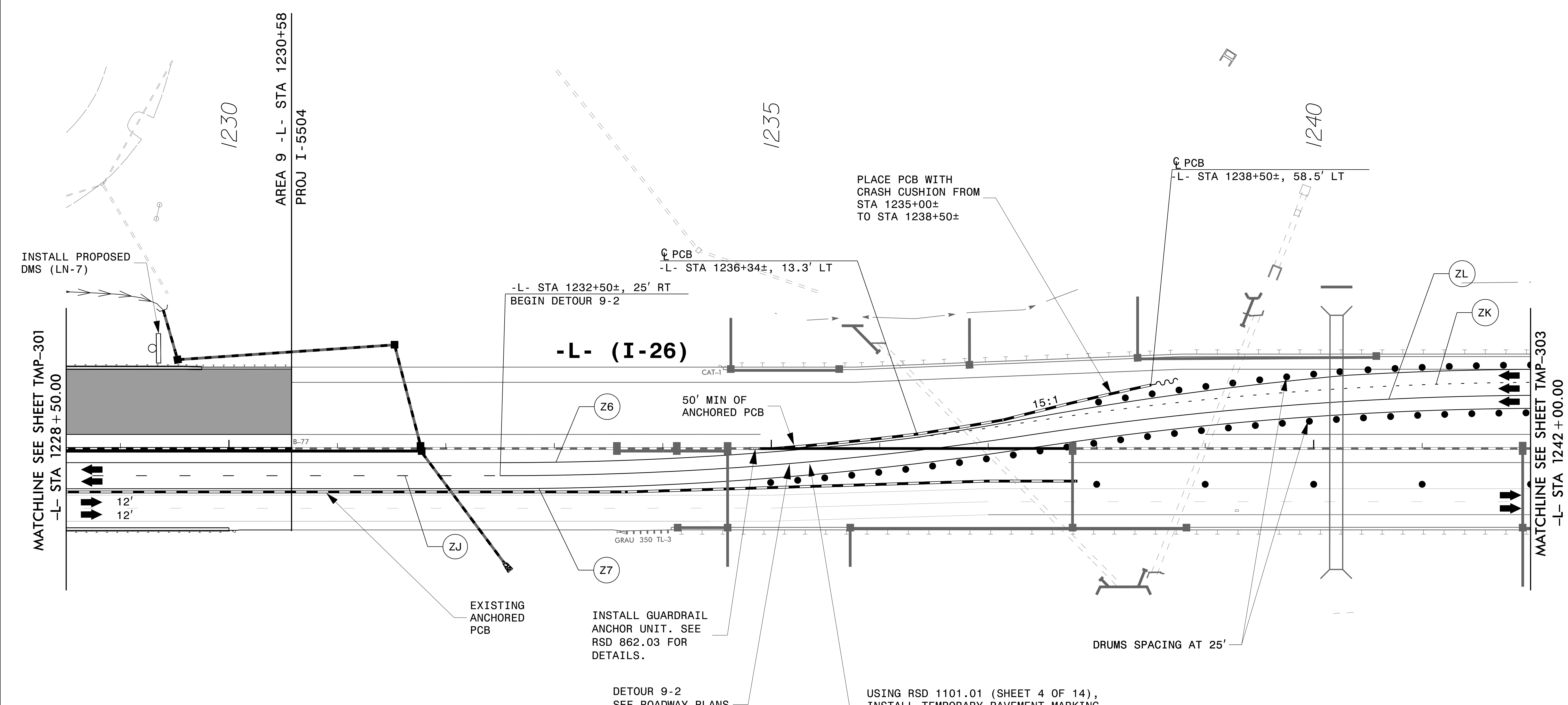
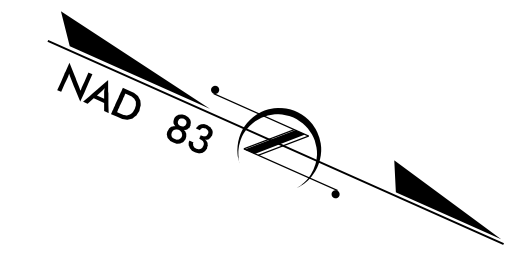

MATCHLINE SEE SHEET TMP-301
-L- STA 1228 + 50.00

MATCHLINE SEE SHEET TMP-303
-L- STA 1242 + 00.00

LEGEND

	TEMPORARY PAVEMENT		REMOVAL
	WORK AREA		WEDGE / WIDEN
	ONGOING CONSTRUCTION		

REFER TO SHEETS 2B-10 THRU 2B-24 FOR DETOUR(S).
REMOVE CONFLICTING PAVEMENT MARKING.



APPROVED: *Dezek Eugene Yip*
DATE: 3/1/2019

SEAL

DOCUMENT NOT CONSIDERED FINAL UNLESS ALL SIGNATURES COMPLETED



TRANSPORTATION MANAGEMENT PLAN

**AREA 9
PHASE IV
DETAIL 5**

01-MAR-2019 15:06
I4700B-TC-A9P405.dgn
HNTB

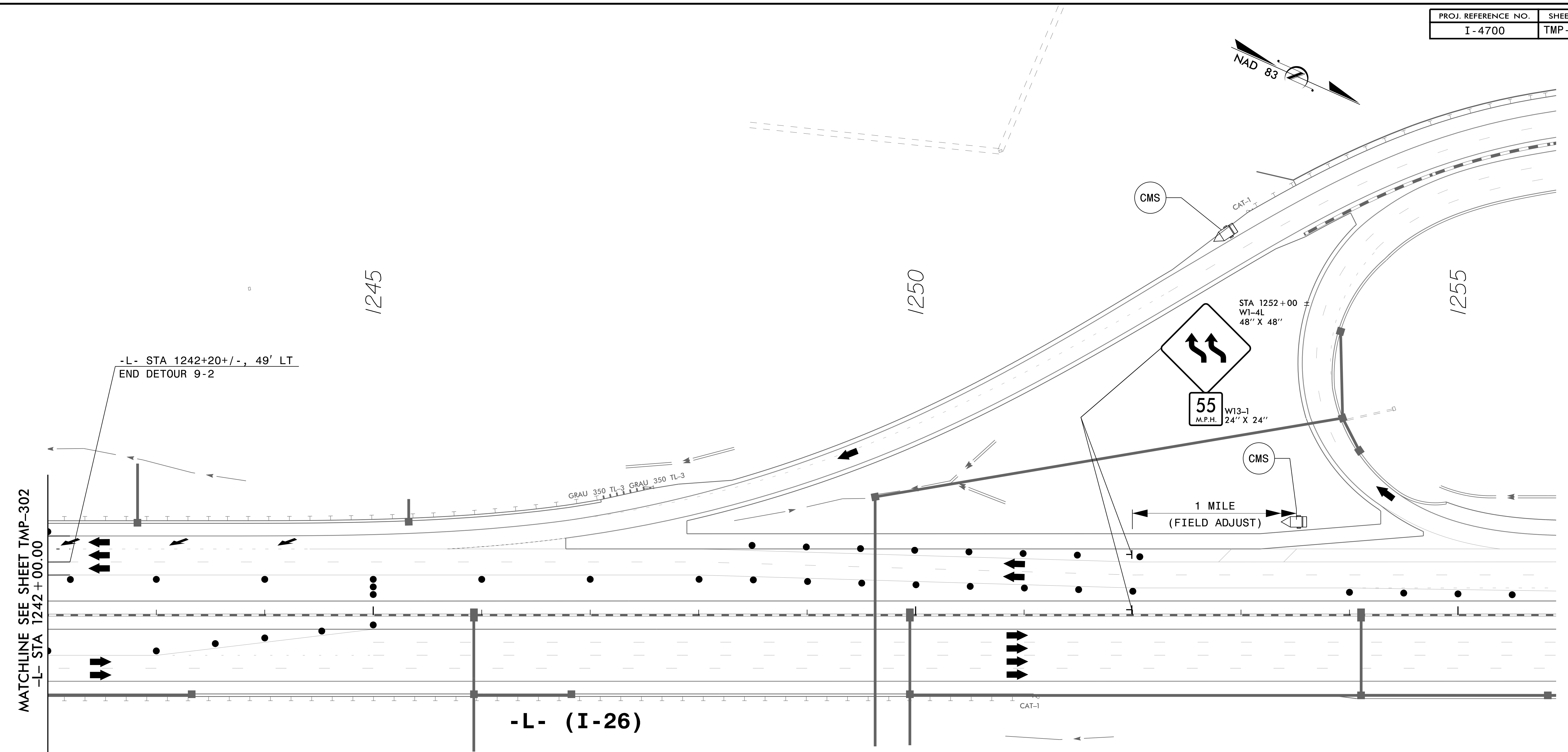
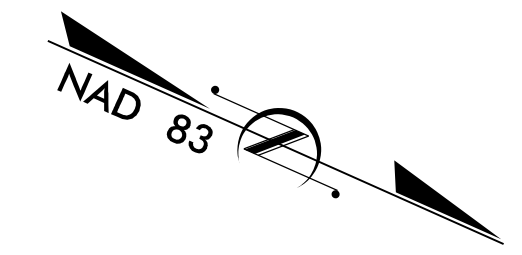

MATCHLINE SEE SHEET TMP-302
-L- STA 1242+00.00

-L- STA 1242+20+/-, 49' LT
END DETOUR 9-2

-L- (I-26)

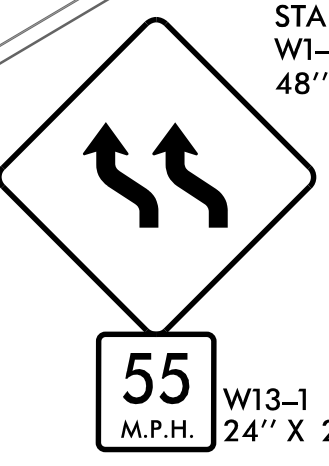

STA 1252+00 ±
W1-4L
48" X 48"

W13-1
24" X 24"

1 MILE
(FIELD ADJUST)

CMS CHANGEABLE MESSAGE SIGN

MESSAGE NO. 1	MESSAGE NO. 2
TRAFFIC SHIFT AHEAD	MAX SPEED 55 MPH

LEGEND

	TEMPORARY PAVEMENT		REMOVAL
	WORK AREA		WEDGE / WIDEN
	ONGOING CONSTRUCTION		

01-MAR-2019 15:07
I4700B-TC-A92406.dgn
HNTB

REMOVE CONFLICTING PAVEMENT MARKING.

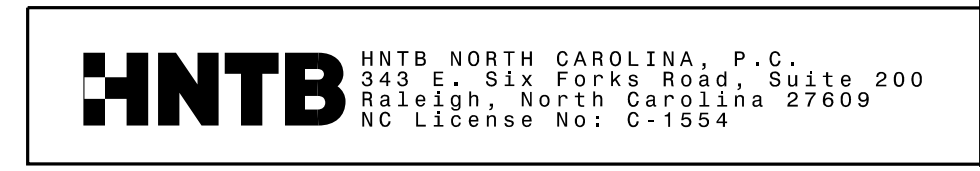

APPROVED: *Devek Eugene Yip*
DATE: 3/1/2019

SEAL

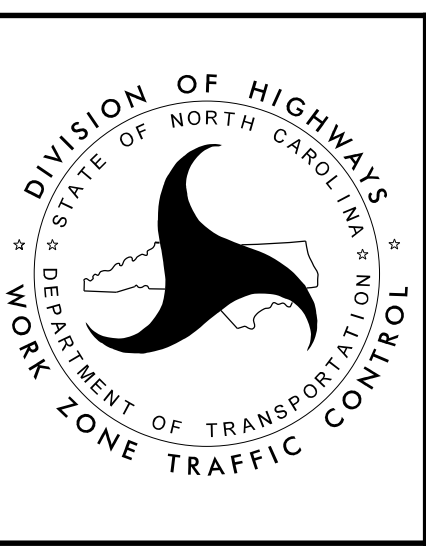

**TRANSPORTATION
MANAGEMENT PLAN**

**AREA 9
PHASE IV
DETAIL 6**

**DOCUMENT NOT CONSIDERED FINAL
UNLESS ALL SIGNATURES COMPLETED**

PHASE I

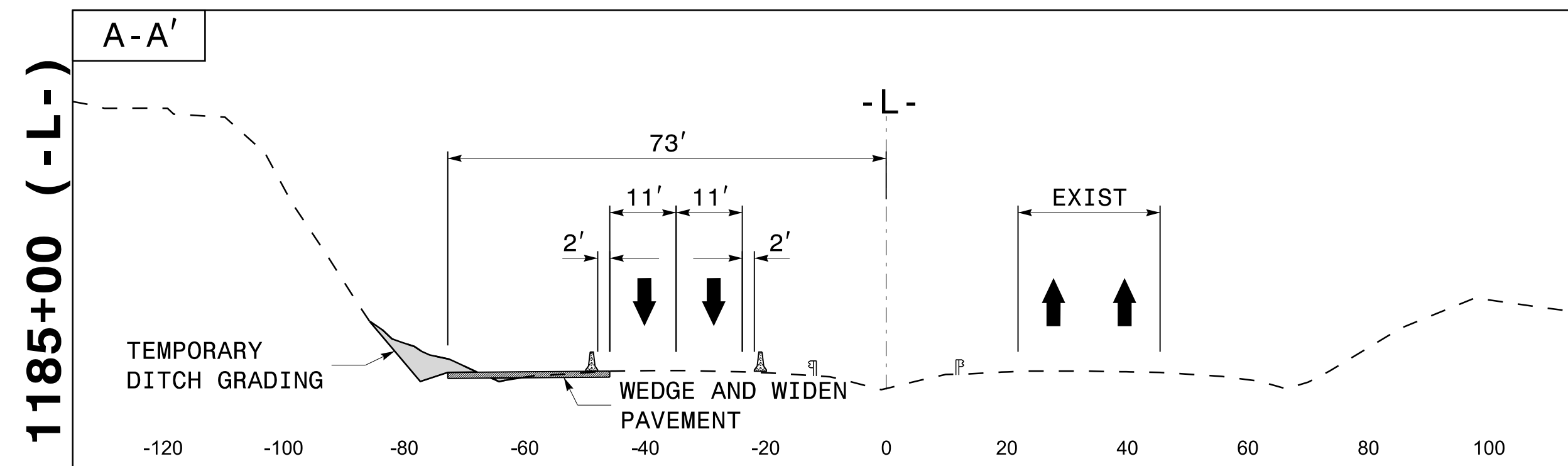

PHASE II

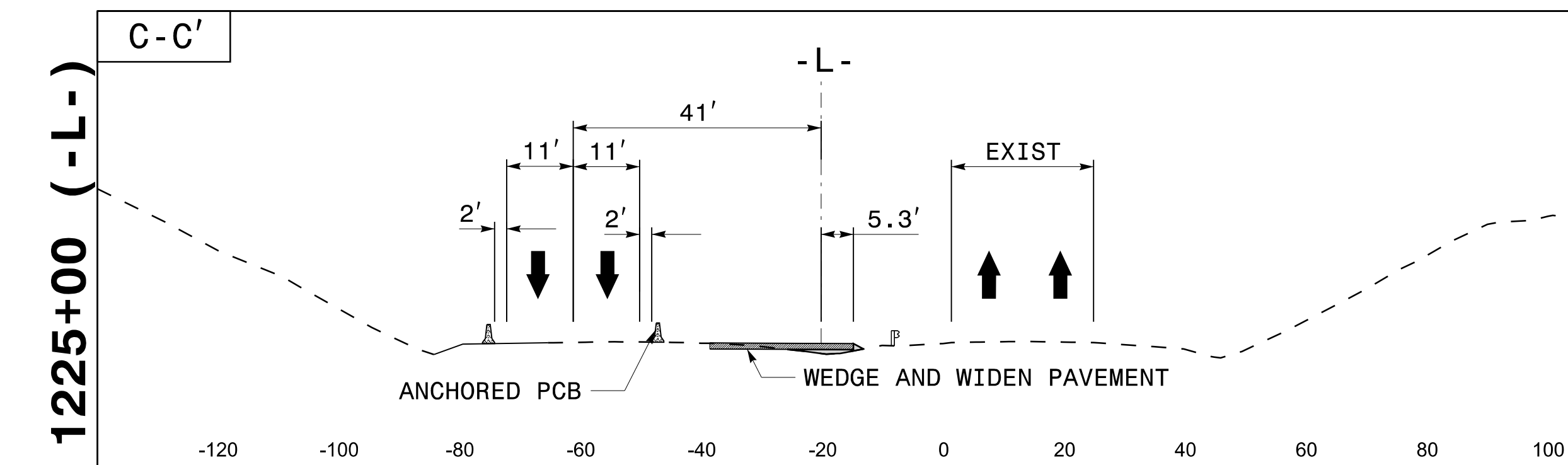
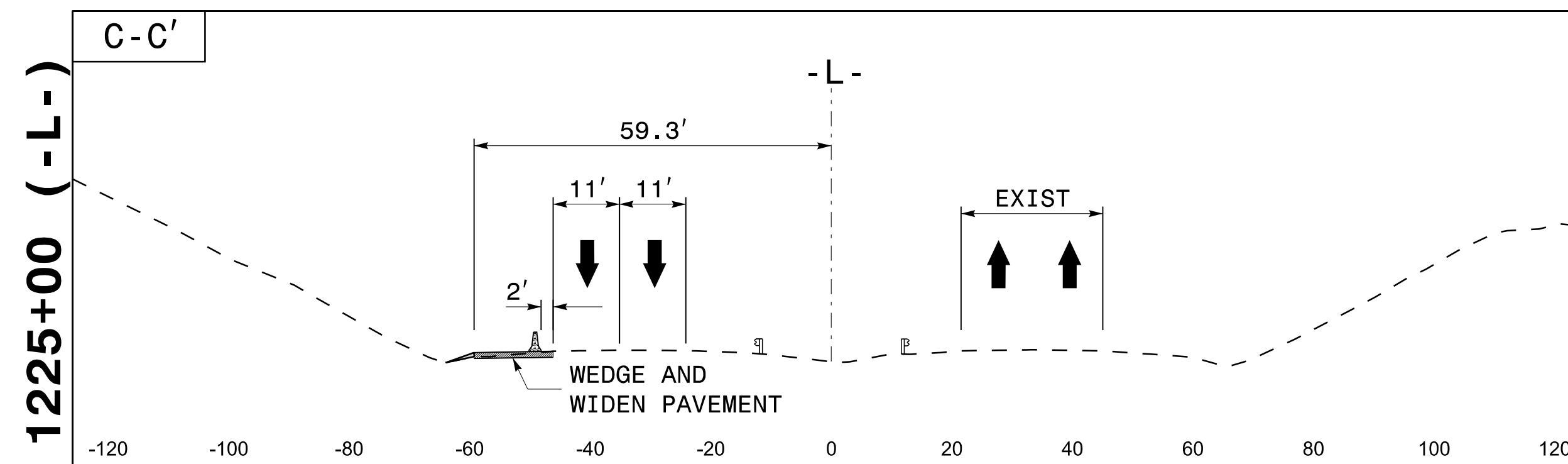
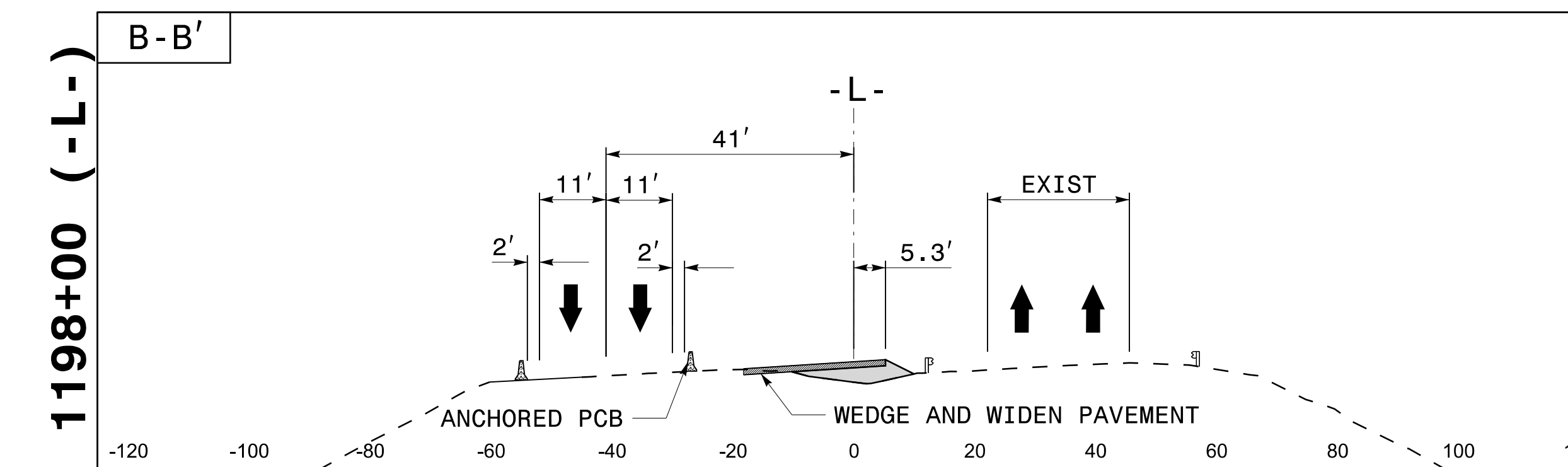
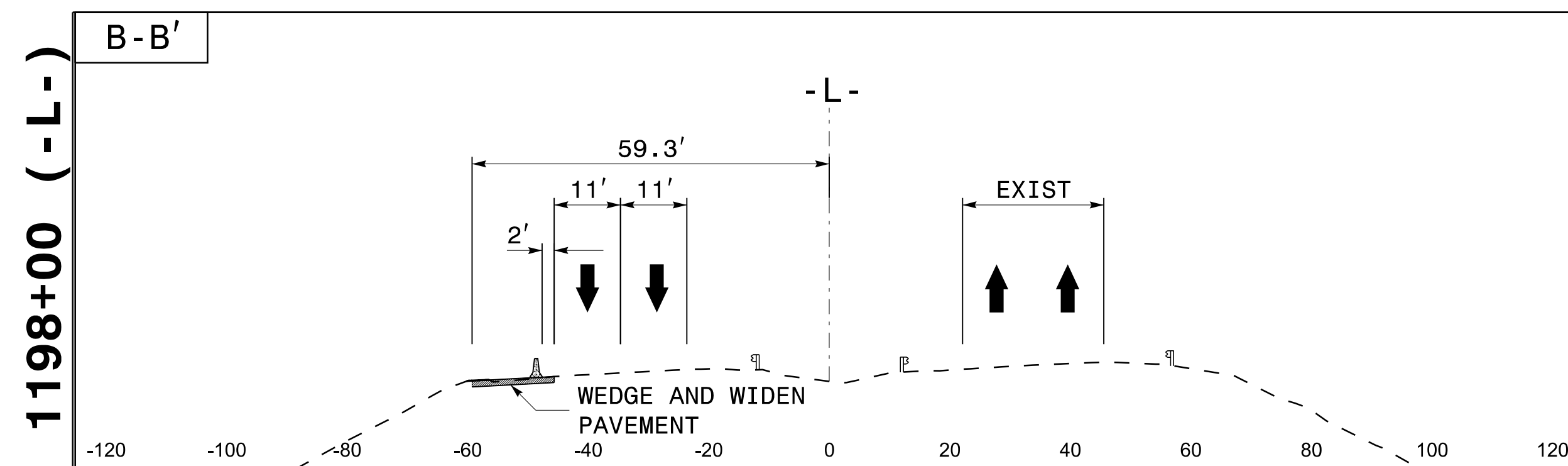
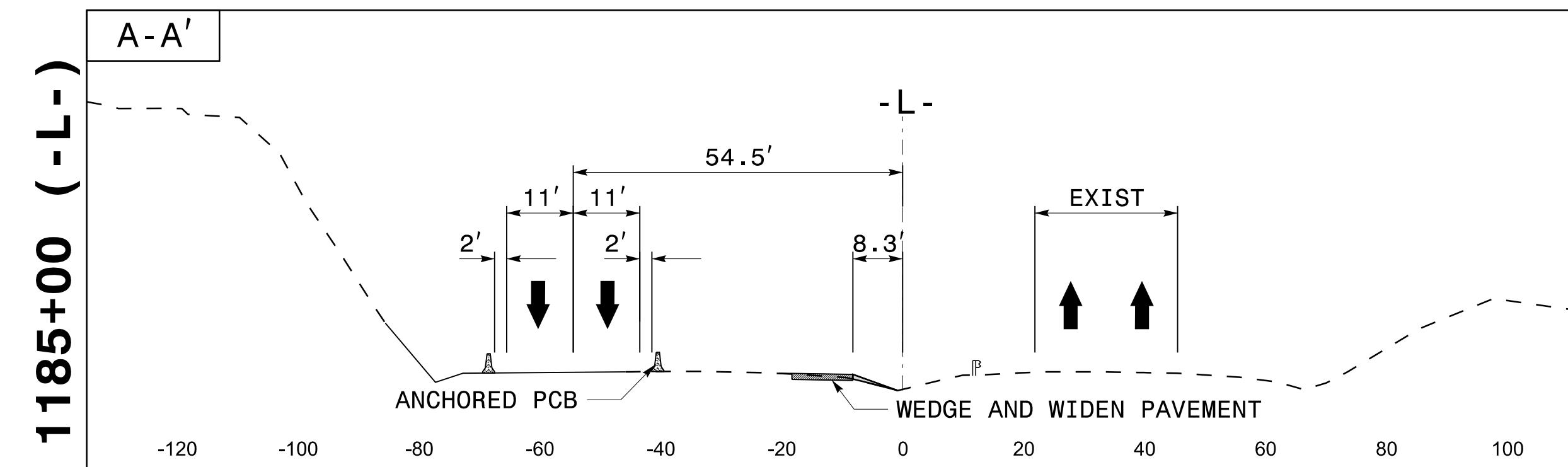

01-MAR-2019 15:07
 I4700B-FC-TMP-A9_CUT.dgn
 HNTB

HNTB
 HNTB NORTH CAROLINA, P.C.
 343 E. Six Forks Road, Suite 200
 Raleigh, North Carolina 27609
 NC License No: C-1554

APPROVED: *Depek Eugene Yip*
 DATE: 3/1/2019
 SEAL
 NORTH CAROLINA PROFESSIONAL ENGINEER
 DEPEK EUGENE YIP
 SEAL 047639

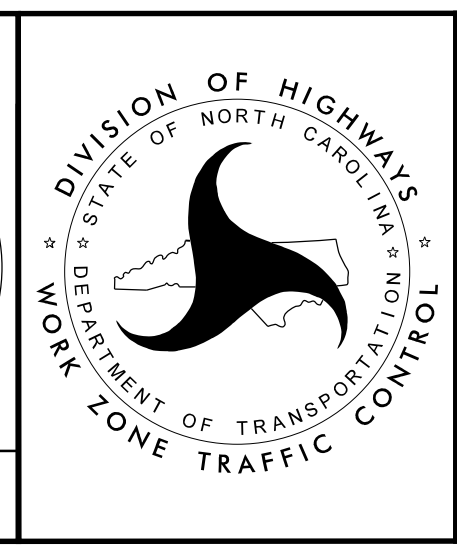

TRANSPORTATION
 MANAGEMENT PLAN

 AREA 9
 PHASE I & II
 CUT SECTIONS

**DOCUMENT NOT CONSIDERED FINAL
 UNLESS ALL SIGNATURES COMPLETED**

PHASE IIIA

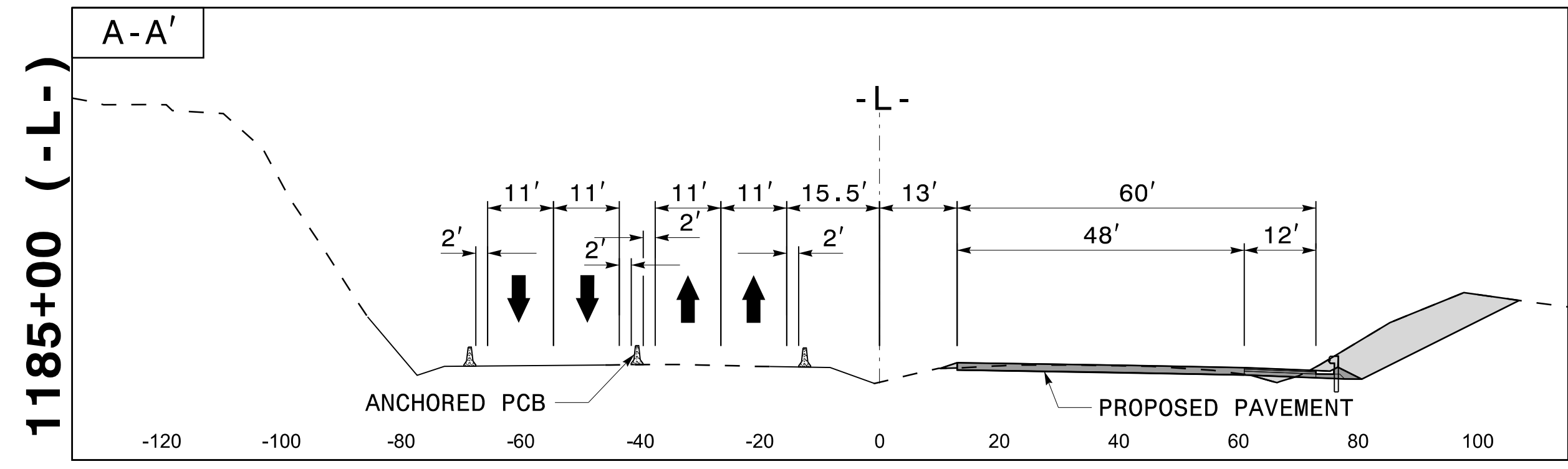

PHASE IIIB

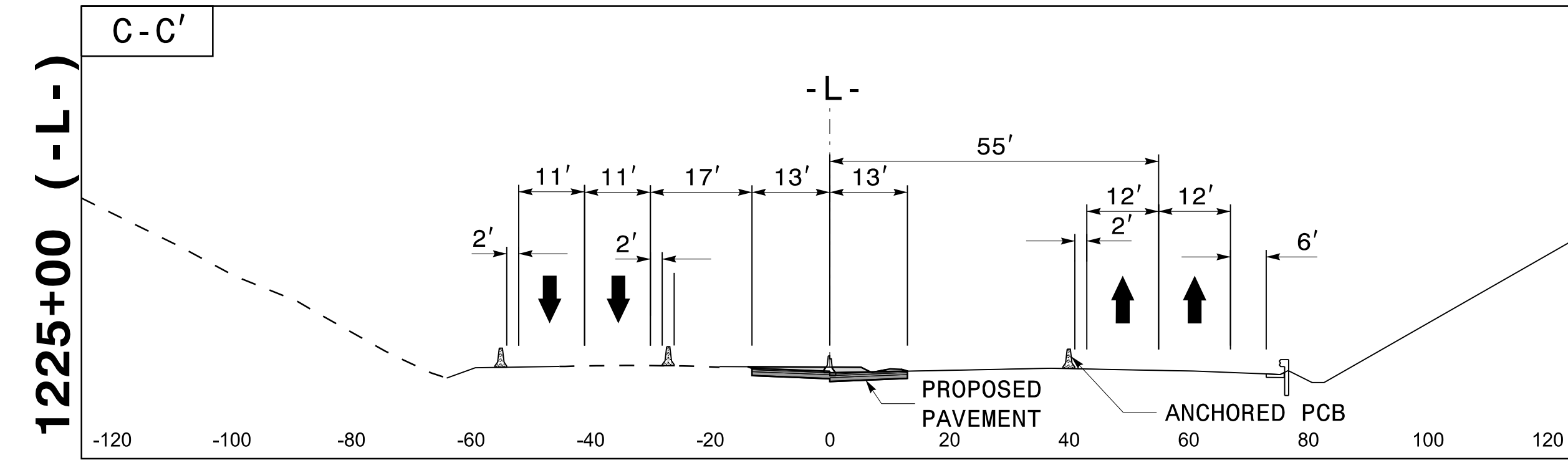
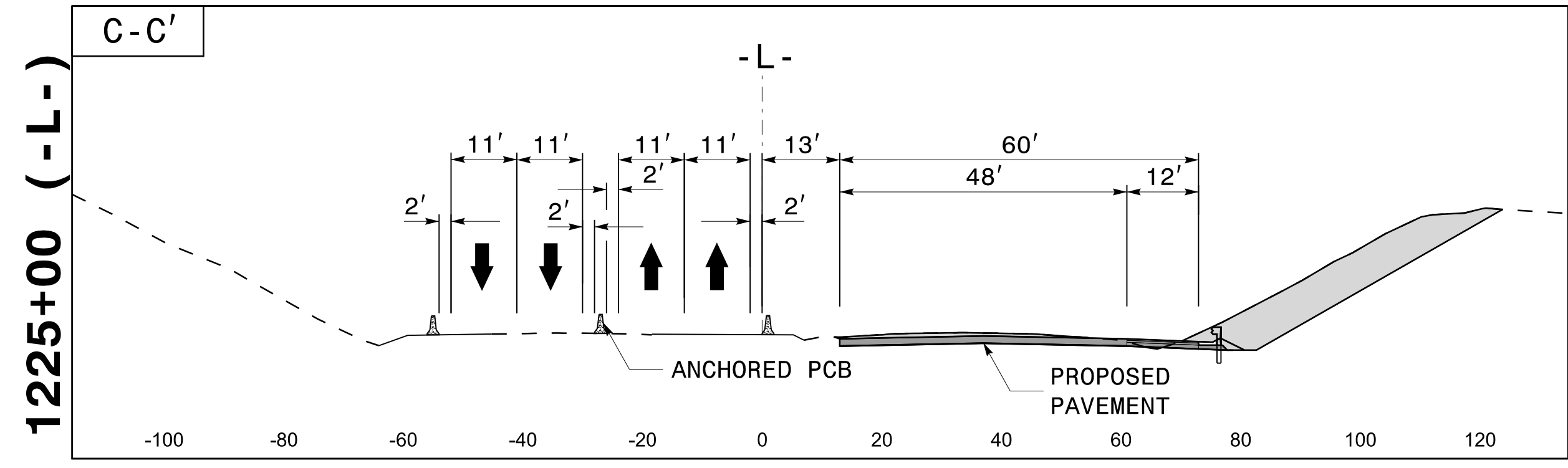
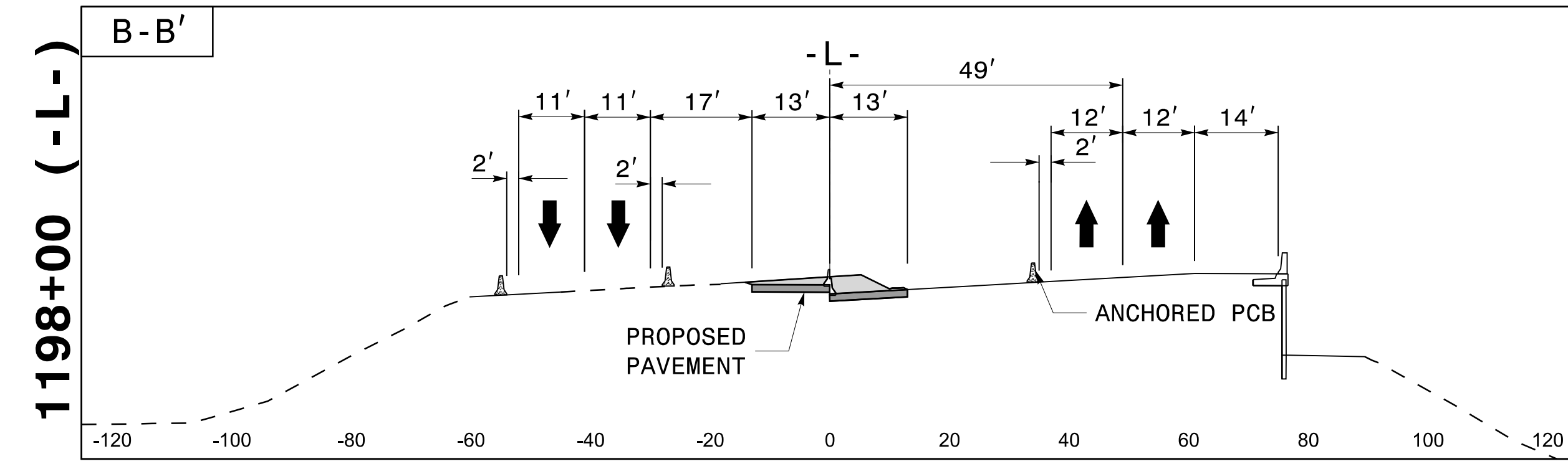
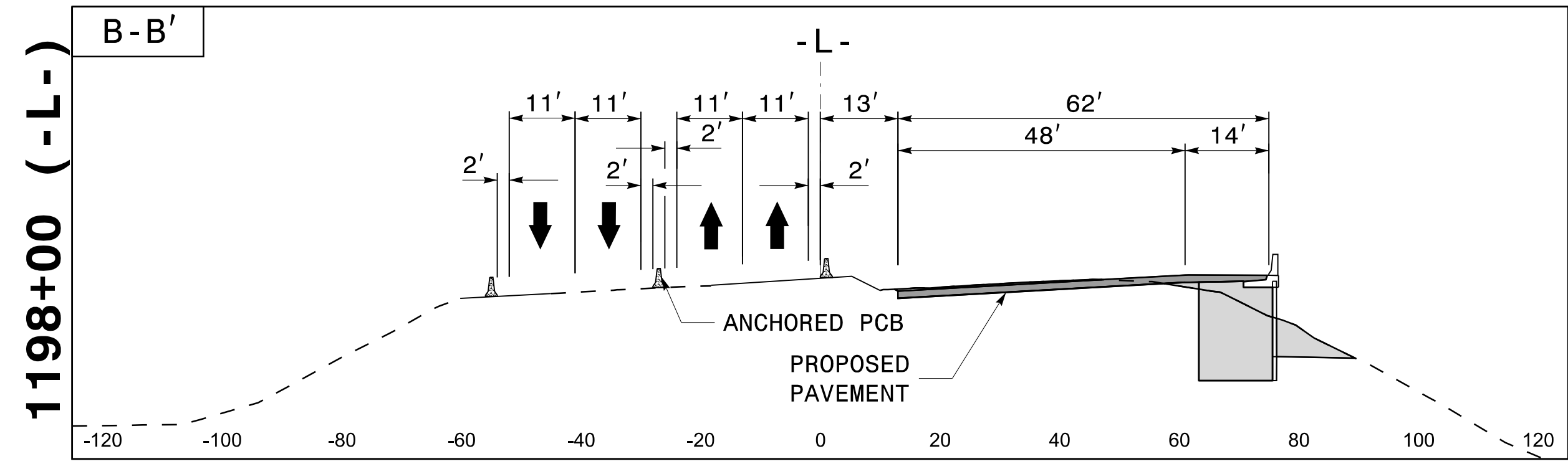
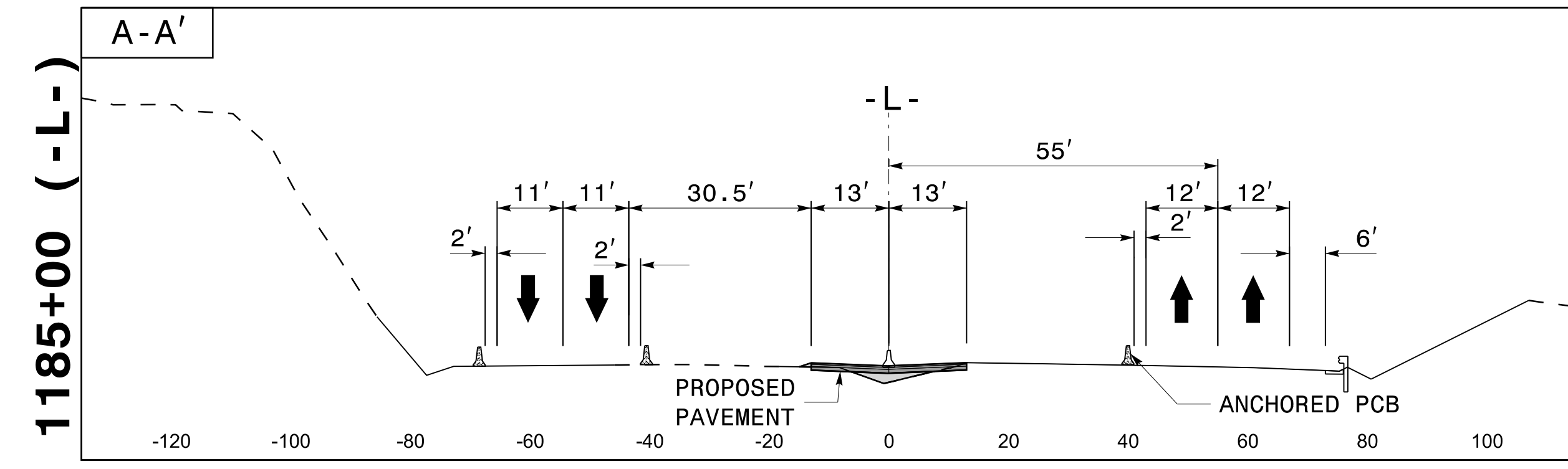

01-MAR-2019 15:07
 I4700B-FC-TMP-A9-CUT.dgn
 HNTB

HNTB
 HNTB NORTH CAROLINA, P.C.
 343 E. Six Forks Road, Suite 200
 Raleigh, North Carolina 27609
 NC License No: C-1554

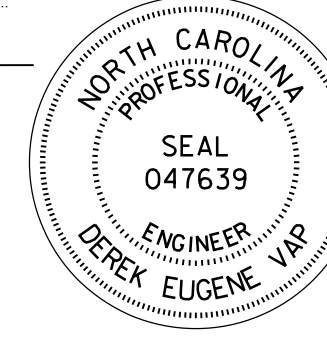
APPROVED: *Depek Eugene Yip*
DocuSigned by:
Depek Eugene Yip
CB273C85AE544C9
 DATE: 3/1/2019
 SEAL

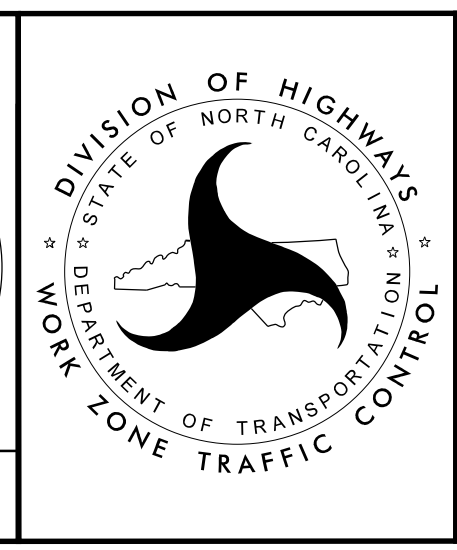

TRANSPORTATION
 MANAGEMENT PLAN

 AREA 9
 PHASE IIIA & IIIB
 CUT SECTIONS

**DOCUMENT NOT CONSIDERED FINAL
 UNLESS ALL SIGNATURES COMPLETED**

PHASE IV

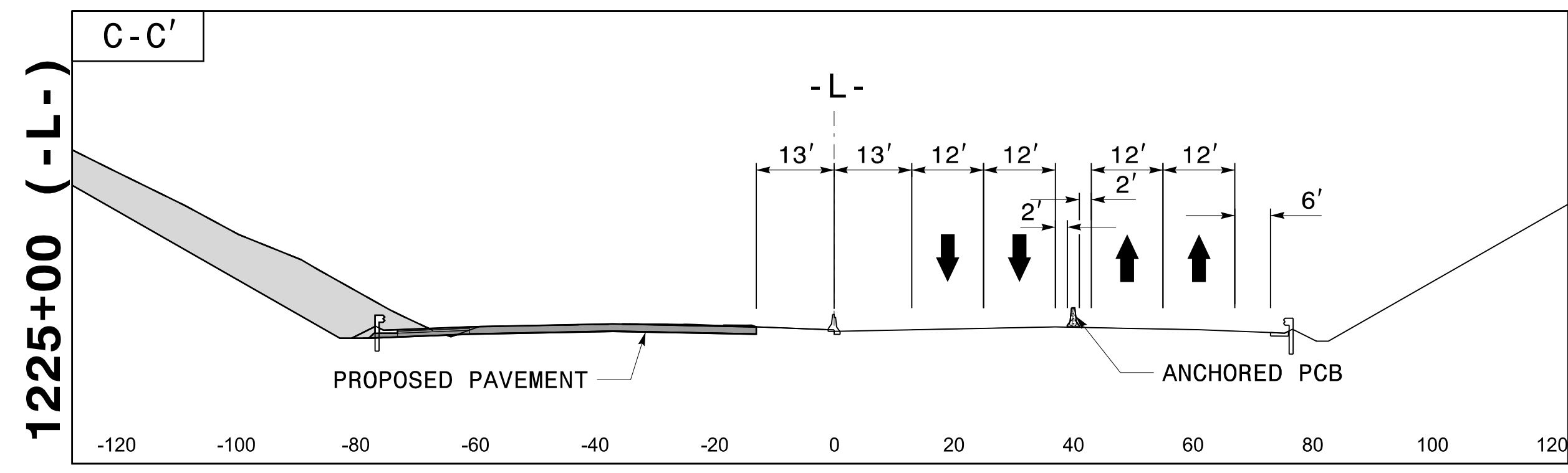
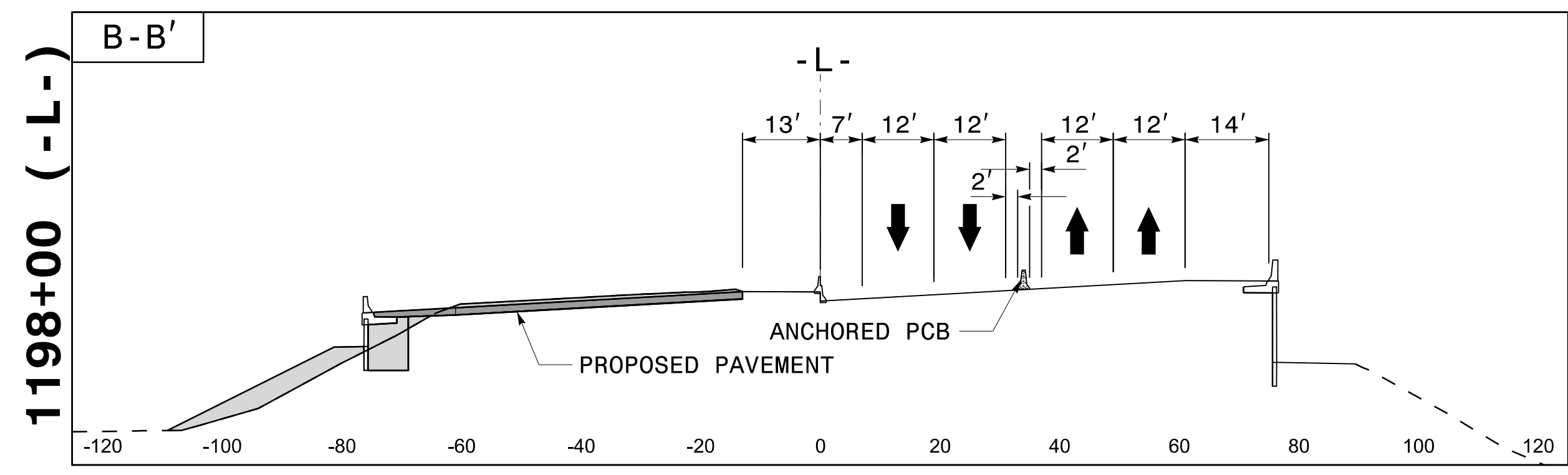
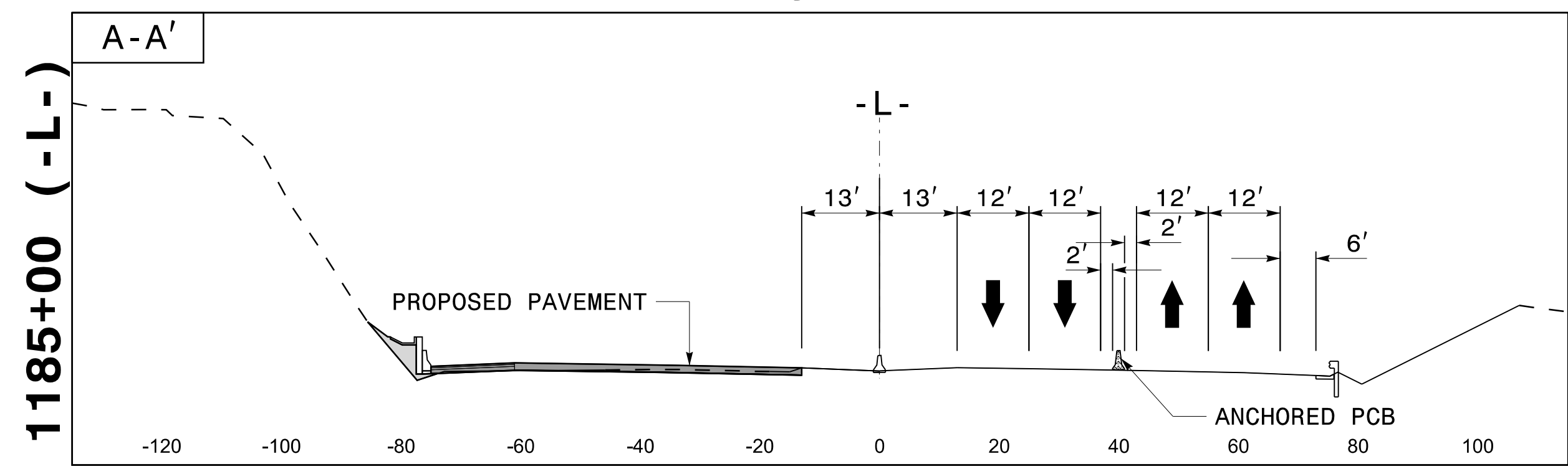

01-MAR-2019 15:07
I4700B-1C-TMP-A9_CUT.dgn
HNTB

HNTB
HNTB NORTH CAROLINA, P.C.
343 E. Six Forks Road, Suite 200
Raleigh, North Carolina 27609
NC License No: C-1554

APPROVED: *Devek Eugene Vap*
DATE: 3/1/2019

SEAL

SEAL
047639
ENGINEER
DEVEK EUGENE VAP

**DOCUMENT NOT CONSIDERED FINAL
UNLESS ALL SIGNATURES COMPLETED**

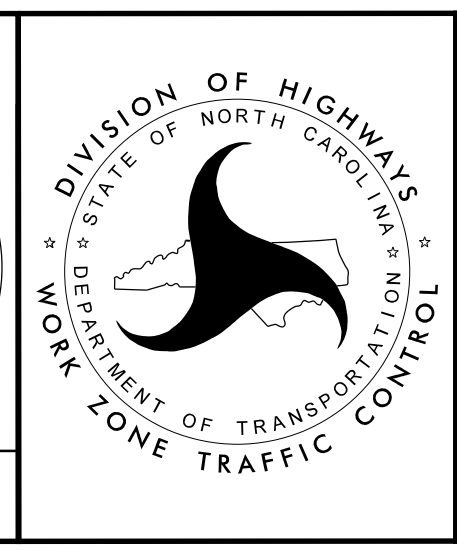

TRANSPORTATION
MANAGEMENT PLAN

**AREA 9
PHASE IV
CUT SECTIONS**