

**PHASING DIAGRAM**

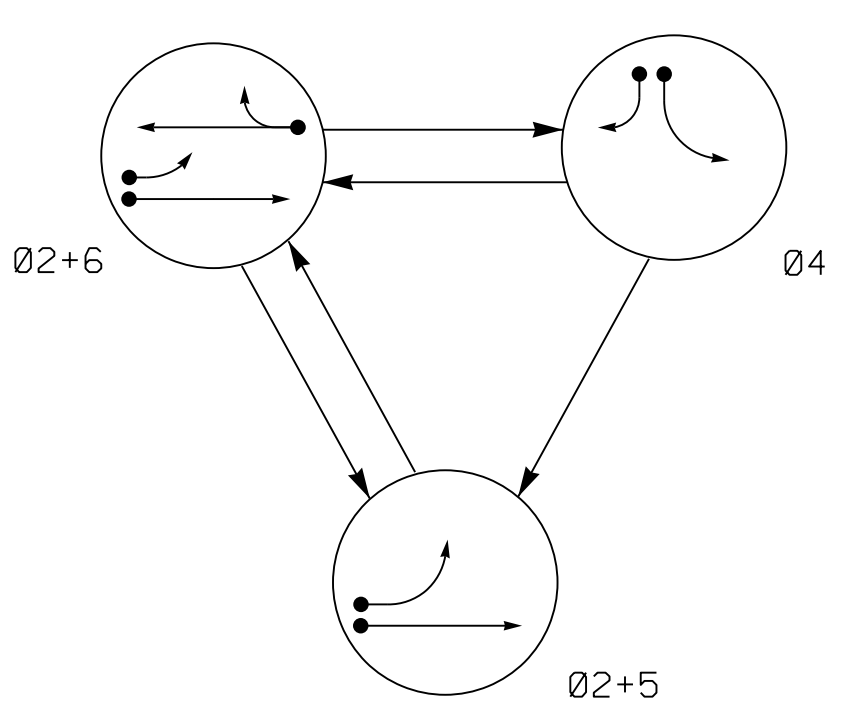
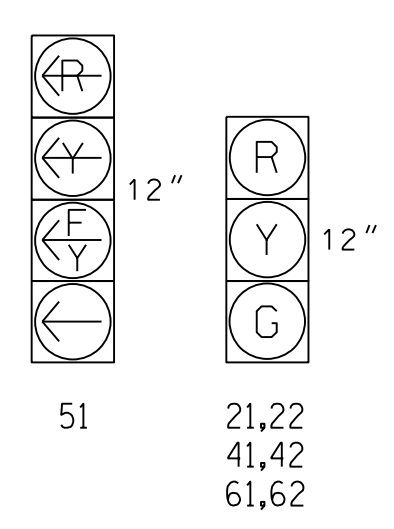

**TABLE OF OPERATION**

SIGNAL FACE	PHASE			
	Ø 2 + 5	Ø 2 + 6	Ø 4	FLASH
21,22	G	G	R	Y
41,42	R	R	G	R
51	←	←	←	←
61,62	R	G	R	Y

**SIGNAL FACE I.D.**

All Heads L.E.D.



**PHASING DIAGRAM DETECTION LEGEND**

- → DETECTED MOVEMENT
- → UNDETECTED MOVEMENT (OVERLAP)
- UNSIGNALIZED MOVEMENT
- ⚡ PEDESTRIAN MOVEMENT

**OASIS 2070 LOOP & DETECTOR INSTALLATION CHART**

LOOP	SIZE (FT)	DISTANCE FROM STOPBAR (FT)	TURNS	NEW LOOP	DETECTOR PROGRAMMING				STRETCH TIME	DELAY TIME	SYSTEM LOOP	NEW CARD
					PHASE	CALLING	EXTENSION	FULL TIME DELAY				
2A	6X6	300	*	*	2	Y	Y	-	-	-	-	*
2B	6X40	0	*	*	2	Y	Y	Y	2.0	5	-	*
4A	6X40	0	*	*	4	Y	Y	-	-	-	-	*
4B	6X40	0	*	*	4	Y	Y	-	-	15	-	*
4C	6X6	0	*	*	4	Y	Y	-	-	15	-	*
5A	6X40	0	*	*	5	Y	Y	-	-	15	-	*
6A	6X6	300	*	*	6	Y	Y	-	-	3	-	*
6B	6X40	0	*	*	6	Y	Y	Y	2.0	5	-	*

\*Video Detection Area. Camera locations should be confirmed in the field by the contractor in order to provide detection of the areas indicated.

**3 Phase Fully Actuated SR 1001 (Sugar Hill Road) CLS**

**NOTES**

- Refer to "Roadway Standard Drawings NCDOT" dated January 2018 and "Standard Specifications for Roads and Structures" dated January 2018.
- Do not program signal for late night flashing operation unless otherwise directed by the Engineer.
- Phase 5 may be lagged.
- Set all detector units to presence mode.
- Locate new cabinet so as not to obstruct sight distance of vehicles turning right on red.
- Maximum times shown in timing chart are for free-run operation only. Coordinated signal system timing values supersede these values.
- Field adjust temporary poles as needed.
- Closed Loop System Data: Controller Asset #: 0611

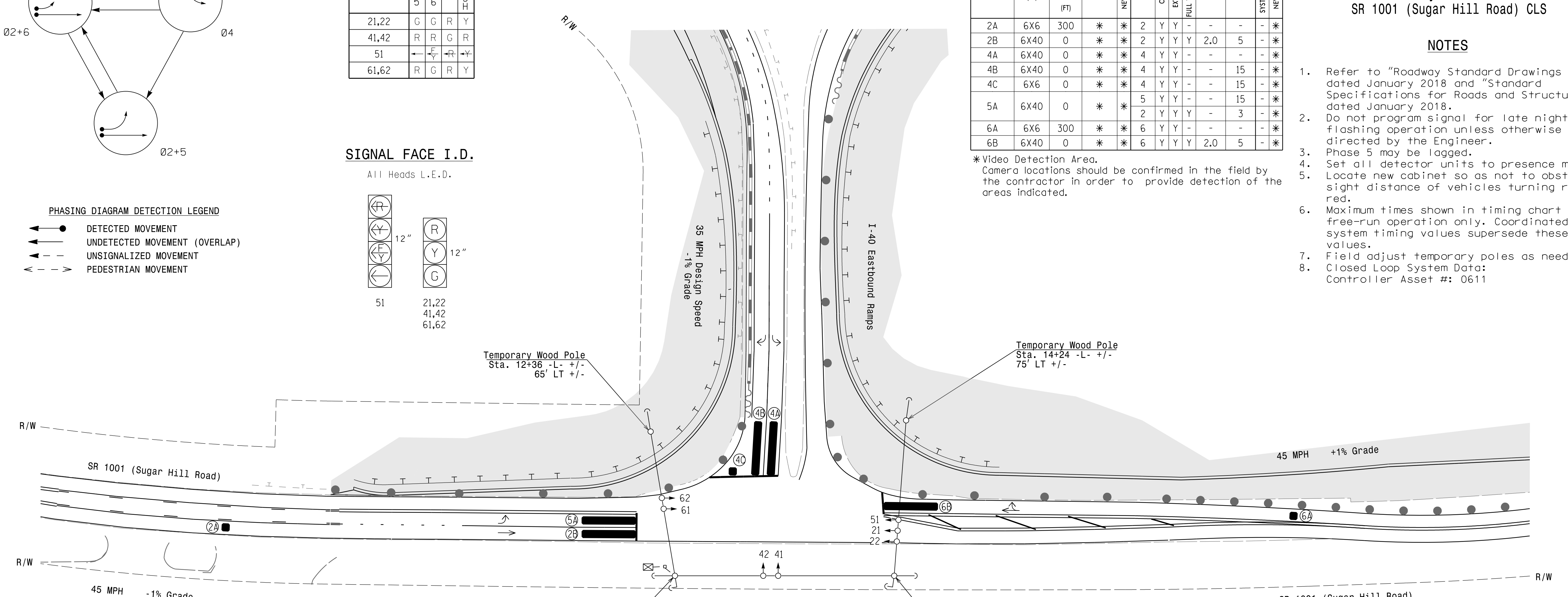

**LEGEND**

- | PROPOSED   | EXISTING  |
|--|-----------|
| ○ → Traffic Signal Head                          | ● → N/A   |
| ○ → Modified Signal Head                         | ○ → N/A   |
| ⊥ Sign   | ⊥ N/A     |
| ⊥ Pedestrian Signal Head With Push Button & Sign | ⊥ N/A     |
| ○ → Signal Pole with Guy                         | ● → N/A   |
| ○ → Signal Pole with Sidewalk Guy                | ● → N/A   |
| ⊠ Inductive Loop Detector                        | ⊠ N/A     |
| ⊠ Controller & Cabinet                           | ⊠ N/A     |
| ⊠ Junction Box                                   | ⊠ N/A     |
| --- 2-in Underground Conduit                     | --- N/A   |
| N/A Right of Way                                 | --- N/A   |
| → Directional Arrow                              | → N/A     |
| ▬ Video Detection Area                           | ▬ N/A     |
| ▬ Construction Zone                              | ▬ N/A     |
| ● ● ● Drums                                      | ● ● ● N/A |

**OASIS 2070 TIMING CHART**

FEATURE	PHASE			
	2	4	5	6
Min Green 1 *	12	7	7	12
Extension 1 *	6.0	2.0	2.0	6.0
Max Green 1 *	90	30	15	90
Yellow Clearance	4.6	3.0	3.0	4.6
Red Clearance	2.9	3.3	3.7	2.9
Red Revert	2.0	2.0	2.0	2.0
Walk 1 *	-	-	-	-
Don't Walk 1	-	-	-	-
Seconds Per Actuation *	-	-	-	-
Max Variable Initial *	-	-	-	-
Time Before Reduction *	15	-	-	15
Time To Reduce *	30	-	-	30
Minimum Gap	3.0	-	-	3.0
Recall Mode	MIN RECALL	-	-	MIN RECALL
Vehicle Call Memory	-	-	-	-
Dual Entry	-	-	-	-
Simultaneous Gap	ON	ON	ON	ON

\* These values may be field adjusted. Do not adjust Min Green and Extension times for phases 2 and 6 lower than what is shown. Min Green for all other phases should not be lower than 4 seconds.

**Signal Upgrade Temporary Design 1 - TMP Phase I**

**Stantec**  
 Stantec Consulting Services Inc.  
 801 Jones Franklin Road-Suite 300  
 Raleigh, NC 27606  
 Tel. (919) 851-6866  
 Fax. (919) 851-7024  
 www.stantec.com  
 License No. F-0672

Prepared for the Offices of:  
 Transportation Mobility and Safety Division  
 NORTH CAROLINA DEPARTMENT OF TRANSPORTATION  
 Signal Design Section  
 750 N. Greenfield Pkwy, Garner, NC 27526  
 SCALE: 1" = 40'

**SR 1001 (Sugar Hill Road) at I-40 Eastbound Ramps**  
 Division 13 McDowell County Marion  
 PLAN DATE: January 2019 REVIEWED BY: R Muncey  
 PREPARED BY: G Spell REVIEWED BY: D Harris

REVISIONS	INIT.	DATE

**PROFESSIONAL SEAL**  
 REGINA M. MUNCEY  
 ENGINEER  
 SEAL 43239  
 DATE: 2/5/2019  
 SIG. INVENTORY NO. 13-06111

DOCUMENT NOT CONSIDERED FINAL UNLESS ALL SIGNATURES COMPLETED

2/5/2019 10:11 AM  
 User: rmuncey  
 C:\Users\muncey\Documents\Signal Design\Signal Design\Temporary Design\5818...sig.dgn, 13-061111.dgn