

**This electronic collection of documents is provided
for the convenience of the user
and is Not a Certified Document –**

**The documents contained herein were originally issued
and sealed by the individuals whose names and license
numbers appear on each page, on the dates appearing
with their signature on that page.**

**This file or an individual page
shall not be considered a certified document.**

CROSS SECTION INDEX

PROJECT NO. B-4962

ALIGNMENT	SHEET NUMBER
-L- & -LDET-	X-1 TO X-12
-Y-	X-13

8/23/99

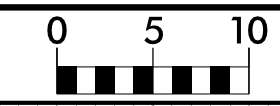

PROJ. REFERENCE NO.
B-4962

SHEET NO.
X-2

150 140 130 120 110 100 90 80 70 60 50 40 30 20 10 0 10 20 30 40 50 60 70 80 90 100 110 120 130 140 150

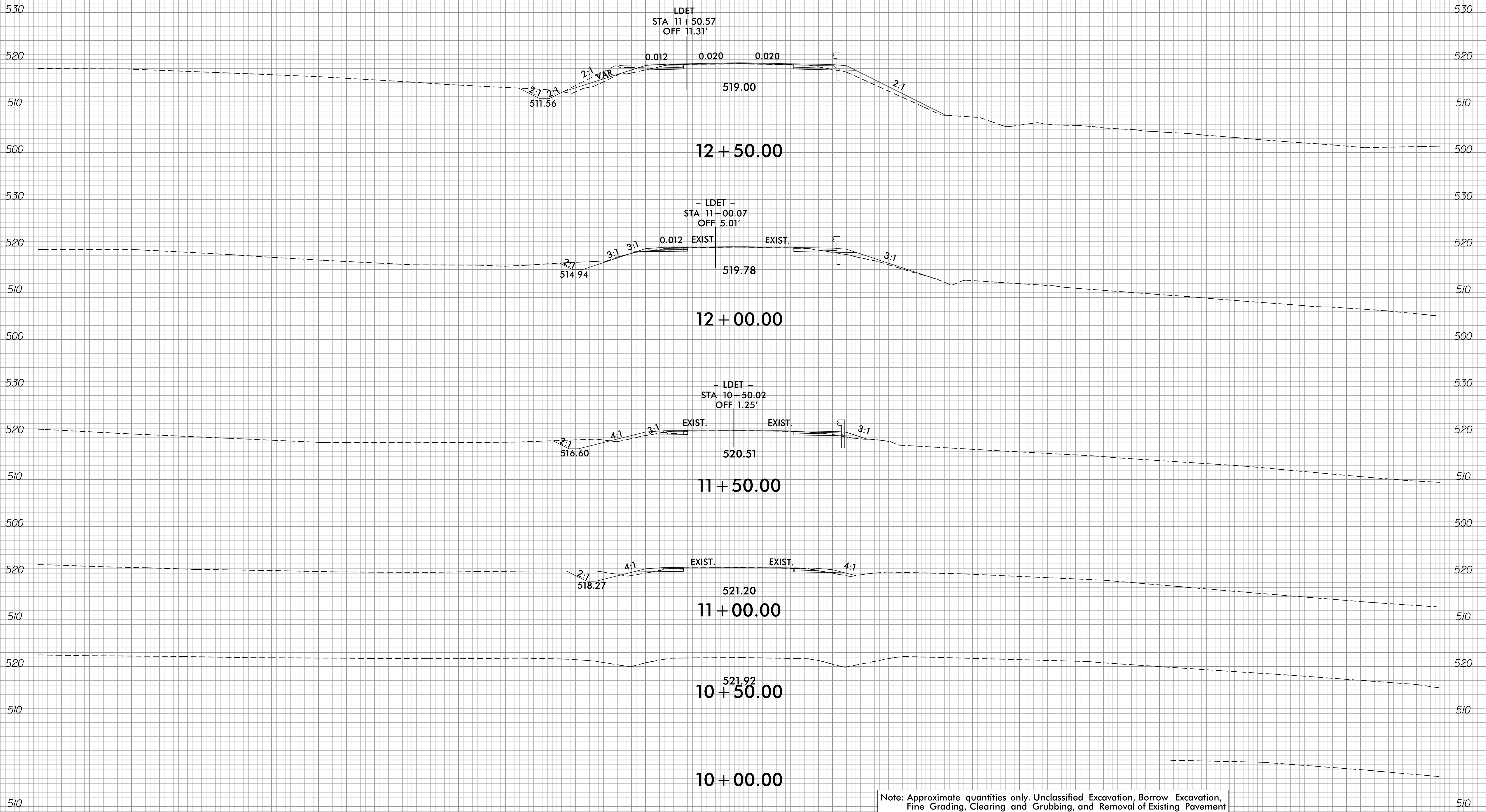

Note: Approximate quantities only. Unclassified Excavation, Borrow Excavation, Fine Grading, Clearing and Grubbing, and Removal of Existing Pavement will be paid for at the contract lump sum price for "Grading."

31-JAN-2019 11:25
B4962.Fdw.XPL.L.dgn
SARZLOK11

150 140 130 120 110 100 90 80 70 60 50 40 30 20 10 0 10 20 30 40 50 60 70 80 90 100 110 120 130 140 150

8/23/99



PROJ. REFERENCE NO.
B-4962

SHEET NO.
X-3

150 140 130 120 110 100 90 80 70 60 50 40 30 20 10 0 10 20 30 40 50 60 70 80 90 100 110 120 130 140 150

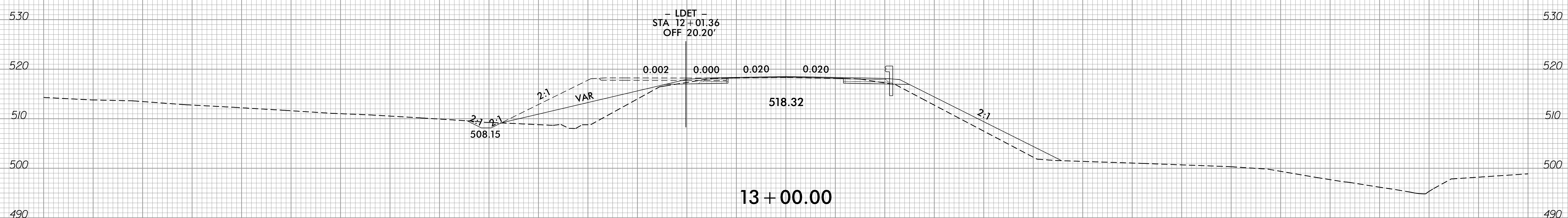
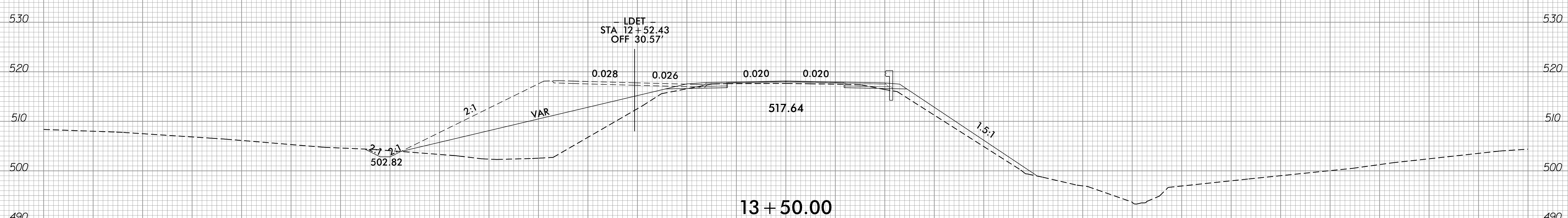
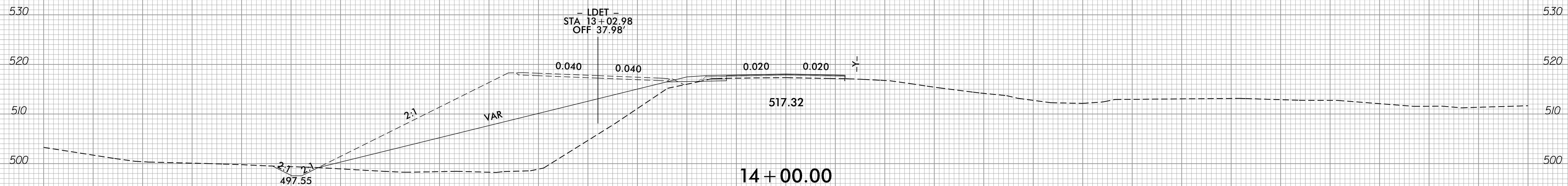

150 140 130 120 110 100 90 80 70 60 50 40 30 20 10 0 10 20 30 40 50 60 70 80 90 100 110 120 130 140 150

31-JAN-2019 11:25
B4962_Pdr_XPL_L.dgn
B4962.dgn

8/23/99

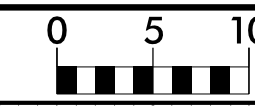

PROJ. REFERENCE NO.	SHEET NO.
B-4962	X-4

150 140 130 120 110 100 90 80 70 60 50 40 30 20 10 0 10 20 30 40 50 60 70 80 90 100 110 120 130 140 150

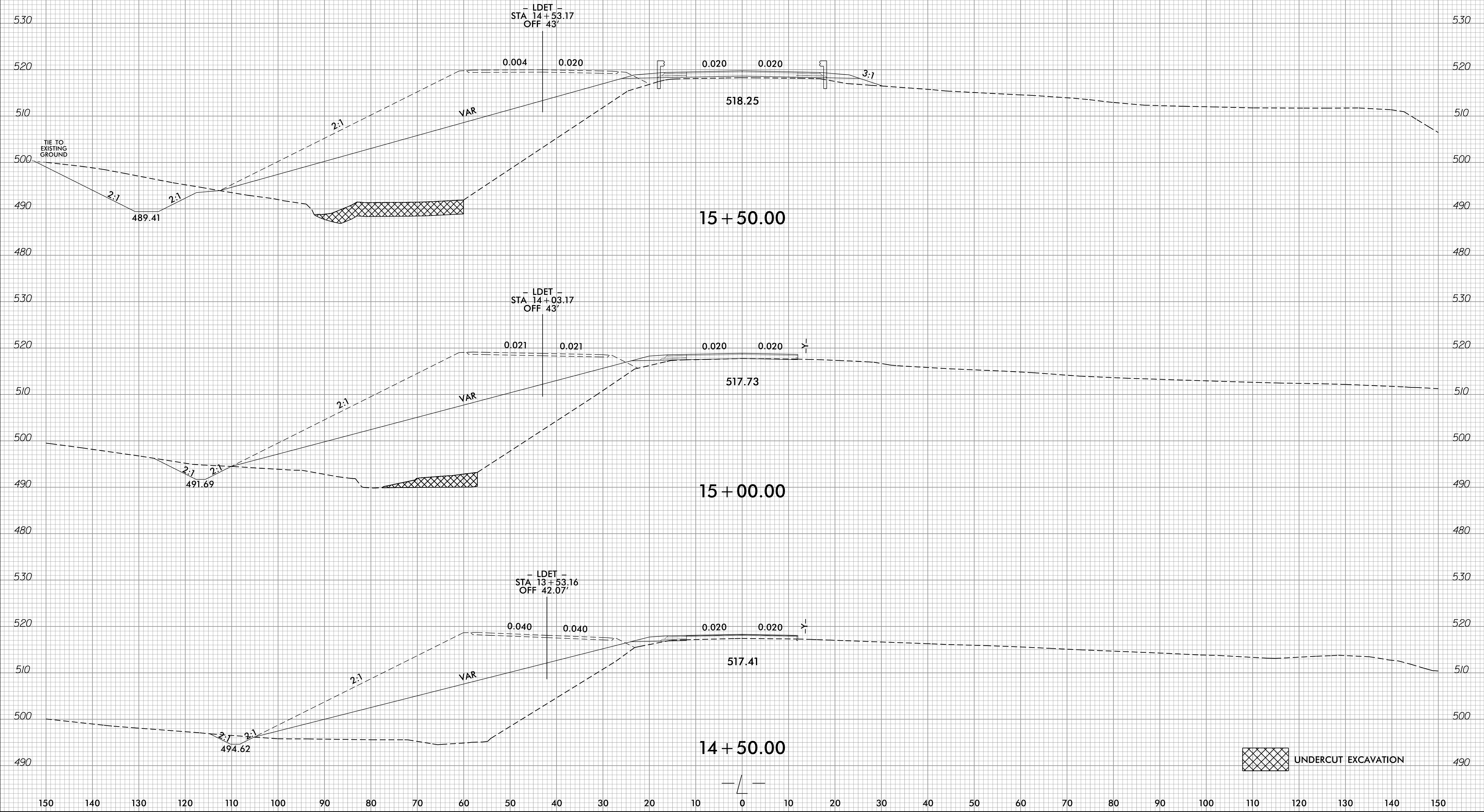

UNDERCUT EXCAVATION

31-JAN-2019 11:25
B4962_Pdrj_XPL_L.dgn
B4962.dwg

8/23/99



PROJ. REFERENCE NO.
B-4962

SHEET NO.
X-5

150 140 130 120 110 100 90 80 70 60 50 40 30 20 10 0 10 20 30 40 50 60 70 80 90 100 110 120 130 140 150

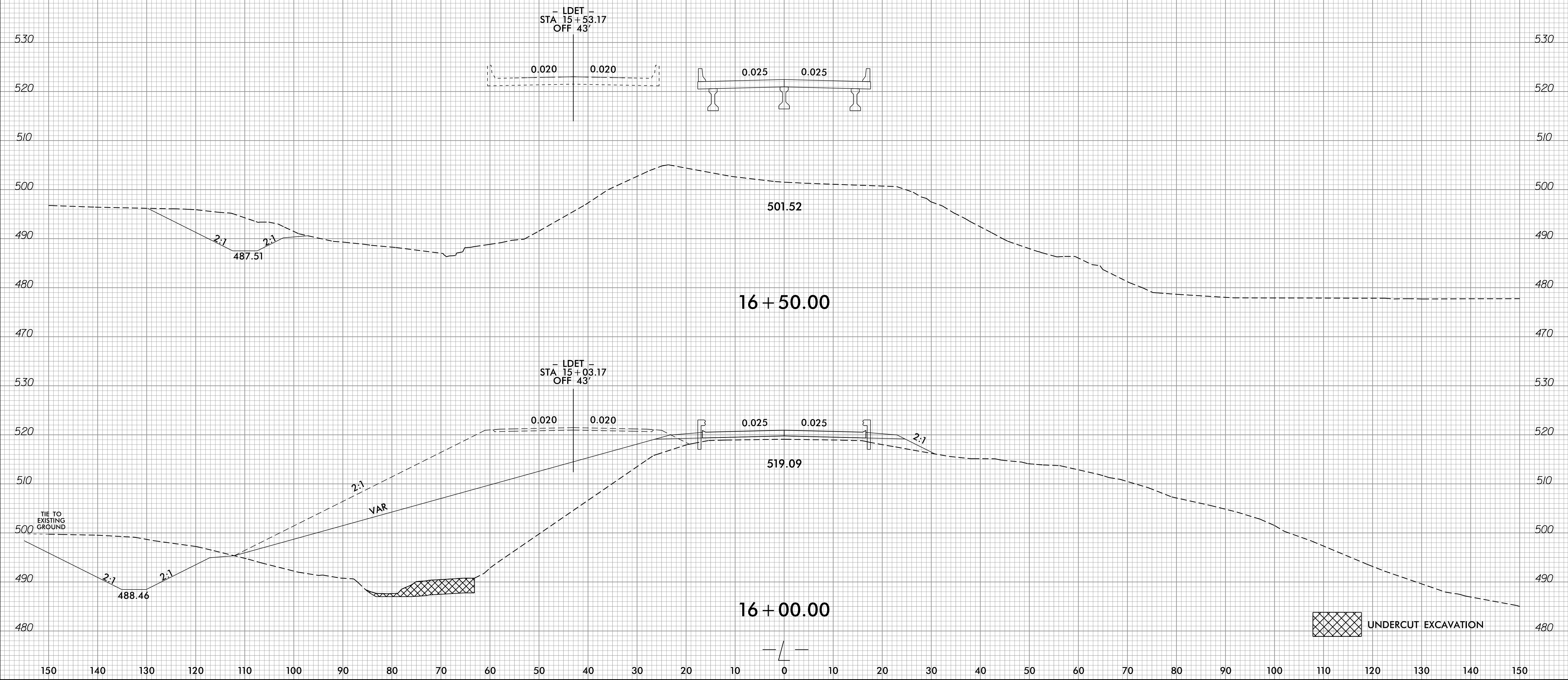

31-JAN-2019 11:25
B4962_Pdr_XPL_L.dgn
B4962.dgn

UNDERCUT EXCAVATION

8/23/99

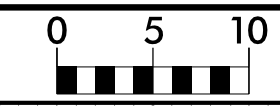

PROJ. REFERENCE NO.
B-4962

SHEET NO.
X-6

150 140 130 120 110 100 90 80 70 60 50 40 30 20 10 0 10 20 30 40 50 60 70 80 90 100 110 120 130 140 150



150 140 130 120 110 100 90 80 70 60 50 40 30 20 10 0 10 20 30 40 50 60 70 80 90 100 110 120 130 140 150

31-JAN-2019 11:25
B4962.Fdw.XPL.L.dgn
8/23/99

8/23/99



PROJ. REFERENCE NO.
B-4962

SHEET NO.
X-7

150 140 130 120 110 100 90 80 70 60 50 40 30 20 10 0 10 20 30 40 50 60 70 80 90 100 110 120 130 140 150

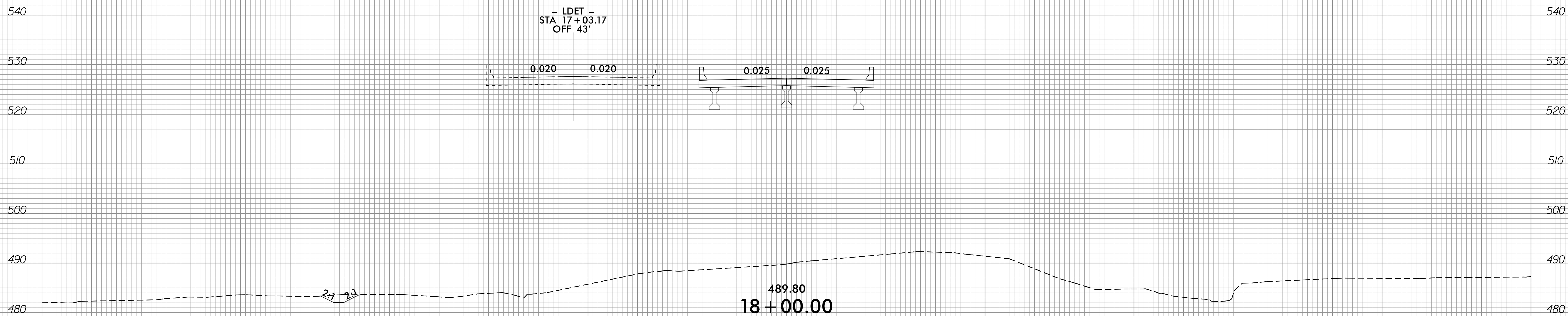

150 140 130 120 110 100 90 80 70 60 50 40 30 20 10 0 10 20 30 40 50 60 70 80 90 100 110 120 130 140 150

31-JAN-2019 11:25
B4962.Fdu_XPL.L.dgn
S:\21\04\11

8/23/99

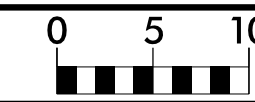

PROJ. REFERENCE NO.	SHEET NO.
B-4962	X-8

150 140 130 120 110 100 90 80 70 60 50 40 30 20 10 0 10 20 30 40 50 60 70 80 90 100 110 120 130 140 150

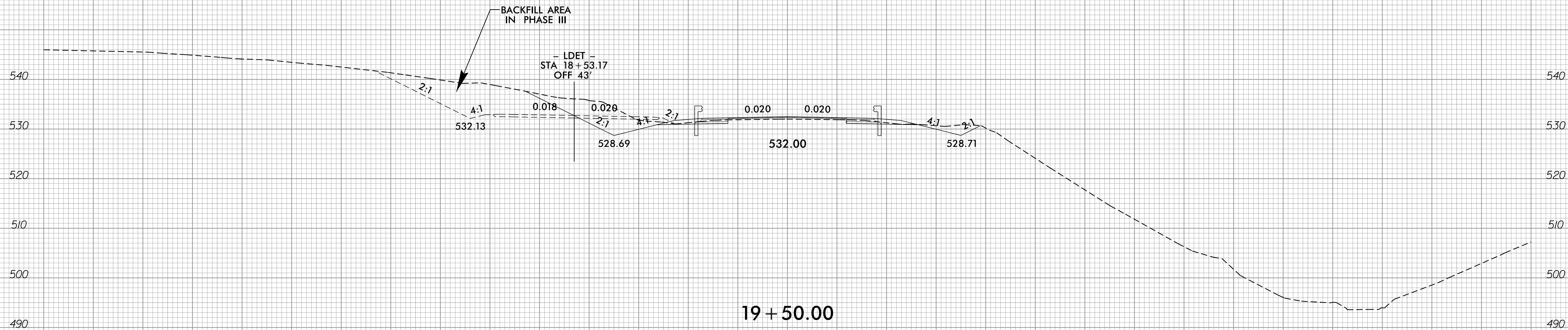

19 + 50.00

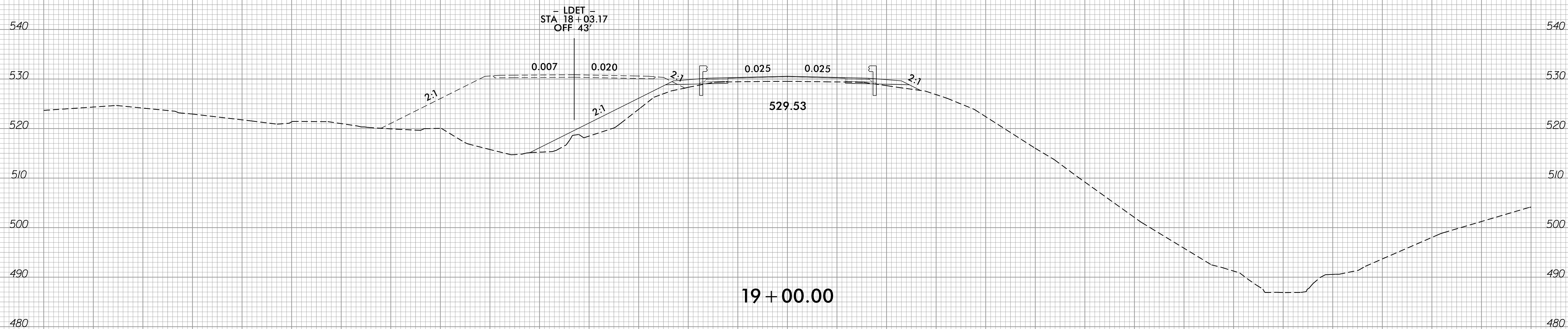

19 + 00.00

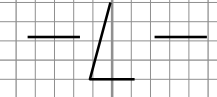

150 140 130 120 110 100 90 80 70 60 50 40 30 20 10 0 10 20 30 40 50 60 70 80 90 100 110 120 130 140 150

31-JAN-2019 11:25
B4962_Plot_XPL_L.dgn
SARAJI0111

8/23/99

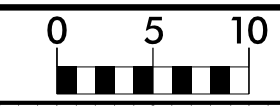

PROJ. REFERENCE NO.	SHEET NO.
B-4962	X-9

150 140 130 120 110 100 90 80 70 60 50 40 30 20 10 0 10 20 30 40 50 60 70 80 90 100 110 120 130 140 150

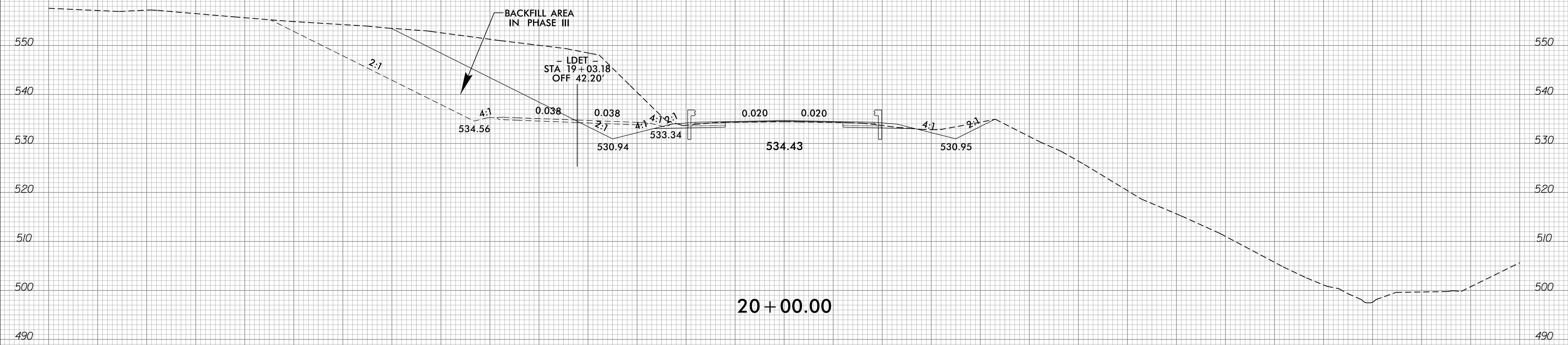
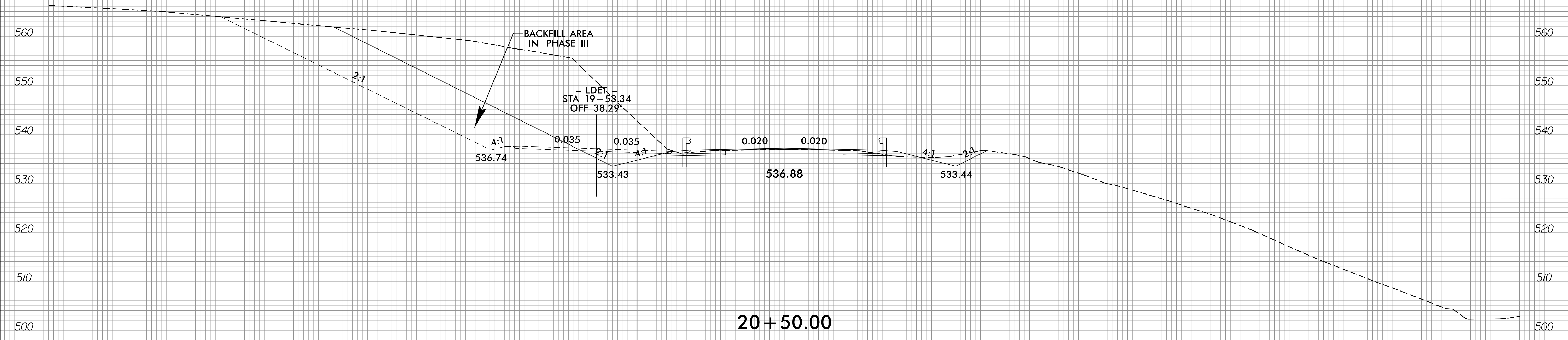

150 140 130 120 110 100 90 80 70 60 50 40 30 20 10 0 10 20 30 40 50 60 70 80 90 100 110 120 130 140 150

31-JAN-2019 11:25
B4962.Fdw.XPL.L.dgn
SARAJLOK11

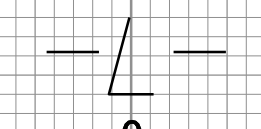

8/23/99



PROJ. REFERENCE NO.	SHEET NO.
B-4962	X-10

150 140 130 120 110 100 90 80 70 60 50 40 30 20 10 0 10 20 30 40 50 60 70 80 90 100 110 120 130 140 150

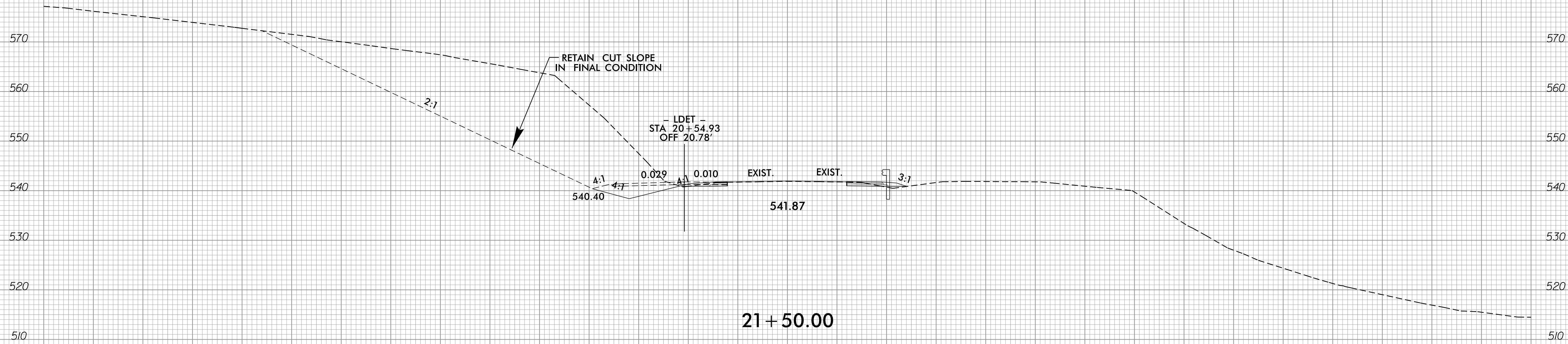

21+50.00

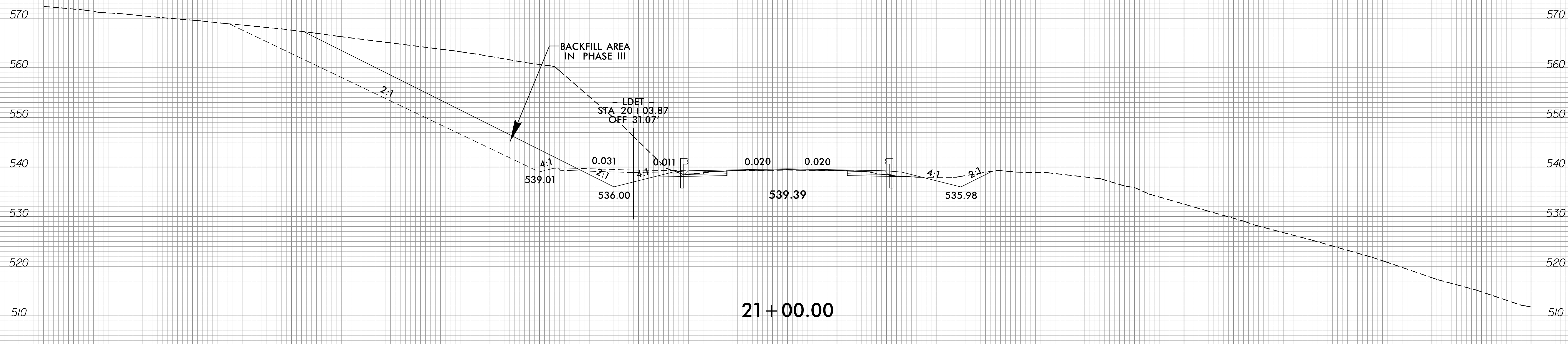

21+00.00

150 140 130 120 110 100 90 80 70 60 50 40 30 20 10 0 10 20 30 40 50 60 70 80 90 100 110 120 130 140 150

31-JAN-2019 11:25
B4962.Fdu_XPL.L.dgn
SARAJI.CWK11

8/23/99

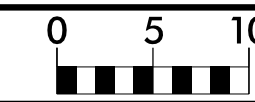

PROJ. REFERENCE NO.	SHEET NO.
B-4962	X-11

150 140 130 120 110 100 90 80 70 60 50 40 30 20 10 0 10 20 30 40 50 60 70 80 90 100 110 120 130 140 150

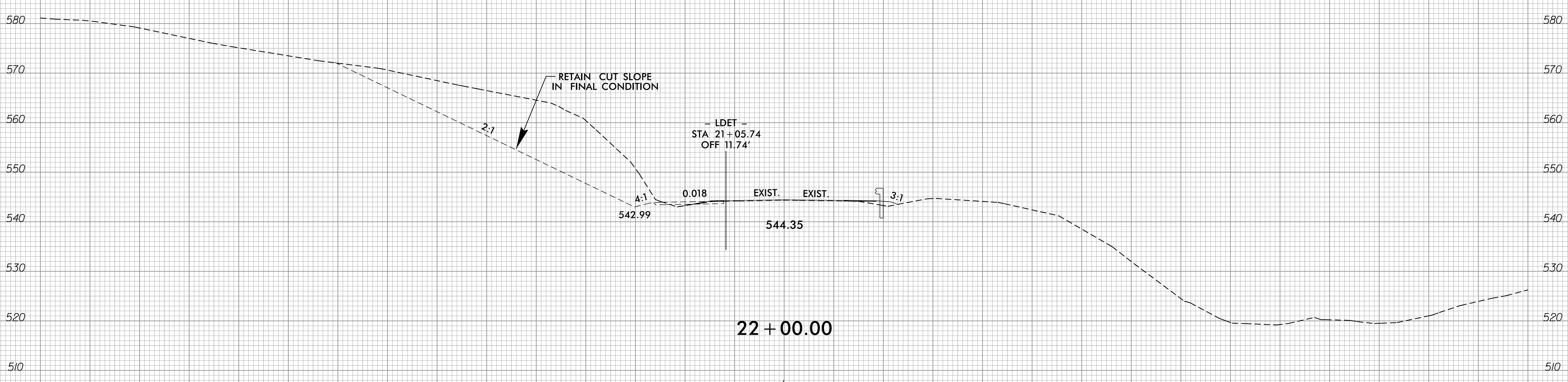
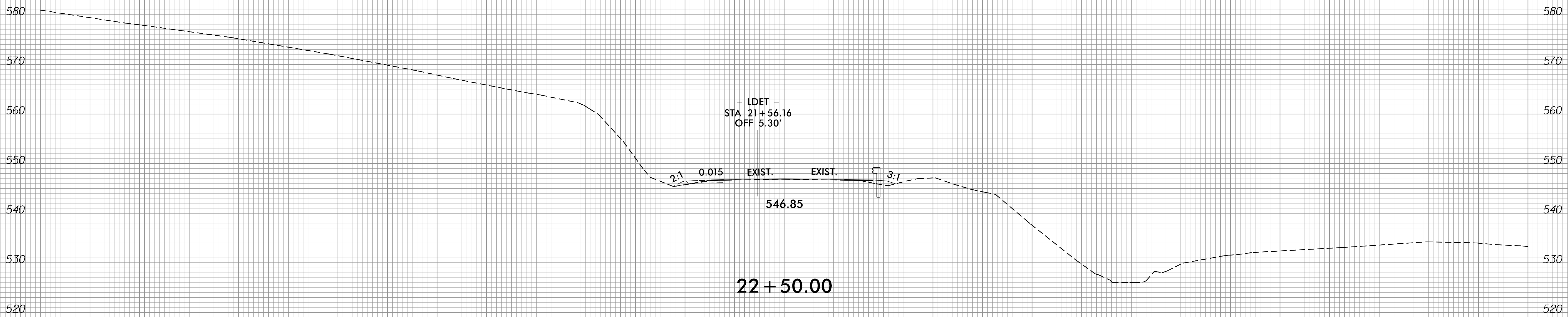

150 140 130 120 110 100 90 80 70 60 50 40 30 20 10 0 10 20 30 40 50 60 70 80 90 100 110 120 130 140 150

31-JAN-2019 11:25
B4962_Pdr_XPL_L.dgn
SARAJI

8/23/99



PROJ. REFERENCE NO.	SHEET NO.
B-4962	X-12

150 140 130 120 110 100 90 80 70 60 50 40 30 20 10 0 10 20 30 40 50 60 70 80 90 100 110 120 130 140 150

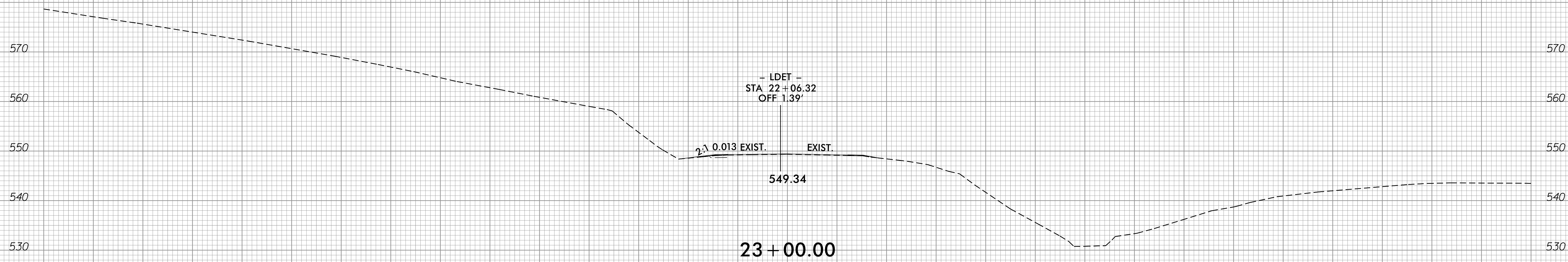
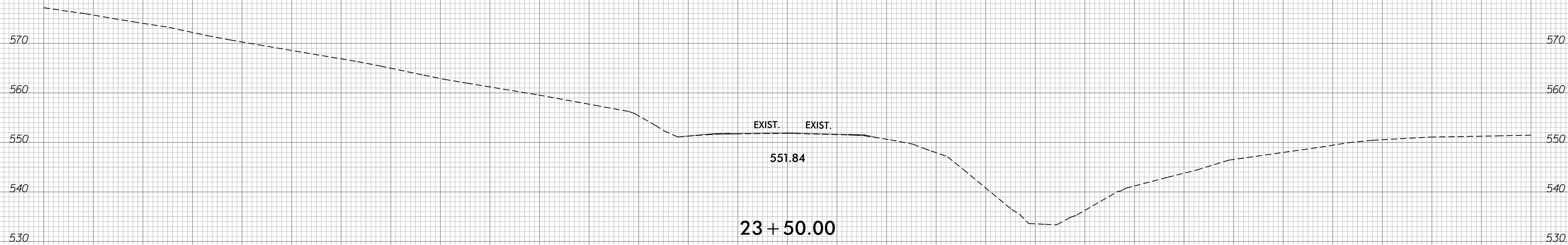
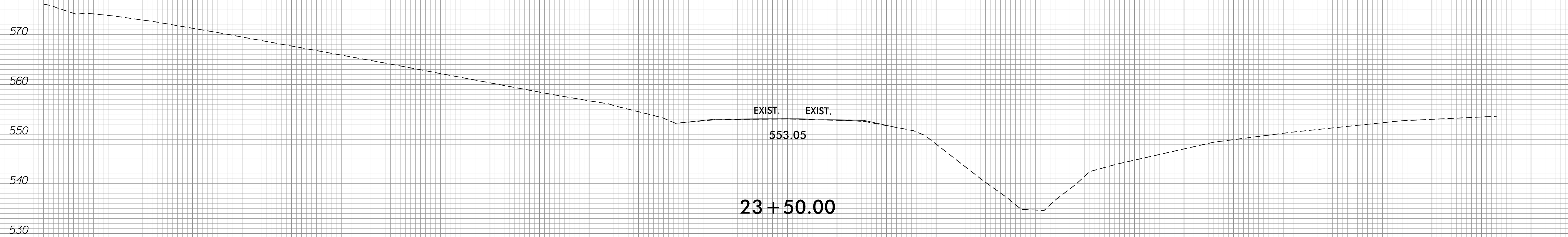

- LDET -
STA 22 + 06.32
OFF 1.39'

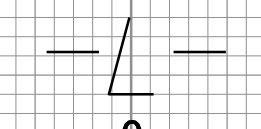

31-JAN-2019 11:25
B4962.Fdw_XPL_L.dgn
B4962.XPL

