

MATCH LINE,
SEE SHEET CR-309

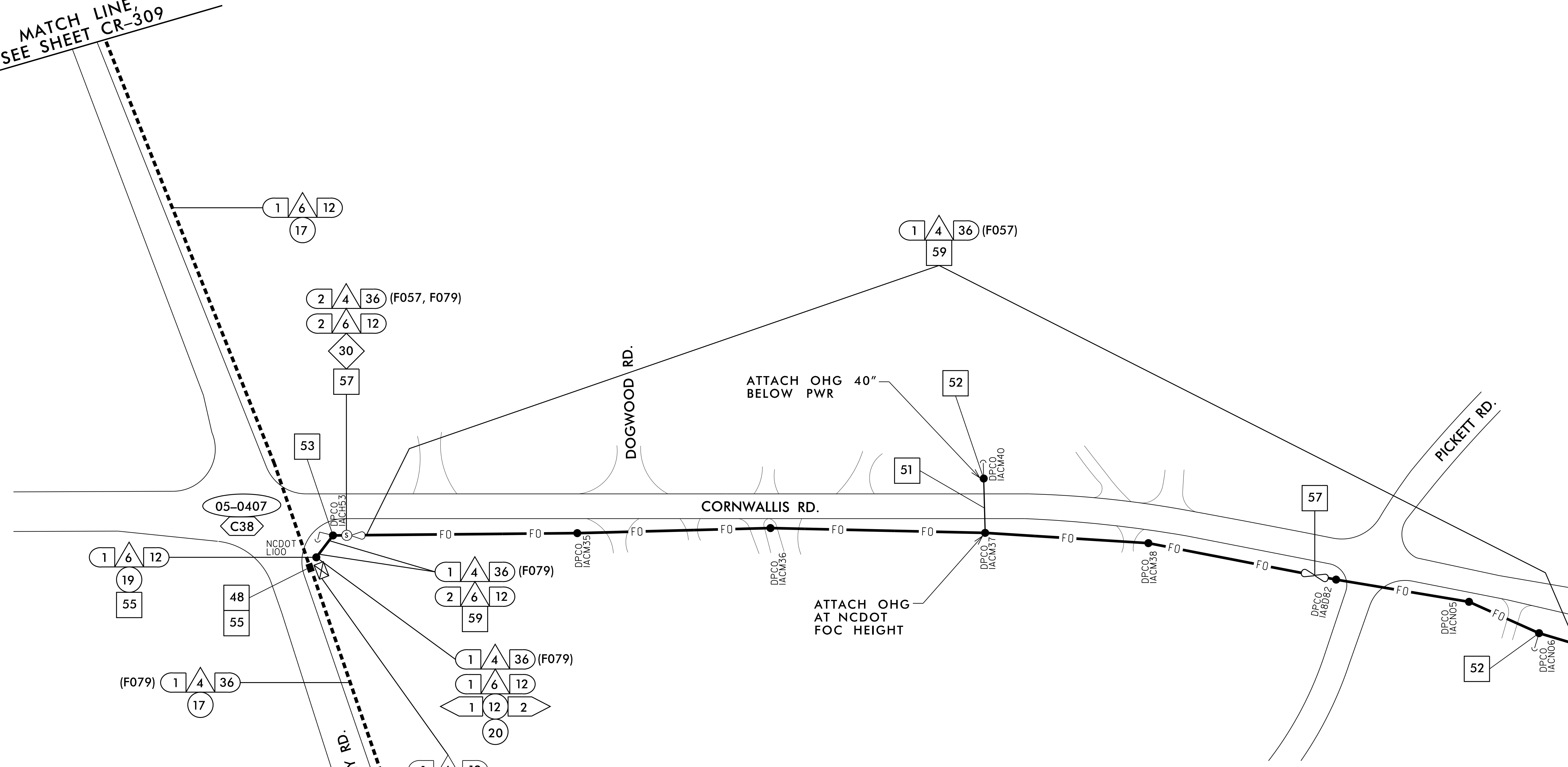

MATCH LINE, SEE SHEET CR-310

- NOTES:
1. ATTACH NEW COMMUNICATIONS CABLE TO FRONT SIDE OF POLE AT 40 INCHES BELOW POWER PRESENCE UNLESS OTHERWISE NOTED.
 2. MAINTAIN A MINIMUM OF 6 FEET FROM THE EDGE OF PAVEMENT WHEN TRENCHING PARALLEL TO THE ROADWAY UNLESS OTHERWISE NOTED.

12/14/2018 K:\ARL\TPTD\ITS\0103640 - Durham Signal System\Plans\U-5968_ITS_psh_308.dgn

MATCH LINE, SEE SHEET CR-307

Kimley»Horn
 NC License #F-0102
 421 Fayetteville St., Suite 600
 Raleigh, NC 27636
 Tel: (919) 677-2000
 Fax: (919) 677-2050

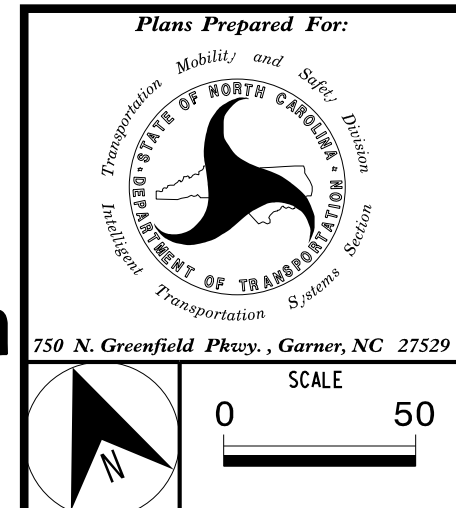

CITY OF DURHAM COMPUTERIZED SIGNAL SYSTEM COMMUNICATIONS CABLE AND CONDUIT ROUTING PLAN	
DIVISION 05	DURHAM COUNTY
PLAN DATE: DEC 2018	REVIEWED BY: I. VAN OSDELL
PREPARED BY: KHA	REVIEWED BY: K. SMITH
REVISIONS	INIT. DATE

SEAL

DocuSigned by:
 KEVIN W. SMITH
 12/18/2018
 DATE

CADD Filename:

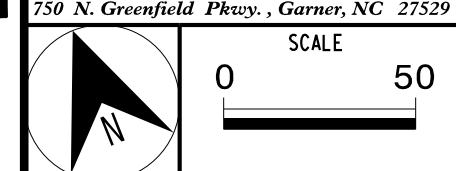

MATCH LINE, SEE SHEET CR-308

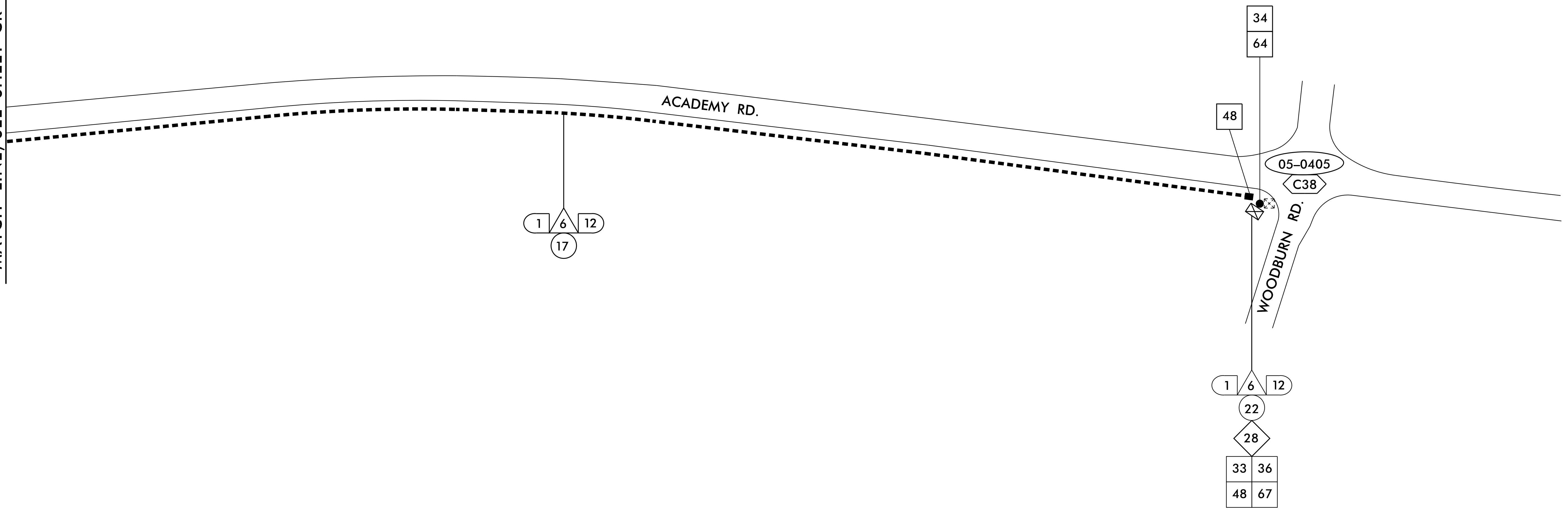

- NOTES:**
1. ATTACH NEW COMMUNICATIONS CABLE TO FRONT SIDE OF POLE AT 40 INCHES BELOW POWER PRESENCE UNLESS OTHERWISE NOTED.
 2. MAINTAIN A MINIMUM OF 6 FEET FROM THE EDGE OF PAVEMENT WHEN TRENCHING PARALLEL TO THE ROADWAY UNLESS OTHERWISE NOTED.

12/14/2018 K:\ARL_TPTD_ITS\0103640 - Durham Signal System\Plans\U-5968_ITS_psh_309.dgn

Kimley»Horn
 NC License #F-0102
 421 Fayetteville St., Suite 600
 Raleigh, NC 27636
 Tel: (919) 677-2000
 Fax: (919) 677-2050

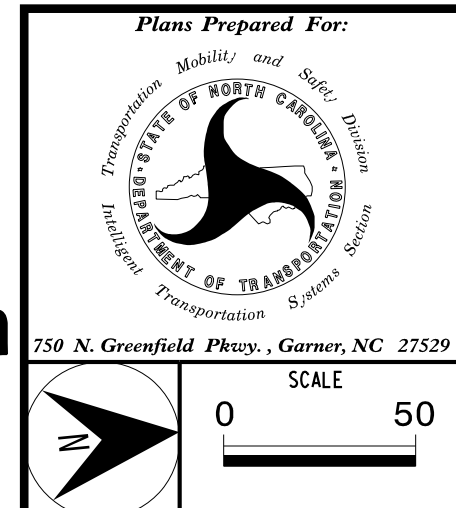

CITY OF DURHAM COMPUTERIZED SIGNAL SYSTEM COMMUNICATIONS CABLE AND CONDUIT ROUTING PLAN	
DIVISION 05	DURHAM COUNTY
PLAN DATE: DEC 2018	REVIEWED BY: I. VAN OSDELL
PREPARED BY: KHA	REVIEWED BY: K. SMITH
REVISIONS	INIT. DATE

SEAL

DocuSigned by:
 Kevin W. Smith
 12/18/2018
 DATE

CADD Filename:

NOTES:

1. ATTACH NEW COMMUNICATIONS CABLE TO FRONT SIDE OF POLE AT 40 INCHES BELOW POWER PRESENCE UNLESS OTHERWISE NOTED.
2. MAINTAIN A MINIMUM OF 6 FEET FROM THE EDGE OF PAVEMENT WHEN TRENCHING PARALLEL TO THE ROADWAY UNLESS OTHERWISE NOTED.
3. INSTALL CCTV ON EXISTING METAL STRAIN POLE, 12" FROM TOP. SEE ITS-22.
4. THIS AREA HAS BEEN DETERMINED TO CONTAIN PROPERTIES WITH DOCUMENTED HISTORIC SIGNIFICANCE. IF IT IS NECESSARY TO DEVIATE FROM THESE PLANS IN THIS AREA, PLEASE ALERT THE ENGINEER TO CONTACT PROJECT DEVELOPMENT AND ENVIRONMENTAL ANALYSIS BRANCH - HISTORIC ARCHITECTURE GROUP OF THE NORTH CAROLINA DEPARTMENT OF TRANSPORTATION FOR AN EFFECT DETERMINATION BEFORE PROCEEDING.

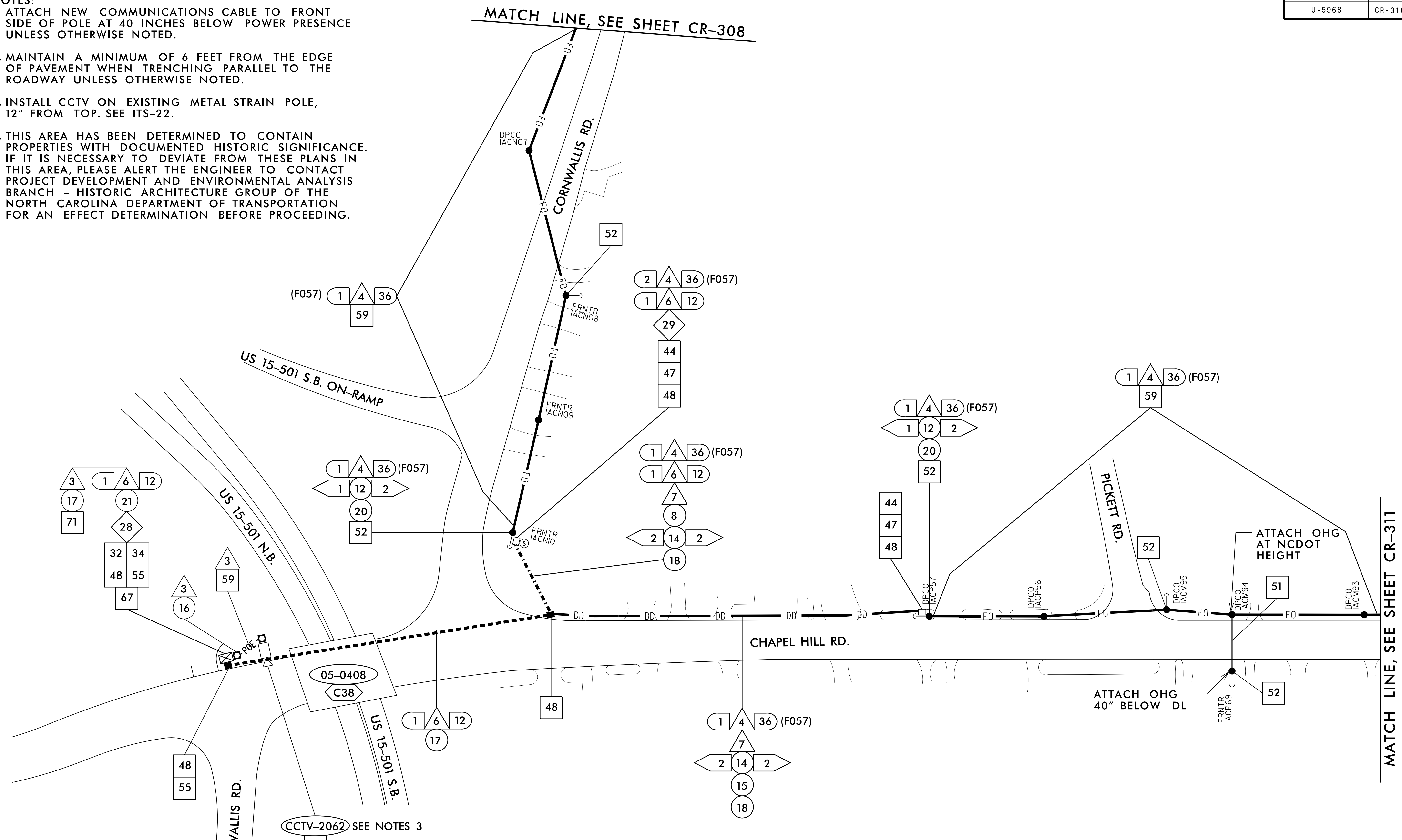

12/14/2018 K:\ARL_TPTD_ITS\0103640 - Durham Signal System\Plans\U-5968_ITS_psh_310.dgn

Kimley»Horn
 NC License #F-0102
 421 Fayetteville St., Suite 600
 Raleigh, NC 27636
 Tel: (919) 677-2000
 Fax: (919) 677-2050

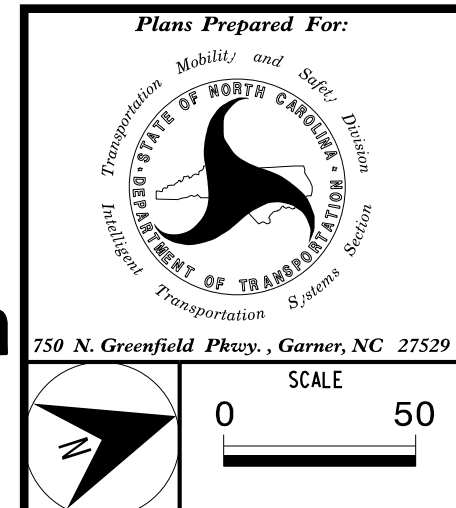

CITY OF DURHAM COMPUTERIZED SIGNAL SYSTEM COMMUNICATIONS CABLE AND CONDUIT ROUTING PLAN

DIVISION 05		DURHAM COUNTY	
PLAN DATE: DEC 2018	REVIEWED BY: I. VAN OSDELL		
PREPARED BY: KHA	REVIEWED BY: K. SMITH		
REVISIONS	INIT.	DATE	

SEAL

NORTH CAROLINA PROFESSIONAL ENGINEER
 SEAL 030472
 KEVIN W. SMITH

DocuSigned by:
 Kevin W. Smith
 12/18/2018

CADD Filename:

MATCH LINE, SEE SHEET CR-311

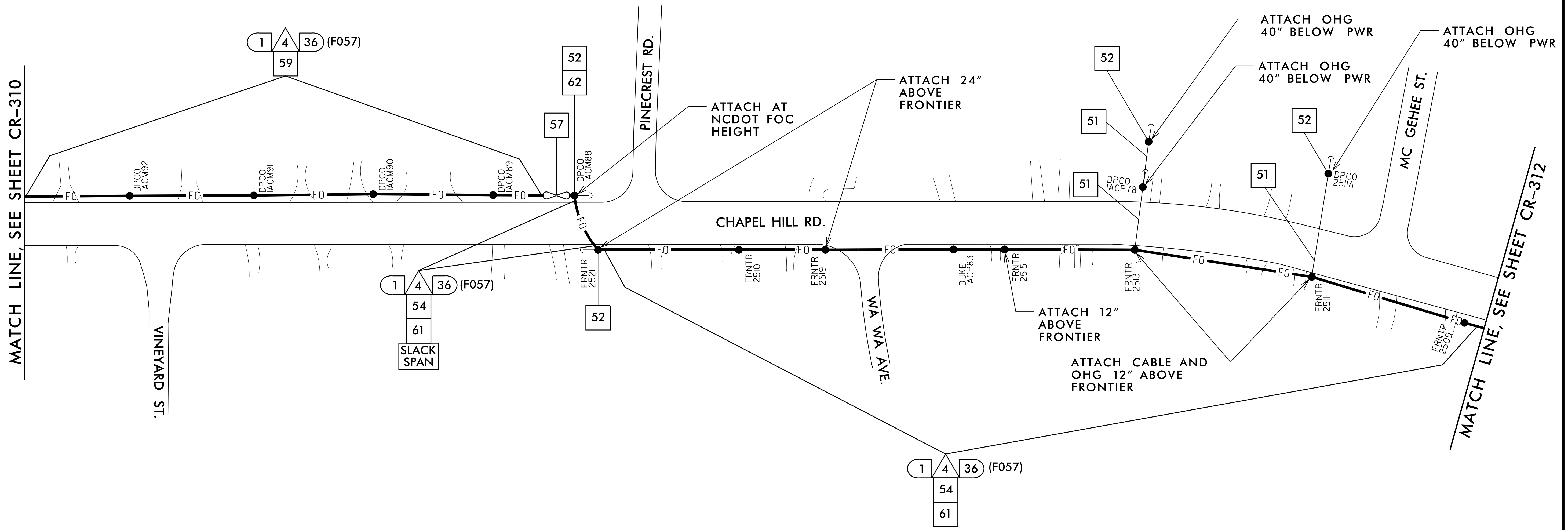

MATCH LINE, SEE SHEET CR-310

MATCH LINE, SEE SHEET CR-312

- NOTES:**
1. ATTACH NEW COMMUNICATIONS CABLE TO FRONT SIDE OF POLE AT 40 INCHES BELOW POWER PRESENCE UNLESS OTHERWISE NOTED.
 2. MAINTAIN A MINIMUM OF 6 FEET FROM THE EDGE OF PAVEMENT WHEN TRENCHING PARALLEL TO THE ROADWAY UNLESS OTHERWISE NOTED.

	CITY OF DURHAM COMPUTERIZED SIGNAL SYSTEM		
	COMMUNICATIONS CABLE AND CONDUIT ROUTING PLAN		
DIVISION 05	DURHAM COUNTY		SEAL 030472 KEVIN W. SMITH ENGINEER
PLAN DATE: DEC 2018	REVIEWED BY: I. VAN OSDELL		
PREPARED BY: KHA	REVIEWED BY: K. SMITH		DocuSigned by: DATE: 12/18/2018
REVISIONS	INIT.	DATE	

Kimley»Horn
 NC License #F-0102
 421 Fayetteville St., Suite 600
 Raleigh, NC 27636
 Tel: (919) 677-2000
 Fax: (919) 677-2050

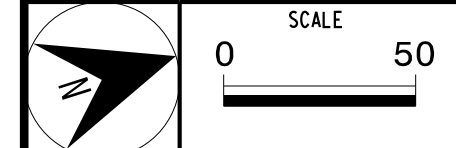

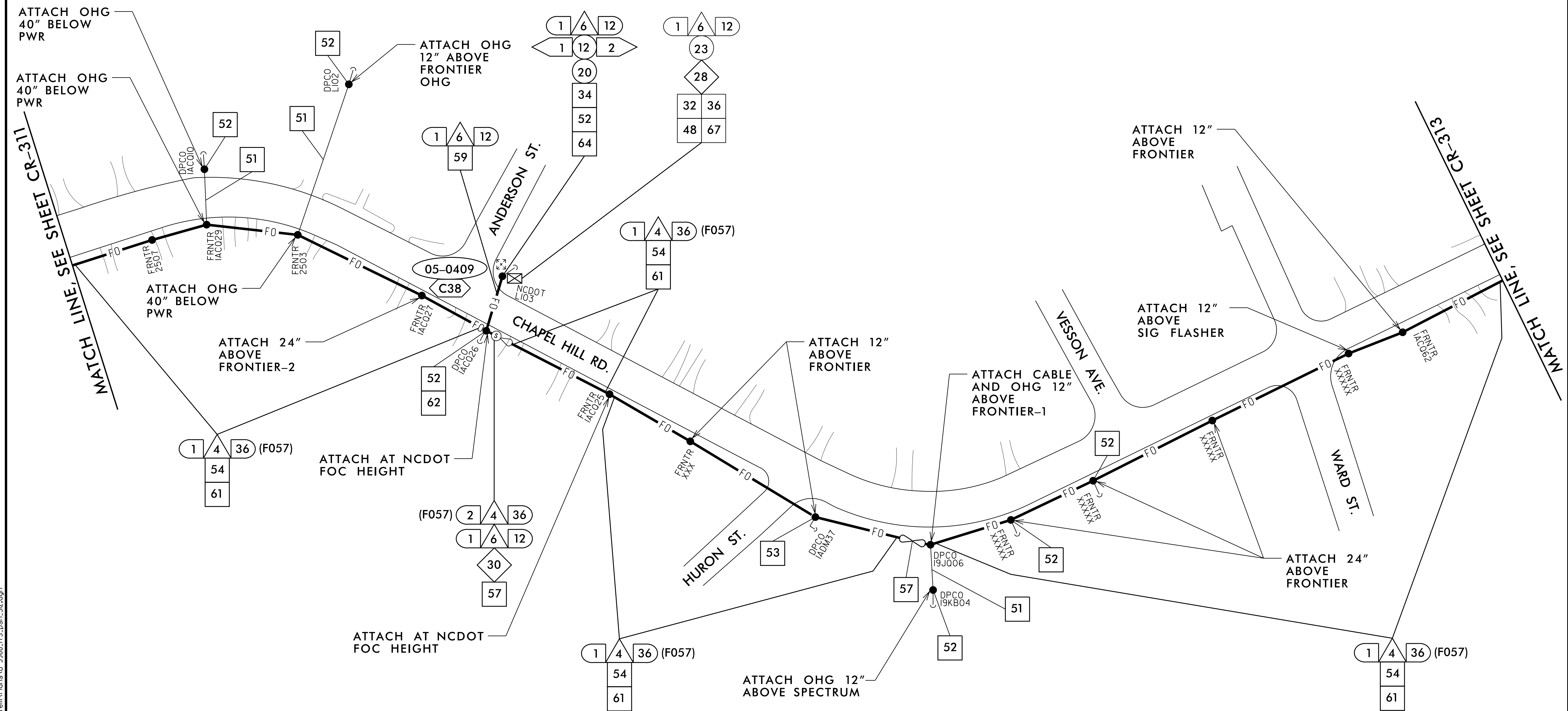

- NOTES:**
1. ATTACH NEW COMMUNICATIONS CABLE TO FRONT SIDE OF POLE AT 40 INCHES BELOW POWER PRESENCE UNLESS OTHERWISE NOTED.
 2. MAINTAIN A MINIMUM OF 6 FEET FROM THE EDGE OF PAVEMENT WHEN TRENCHING PARALLEL TO THE ROADWAY UNLESS OTHERWISE NOTED.

12/14/2018 K:\ARL_TPTD_LITS\01036410 - Durham - Signal System\Plans\U-5968_LITS_psh_312.dgn

Kimley»Horn
 NC License #F-0102
 421 Fayetteville St., Suite 600
 Raleigh, NC 27636
 Tel: (919) 677-2000
 Fax: (919) 677-2050

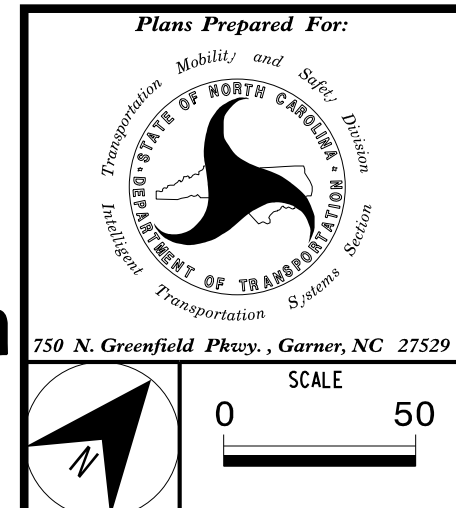

CITY OF DURHAM COMPUTERIZED SIGNAL SYSTEM COMMUNICATIONS CABLE AND CONDUIT ROUTING PLAN	
DIVISION 05	DURHAM COUNTY
PLAN DATE: DEC 2018	REVIEWED BY: I. VAN OSDELL
PREPARED BY: KHA	REVIEWED BY: K. SMITH
REVISIONS	INIT. DATE

SEAL

DocuSigned by:
 Kevin W. Smith
 12/18/2018
 DATE

CADD Filename:

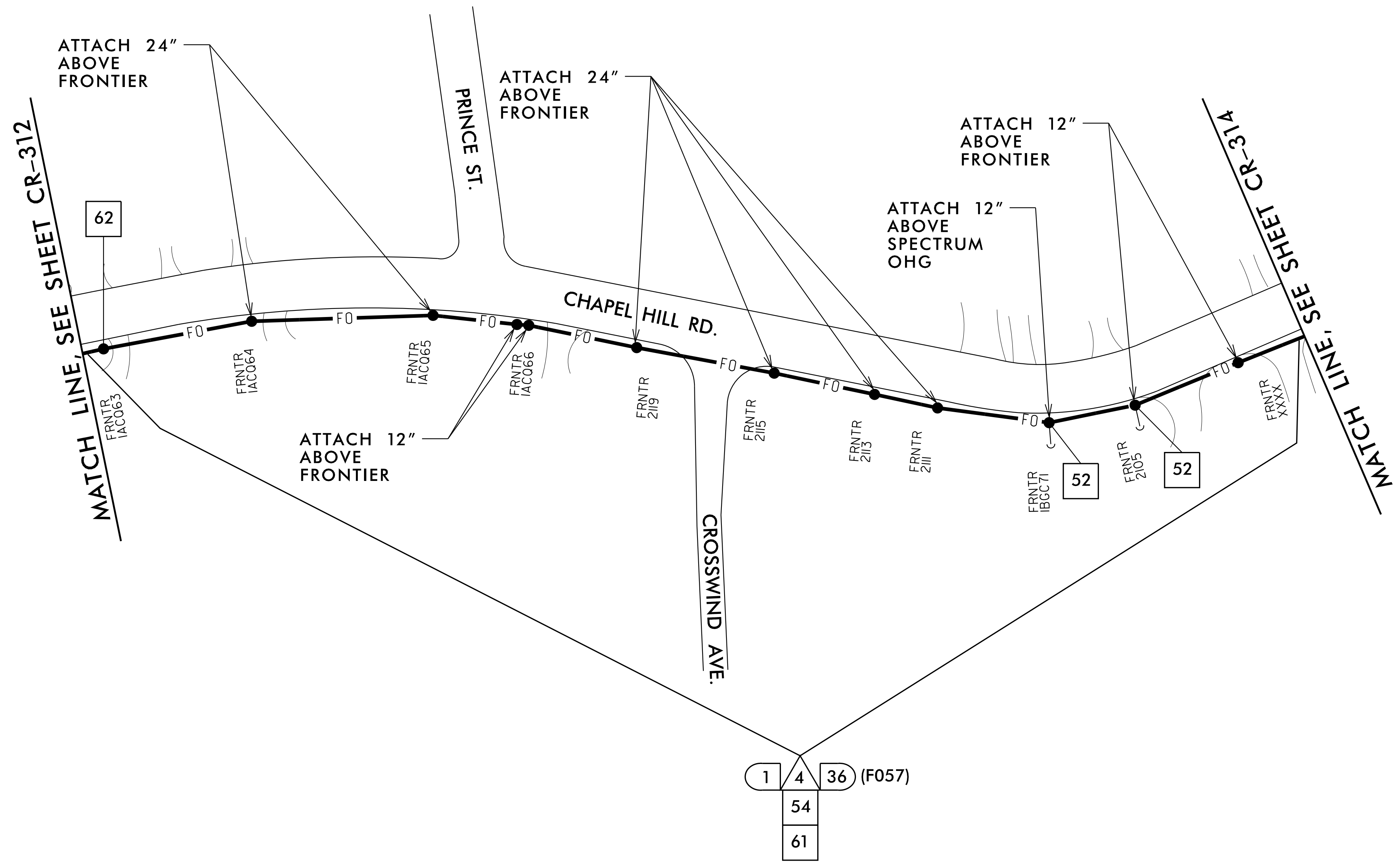

- NOTES:
1. ATTACH NEW COMMUNICATIONS CABLE TO FRONT SIDE OF POLE AT 40 INCHES BELOW POWER PRESENCE UNLESS OTHERWISE NOTED.
 2. MAINTAIN A MINIMUM OF 6 FEET FROM THE EDGE OF PAVEMENT WHEN TRENCHING PARALLEL TO THE ROADWAY UNLESS OTHERWISE NOTED.
 3. THIS AREA HAS BEEN DETERMINED TO CONTAIN PROPERTIES WITH DOCUMENTED HISTORIC SIGNIFICANCE. IF IT IS NECESSARY TO DEVIATE FROM THESE PLANS IN THIS AREA, PLEASE ALERT THE ENGINEER TO CONTACT PROJECT DEVELOPMENT AND ENVIRONMENTAL ANALYSIS BRANCH - HISTORIC ARCHITECTURE GROUP OF THE NORTH CAROLINA DEPARTMENT OF TRANSPORTATION FOR AN EFFECT DETERMINATION BEFORE PROCEEDING.

12/14/2018 K:\ARL_TPTD_ITS\01036410 - Durham Signal System\Plans\U-5968_ITS_psh_313.dgn

Kimley»Horn
 NC License #F-0102
 421 Fayetteville St., Suite 600
 Raleigh, NC 27636
 Tel: (919) 677-2000
 Fax: (919) 677-2050

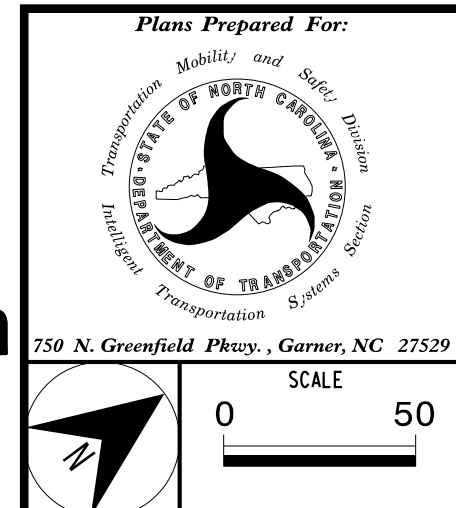

CITY OF DURHAM COMPUTERIZED SIGNAL SYSTEM COMMUNICATIONS CABLE AND CONDUIT ROUTING PLAN	
DIVISION 05	DURHAM COUNTY
PLAN DATE: DEC 2018	REVIEWED BY: I. VAN OSDELL
PREPARED BY: KHA	REVIEWED BY: K. SMITH
REVISIONS	INIT. DATE

SEAL
NORTH CAROLINA PROFESSIONAL ENGINEER KEVIN W. SMITH
SEAL 030472
DocuSigned by: Kevin W. Smith
12/18/2018
CADD Filename:

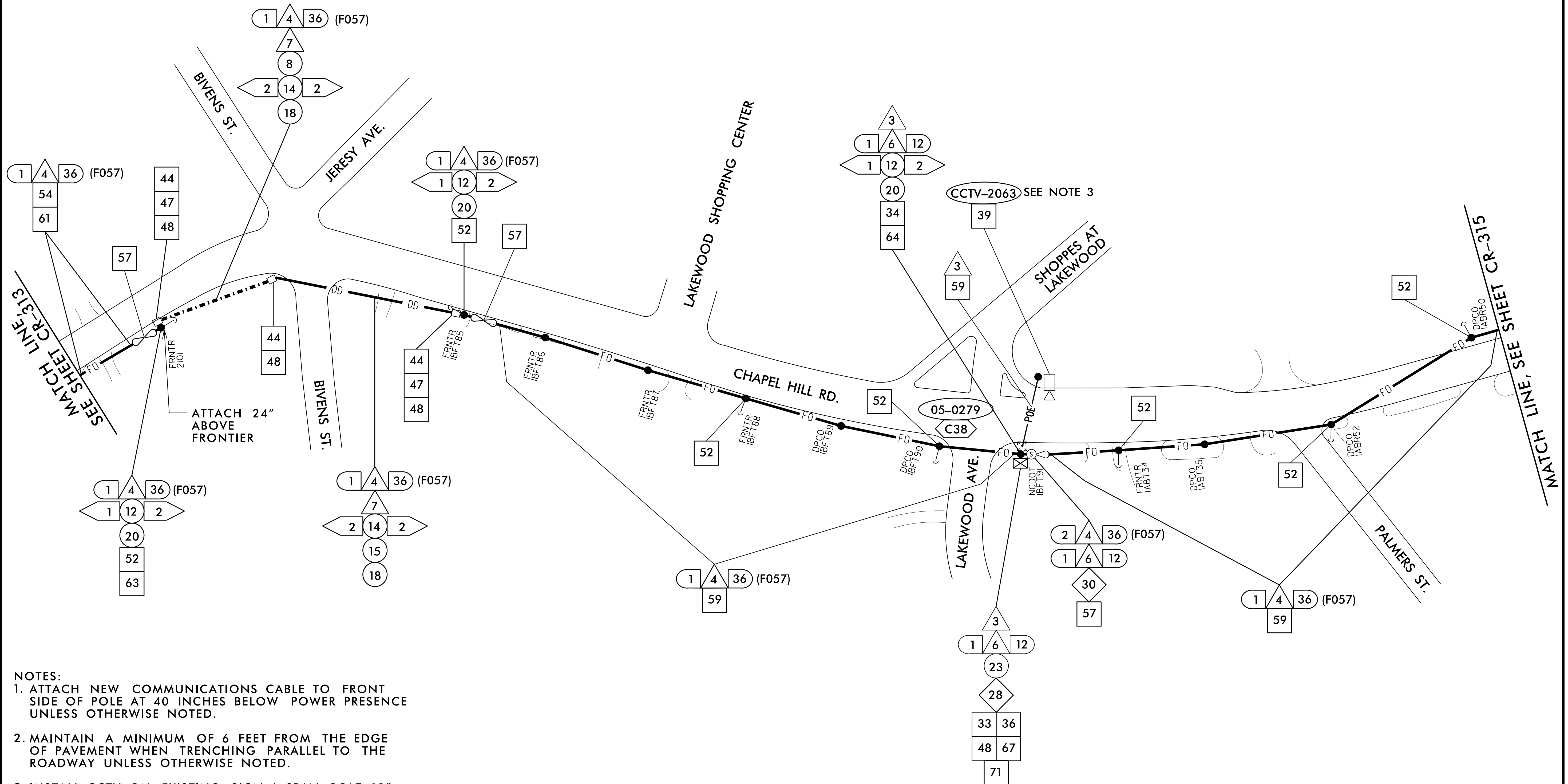

NOTES:

1. ATTACH NEW COMMUNICATIONS CABLE TO FRONT SIDE OF POLE AT 40 INCHES BELOW POWER PRESENCE UNLESS OTHERWISE NOTED.
2. MAINTAIN A MINIMUM OF 6 FEET FROM THE EDGE OF PAVEMENT WHEN TRENCHING PARALLEL TO THE ROADWAY UNLESS OTHERWISE NOTED.
3. INSTALL CCTV ON EXISTING SIGNAL SPAN POLE, 12" FROM TOP. SEE ITS-21.
4. THIS AREA HAS BEEN DETERMINED TO CONTAIN PROPERTIES WITH DOCUMENTED HISTORIC SIGNIFICANCE. IF IT IS NECESSARY TO DEVIATE FROM THESE PLANS IN THIS AREA, PLEASE ALERT THE ENGINEER TO CONTACT PROJECT DEVELOPMENT AND ENVIRONMENTAL ANALYSIS BRANCH - HISTORIC ARCHITECTURE GROUP OF THE NORTH CAROLINA DEPARTMENT OF TRANSPORTATION FOR AN EFFECT DETERMINATION BEFORE PROCEEDING.

12/14/2018 K:\ARL_TPTD\ITS\0103640 - Durham Signal System\Plans\U-5968_ITS_psh_314.dgn

Kimley»Horn
 NC License #F-0102
 421 Fayetteville St., Suite 600
 Raleigh, NC 27636
 Tel: (919) 677-2000
 Fax: (919) 677-2050

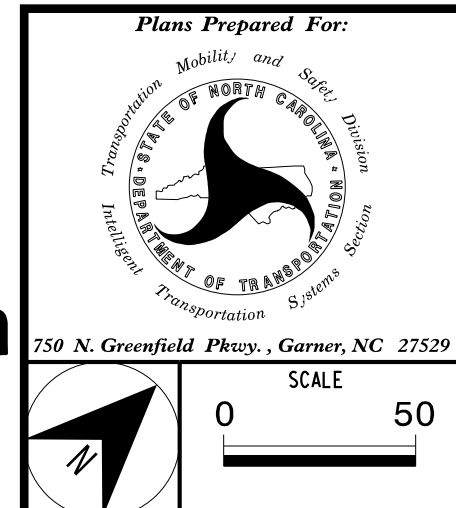

CITY OF DURHAM COMPUTERIZED SIGNAL SYSTEM COMMUNICATIONS CABLE AND CONDUIT ROUTING PLAN	
DIVISION 05	DURHAM COUNTY
PLAN DATE: DEC 2018	REVIEWED BY: I. VAN OSDELL
PREPARED BY: KHA	REVIEWED BY: K. SMITH
REVISIONS	INIT. DATE

SEAL
 NORTH CAROLINA PROFESSIONAL ENGINEER
 KEVIN W. SMITH
 SEAL 030472
 12/18/2018
 CADD Filename: