

- NOTES:
1. ATTACH NEW COMMUNICATIONS CABLE TO FRONT SIDE OF POLE AT 40 INCHES BELOW POWER PRESENCE UNLESS OTHERWISE NOTED.
 2. MAINTAIN A MINIMUM OF 6 FEET FROM THE EDGE OF PAVEMENT WHEN TRENCHING PARALLEL TO THE ROADWAY UNLESS OTHERWISE NOTED.
 3. THIS AREA HAS BEEN DETERMINED TO CONTAIN PROPERTIES WITH DOCUMENTED HISTORIC SIGNIFICANCE. IF IT IS NECESSARY TO DEVIATE FROM THESE PLANS IN THIS AREA, PLEASE ALERT THE ENGINEER TO CONTACT PROJECT DEVELOPMENT AND ENVIRONMENTAL ANALYSIS BRANCH - HISTORIC ARCHITECTURE GROUP OF THE NORTH CAROLINA DEPARTMENT OF TRANSPORTATION FOR AN EFFECT DETERMINATION BEFORE PROCEEDING.

12/14/2018 K:\RAL_TPTD_ITS\0103640 - Durham Signal System\Plans\U-5968_ITS_psh_368.dgn

Kimley»Horn
 NC License #F-0102
 421 Fayetteville St., Suite 600
 Raleigh, NC 27636
 Tel: (919) 677-2000
 Fax: (919) 677-2050

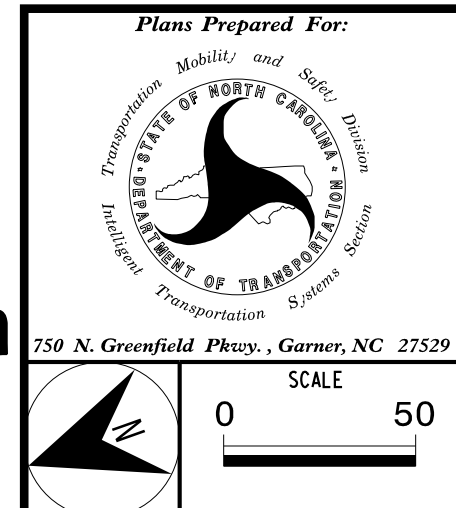

| | |
|--|----------------------------|
| CITY OF DURHAM COMPUTERIZED SIGNAL SYSTEM COMMUNICATIONS CABLE AND CONDUIT ROUTING PLAN | |
| DIVISION 05 | DURHAM COUNTY |
| PLAN DATE: DEC 2018 | REVIEWED BY: I. VAN OSDELL |
| PREPARED BY: KHA | REVIEWED BY: K. SMITH |
| REVISIONS | INIT. DATE |
| | |
| | |
| | |

SEAL
 NORTH CAROLINA PROFESSIONAL ENGINEER
 SEAL 030472
 KEVIN W. SMITH
 KEVIN W. SMITH
 12/18/2018
 DATE
 CADD Filename:

MATCH LINE, SEE SHEET CR-407

MATCH LINE, SEE SHEET CR-368

MATCH LINE, SEE SHEET CR-370

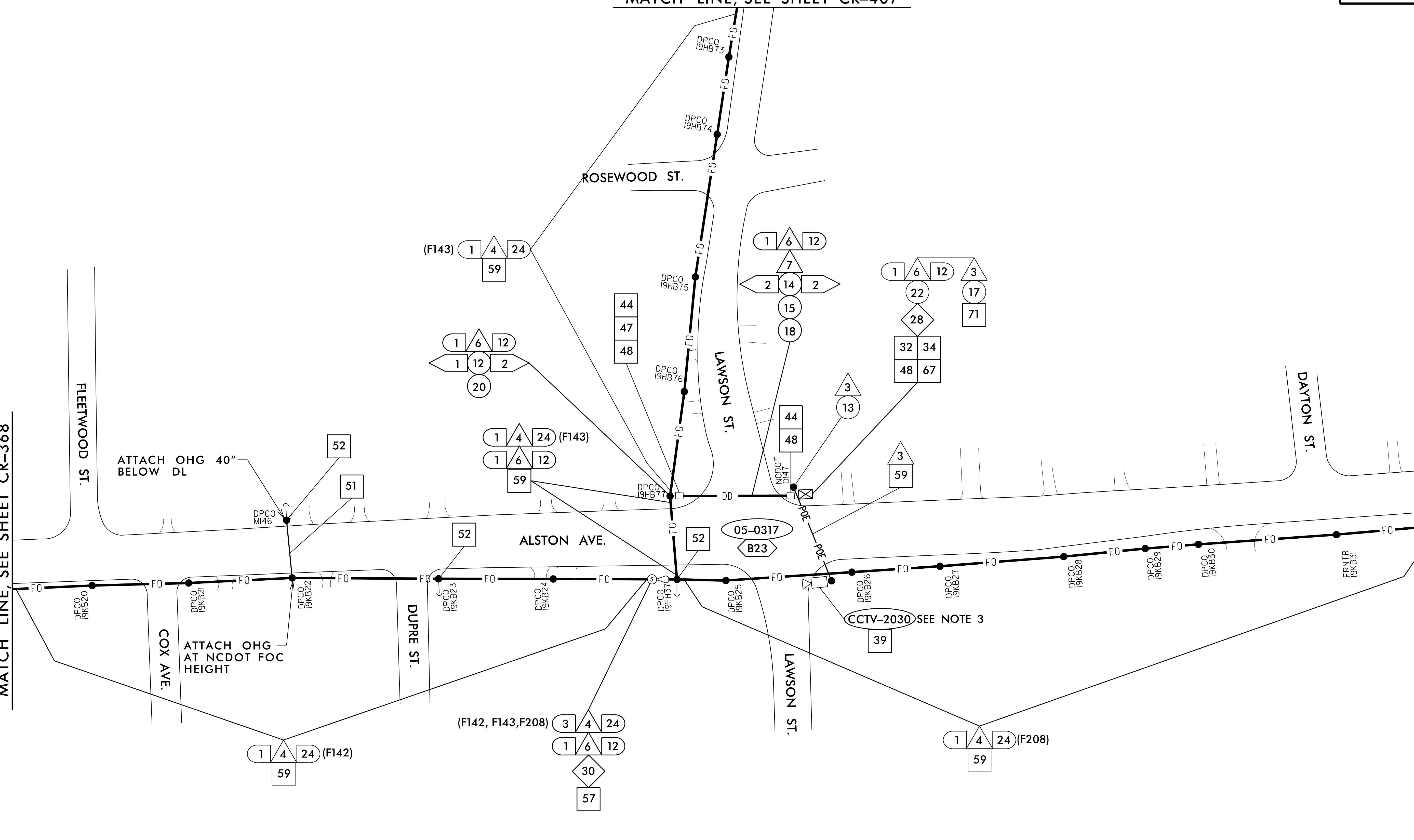

- NOTES:
1. ATTACH NEW COMMUNICATIONS CABLE TO FRONT SIDE OF POLE AT 40 INCHES BELOW POWER PRESENCE UNLESS OTHERWISE NOTED.
 2. MAINTAIN A MINIMUM OF 6 FEET FROM THE EDGE OF PAVEMENT WHEN TRENCHING PARALLEL TO THE ROADWAY UNLESS OTHERWISE NOTED.
 3. INSTALL CCTV ON EXISTING WOOD SIGNAL SPAN POLE, 12" FROM TOP. SEE ITS-21.

12/14/2018 K:\ARL_TPTD\ITS\0103640 - Durham Signal System\Plans\U-5968_ITS_psh_369.dgn

Kimley»Horn
 NC License #F-0102
 421 Fayetteville St., Suite 600
 Raleigh, NC 27636
 Tel: (919) 677-2000
 Fax: (919) 677-2050

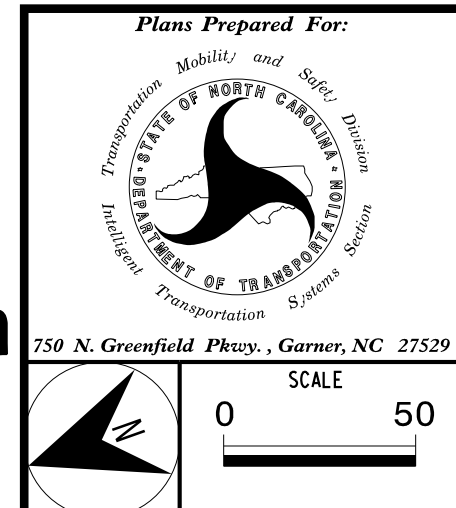

| | |
|---|----------------------------|
| CITY OF DURHAM COMPUTERIZED SIGNAL SYSTEM COMMUNICATIONS CABLE AND CONDUIT ROUTING PLAN | |
| DIVISION 05 | DURHAM COUNTY |
| PLAN DATE: DEC 2018 | REVIEWED BY: I. VAN OSDELL |
| PREPARED BY: KHA | REVIEWED BY: K. SMITH |
| REVISIONS | INIT. DATE |
| | |
| | |
| | |

SEAL

DocuSigned by:
 Kevin W. Smith
 12/18/2018
 DATE

CADD Filename:

| | | |
|-------|---|----|
| SCALE | 0 | 50 |
| | | |

MATCH LINE, SEE SHEET CR-369

MATCH LINE, SEE SHEET CR-371

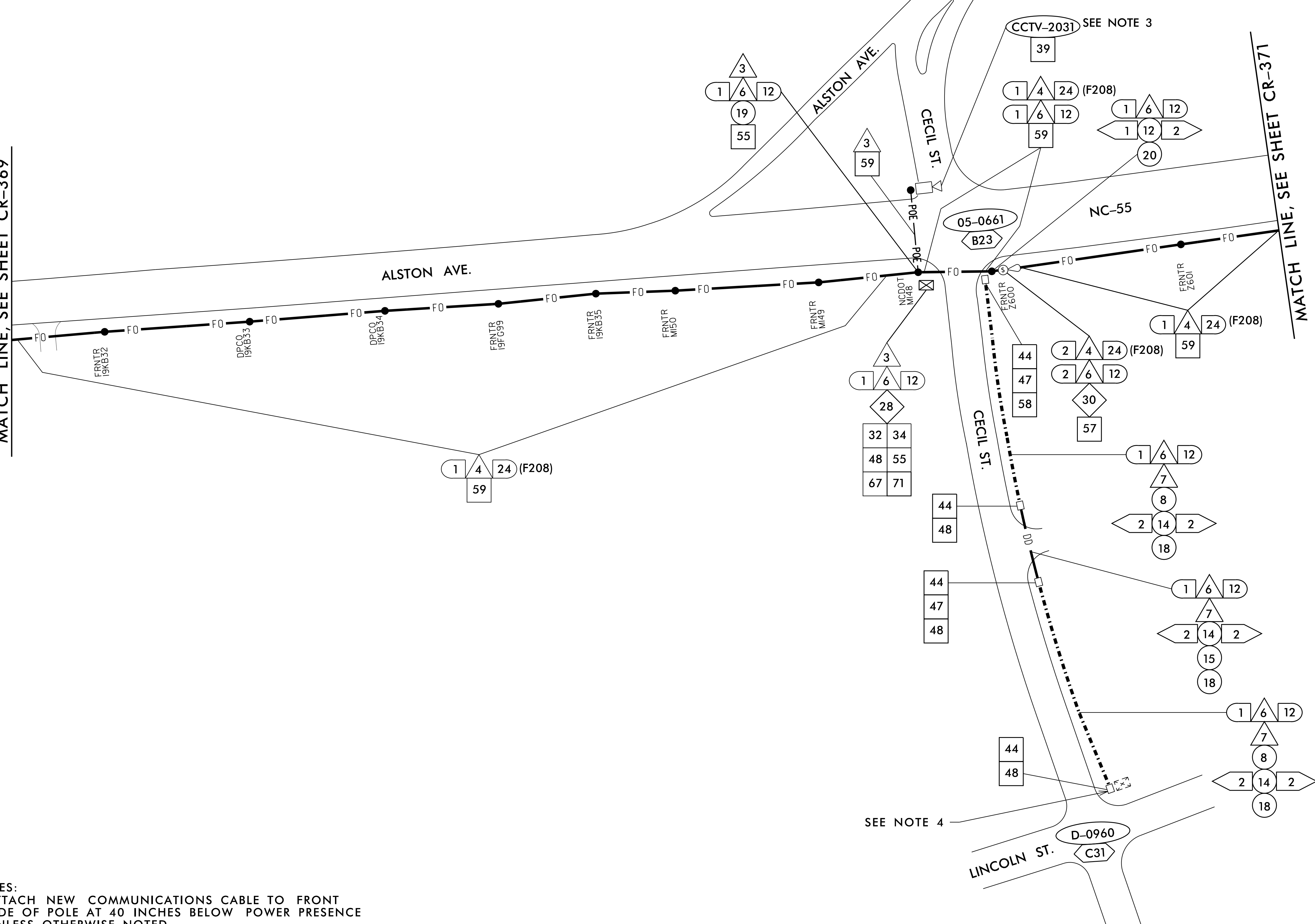

- NOTES:**
1. ATTACH NEW COMMUNICATIONS CABLE TO FRONT SIDE OF POLE AT 40 INCHES BELOW POWER PRESENCE UNLESS OTHERWISE NOTED.
 2. MAINTAIN A MINIMUM OF 6 FEET FROM THE EDGE OF PAVEMENT WHEN TRENCHING PARALLEL TO THE ROADWAY UNLESS OTHERWISE NOTED.
 3. INSTALL CCTV ON EXISTING WOOD SIGNAL SPAN POLE, 12" FROM TOP. SEE ITS-21.
 4. CAP AND SEAL END OF 12 SMFO CABLE AND COIL IN THIS JUNCTION BOX. DO NOT TERMINATE CABLE IN CABINET.

12/14/2018 K:\ARL\TPTD\ITS\01036410 - Durham Signal System\Plans\U-5968_ITS_psh_370.dgn

Kimley»Horn
 NC License #F-0102
 421 Fayetteville St., Suite 600
 Raleigh, NC 27636
 Tel: (919) 677-2000
 Fax: (919) 677-2050

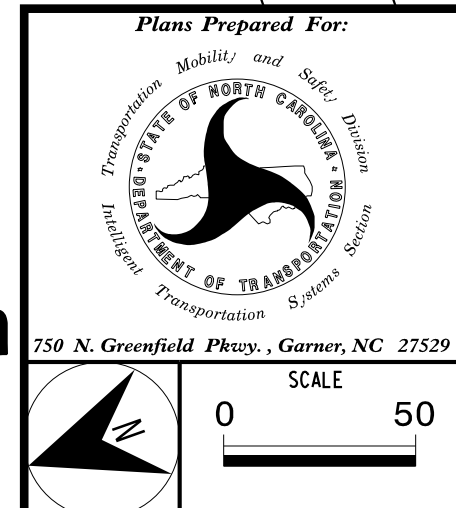

| | |
|---|----------------------------|
| CITY OF DURHAM COMPUTERIZED SIGNAL SYSTEM | |
| COMMUNICATIONS CABLE AND CONDUIT ROUTING PLAN | |
| DIVISION 05 | DURHAM COUNTY |
| PLAN DATE: DEC 2018 | REVIEWED BY: I. VAN OSDELL |
| PREPARED BY: KHA | REVIEWED BY: K. SMITH |
| REVISIONS | INIT. DATE |
| | |
| | |
| | |

SEAL

DocuSigned by:
 Kevin W. Smith
 12/18/2018
 DATE

CADD Filename:

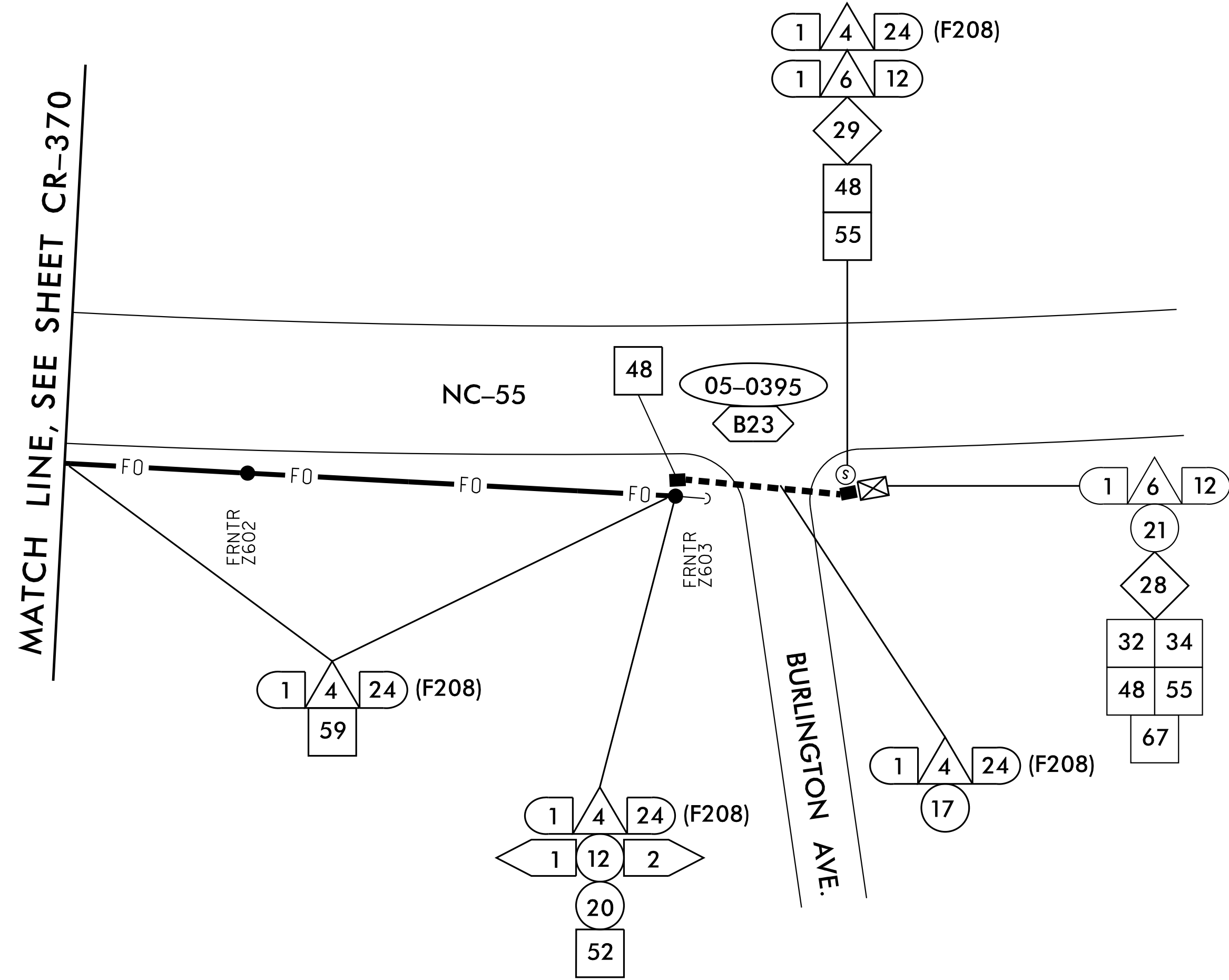

NOTES:

1. ATTACH NEW COMMUNICATIONS CABLE TO FRONT SIDE OF POLE AT 40 INCHES BELOW POWER PRESENCE UNLESS OTHERWISE NOTED.
2. MAINTAIN A MINIMUM OF 6 FEET FROM THE EDGE OF PAVEMENT WHEN TRENCHING PARALLEL TO THE ROADWAY UNLESS OTHERWISE NOTED.

| | | | |
|---------------------|--|------|------------------------------|
| | CITY OF DURHAM COMPUTERIZED SIGNAL SYSTEM COMMUNICATIONS CABLE AND CONDUIT ROUTING PLAN | | |
| | DIVISION 05 DURHAM COUNTY | | |
| PLAN DATE: DEC 2018 | REVIEWED BY: I. VAN OSDELL | | DocuSigned by: 12/18/2018 |
| PREPARED BY: KHA | REVIEWED BY: K. SMITH | | |
| REVISIONS | INIT. | DATE | SEAL |
| | | | |
| | | | |
| | | | |

Kimley»Horn
 NC License #F-0102
 421 Fayetteville St., Suite 600
 Raleigh, NC 27636
 Tel: (919) 677-2000
 Fax: (919) 677-2050

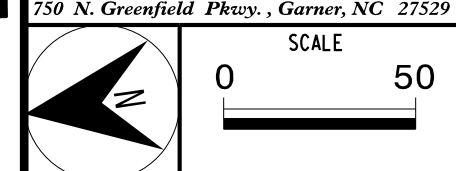

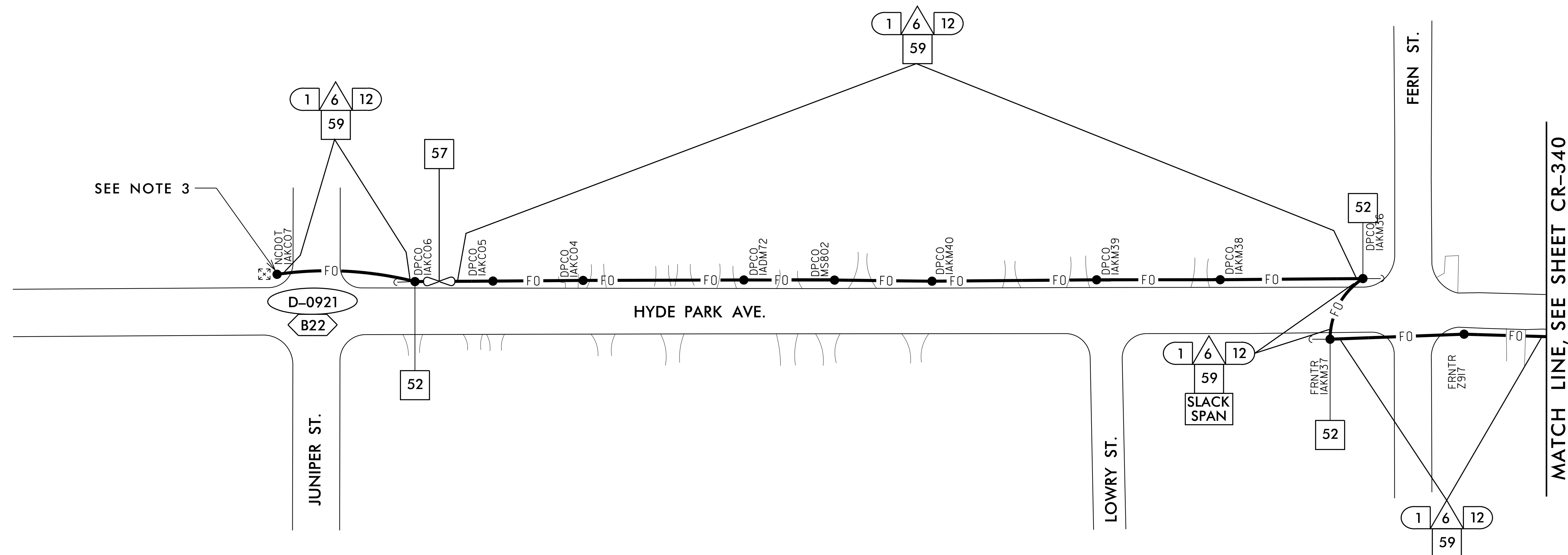

SEE NOTE 3

- NOTES:**
1. ATTACH NEW COMMUNICATIONS CABLE TO FRONT SIDE OF POLE AT 40 INCHES BELOW POWER PRESENCE UNLESS OTHERWISE NOTED.
 2. MAINTAIN A MINIMUM OF 6 FEET FROM THE EDGE OF PAVEMENT WHEN TRENCHING PARALLEL TO THE ROADWAY UNLESS OTHERWISE NOTED.
 3. CAP AND SEAL END OF CABLE AND COIL AT THIS POLE FOR FUTURE USE BY OTHERS. DO NOT TERMINATE CABLE IN CABINET.

12/14/2018 K:\ARL_TPTD\ITS\0103640 - Durham Signal System\Plans\U-5968_ITS_psh_372.dgn

Kimley»Horn
 NC License #F-0102
 421 Fayetteville St., Suite 600
 Raleigh, NC 27636
 Tel: (919) 677-2000
 Fax: (919) 677-2050

| | CITY OF DURHAM COMPUTERIZED SIGNAL SYSTEM COMMUNICATIONS CABLE AND CONDUIT ROUTING PLAN | | | | | | | | |
|-----------|---|--|-----------|-------|------|--|--|--|--|
| | DIVISION 05 DURHAM COUNTY PLAN DATE: DEC 2018 REVIEWED BY: I. VAN OSDELL PREPARED BY: KHA REVIEWED BY: K. SMITH | | | | | | | | |
| | SCALE 0 50 | <table border="1"> <thead> <tr> <th>REVISIONS</th> <th>INIT.</th> <th>DATE</th> </tr> </thead> <tbody> <tr> <td> </td> <td> </td> <td> </td> </tr> </tbody> </table> | REVISIONS | INIT. | DATE | | | | SEAL NORTH CAROLINA PROFESSIONAL ENGINEER KEVIN W. SMITH 12/18/2018 DATE |
| REVISIONS | INIT. | DATE | | | | | | | |
| | | | | | | | | | |

MATCH LINE, SEE SHEET CR-340

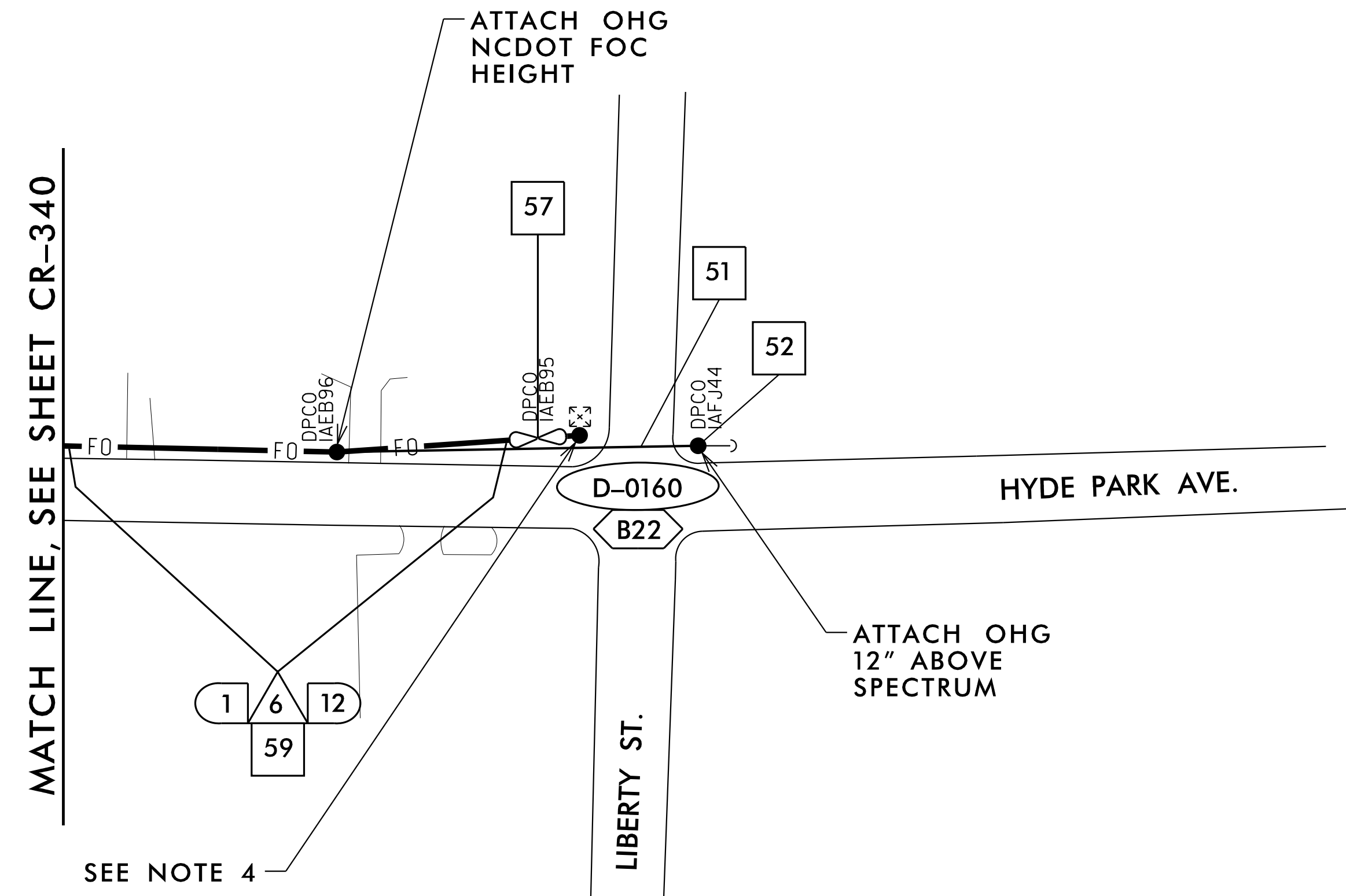

NOTES:

1. ATTACH NEW COMMUNICATIONS CABLE TO FRONT SIDE OF POLE AT 40 INCHES BELOW POWER PRESENCE UNLESS OTHERWISE NOTED.
2. MAINTAIN A MINIMUM OF 6 FEET FROM THE EDGE OF PAVEMENT WHEN TRENCHING PARALLEL TO THE ROADWAY UNLESS OTHERWISE NOTED.
3. THIS AREA HAS BEEN DETERMINED TO CONTAIN PROPERTIES WITH DOCUMENTED HISTORIC SIGNIFICANCE. IF IT IS NECESSARY TO DEVIATE FROM THESE PLANS IN THIS AREA, PLEASE ALERT THE ENGINEER TO CONTACT PROJECT DEVELOPMENT AND ENVIRONMENTAL ANALYSIS BRANCH – HISTORIC ARCHITECTURE GROUP OF THE NORTH CAROLINA DEPARTMENT OF TRANSPORTATION FOR AN EFFECT DETERMINATION BEFORE PROCEEDING.
4. CAP AND SEAL END OF CABLE AND COIL AT THIS POLE FOR FUTURE USE BY OTHERS. DO NOT TERMINATE CABLE IN CABINET.

12/14/2018 K:\ARL\TPTD\ITS\01036410 - Durham Signal System\Plans\U-5968_ITS_psh_373.dgn

Kimley»Horn
 NC License #F-0102
 421 Fayetteville St., Suite 600
 Raleigh, NC 27636
 Tel: (919) 677-2000
 Fax: (919) 677-2050



| | |
|---|----------------------------|
| CITY OF DURHAM COMPUTERIZED SIGNAL SYSTEM COMMUNICATIONS CABLE AND CONDUIT ROUTING PLAN | |
| DIVISION 05 | DURHAM COUNTY |
| PLAN DATE: DEC 2018 | REVIEWED BY: I. VAN OSDELL |
| PREPARED BY: KHA | REVIEWED BY: K. SMITH |
| REVISIONS | INIT. DATE |
| | |
| | |
| | |

SEAL

NORTH CAROLINA PROFESSIONAL ENGINEER SEAL 030472 KEVIN W. SMITH

Documented by: Kevin Smith 12/18/2018

SIGNATURE DATE

CADD Filename:

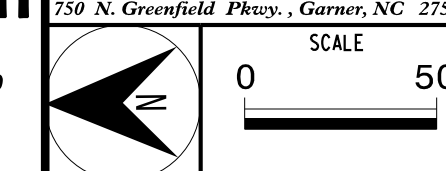

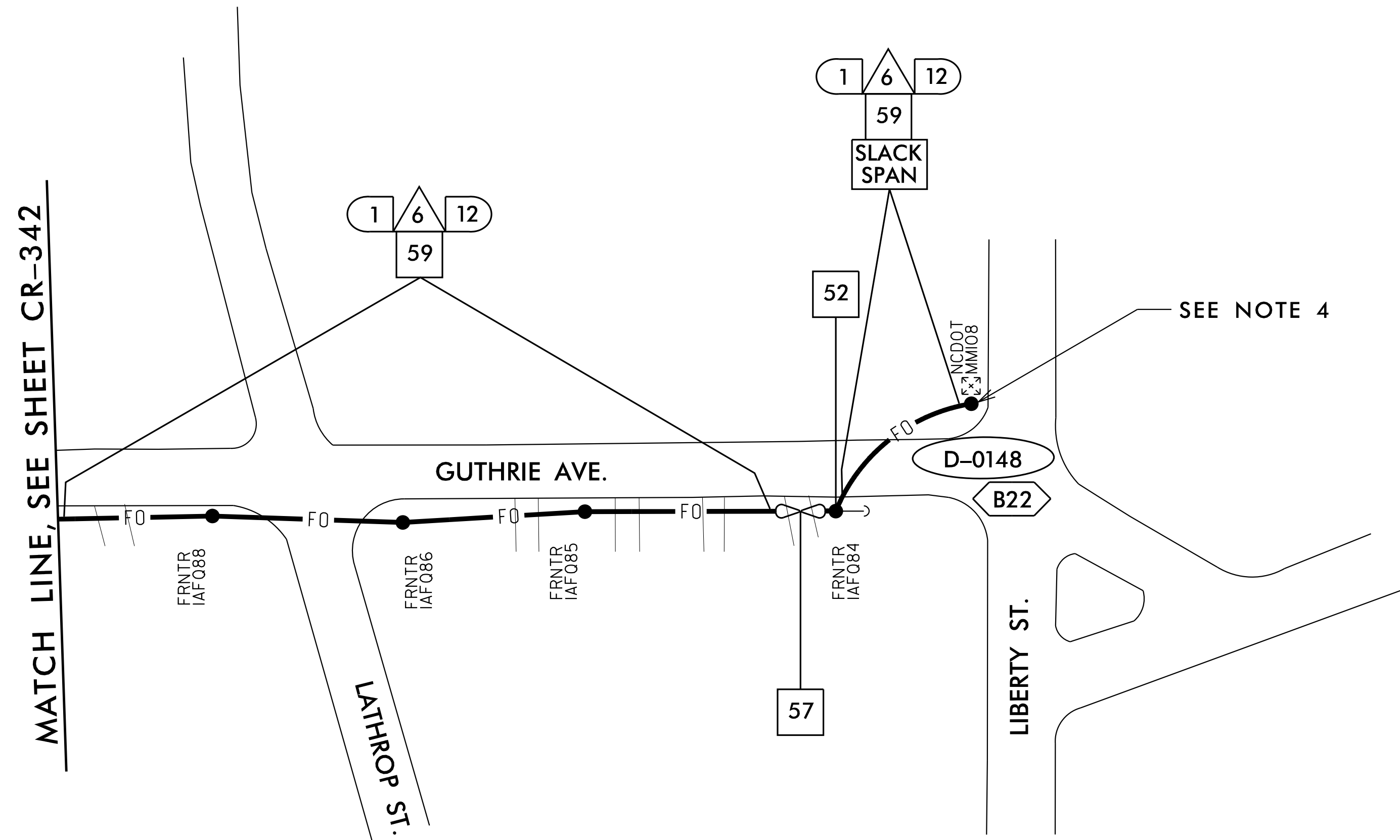

NOTES:

1. ATTACH NEW COMMUNICATIONS CABLE TO FRONT SIDE OF POLE AT 40 INCHES BELOW POWER PRESENCE UNLESS OTHERWISE NOTED.
2. MAINTAIN A MINIMUM OF 6 FEET FROM THE EDGE OF PAVEMENT WHEN TRENCHING PARALLEL TO THE ROADWAY UNLESS OTHERWISE NOTED.
3. THIS AREA HAS BEEN DETERMINED TO CONTAIN PROPERTIES WITH DOCUMENTED HISTORIC SIGNIFICANCE. IF IT IS NECESSARY TO DEVIATE FROM THESE PLANS IN THIS AREA, PLEASE ALERT THE ENGINEER TO CONTACT PROJECT DEVELOPMENT AND ENVIRONMENTAL ANALYSIS BRANCH - HISTORIC ARCHITECTURE GROUP OF THE NORTH CAROLINA DEPARTMENT OF TRANSPORTATION FOR AN EFFECT DETERMINATION BEFORE PROCEEDING.
4. CAP AND SEAL END OF CABLE AND COIL AT THIS POLE FOR FUTURE USE BY OTHERS. DO NOT TERMINATE CABLE IN CABINET.

12/14/2018 K:\ARL\TPTD\ITS\01036410 - Durham Signal System\Plans\U-5968_ITS_psh_374.dgn

Kimley»Horn
 NC License #F-0102
 421 Fayetteville St., Suite 600
 Raleigh, NC 27636
 Tel: (919) 677-2000
 Fax: (919) 677-2050

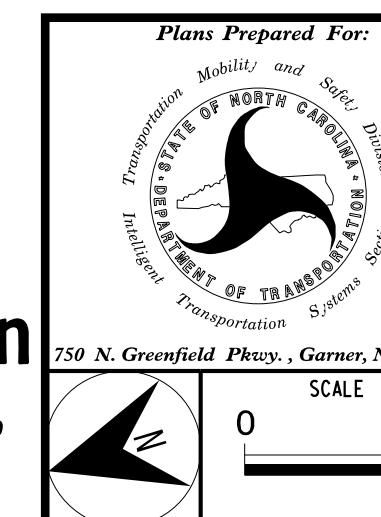

| | |
|---|----------------------------|
| CITY OF DURHAM COMPUTERIZED SIGNAL SYSTEM COMMUNICATIONS CABLE AND CONDUIT ROUTING PLAN | |
| DIVISION 05 | DURHAM COUNTY |
| PLAN DATE: DEC 2018 | REVIEWED BY: I. VAN OSDELL |
| PREPARED BY: KHA | REVIEWED BY: K. SMITH |
| REVISIONS | INIT. DATE |
| | |
| | |
| | |

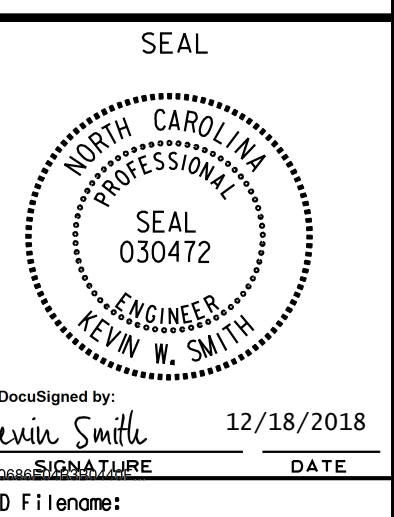

DocuSigned by:
 Kevin W. Smith
 12/18/2018
 CADD Filename: