

MATCH LINE, SEE SHEET CR-263

MATCH LINE, SEE SHEET CR-265

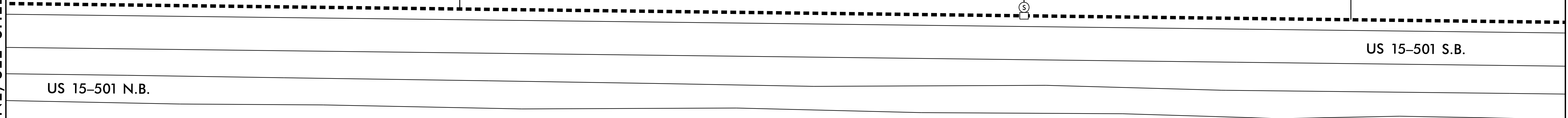

NOTES:

1. ATTACH NEW COMMUNICATIONS CABLE TO FRONT SIDE OF POLE AT 40 INCHES BELOW POWER PRESENCE UNLESS OTHERWISE NOTED.
2. MAINTAIN A MINIMUM OF 6 FEET FROM THE EDGE OF PAVEMENT WHEN TRENCHING PARALLEL TO THE ROADWAY UNLESS OTHERWISE NOTED.

12/14/2018 K:\ARL_TPTD\ITS\01036410 - Durham Signal System\Plans\U-5968_ITS_psh_264.dgn

Kimley»Horn
 NC License #F-0102
 421 Fayetteville St., Suite 600
 Raleigh, NC 27636
 Tel: (919) 677-2000
 Fax: (919) 677-2050

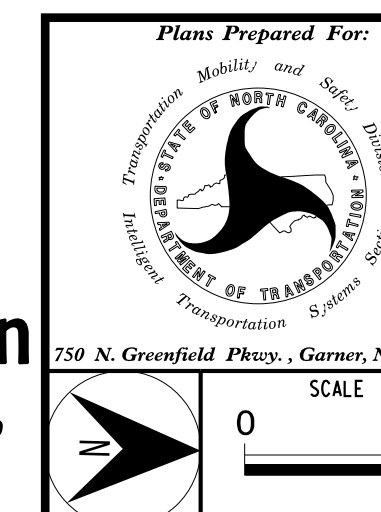

| | |
|---|----------------------------|
| CITY OF DURHAM COMPUTERIZED SIGNAL SYSTEM COMMUNICATIONS CABLE AND CONDUIT ROUTING PLAN | |
| DIVISION 05 | DURHAM COUNTY |
| PLAN DATE: DEC 2018 | REVIEWED BY: I. VAN OSDELL |
| PREPARED BY: KHA | REVIEWED BY: K. SMITH |
| REVISIONS | INIT. DATE |
| | |
| | |

SEAL
 NORTH CAROLINA PROFESSIONAL ENGINEER
 SEAL 030472
 KEVIN W. SMITH
 Documented by: KEVIN W. SMITH 12/18/2018
 SIGNATURE DATE
 CADD Filename:

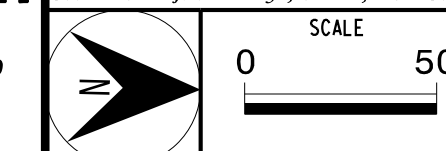

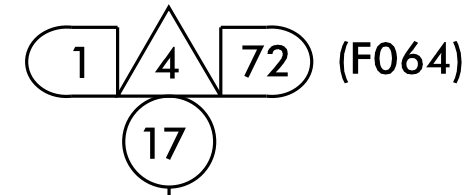

MATCH LINE, SEE SHEET CR-264

MATCH LINE, SEE SHEET CR-266

US 15-501 S.B.

US 15-501 S.B.

US 15-501 N.B.

US 15-501 N.B.

NOTES:

1. ATTACH NEW COMMUNICATIONS CABLE TO FRONT SIDE OF POLE AT 40 INCHES BELOW POWER PRESENCE UNLESS OTHERWISE NOTED.
2. MAINTAIN A MINIMUM OF 6 FEET FROM THE EDGE OF PAVEMENT WHEN TRENCHING PARALLEL TO THE ROADWAY UNLESS OTHERWISE NOTED.

| | | | |
|---------------------|--|------|---|
| | CITY OF DURHAM COMPUTERIZED SIGNAL SYSTEM COMMUNICATIONS CABLE AND CONDUIT ROUTING PLAN | | |
| | DIVISION 05 DURHAM COUNTY | | |
| PLAN DATE: DEC 2018 | REVIEWED BY: I. VAN OSDELL | | Documented by: <u>Kevin W. Smith</u> 12/18/2018 SIGNATURE DATE CADD Filename: |
| PREPARED BY: KHA | REVIEWED BY: K. SMITH | | |
| REVISIONS | INIT. | DATE | |

Kimley»Horn
 NC License #F-0102
 421 Fayetteville St., Suite 600
 Raleigh, NC 27636
 Tel: (919) 677-2000
 Fax: (919) 677-2050

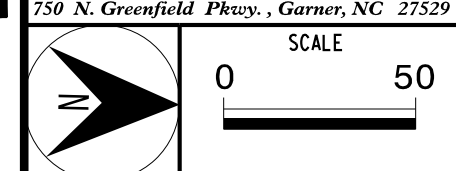

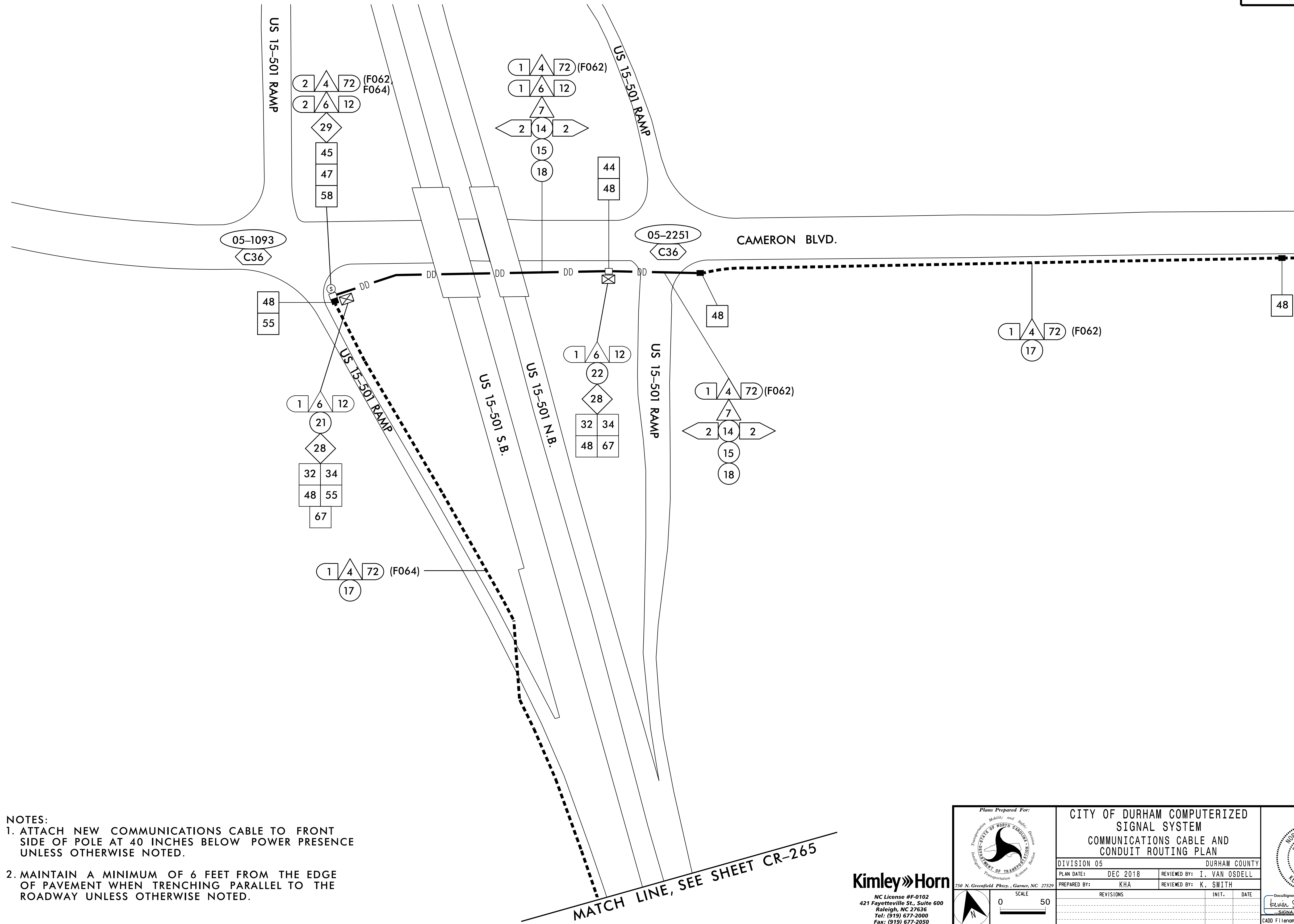

MATCH LINE, SEE SHEET CR-267

MATCH LINE, SEE SHEET CR-265

- NOTES:**
1. ATTACH NEW COMMUNICATIONS CABLE TO FRONT SIDE OF POLE AT 40 INCHES BELOW POWER PRESENCE UNLESS OTHERWISE NOTED.
 2. MAINTAIN A MINIMUM OF 6 FEET FROM THE EDGE OF PAVEMENT WHEN TRENCHING PARALLEL TO THE ROADWAY UNLESS OTHERWISE NOTED.

12/14/2018 K:\ARL_TPTD\ITS\0103640 - Durham Signal System\Plans\U-5968_ITS_psh_266.dgn

Kimley»Horn
 NC License #F-0102
 421 Fayetteville St., Suite 600
 Raleigh, NC 27636
 Tel: (919) 677-2000
 Fax: (919) 677-2050

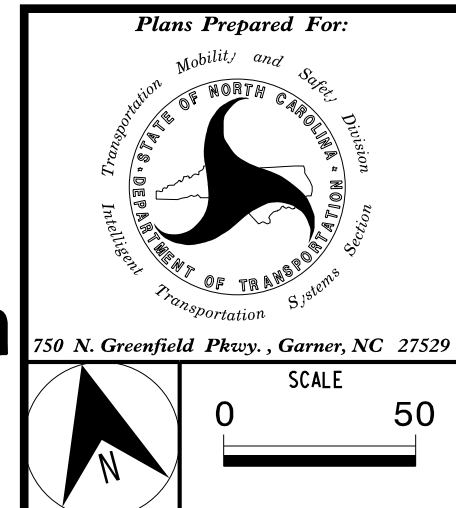

| | |
|---|----------------------------|
| CITY OF DURHAM COMPUTERIZED SIGNAL SYSTEM COMMUNICATIONS CABLE AND CONDUIT ROUTING PLAN | |
| DIVISION 05 | DURHAM COUNTY |
| PLAN DATE: DEC 2018 | REVIEWED BY: I. VAN OSDELL |
| PREPARED BY: KHA | REVIEWED BY: K. SMITH |
| REVISIONS | INIT. DATE |
| | |
| | |
| | |

SEAL
 NORTH CAROLINA PROFESSIONAL ENGINEER
 KEVIN W. SMITH
 SEAL 030472
 DocuSigned by:
 Kevin W. Smith 12/18/2018
 SIGNATURE DATE
 CADD Filename:

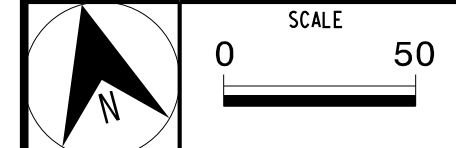

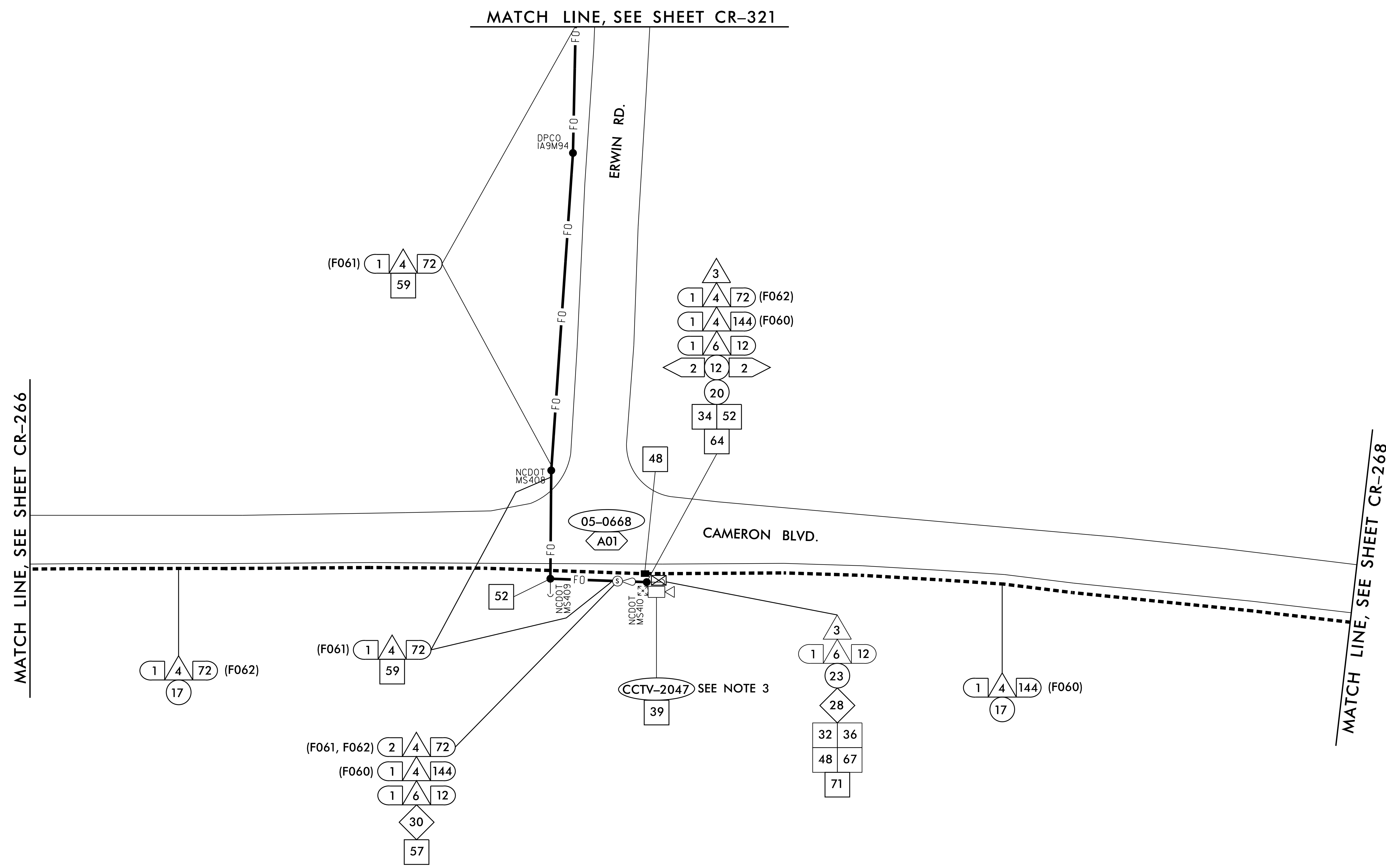

- NOTES:**
1. ATTACH NEW COMMUNICATIONS CABLE TO FRONT SIDE OF POLE AT 40 INCHES BELOW POWER PRESENCE UNLESS OTHERWISE NOTED.
 2. MAINTAIN A MINIMUM OF 6 FEET FROM THE EDGE OF PAVEMENT WHEN TRENCHING PARALLEL TO THE ROADWAY UNLESS OTHERWISE NOTED.
 3. INSTALL CCTV ON EXISTING WOOD SIGNAL SPAN POLE, 12" BELOW SIGNAL SPAN. SEE ITS-21.

12/14/2018 K:\ARL_TPTD_ITS_0103640 - Durham Signal System\Plans\U-5968_ITS_psh_267.dgn

Kimley»Horn
 NC License #F-0102
 421 Fayetteville St., Suite 600
 Raleigh, NC 27636
 Tel: (919) 677-2000
 Fax: (919) 677-2050

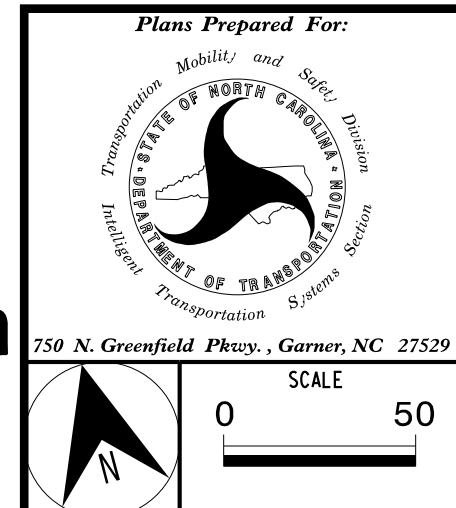

| | |
|--|----------------------------|
| CITY OF DURHAM COMPUTERIZED SIGNAL SYSTEM COMMUNICATIONS CABLE AND CONDUIT ROUTING PLAN | |
| DIVISION 05 | DURHAM COUNTY |
| PLAN DATE: DEC 2018 | REVIEWED BY: I. VAN OSDELL |
| PREPARED BY: KHA | REVIEWED BY: K. SMITH |
| REVISIONS | INIT. DATE |
| | |
| | |
| | |

| |
|--|
| SEAL NORTH CAROLINA PROFESSIONAL ENGINEER KEVIN W. SMITH 030472 12/18/2018 DATE CADD Filename: |
|--|

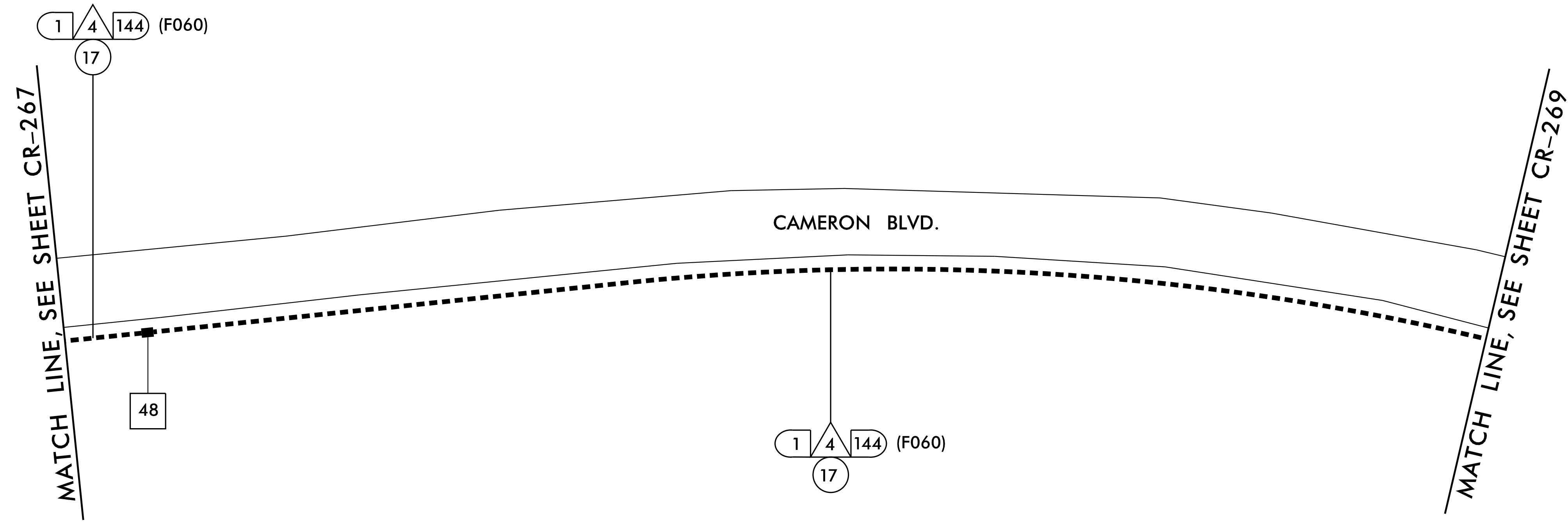

NOTES:

- ATTACH NEW COMMUNICATIONS CABLE TO FRONT SIDE OF POLE AT 40 INCHES BELOW POWER PRESENCE UNLESS OTHERWISE NOTED.
- MAINTAIN A MINIMUM OF 6 FEET FROM THE EDGE OF PAVEMENT WHEN TRENCHING PARALLEL TO THE ROADWAY UNLESS OTHERWISE NOTED.

| | | | |
|---|--|-------------------------|--|
| | CITY OF DURHAM COMPUTERIZED SIGNAL SYSTEM COMMUNICATIONS CABLE AND CONDUIT ROUTING PLAN | | |
| | DIVISION 05 | DURHAM COUNTY | |
| PLAN DATE: DEC 2018 PREPARED BY: KHA | REVIEWED BY: I. VAN OSDELL REVIEWED BY: K. SMITH | REVISIONS INIT. DATE | DocuSigned by: KEVIN W. SMITH 12/18/2018 |

Kimley»Horn
 NC License #F-0102
 421 Fayetteville St., Suite 600
 Raleigh, NC 27636
 Tel: (919) 677-2000
 Fax: (919) 677-2050

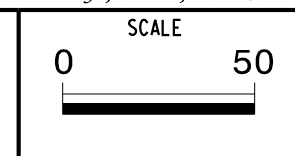

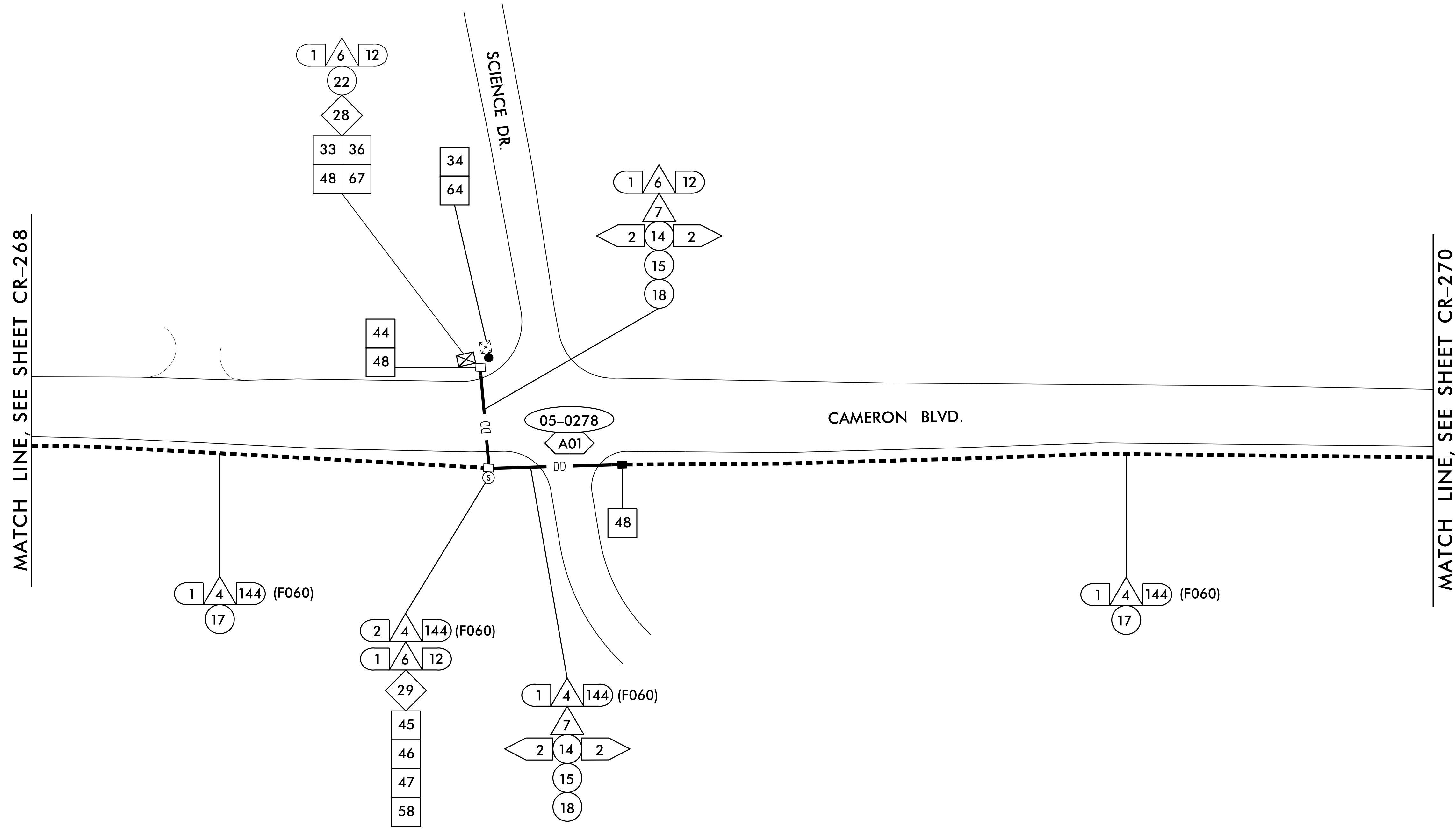

- NOTES:
1. ATTACH NEW COMMUNICATIONS CABLE TO FRONT SIDE OF POLE AT 40 INCHES BELOW POWER PRESENCE UNLESS OTHERWISE NOTED.
 2. MAINTAIN A MINIMUM OF 6 FEET FROM THE EDGE OF PAVEMENT WHEN TRENCHING PARALLEL TO THE ROADWAY UNLESS OTHERWISE NOTED.

12/14/2018 K:\ARL_TPTD_ITS\01036410 - Durham Signal System\Plans\U-5968_ITS_psh_269.dgn

Kimley»Horn
 NC License #F-0102
 421 Fayetteville St., Suite 600
 Raleigh, NC 27636
 Tel: (919) 677-2000
 Fax: (919) 677-2050

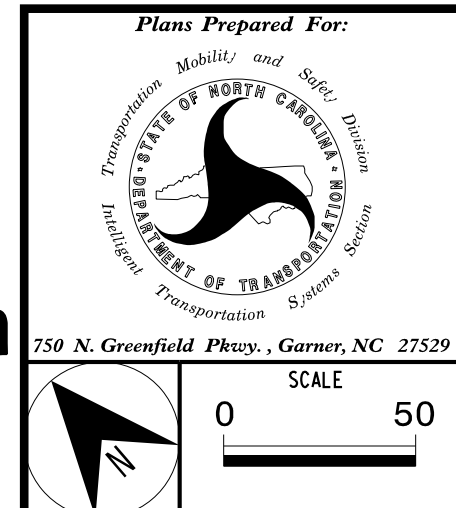

| | |
|--|----------------------------|
| CITY OF DURHAM COMPUTERIZED SIGNAL SYSTEM COMMUNICATIONS CABLE AND CONDUIT ROUTING PLAN | |
| DIVISION 05 | DURHAM COUNTY |
| PLAN DATE: DEC 2018 | REVIEWED BY: I. VAN OSDELL |
| PREPARED BY: KHA | REVIEWED BY: K. SMITH |
| REVISIONS | INIT. DATE |
| | |
| | |
| | |

SEAL
 NORTH CAROLINA
 PROFESSIONAL
 ENGINEER
 KEVIN W. SMITH
 SEAL
 030472
 DocuSigned by:
 Kevin W. Smith
 12/18/2018
 DATE
 CADD Filename:

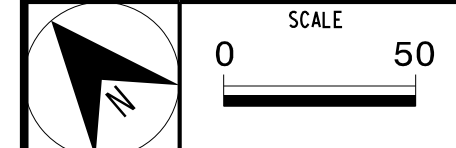

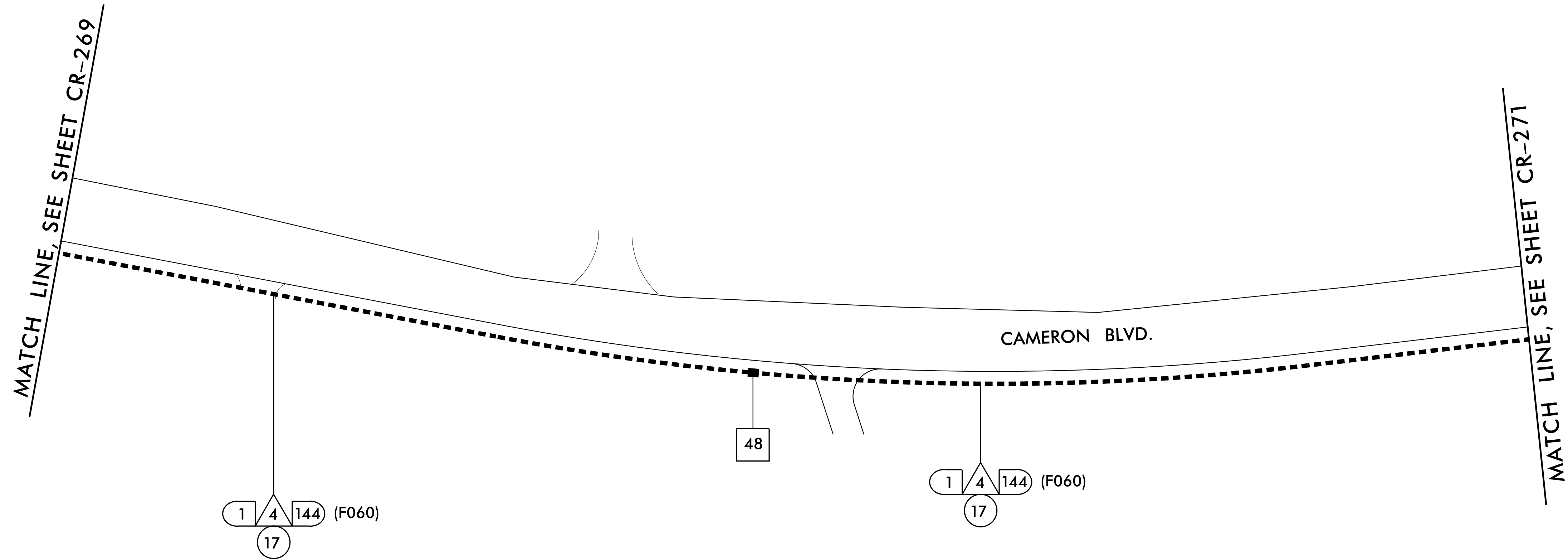

NOTES:

1. ATTACH NEW COMMUNICATIONS CABLE TO FRONT SIDE OF POLE AT 40 INCHES BELOW POWER PRESENCE UNLESS OTHERWISE NOTED.
2. MAINTAIN A MINIMUM OF 6 FEET FROM THE EDGE OF PAVEMENT WHEN TRENCHING PARALLEL TO THE ROADWAY UNLESS OTHERWISE NOTED.

12/14/2018 KARAL_TPTD.LTS 0103640 - Durham Signal System\Plans\U-5968.LTS_psh_270.dgn

Kimley»Horn
 NC License #F-0102
 421 Fayetteville St., Suite 600
 Raleigh, NC 27636
 Tel: (919) 677-2000
 Fax: (919) 677-2050

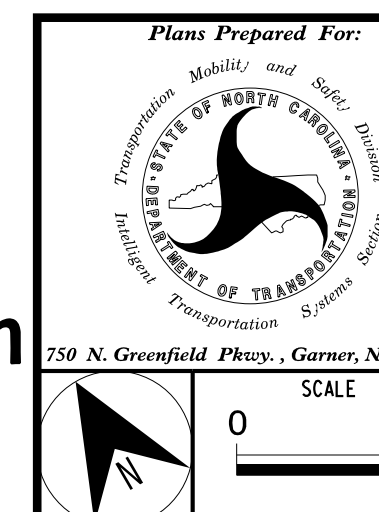

| | |
|---|----------------------------|
| CITY OF DURHAM COMPUTERIZED SIGNAL SYSTEM COMMUNICATIONS CABLE AND CONDUIT ROUTING PLAN | |
| DIVISION 05 | DURHAM COUNTY |
| PLAN DATE: DEC 2018 | REVIEWED BY: I. VAN OSDELL |
| PREPARED BY: KHA | REVIEWED BY: K. SMITH |
| REVISIONS | INIT. DATE |
| | |
| | |
| | |

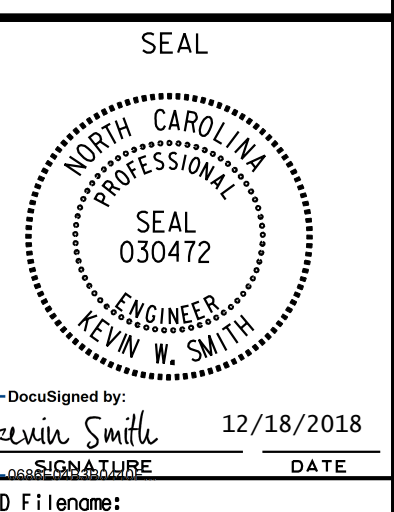

DocuSigned by:
 Kevin W. Smith
 12/18/2018
 CADD Filename: