

1 GROUND FLOOR
1/4" = 1'-0"

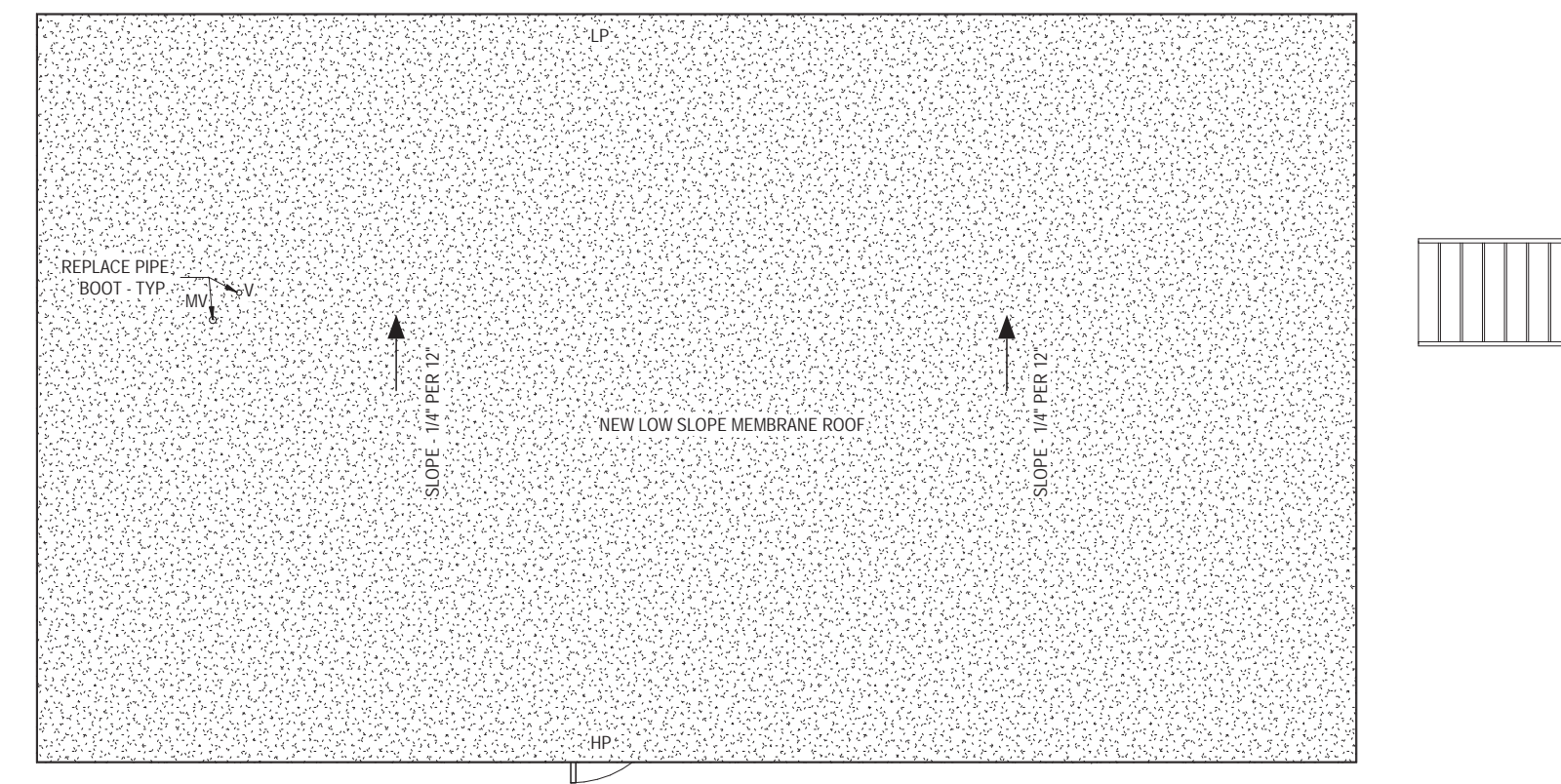

4 ROOF PLAN
1/4" = 1'-0"

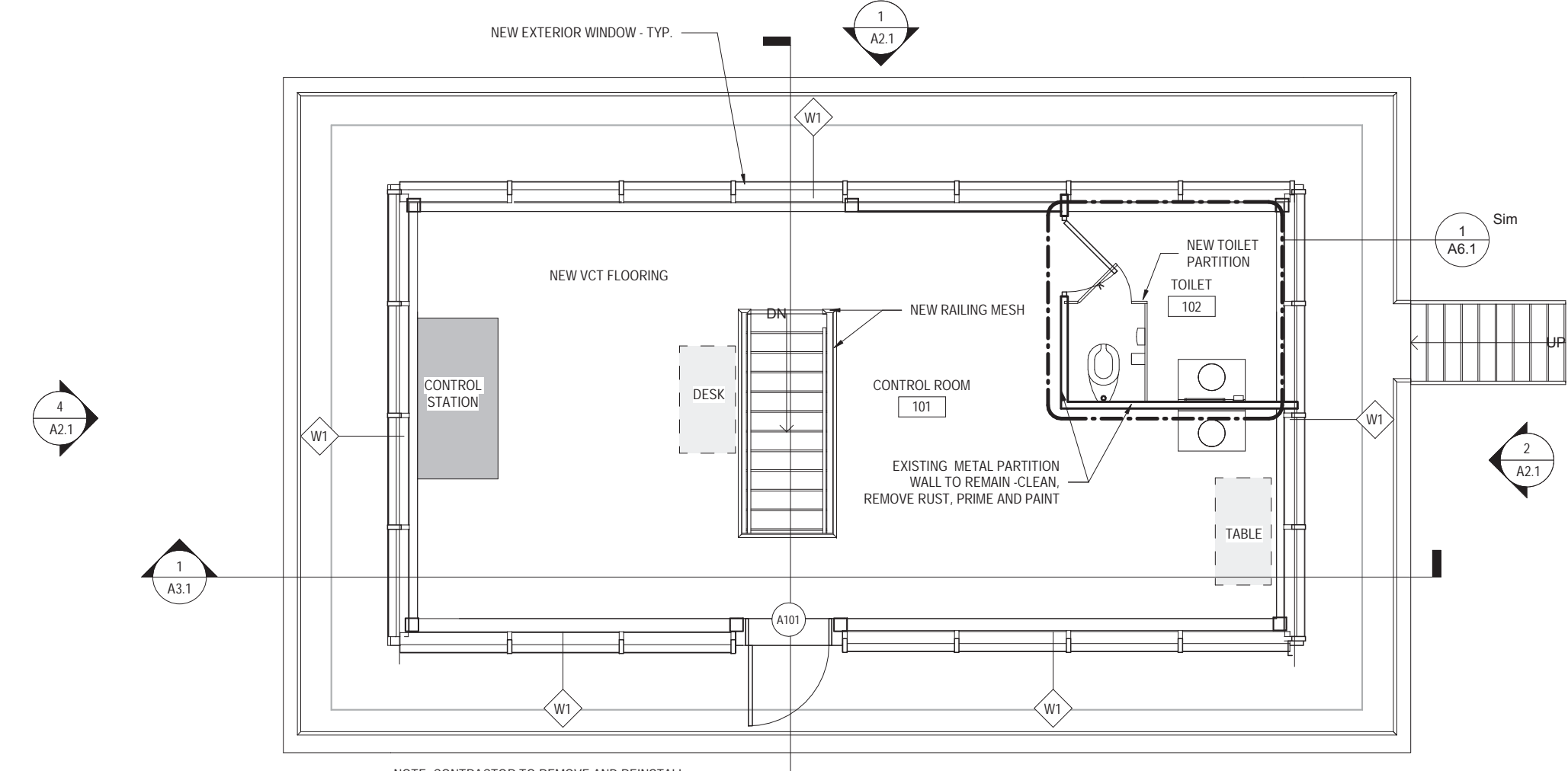

2 FIRST FLOOR PLAN
1/4" = 1'-0"

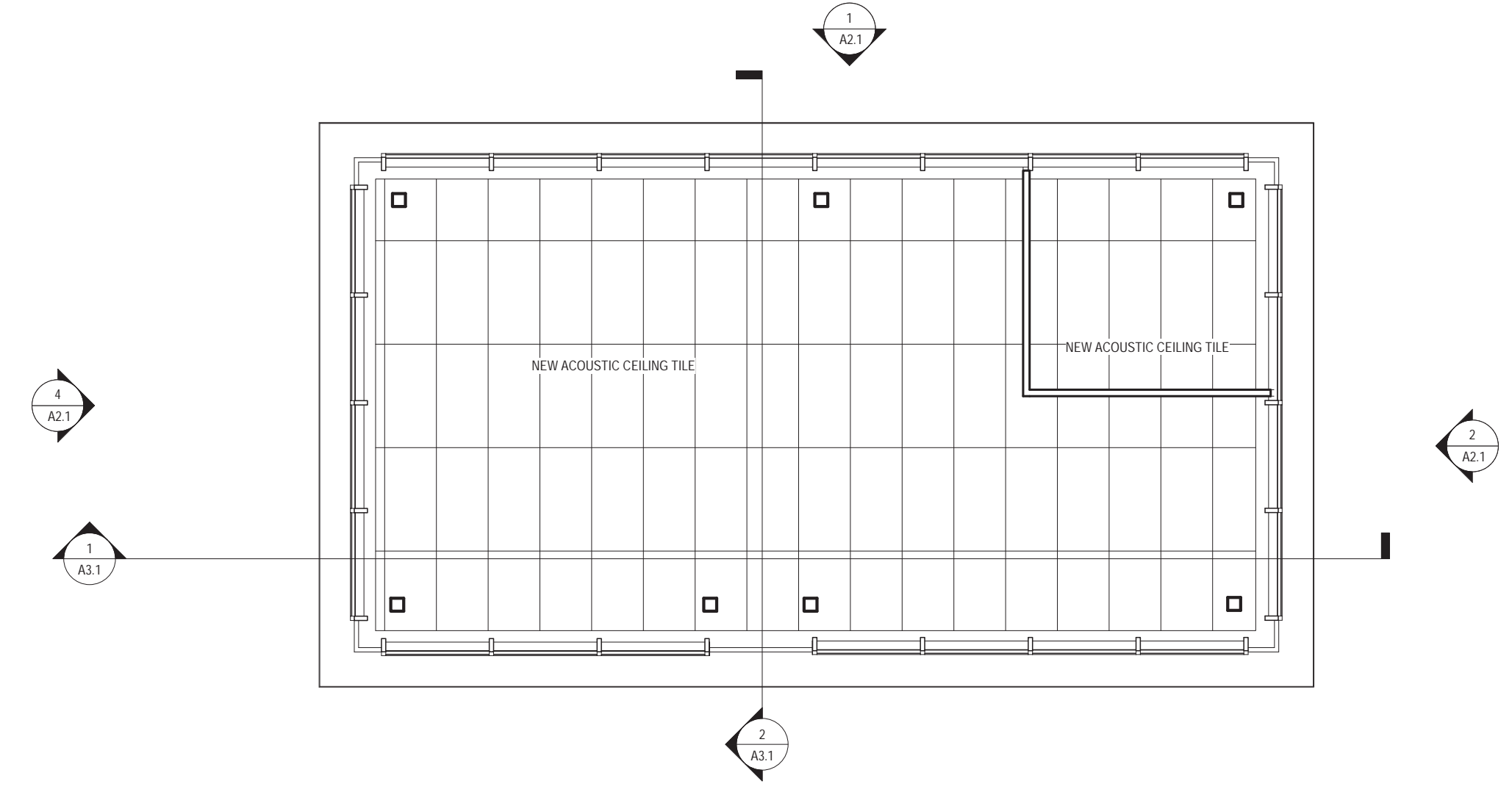

3 FIRST FLOOR REFLECTED CEILING PLAN
1/4" = 1'-0"

- GENERAL NOTES:**
1. ALL DOOR JAMBS SHALL BE LOCATED 4" FROM INSIDE CORNER OF WALL ON HINGE SIDE UNLESS OTHERWISE INDICATED.
 2. COORDINATE LOCATION OF MEP EQUIPMENT, DEVICES, OUTLET BOXES, ETC. WITH OTHER EQUIPMENT AND FINISH SCHEDULE PRIOR TO INSTALLATION.
 3. UNLESS NOTED OTHERWISE, WHERE DIFFERENT FLOOR ELEVATIONS OCCUR ON OPPOSITE SIDES OF INTERIOR MASONRY WALLS, PROVIDE COLD FLUID APPLIED WATERPROOFING (CFAWP) ON THE BACKFILLED FACE OF WALL. APPLY CFAWP FROM UNDERSIDE OF CONC. SLAB TO TOP OF FOOTING BELOW. CFAWP NOT TO INTERFERE WITH INSTALLATION OF CONC. SLAB VAPOR BARRIER.
 4. ALL WALL LAYOUT DIMENSIONS ARE FROM FACE OF STUD & FACE OF CMU UNLESS OTHERWISE NOTED.

LEGEND		ROOF PLAN NOTES:	
LP	LOW POINT	1.	COORDINATE ROOF-MOUNTED EQUIPMENT & PENETRATIONS. REFER TO MEP DRAWINGS.
HP	HIGH POINT	2.	PROVIDE ROOFING MANUFACTURERS' STANDARD DETAILS FOR ALL PENETRATIONS & FLASHING AS PER ROOFING MANUFACTURERS' WARRANTY.
OD	OVERFLOW DRAIN	3.	CRICKETS AND SADDLES SHALL HAVE A MINIMUM OF TWO TIMES THE SLOPE OF THE PRIMARY TAPERED SYSTEM OR STRUCTURAL SLOPE.
→	FLOW DIRECTION	4.	ROOF MOUNTED EQUIPMENT CURBS AND SUPPORTS SHALL BE FURNISHED AND INSTALLED BY THE EQUIPMENT SUPPLIER.
[Stippled Box]	INDICATES MEMBRANE ROOF SYSTEM WITH TAPERED INSULATION ROOF		

- REFLECTED CEILING PLAN GENERAL NOTES:**
1. UNLESS NOTED OTHERWISE, GYPSUM BULKHEADS TO BE 3/8" METAL STUDS AT 16" O/C WITH 5/8" GWB EACH SIDE, EXTENDING MIN. 1" BELOW ADJACENT CEILING.
 2. CEILING GRID SHALL BE COORDINATED WITH MEP EQUIPMENT AND DEVICES.
 3. UNLESS NOTED OTHERWISE, ALL VISIBLE STRUCTURAL STEEL, ROOF FLOOR DECK, DUCTWORK, PIPING, CONDUIT, HANGER WIRES, ETC. AT EXPOSED LOCATIONS OR ABOVE CEILING CLOUDS SHALL BE PAINTED.
 4. REFER TO ROOM FINISH SCHEDULE FOR CEILING TYPES.
 5. ALL VISIBLE HANGER WIRES, STRUCTURE AND BRACING AT EXPOSED CEILING GRID OR CEILING CLOUD LOCATIONS SHALL BE INSTALLED PLUMB AND LEVEL.
 6. FOR WINDOWS THAT REQUIRE TWO OR MORE ROLLER SHADES, EACH ROLLER SHADE SHALL TERMINATE AT THE CENTER OF THE WINDOW MULLION. REFER TO HOLLOW METAL AND ALUMINUM FRAME ELEVATIONS FOR DIMENSIONS AND WINDOW MULLION DESIGN AND ROLLER SHADE BRAKES.

LEGEND	
[Grid Box]	2' X 4' SUSPENDED CEILING SYSTEM

ALL REPORTS, PLANS SPECIFICATIONS AND COMPUTER FILES RELATING TO THIS PROJECT ARE THE PROPERTY OF CRABTREE, ROHRBAUGH & ASSOCIATES. CRABTREE, ROHRBAUGH & ASSOCIATES RESERVES ALL COMMON LAW, STATUTE AND OTHER RESERVED RIGHTS INCLUDING THE COPYRIGHT. THESE TO REPRODUCTION OF THE MATERIAL HEREIN OR SUBSTANTIAL USE WITHOUT WRITTEN PERMISSION OF CRABTREE, ROHRBAUGH & ASSOCIATES VIOLATES THE COPYRIGHT LAWS OF THE UNITED STATES AND WILL BE SUBJECT TO LEGAL PROSECUTION. © CRABTREE, ROHRBAUGH & ASSOCIATES, INC. 2018

REVISIONS		
NO.	DATE	DESCRIPTION OF CHANGES

CRABTREE ROHRBAUGH & ASSOCIATES - ARCHITECTS
 BALTIMORE, MARYLAND
 CHARLOTTESVILLE, VIRGINIA
 WHITE SULPHUR SPRINGS, WEST VIRGINIA
www.cra-architects.com

401 EAST WINDING HILL ROAD
 MECHANICSBURG PA 17055
 717-458-0272

RENOVATIONS TO THE ISABEL HOLMES BRIDGE

OVERALL FLOOR PLANS, REFLECTED CEILING PLAN, ROOF PLAN
 PLOT SCALE: 1/4" = 1'-0"
 FILENAME:
 DATE: November 9, 2018

PROJECT 3133
 A1.1