

MAP #10

DETAIL AND TYPICAL #7

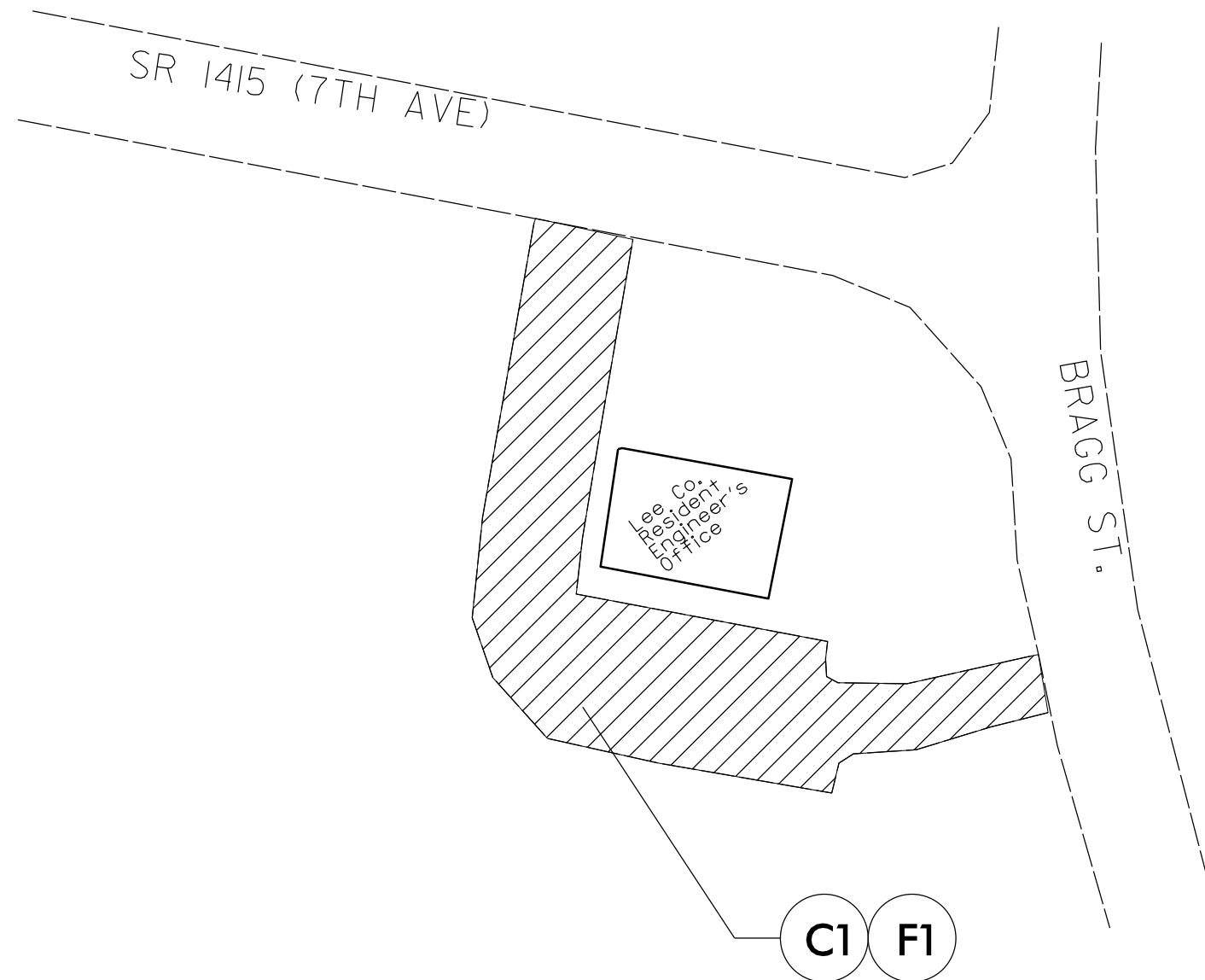

PAVEMENT SCHEDULE	
C1	PROP. APPROX. 1.5" ASPHALT CONCRETE SURFACE COURSE, TYPE S9.5B, AT AN AVERAGE RATE OF 165 LBS. PER SQ. YD.
F1	ASPHALT SURFACE TREATMENT, SINGLE SEAL