

PROJECT REFERENCE NO. R-5742	SHEET NO. EC-37/CONST.-17
RW SHEET NO.	
ROADWAY DESIGN ENGINEER	HYDRAULICS ENGINEER

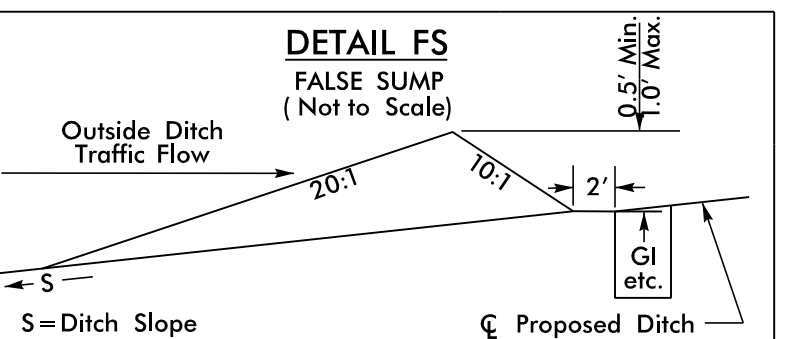
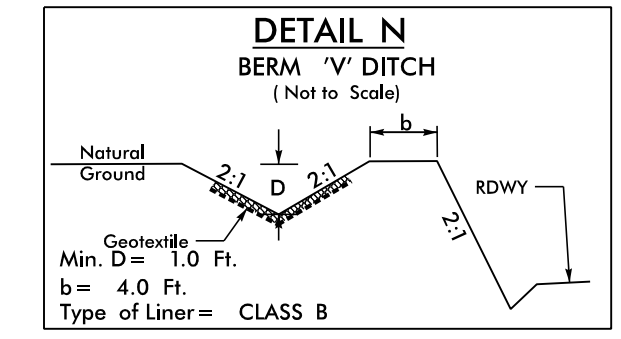
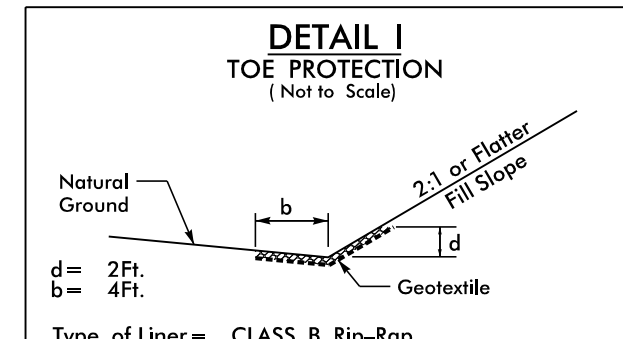
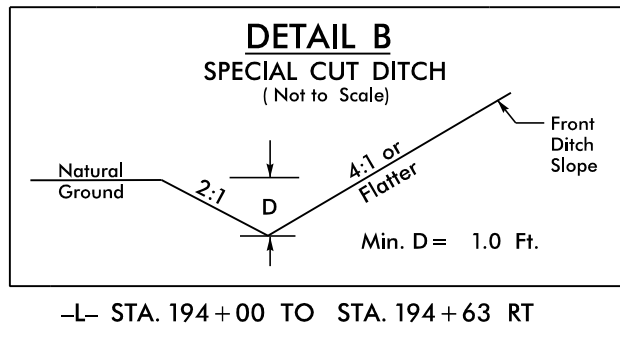
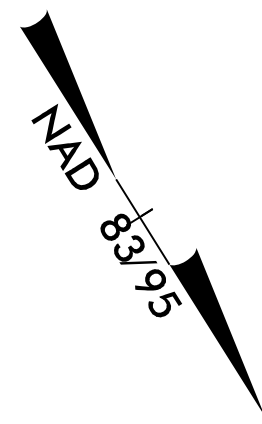

TELEPHONE
FRONTIER COMMUNICATIONS
765 CHURCH STREET
MURPHY, N.C. 28906
828-837-5800

SEWER
CLAY COUNTY WATER & SEWER
33 MAIN ST.
HAYESVILLE, N.C.
828-389-1361

U.S.A. - T.V.A
LAKE CHATUGE
DB 36 PG 251

Place Matting for Erosion Control
on Slopes Adjacent to Permitted
Wetlands as Work Allows.

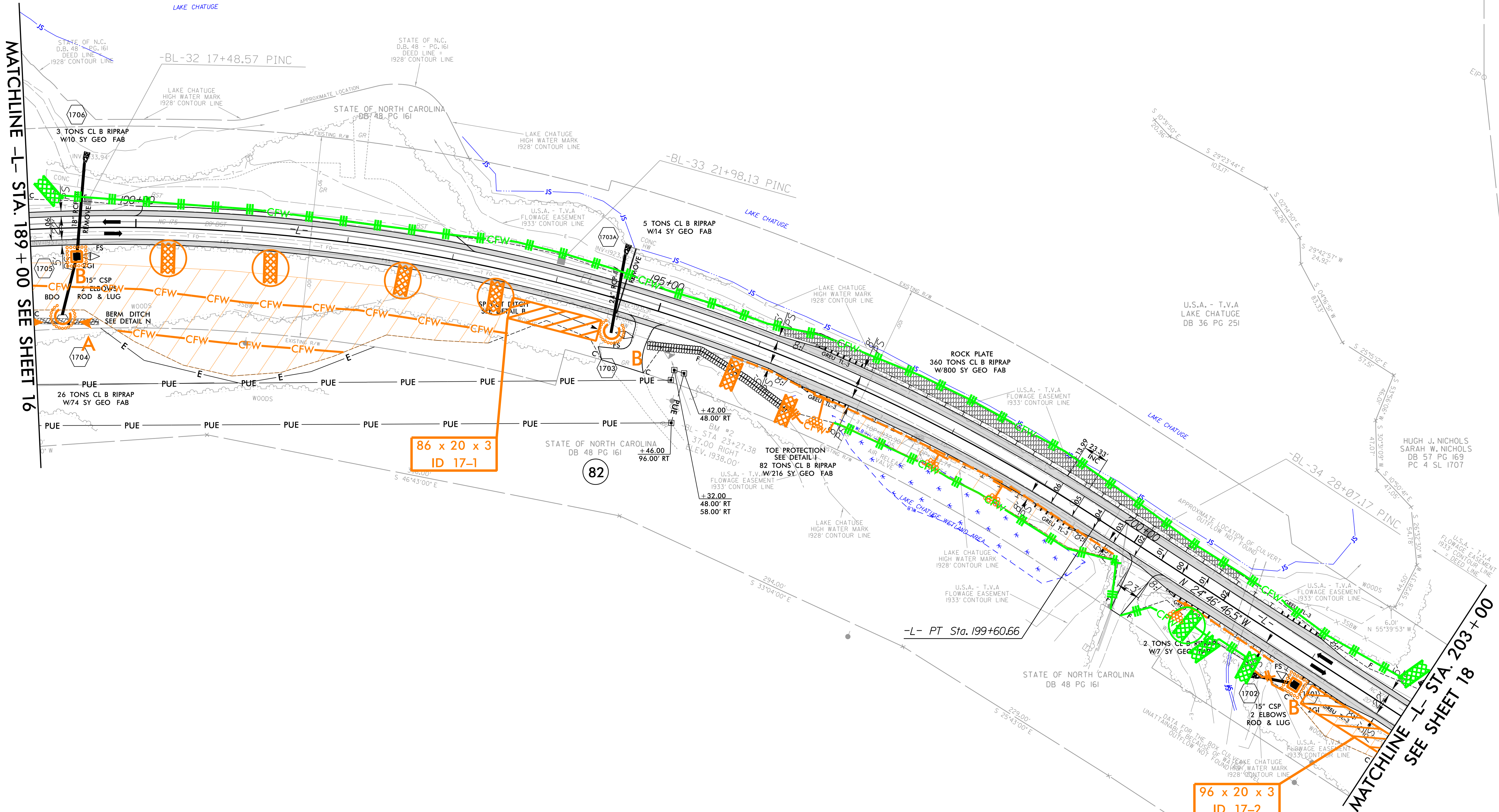

86 x 20 x 3
ID 17-1

96 x 20 x 3
ID 17-2

-L-
PI Sta 192+07.18
 $\Delta = 55^{\circ} 36' 35.8''$ (RT)
D = 3' 22' 13.2"
L = 1,649.98'
T = 896.50'
R = 1,700.00'
SE = 0.06
V = 50 mph

FOR -L- PROFILE SEE SHT. 26
NOTE: ALL DRIVEWAY WIDTHS ARE 16' UNLESS OTHERWISE NOTED.
ALL DRIVEWAY RADII ARE 10' UNLESS OTHERWISE NOTED.

PLANS PREPARED BY :
RK&K
RUMMEL, KLEPPER & KAHL, LLP
900 RIDGEFIELD DRIVE SUITE 350
RALEIGH, NORTH CAROLINA 27609-3960
NC LICENSE NO. F-0112 • (919) 878-9560

8/17/99
R:\Hydraulics\CADD\PSH\Erosion_Control\NR-5742_EC_psh33.dgn
12/21/2018