

PROJECT REFERENCE NO. R-5742	SHEET NO. EC-12/CONST.-10
RW SHEET NO.	
ROADWAY DESIGN ENGINEER	HYDRAULICS ENGINEER

CLEARING AND GRUBBING  
EROSION CONTROL FOR  
CONSTRUCTION SHEET 10

NOTE:  
PLACE TEMPORARY ROCK SEDIMENT DAMS TYPE - B  
AND TEMPORARY ROCK SILT CHECKS TYPE - A AT  
DRAINAGE OUTLETS.

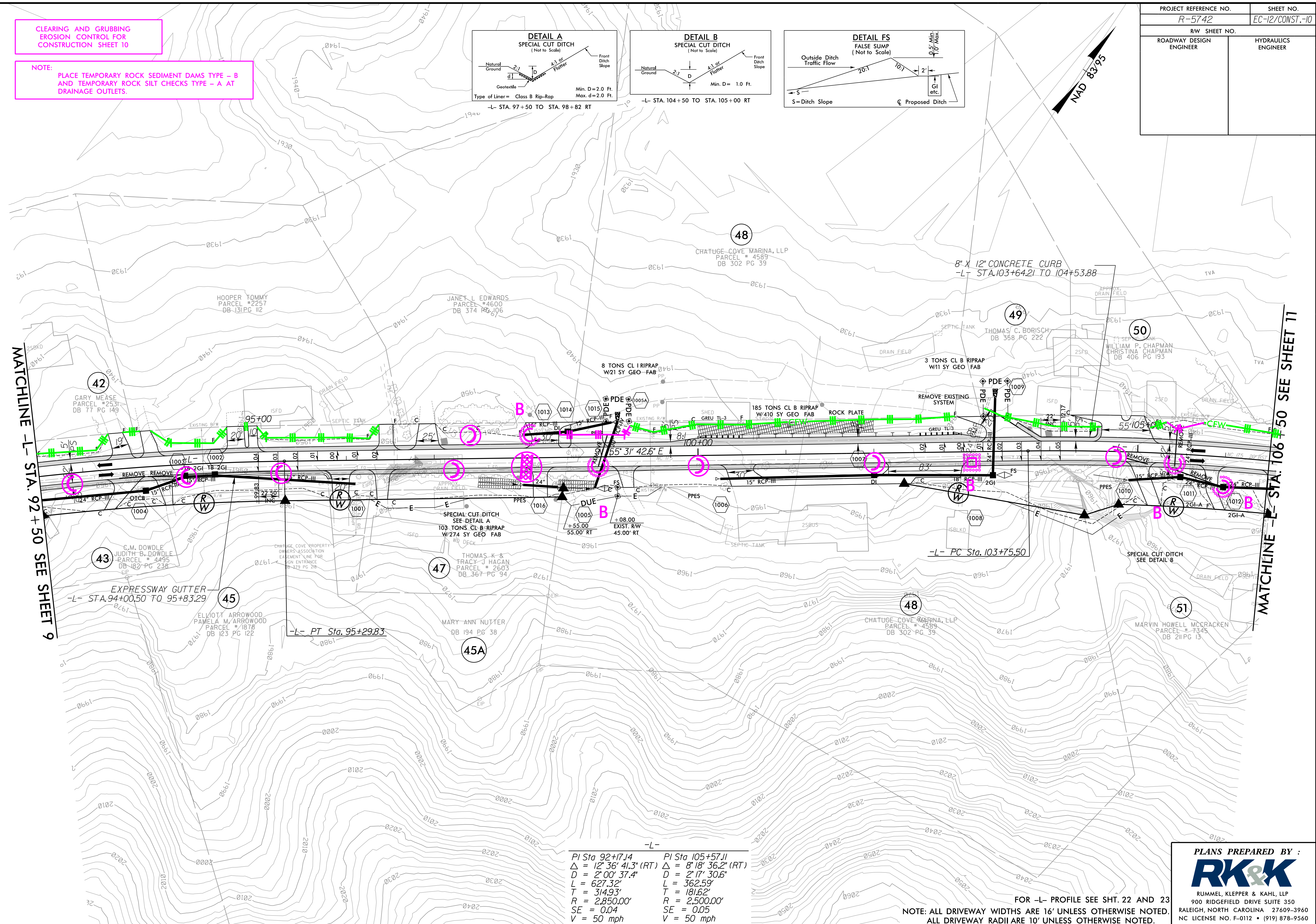
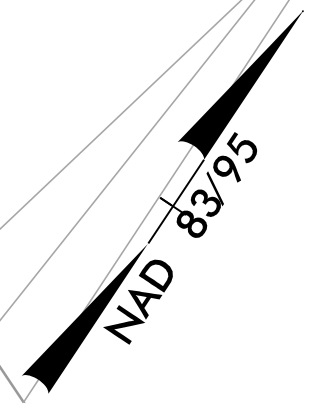
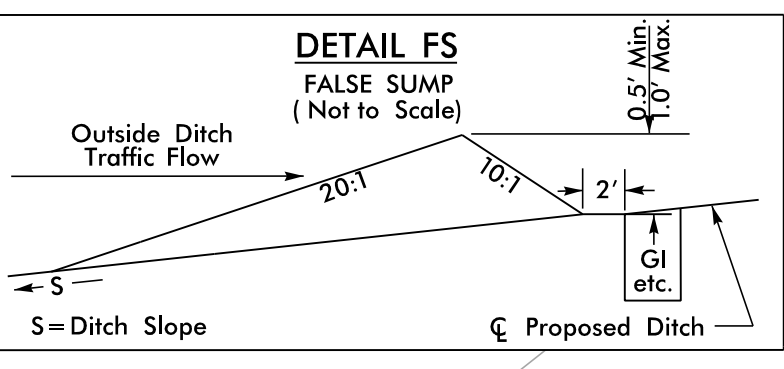
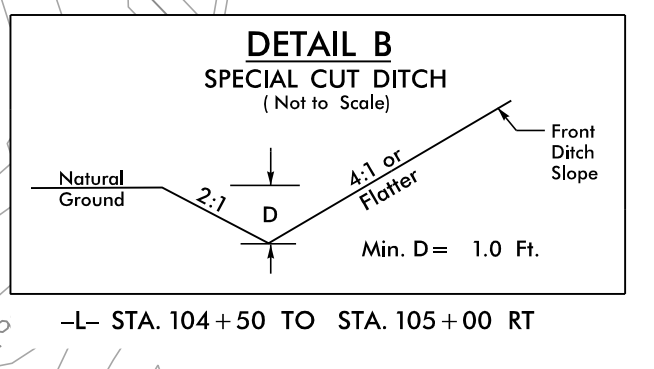
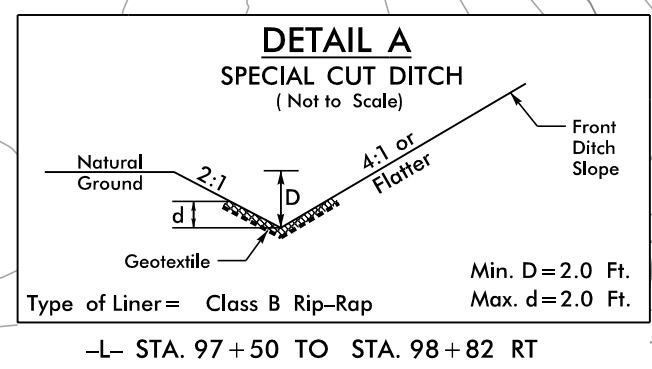

MATCHLINE -L- STA. 92+50 SEE SHEET 9

MATCHLINE -L- STA. 106+50 SEE SHEET 11

-L-	-L-
PI Sta 92+17.14	PI Sta 105+57.11
$\Delta = 12' 36" 41.3" (RT)$	$\Delta = 8' 18" 36.2" (RT)$
$D = 2' 00" 37.4"$	$D = 2' 17" 30.6"$
$L = 627.32'$	$L = 362.59'$
$T = 314.93'$	$T = 181.62'$
$R = 2,850.00'$	$R = 2,500.00'$
$SE = 0.04$	$SE = 0.05$
$V = 50 \text{ mph}$	$V = 50 \text{ mph}$

FOR -L- PROFILE SEE SHT. 22 AND 23  
NOTE: ALL DRIVEWAY WIDTHS ARE 16' UNLESS OTHERWISE NOTED.  
ALL DRIVEWAY RADII ARE 10' UNLESS OTHERWISE NOTED.

PLANS PREPARED BY :

RUMMEL, KLEPPER & KAHL, LLP  
900 RIDGEFIELD DRIVE SUITE 350  
RALEIGH, NORTH CAROLINA 27609-3960  
NC LICENSE NO. F-0112 • (919) 878-9560

8.17.09  
R:\Hydro\cadd\PSH\Erosion\_Control\NR-5742\_EC\_psh10.dgn