

PROJECT REFERENCE NO.	SHEET NO.
1-5823	EC-19
RW SHEET NO.	
ROADWAY DESIGN ENGINEER	HYDRAULICS ENGINEER

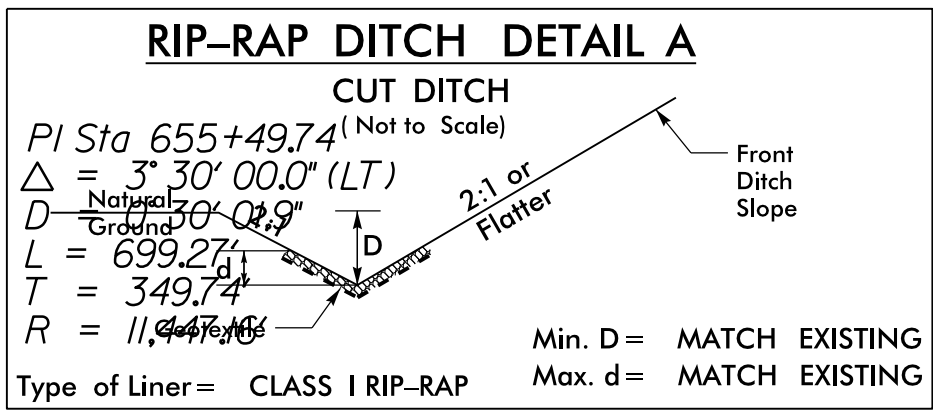

PI Sta 654+58.42
 $\Delta = 10^{\circ} 08' 16.1''$ (LT)
 $D = 0^{\circ} 30' 00.0''$
 $L = 2,027.56'$
 $T = 1,016.43'$
 $R = 11,459.16'$



-EOT7- 652+94 TO 654+56 LT, EST. 108 TONS,
 EST. 220 SY GEO FAB, EST. 76 CY DDE
 -EOT8- 652+83 TO 653+32 RT, EST. 33 TONS,
 EST. 67 SY GEO FAB, EST. 23 CY DDE

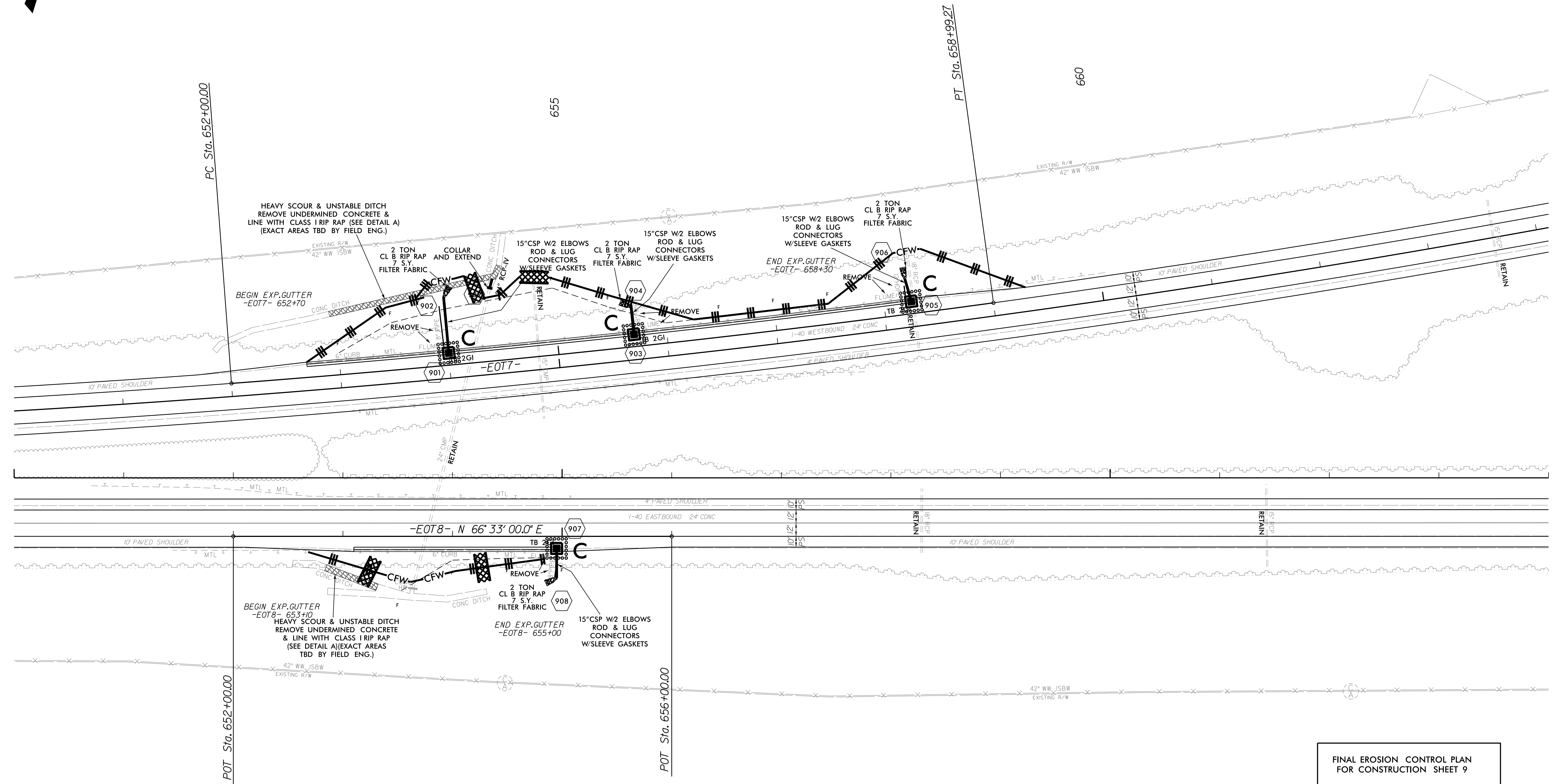

FINAL EROSION CONTROL PLAN
 FOR CONSTRUCTION SHEET 9

29 NOV 2018 11:29
 C:\Program Files\Autodesk\AutoCAD 2011\Projects\1-5823-40-Dave\EROSIONCONTROL\15823.ddc_EC-19.dgn
 USER:DAVE