

PROJECT REFERENCE NO. 1-5823	SHEET NO. EC-II
RW SHEET NO.	
ROADWAY DESIGN ENGINEER	HYDRAULICS ENGINEER

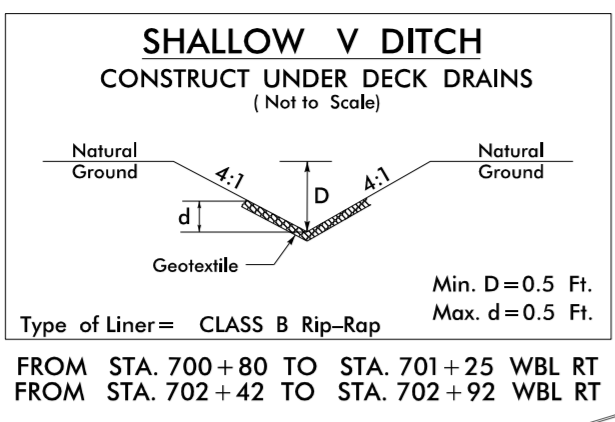

L-LT

PIs Sta 696+97.22 Os = 0° 30' 00.0" Ls = 200.00' LT = 133.33' ST = 66.67'	PI Sta 711+08.79 Δ = 13° 23' 16.1" (RT) D = 0° 30' 00.0" L = 2,677.56' T = 1,344.90' R = 11459.16'	PIs Sta 725+08.11 Os = 0° 30' 00.0" Ls = 200.00' LT = 133.33' ST = 66.67'
---	---	---

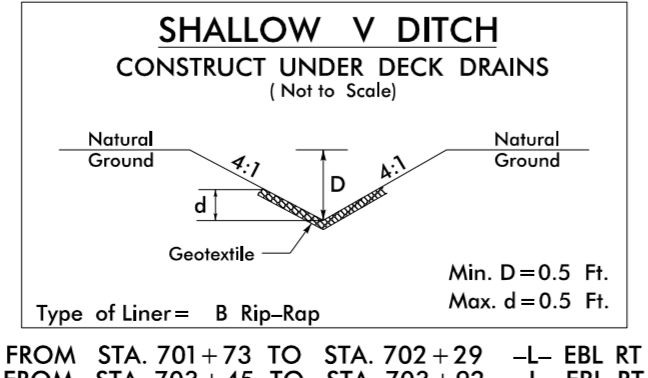
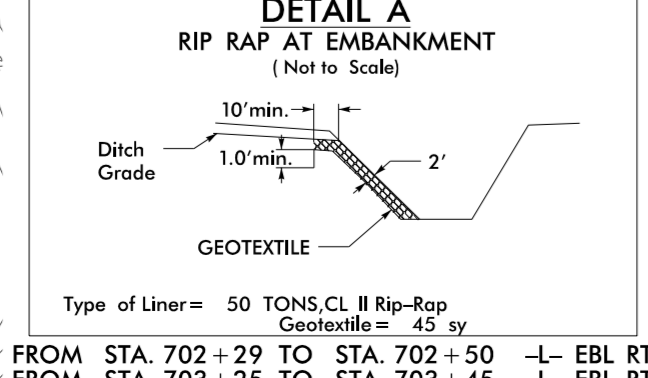
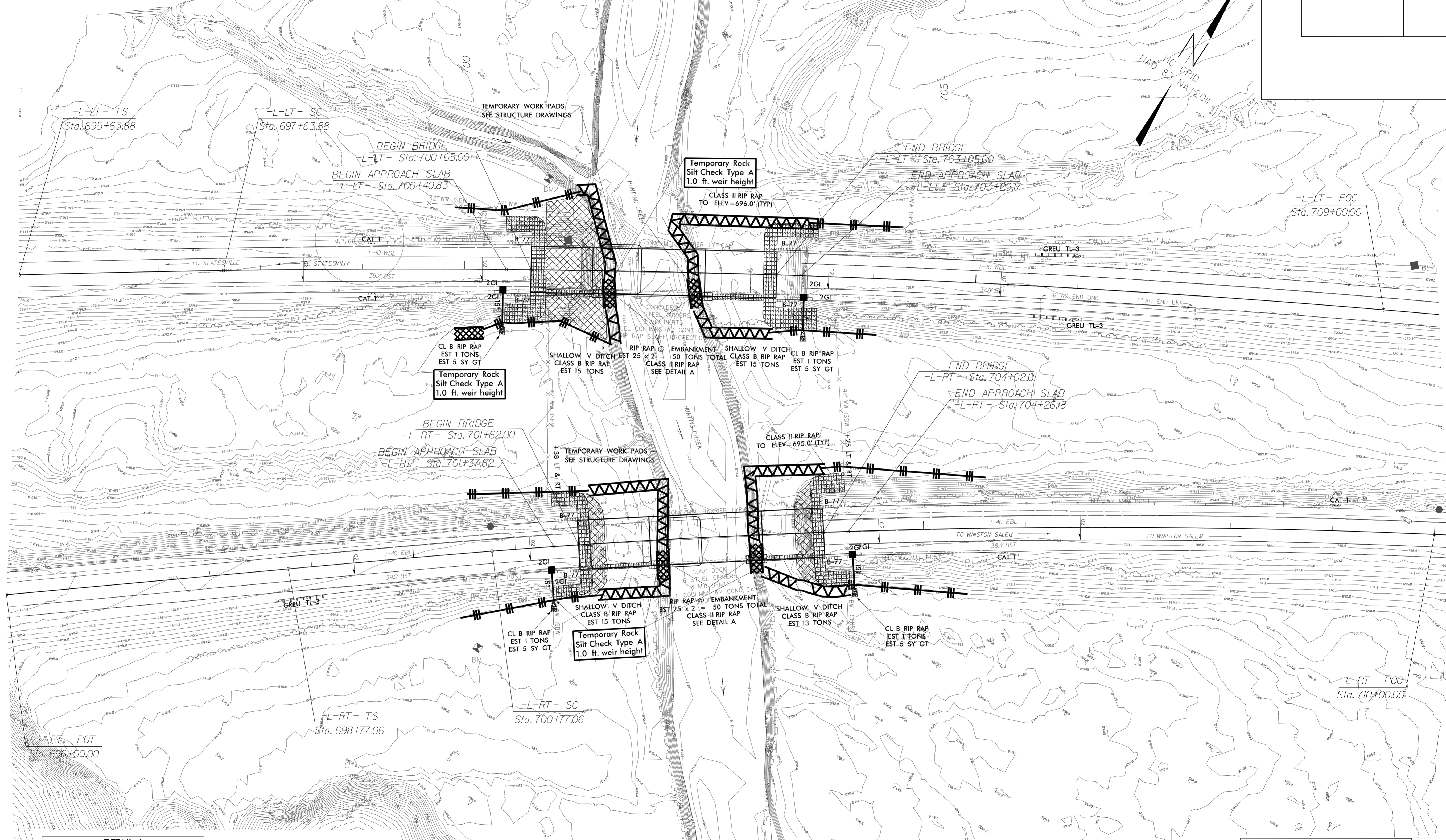

L-RT

PIs Sta 700+00.39 Os = 0° 45' 00.0" Ls = 200.00' LT = 133.33' ST = 66.67'	PI Sta 710+92.83 Δ = 15° 08' 51.8" (RT) D = 0° 45' 00.0" L = 2,019.70' T = 1,015.77' R = 71639.44'	PIs Sta 721+63.42 Os = 0° 45' 00.0" Ls = 200.00' LT = 133.33' ST = 66.67'
---	---	---

BENCHMARKS (NAVD 88)

BM1 ELEVATION = 689.84'
N 785073 E 1511778
RAILROAD SPIKE SET VERTICALLY
IN 24' RIVER BIRCH

BM2 ELEVATION = 687.92'
N 785495 E 1511586
RAILROAD SPIKE SET IN
22' SYCAMORE

**CLEARING AND GRUBBING
EROSION CONTROL FOR
CONSTRUCTION SHEET 11**

NOTE:
PLACE TEMPORARY ROCK SEDIMENT DAMS TYPE - B
AND TEMPORARY ROCK SILT CHECKS TYPE - A AT
DRAINAGE OUTLETS.

8/17/99

11/29/2018 9:07:58 AM
I:\Drawings\15823\ddc-psht11.dgn