

-EOT9- STA 676+00 TO 677+00 LT, EST. 142 TONS,
EST. 325 SY GEO FAB, EST. 202 CY DDE

-EOT9- 673+60 TO 674+50 LT, EST. 62 TONS,
EST. 127 SY GEO FAB, EST. 44 CY DDE

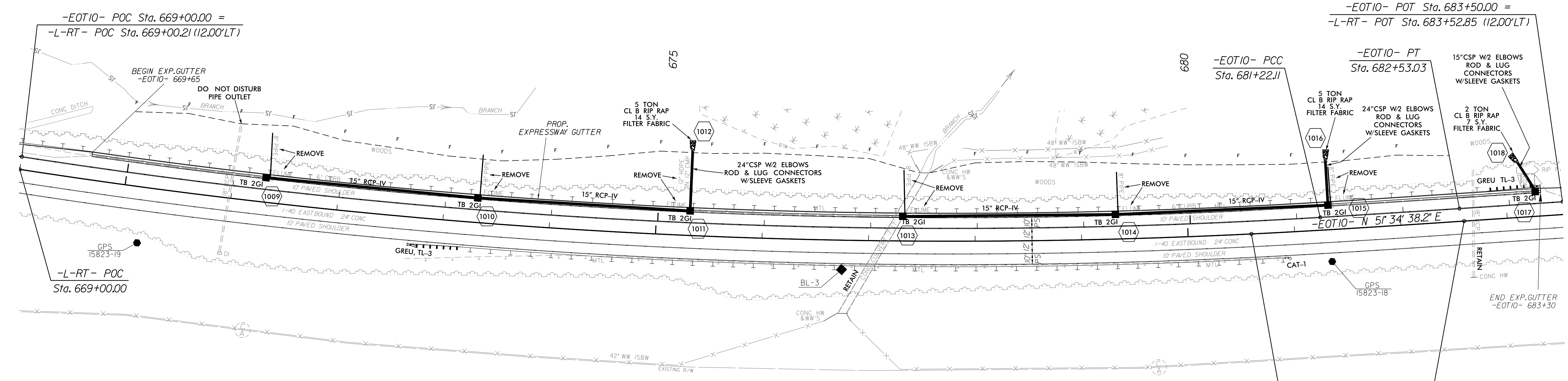
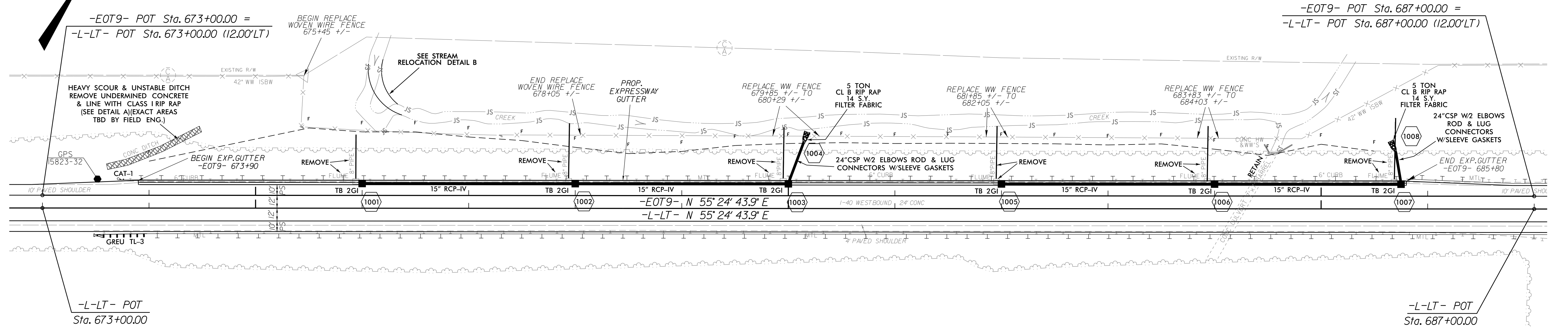

-L-RT-		-EOT10-	
PI Sta 674+13.81	PIs Sta 681+26.12	PI Sta 674+64.01	PI Sta 681+87.57
$\Delta = 12' 58'' 06.2''$ (LT)	$\Theta_s = 1' 00'' 00.0''$	$\Delta = 13' 14'' 55.7''$ (LT)	$\Delta = 0' 20'' 44.5''$ (LT)
D = 1'00' 00.0"	Ls = 200.00'	D = 1'00' 07.6"	D = 0'15' 50.5"
L = 1,296.84'	LT = 133.34'	L = 1,322.11'	L = 130.92'
T = 651.20'	ST = 66.67'	T = 664.01'	T = 65.46'
R = 5,729.58'		R = 5,717.58'	R = 21,700.00'

NOTE:
SEE SHEET X-36 TO X-56
FOR CROSS SECTIONS

I:\DEC-2018\4295...
 I:\Development\TIP_Projects\1-5823-40-Davie\Roadway\DesignFiles\5823_ddc_psh10.dgn