

TIP PROJECT: 15BPR.32
CONTRACT: C204235

STATE OF NORTH CAROLINA
DIVISION OF HIGHWAYS

AVERY & WATAUGA COUNTY

STATE	STATE PROJECT REFERENCE NO.	TOTAL SHEETS
N.C.	15BPR.32	
STATE PROJ. NO.	F.A. PROJ. NO.	DESCRIPTION
15BPR.32	-	P.E.
15BPR.32	-	CONSTR.

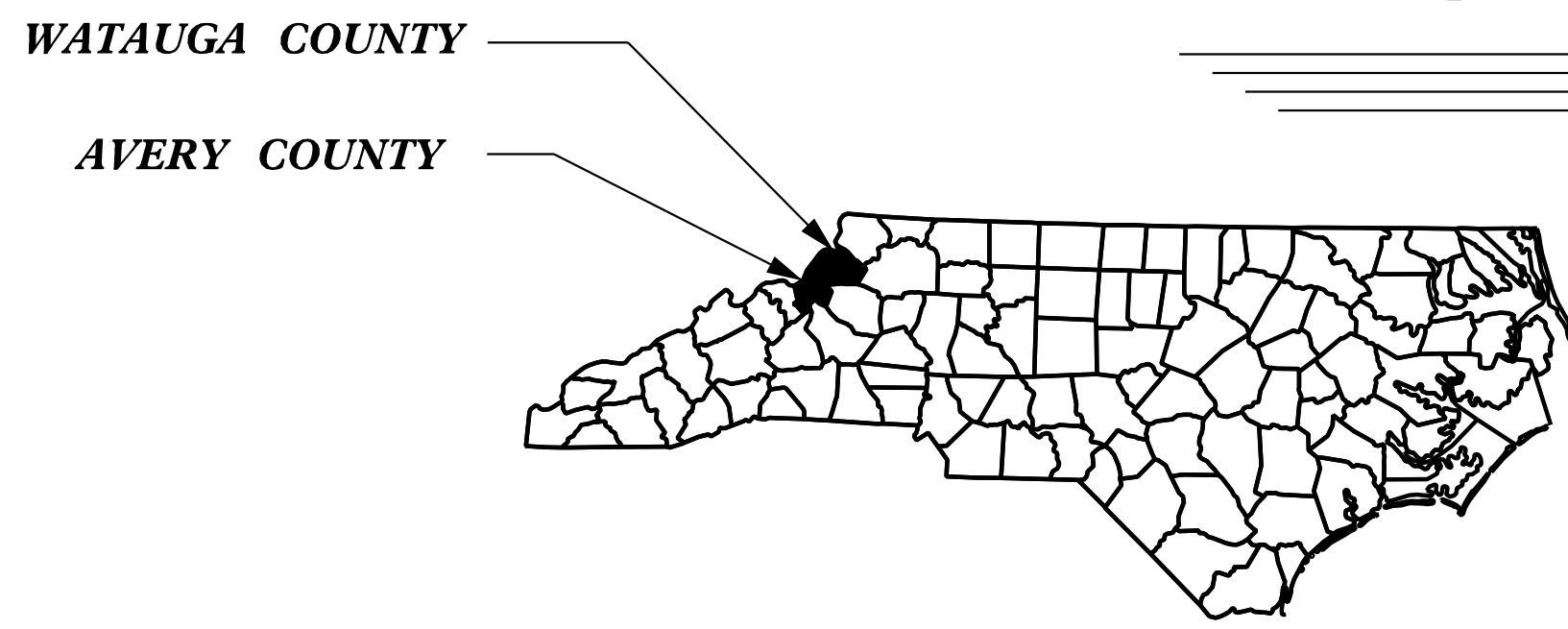

LOCATION: AVERY & WATAUGA COUNTY
AVERY COUNTY CULVERT #02 UNDER US 321 OVER BEECH CREEK
AVERY COUNTY CULVERT #31 UNDER SR 1545 (LINVILLE AVE) OVER GRANDMOTHER CREEK
WATAUGA COUNTY CULVERT #66 UNDER US 321 OVER LAUREL CREEK

TYPE OF WORK: CULVERT PRESERVATION - SHOTCRETE REPAIR, CONCRETE REPAIR, & EPOXY RESIN INJECTION.

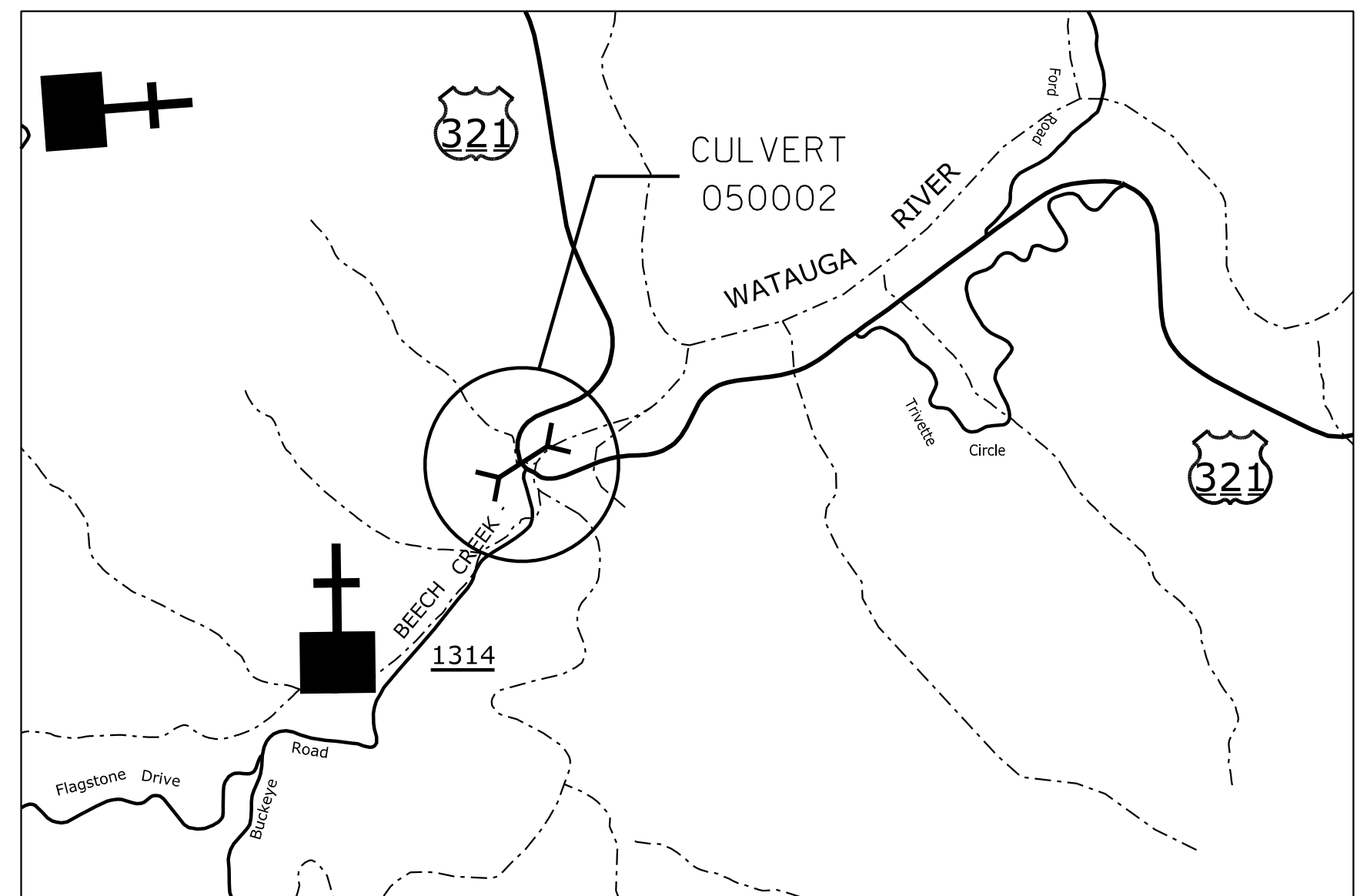

LOCATION SKETCH
 AVERY CULVERT 050002
 LAT 36°15'42.44" / LONG 81°53'49.55"
 SHEETS S-2 THROUGH S-7

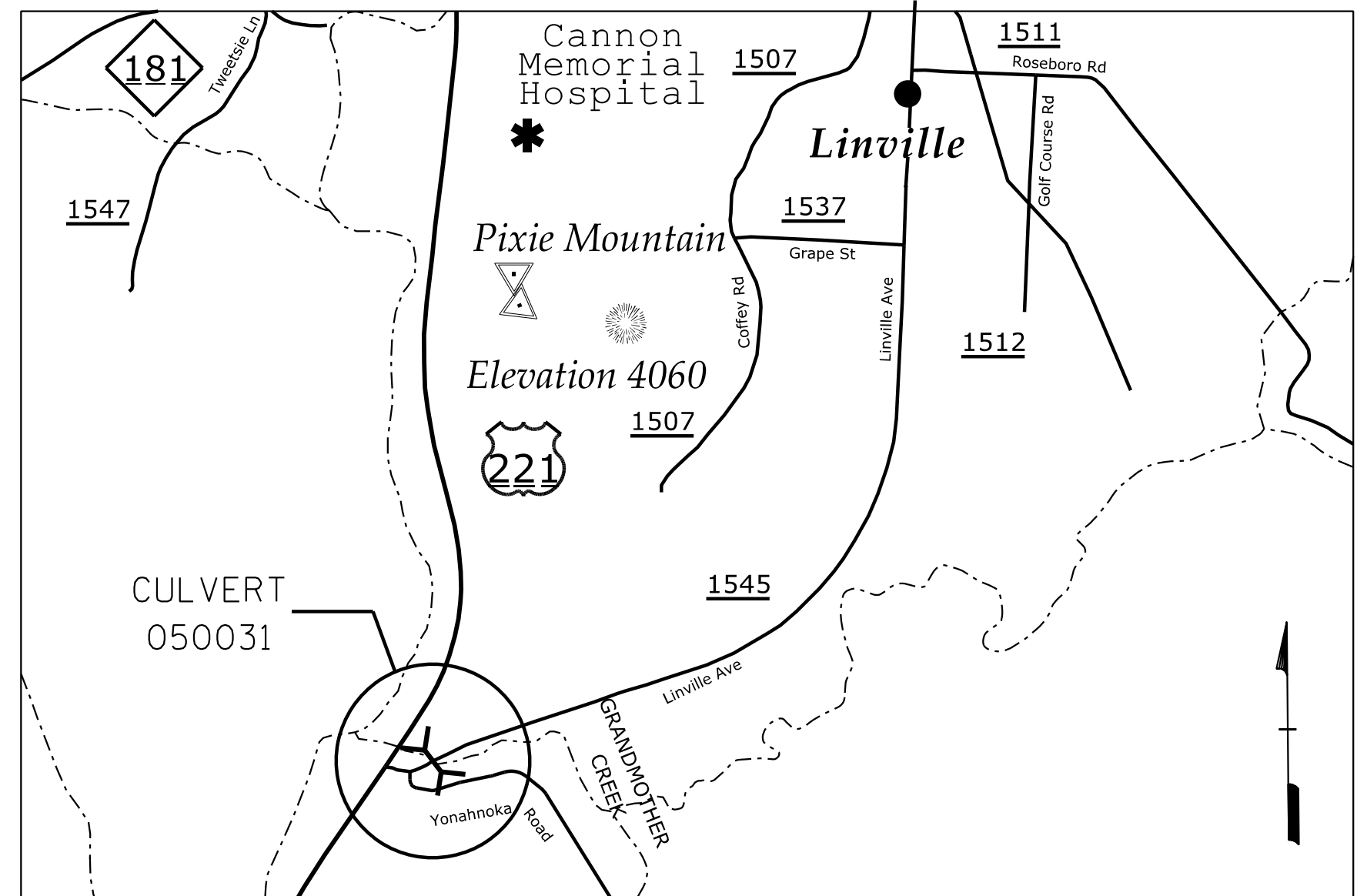

LOCATION SKETCH
 AVERY CULVERT 050031
 LAT 36°03'12.61" / LONG 81°52'50.55"
 SHEETS S-8 THROUGH S-15

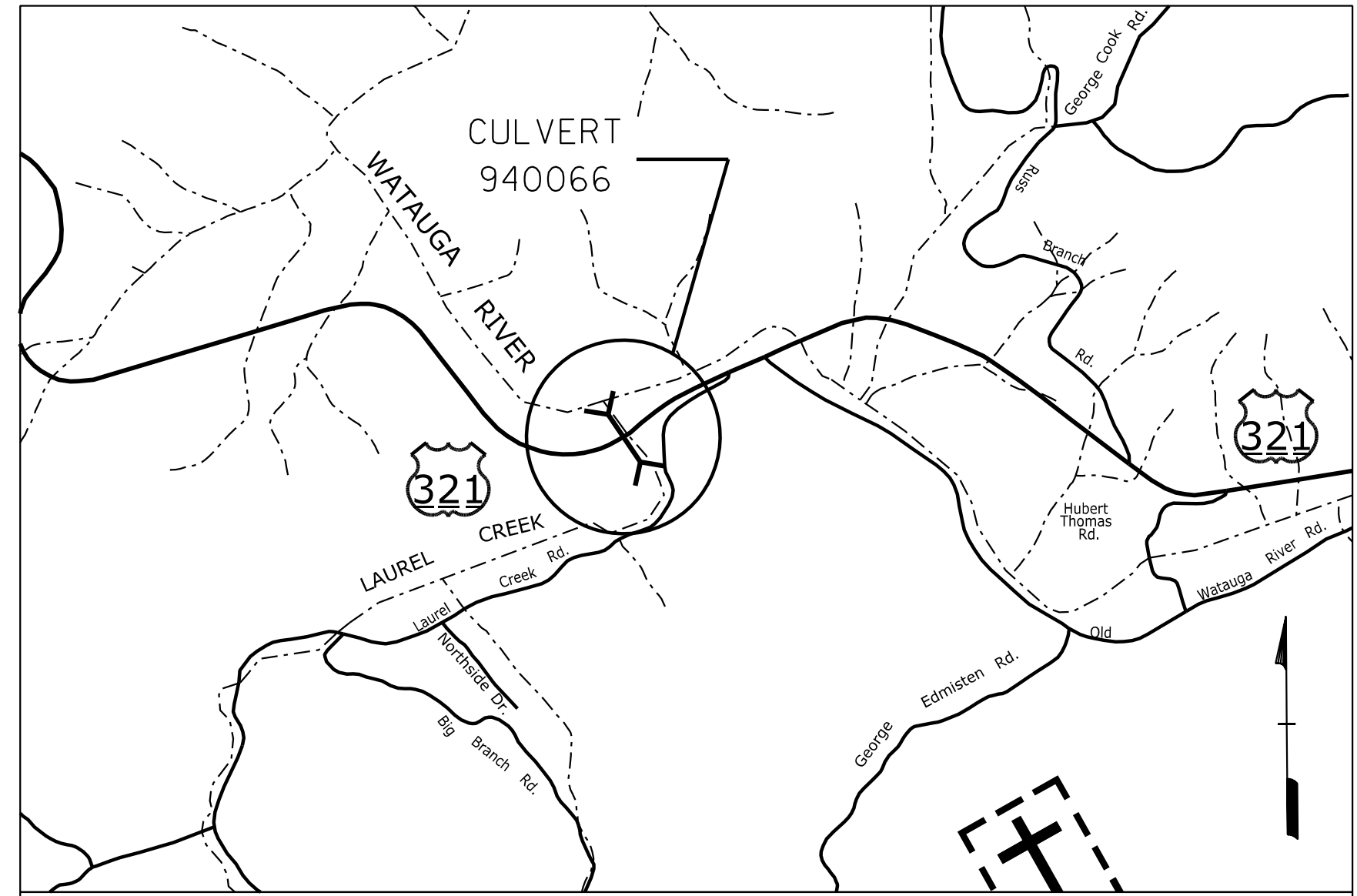

LOCATION SKETCH
 WATAUGA CULVERT 940066
 LAT 36°15'11.99" / LONG 81°51'12.97"
 SHEETS S-16 THROUGH S-22

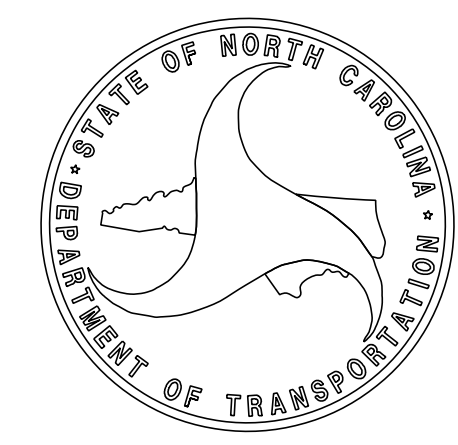

DESIGN DATA

AVERY COUNTY		
- #02 ADT 2015	=	1400
- #31 ADT 2012	=	1100
WATAUGA COUNTY		
- #66 ADT	=	2700

PROJECT LENGTH

AVERY COUNTY	
- #02	= 0.014 MI
- #31	= 0.012 MI
WATAUGA COUNTY	
- #66	= 0.006 MI



TRANSPORTATION PLANNING/DESIGN - BRIDGE/STRUCTURE DESIGN
 CIVIL/SITE DESIGN - GIS/GPS - CONSTRUCTION OBSERVATION

2018 STANDARD SPECIFICATIONS

LETTING DATE:
JANUARY 15, 2019

1223 Jones Franklin Rd.
 Raleigh, N.C. 27606
 License No. F-0377
 Bus: 919 851 8077
 Fax: 919 851 8107

TOM KOCH, P.E.
 PROJECT ENGINEER

ALEX KLINK E.I.
 PROJECT DESIGN ENGINEER