

SURVEY CONTROL SHEET U-5840

-FINAL-

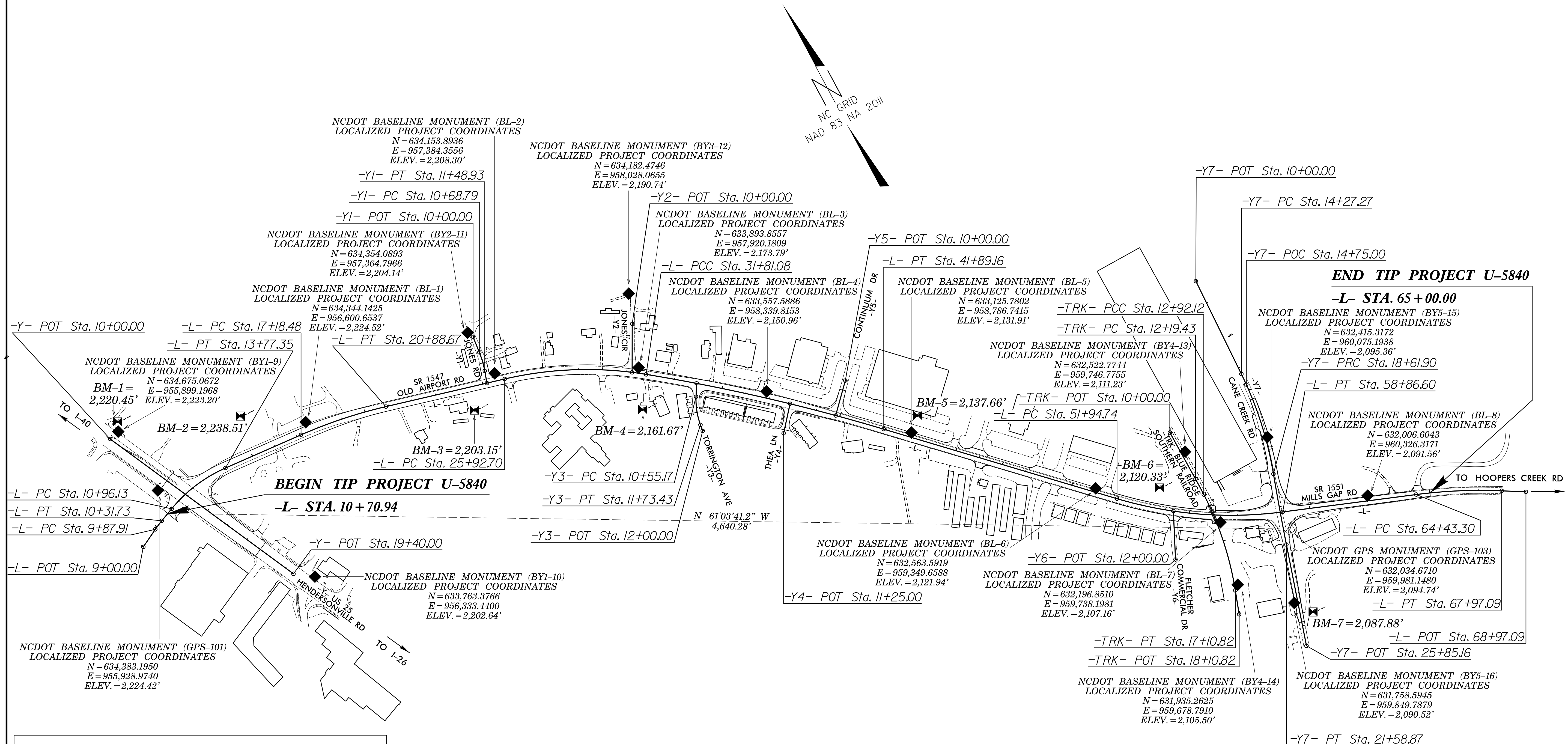
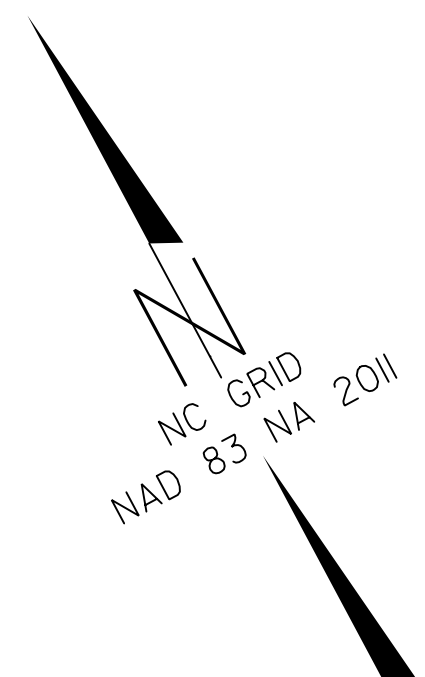

DATUM DESCRIPTION

THE LOCALIZED COORDINATE SYSTEM DEVELOPED FOR THIS PROJECT IS BASED ON THE STATE PLANE COORDINATES ESTABLISHED BY NCGS FOR MONUMENT "GPS-103" WITH NAD 83/NA 2011 STATE PLANE GRID COORDINATES OF NORTHING: 632034.6710(±) EASTING: 959981.1480(±) ELEVATION: 2094.74(±)

THE AVERAGE COMBINED GRID FACTOR USED ON THIS PROJECT (GROUND TO GRID) IS: 0.9997797375

THE N.C. LAMBERT GRID BEARING AND LOCALIZED HORIZONTAL GROUND DISTANCE FROM "GPS-103" TO -L- STATION 10+70.94 IS
N 61°03'41.2" W 4,640.48'

ALL LINEAR DIMENSIONS ARE LOCALIZED HORIZONTAL DISTANCES
VERTICAL DATUM USED IS NAVD 88

NOTES:

- THE CONTROL DATA FOR THIS PROJECT CAN BE FOUND ELECTRONICALLY BY SELECTING PROJECT CONTROL DATA AT:
[HTTPS://CONNECT.NCDOT.GOV/RESOURCES/LOCATION](https://connect.ncdot.gov/resources/location)
 - THE FILES TO BE FOUND ARE AS FOLLOWS:
U-5840_LS_CONTROL.TXT
 - SITE CALIBRATION INFORMATION HAS NOT BEEN PROVIDED FOR THIS PROJECT. IF FURTHER INFORMATION IS NEEDED, PLEASE CONTACT THE LOCATION AND SURVEYS UNIT.
- ⊙ INDICATES GEODETIC CONTROL MONUMENTS USED OR SET FOR HORIZONTAL PROJECT CONTROL BY THE NCDOT LOCATION AND SURVEYS UNIT.
PROJECT CONTROL ESTABLISHED USING GLOBAL POSITIONING SYSTEM.

GEOID MODEL - G12ANC
NOTE: DRAWING NOT TO SCALE

6/2/2016 10:15:11 AM C:\Users\perry\OneDrive\Documents\Projects\U-5840\1c-1.dgn