

TYPICAL SECTION
(EXISTING TRAFFIC PATTERN ON EACH BRIDGE)

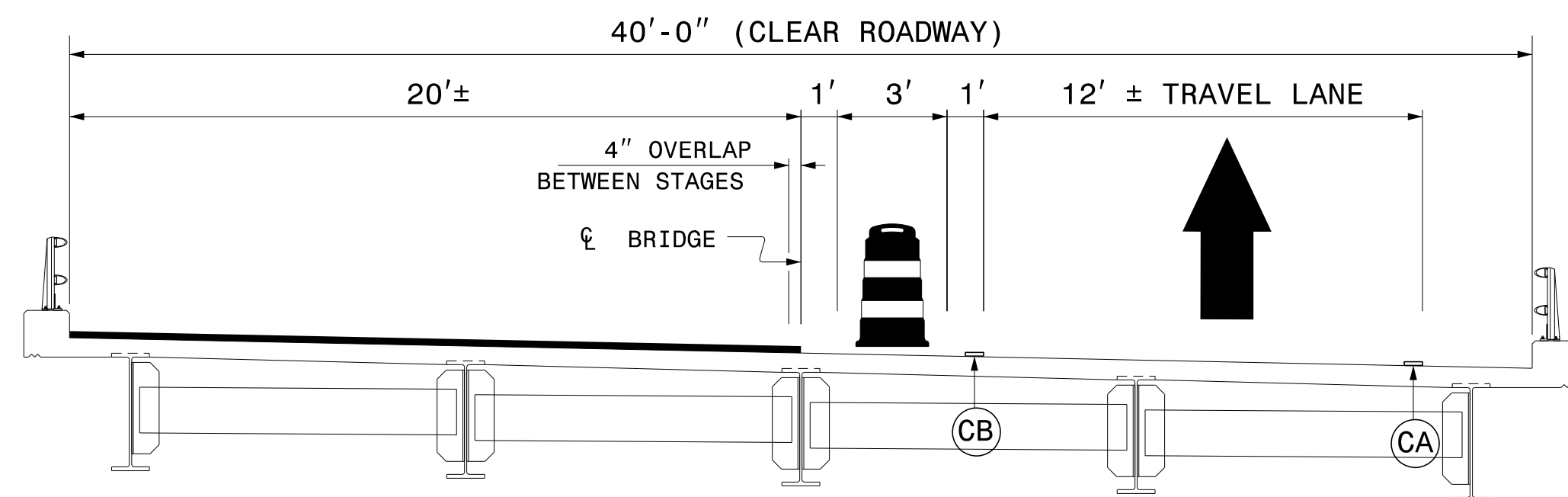

TYPICAL SECTION
(STEP 4)

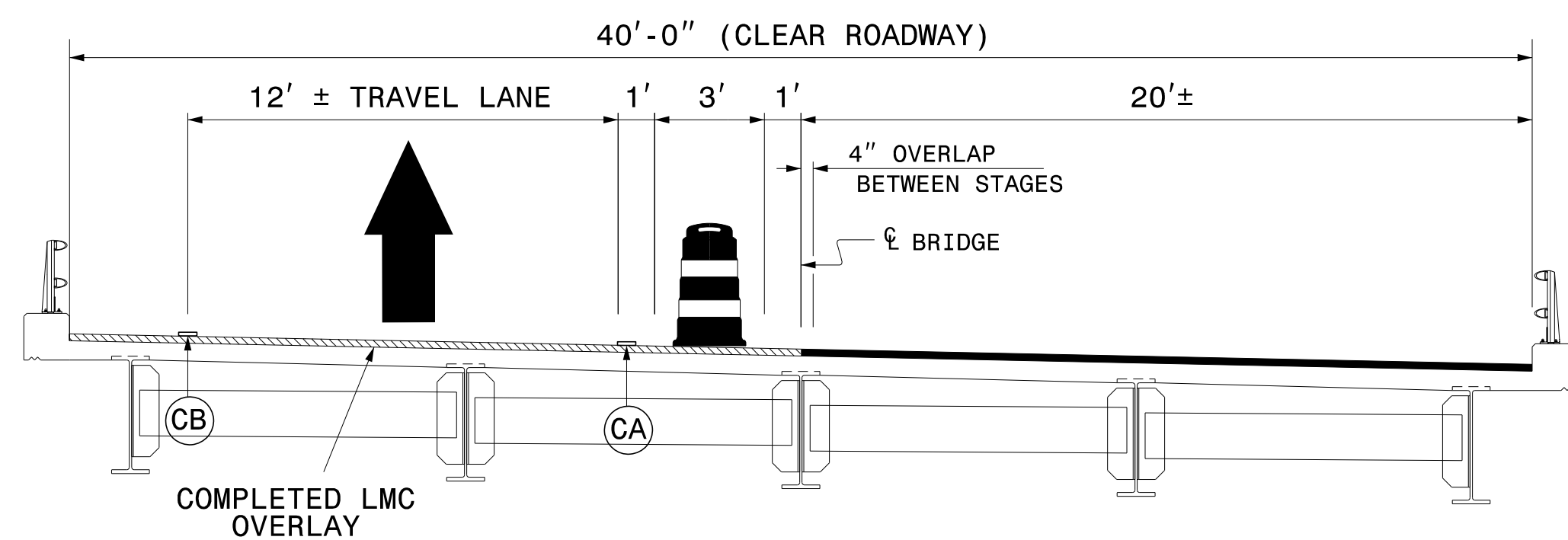

TYPICAL SECTION
(STEP 6)

NOTES

1. THESE TYPICALS INDICATE THE TRAFFIC PATTERNS FOR EACH BRIDGE, AS BRIDGES 31 AND 33 CAN BE WORKED ON CONCURRENTLY.
2. THE CONTRACTOR MAY ELECT TO CLOSE EITHER SINGLE LANE FIRST, HOWEVER, THE CONTRACTOR SHALL SUBMIT A WRITTEN CONSTRUCTION SEQUENCE FOR TRAFFIC CONTROL TO THE ENGINEER AT THE PRECONSTRUCTION MEETING AND THE SEQUENCE MUST BE APPROVED BEFORE CLOSING A LANE OF TRAFFIC.

9/5/2018
 N:\Special\15BPR29\TrafficControl\TCP\15BPR29_TC_TMP_2.dgn
 User:kedals

APPROVED: *Don A. Parker*
4DD4826261841D...
 DATE: 9/5/2018

**DOCUMENT NOT CONSIDERED FINAL
UNLESS ALL SIGNATURES COMPLETED**

DIVISION OF HIGHWAYS
 STATE OF NORTH CAROLINA
 DEPARTMENT OF TRANSPORTATION
 WORK ZONE TRAFFIC CONTROL

TRAFFIC CONTROL
TYPICALS