

STATE	STATE PROJECT REFERENCE NO.	SHEET NO.
N.C.	B-4833	UO-1
STATE PROJ. NO.	F.A. PROJ. NO.	DESCRIPTION
38603.1.FD1	BRZ-2761 (1)	PE, UTIL.
17BP.5.R.96	N/A	UTIL., CONST.

NOTE:
 ALL UTILITY WORK SHOWN ON THIS SHEET IS DONE BY OTHERS.
 NO PAYMENT WILL BE MADE TO THE CONTRACTOR FOR UTILITY WORK SHOWN ON THIS SHEET.

STATE OF NORTH CAROLINA
 DIVISION OF HIGHWAYS

**UTILITIES BY OTHERS PLANS
 WAKE COUNTY**

**LOCATION: BRIDGE NO. 376 OVER LITTLE BLACK CREEK
 ON SR 2761 (WIMBERLY ROAD)**
**TYPE OF WORK: POWER DISTRIBUTION AND
 TELEPHONE RELOCATION**

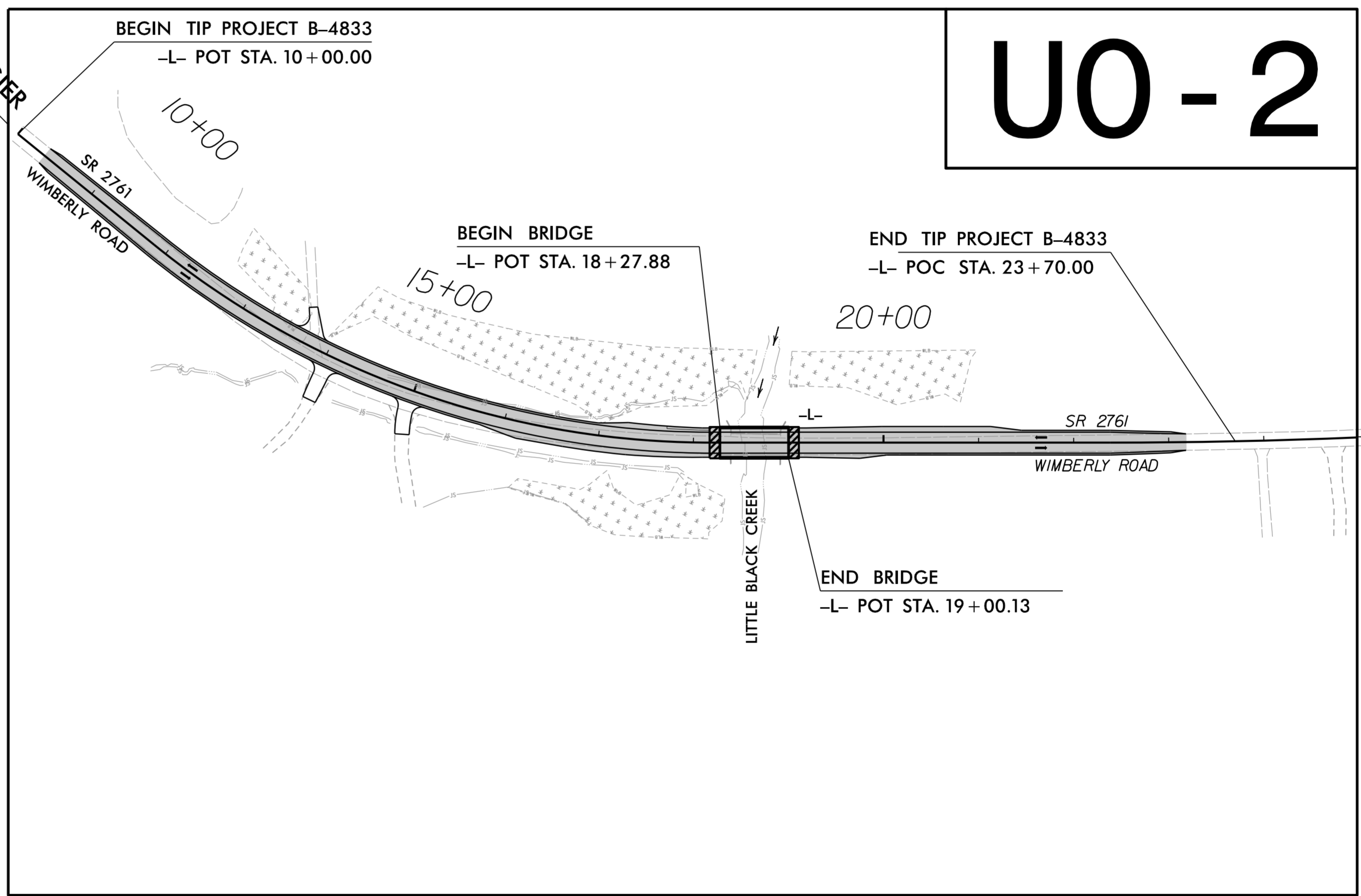
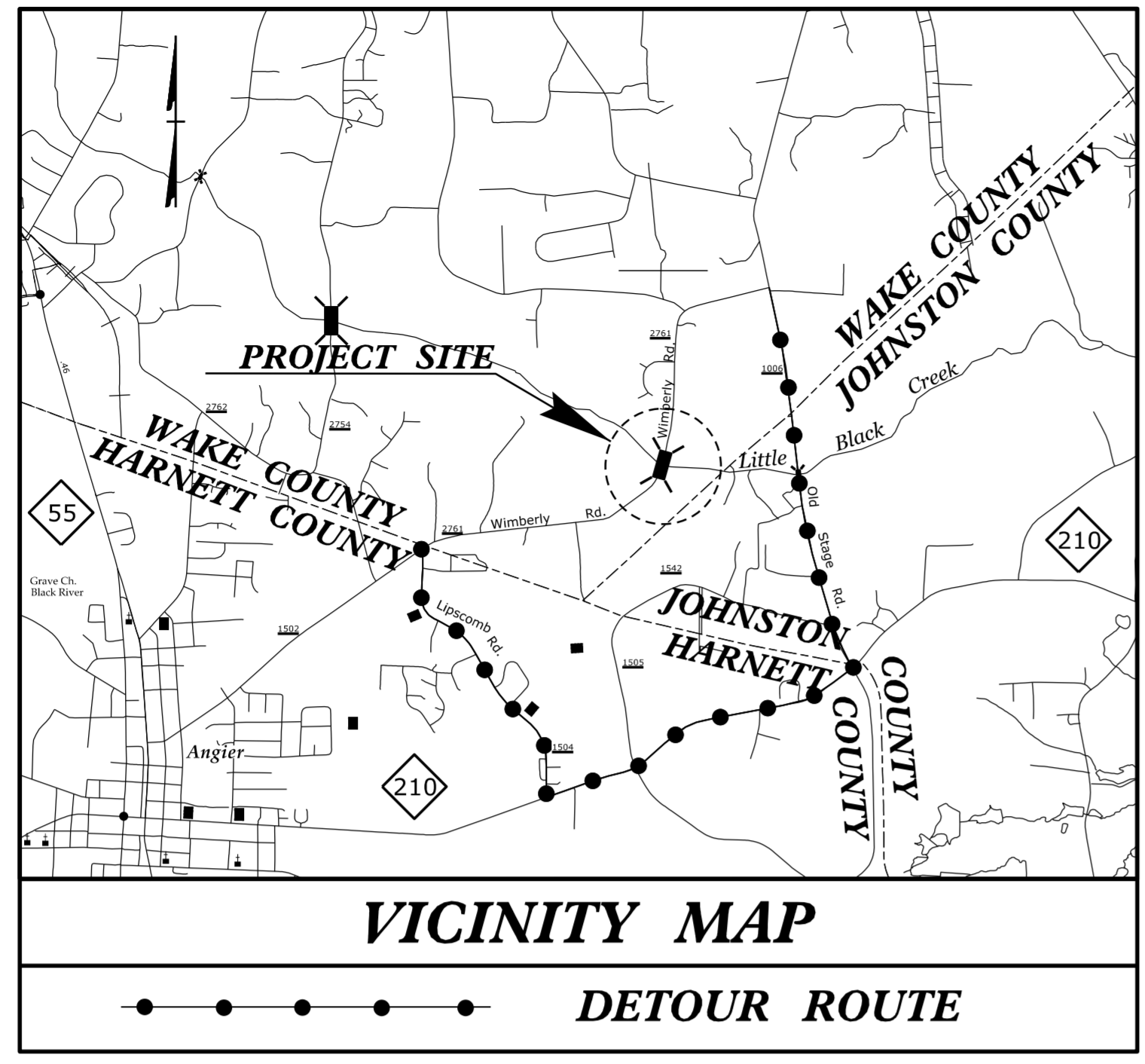
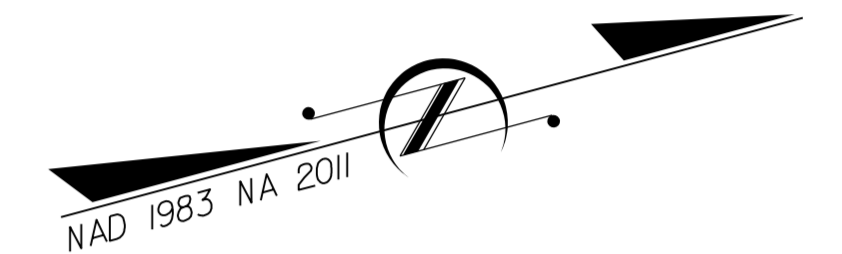

UO-2

TIP PROJECT: B-4833

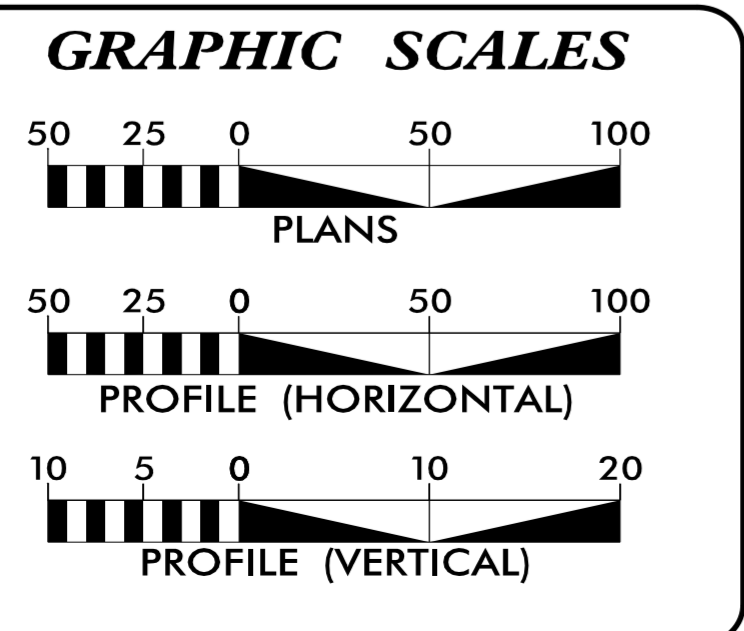

INDEX OF SHEETS

SHEET NO.:	DESCRIPTION:
UO-1	TITLE SHEET
UO-2	UBO PLAN SHEET

UTILITY OWNERS WITH CONFLICTS

(A) POWER DISTRIBUTION - DUKE ENERGY PROGRESS
 (B) TELEPHONE - CENTURYLINK

PREPARED IN THE OFFICE OF:

CH ENGINEERING

3220 GLEN ROYAL RD. RALEIGH, NC 27617
 TELE 919.788.0224 FAX 919.788.0232
 NC LICENSE #P-0189

UTILITIES PROJECT ENGINEER
 Mary Jo Lee, P.E.

**DIVISION OF HIGHWAYS
 DIVISION 5**
 2612 N. DUKE STREET
 DURHAM, 27704

LISA B. GILCHRIST DIVISION CONTACT #1
 XXXX DIVISION CONTACT #2
 XXXX DIVISION CONTACT #3
 XXXX DIVISION CONTACT #4